



**5000 SERIES
STALK DEVASTATOR
CHOPPING / 20" & 30" ROWS
CASE – IH / NEW HOLLAND CORN HEADS**

**OWNER'S MANUAL
PART IDENTIFICATION
2565-970_REV_C • 8/2024**



YETTER MANUFACTURING CO.

Founded 1930

Colchester, IL 62326

Toll free: (800)447-5777.

Fax: (309)776-3222

Website: yetterco.com

E-mail: info@yetterco.com

YETTER

FOREWORD

You've just joined an exclusive but rapidly growing club.

For our part, we want to welcome you to the group and thank you for buying a Yetter product.

We hope your new Yetter products will help you achieve both goals-increase your productivity and increase your efficiency so that you may generate more profit.

This operator's manual has been designed into four major sections: Foreword, Safety Precautions, Installation Instructions and Parts Breakdown.

This **SAFETY ALERT SYMBOL** indicates important safety messages in the manual. When you see this symbol, be alert to the possibility of **PERSONAL INJURY** and carefully read the message that follows.



DANGER: Indicates an imminently hazardous situation which, if not avoided "will" result in death or serious injury. This signal word is to be limited to the most extreme situations



WARNING: Indicates a potentially hazardous situation which, if not avoided, "could" result in death or serious injury.



CAUTION: Indicates a potentially hazardous situation, which if not avoided, "may" result in minor or moderate injury. It may also be used to alert against unsafe practices.



NOTICE: Indicates information considered important, but not hazard related (e.g., messages relating to property damage).

It is the responsibility of the user to read the operator's manual and comply with the safe and correct operating procedure and to lubricate and maintain the product according to the maintenance schedule in the operator's manual. The user is responsible for inspecting his machine and for having parts repaired or replaced when continued use of the product would cause damage or excessive wear to the other parts.

It is the user's responsibility to deliver his machine to the Yetter dealer who sold him the product for service or replacement of defective parts, which are covered by the warranty policy.

If you are unable to understand or follow the instructions provided in this publication, consult your local Yetter dealer or contact:

YETTER MANUFACTURING CO.

309/776-4111

800/447-5777

309/776-3222 (FAX)

Website: www.yetterco.com

E-mail: info@yetterco.com

WARRANTY POLICY

Yetter Manufacturing warrants all products manufactured and sold by it against defects in material. This warranty being expressly limited to replacement at the factory of such parts or products as will appear to be defective after inspection. This warranty does not obligate the Company to bear cost of labor in replacement of parts. It is the policy of the company to make improvements without incurring obligations to add them to any unit already sold. No warranty is made or authorized to be made, other than herein set forth. This warranty is in effect for one year after purchase.

Dealer : _____

Yetter Manufacturing warrants its own products only and cannot be responsible for damage to equipment on which mounted.



SAFETY PRECAUTIONS



A brief description of signal words that may be used in this manual:

DANGER: Indicates an imminently hazardous situation which, if not avoided “will” result in death or serious injury. This signal word is to be limited to the most extreme situations.

WARNING: Indicates a potentially hazardous situation which, if not avoided, “could” result in death or serious injury.

CAUTION: Indicates a potentially hazardous situation, which if not avoided, “may” result in minor or moderate injury. It may also be used to alert against unsafe practices.

NOTICE: Indicates information considered important, but not hazard related (e.g., messages relating to property damage).

Consult your implement and tractor operator’s manual for correct and safe operating practices. Be aware of towed implement width and allow safe clearance.

Safety decals are placed on the implement to alert the operator and others to the risk of personal injury or unsafe operation during normal operations and servicing.

1. The safety decals must be kept clean and in good condition to ensure that they are legible.
2. Safety decals must be replaced if they are missing or illegible.
3. When components are replaced during repair or servicing, check that the new components include the necessary safety signs.
4. Replacement safety decals may be obtained from your local dealer.



WARNING

Read these instructions carefully to acquaint yourself with the Equipment. Working with unfamiliar equipment can lead to accidents.

Never park the equipment on a steep incline or leave the equipment running unattended.

Never clean, lubricate or adjust a machine that is in motion.

Always check that straps are secure.

Make sure latches are in pinned position when moving equipment.

Do not allow children to operate this equipment.

Do not allow riders on the equipment, trailer and/or pick-up.

Use speed and caution dictated by the terrain being traversed. Do not operate on any slope steep enough to cause tipping or loss of control.

Read and understand the operator’s manual and require all other persons who will operate the equipment to do the same.

If operating on public roadways, where legal, be certain all lighting is operating properly and observe all traffic laws.

Beware of increased stopping distances and control effort when operating with implements attached.

Be familiar with all controls and be prepared to stop equipment quickly in an emergency.

FAILURE TO HEED MAY RESULT IN PERSONAL INJURY OR DEATH.

PLEASE READ, VERY IMPORTANT



SECURE CORN HEADER AGAINST UNWANTED LOWERING BY APPLYING THE LOCKING MECHANISM ON THE HYDRAULIC CYLINDERS!

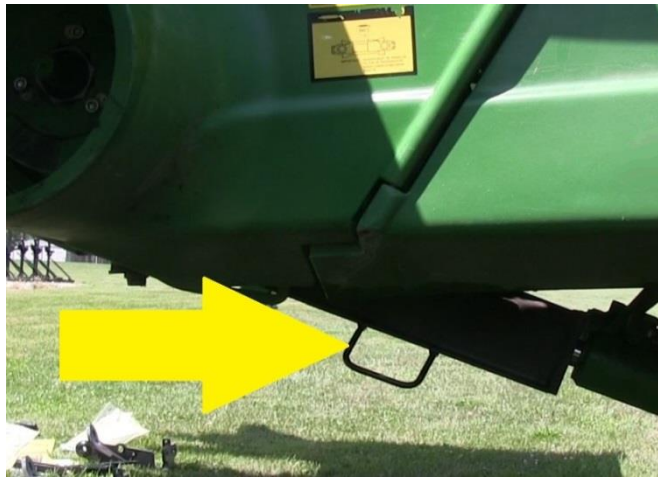

- 1. Attach head to combine, lock head to combine**
- 2. Raise the head off the ground and engage safety stop on the feeder house cylinder.**
- 3. Turn off combine engine and remove the key**

Subject to the size and weight of the corn header, one or two additional hydraulic cylinders may be required.

The combine manufacturer generally keeps corresponding kits readily available for dealers.

Subject to the design of the corn header and the carrying capacity of different combines, the steering axle may require the fitting of additional weights and the rear tires be filled with ballast.

FOLLOW ALL INSTRUCTIONS GIVEN BY THE COMBINE MANUFACTURER

TABLE OF CONTENTS

FOREWARD.....	2
WARRANTY.....	2
SAFETY INFORMATION.....	2 – 4
OPERATION CHECKLIST / TORQUE.....	5
BILL OF MATERIALS	6
ASSEMBLY INSTRUCTIONS.....	7 – 11
LOCK UP / OPERATION.....	12
STORAGE / TRANSPORT / BEARING REPLACEMENT.....	13
PART IDENTIFICATION.....	14 – 17
TROUBLESHOOTING.....	18

DEVASTATOR OPERATION CHECKLIST

Please fill this out after the Yetter Stalk Devastator has been installed.

DATE ___/___/___ YETTER KIT # - 5000-___ CORN HEAD MAKE/MODEL_____

COMBINE MAKE/MODEL_____ FRONT TIRE SIZE_____ REAR TIRE SIZE_____

REAR AXLE POSITION_____ SNAPPING ROLLS USING_____ CHOPPING BLADES YES / NO

DECK PLATE ANGLE _____ ° (USE ANGLE FINDER) SNAPPING ROLL HEIGHT (OPERATING POSITION) _____ INCHES

HARVEST SPEED _____ MPH HEAD SPEED _____ ANGLE TORSION ARM (OPERATING POSITION - USE ANGLE FINDER) _____

HEAD CART INFO:

MAKE/MODEL _____ LENGTH _____ TIRE SIZE _____

SEE **PAGE 12 & 13** FOR HEAD & TRAILER ADJUSTMENTS

BOLT TORQUE





Important: Over-tightening hardware can cause just as much damage as under-tightening. Tightening hardware beyond the recommended range can reduce its shock load capacity.

All hardware on the 5000 Devastator is either Grade 5 or Grade 8, unless otherwise noted. Grade 5 cap screws are marked with three radial lines on the head. Grade 8 cap screws are marked with six radial lines on the head. If hardware must be replaced, be sure to replace it with hardware of equal size, strength and thread type. Refer to the torque values chart when tightening hardware.

The chart below is a guide for proper torque. Use it unless a specified torque is called out elsewhere in the manual. Torque is the force applied to the end of the handle or cheater bar, times the length of the handle or bar.

Use a torque wrench wherever possible

The following table shows torque in ft.-lbs. for coarse thread hardware.

Bolt Diameter and Threads per Inch	 Grade 2	 Grade 5	 A-325	 Grade 8
1/4	6	10	14	
5/16	12	20	30	
3/8 – 16	25	35	50	
7/16 – 14	35	55	80	
1/2 – 13	55	85	125	
9/16 – 12	75	125	175	
5/8 – 11	105	170	235	
3/4-10	185	305	425	
7/8 – 9	170	445	690	
1-8	260	670	1030	
1 1/8 – 7	365	900	1460	
1 1/4 - 7	515	1275	2060	
1 3/8 – 6	675	1675	2700	
1 1/2 - 6	900	2150	3500	
1 3/4 – 5	1410	3500	5600	

BILL OF MATERIALS PER KIT

5000-060C – 6R30 Case 2606/4206/4406 & New Holland 99C/980R Chopping Rigid Corn Heads – 2) 5000-160A Roller Bearing Bolt Bag, 4) 5000-173 Torsion Mount Bolt Bag, 1) 5000-175 Manual Bag, 4) 5000-187 Locking Torsion Assembly, 2) 5000-272 3R30 Roller W.A., 2) 5000-275A 4R20/3R30 Roller Mount W.A., 4) 5000-294A Torsion Arm W.A.

5000-061C – 8R30 Case 2608/4208/4408 & New Holland 99C/980R Chopping Rigid Corn Head – 3) 5000-160A Roller Bearing Bolt Bag, 6) 5000-173 Torsion Mount Bolt Bag, 1) 5000-175 Manual Bag, 6) 5000-187 Locking Torsion Assembly, 1) 5000-268 2R30 Roller W.A., 1) 5000-269A 2R30 Roller Mount W.A., 2) 5000-272 3R30 Roller W.A., 2) 5000-275A 4R20/3R30 Roller Mount W.A., 6) 5000-294A Torsion Arm W.A.

5000-062C – 12R30 Case 2612/4412/4412F & New Holland 99C/980CR Chopping Folding/Rigid Corn Heads – 4) 5000-160A Roller Bearing Bolt Bag, 8) 5000-173 Torsion Mount Bolt Bag, 1) 5000-175 Manual Bag, 8) 5000-187 Locking Torsion Assembly, 4) 5000-272 3R30 Roller W.A., 4) 5000-275A 4R20/3R30 Roller Mount W.A., 8) 5000-294A Torsion Arm W.A.

5000-063C – 12R20 Case 4412 & New Holland 9212 Chopping Rigid Corn Heads– 3) 5000-160A Roller Bearing Bolt Bag, 6) 5000-173 Torsion Mount Bolt Bag, 1) 5000-175 Manual Bag, 6) 5000-187 Locking Torsion Assembly, 3) 5000-267 4R20 Roller W.A., 3) 5000-275A 4R20/3R30 Roller Mount W.A., 6) 5000-294A Torsion Arm W.A.

ASSEMBLY INSTRUCTIONS

BELOW ARE RECOMMENDED LOCATIONS OF THE TORSION PIVOT ASSEMBLY, ALTERNATE LOCATIONS MAY BE USED IF INTERFERENCE OCCURS!

5000-060 6 ROW 30"

Arrows indicate 5000-187 Torsion Pivot locations

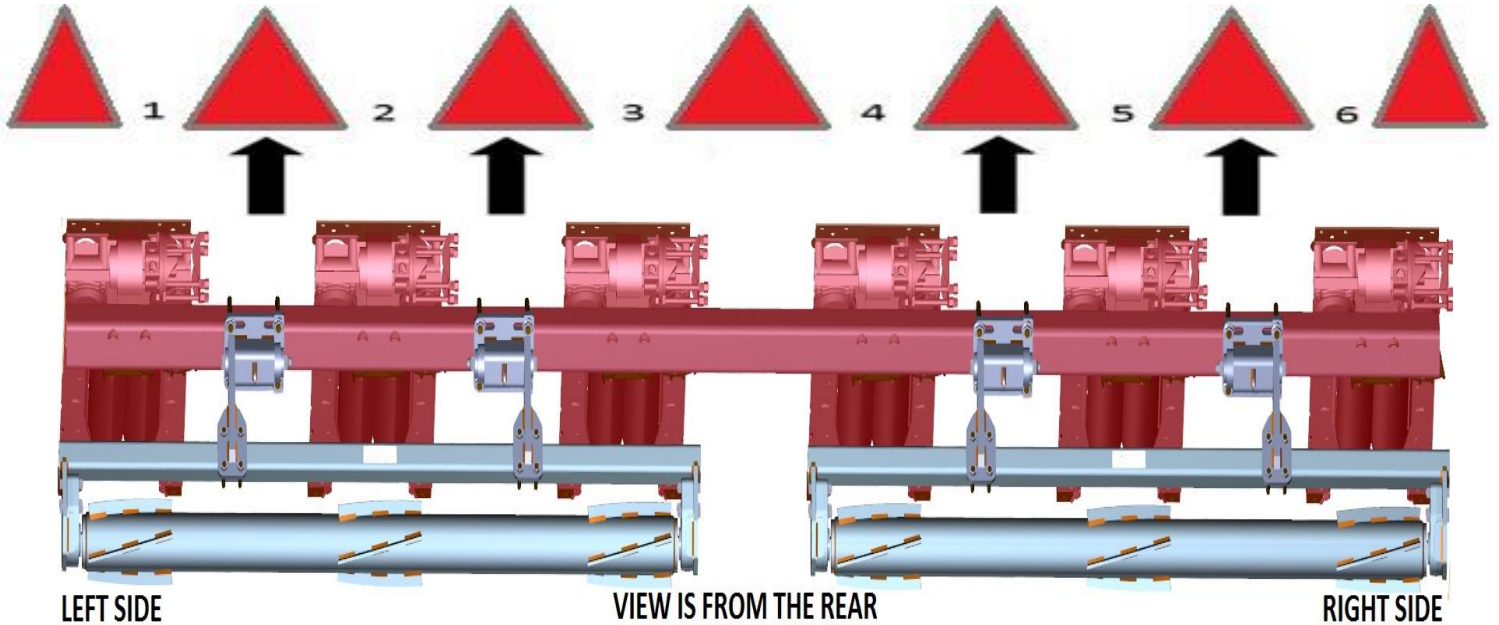

5000-061 8 ROW 30"

Arrows indicate 5000-167 Torsion Pivot locations

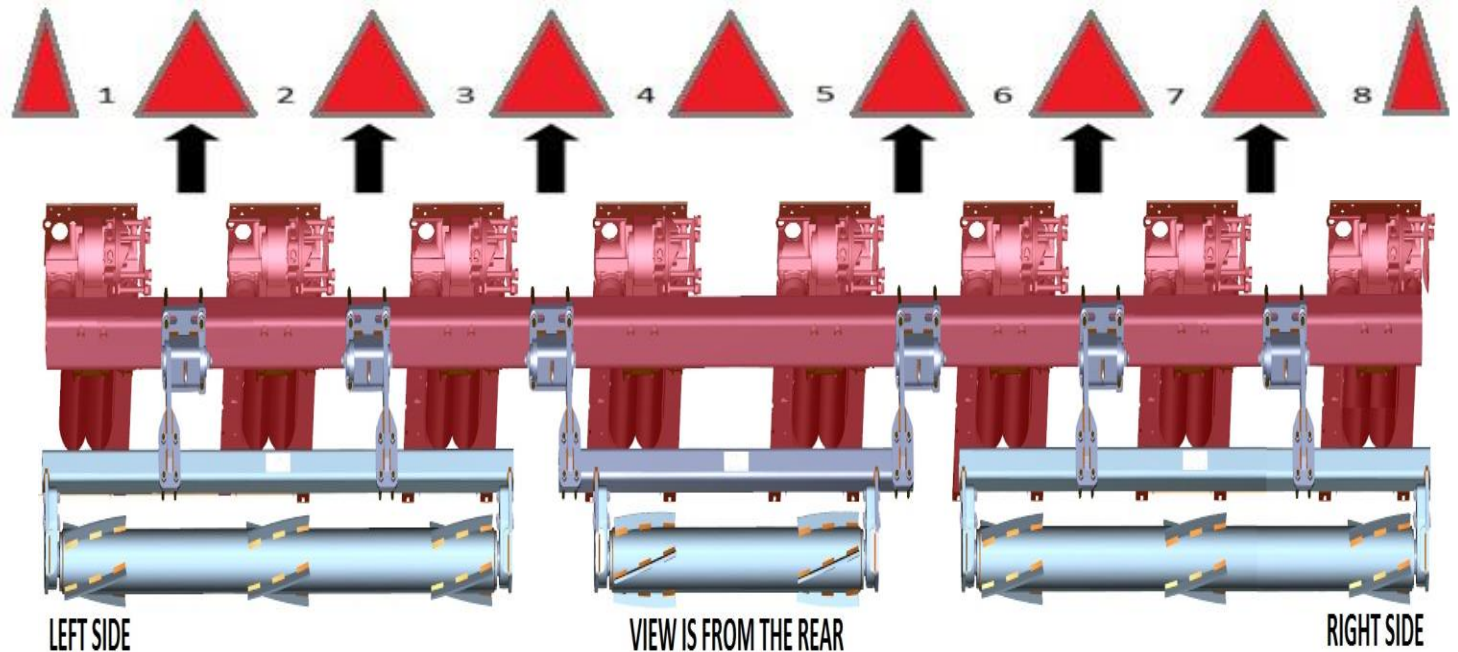

ASSEMBLY INSTRUCTIONS

BELOW ARE RECOMMENDED LOCATIONS OF THE TORSION PIVOT ASSEMBLY, ALTERNATE LOCATIONS MAY BE USED IF INTERFERENCE OCCURS!

5000-062 12 ROW 30"

Arrows indicate 5000-187 Torsion Pivot locations

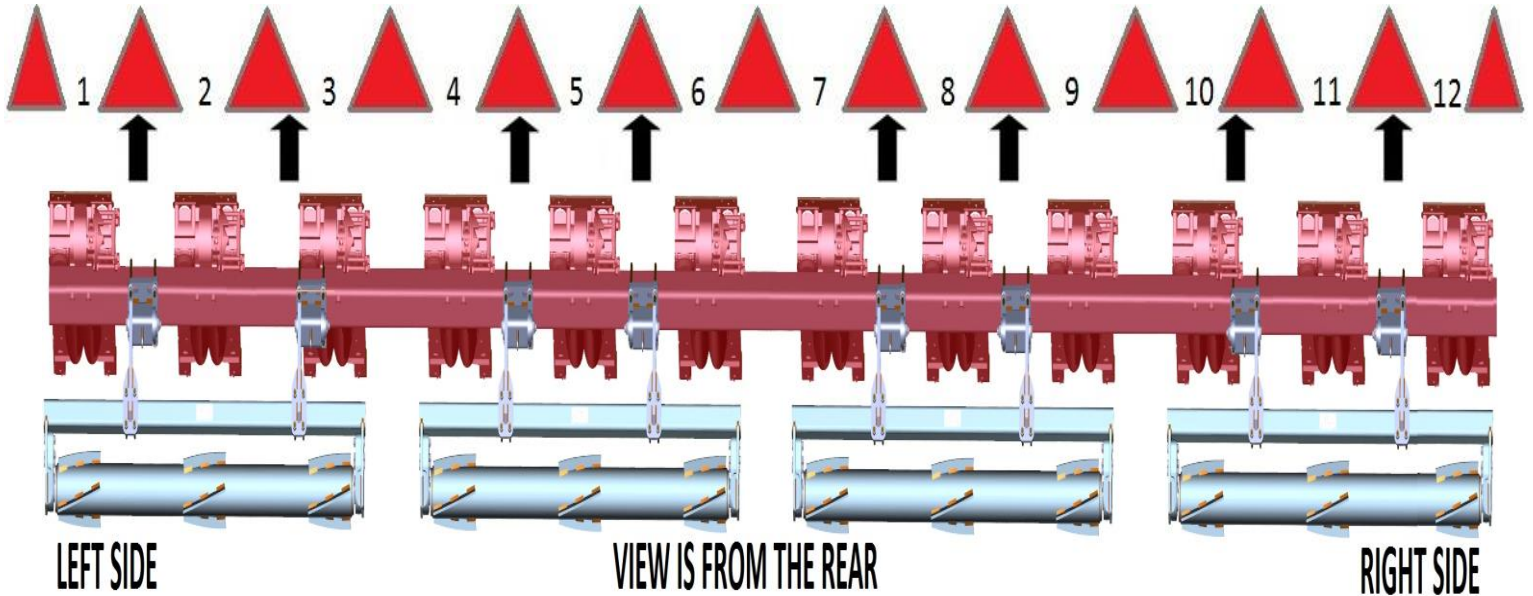

5000-063 12 ROW 20"

Arrows indicate 5000-187 Torsion Pivot locations

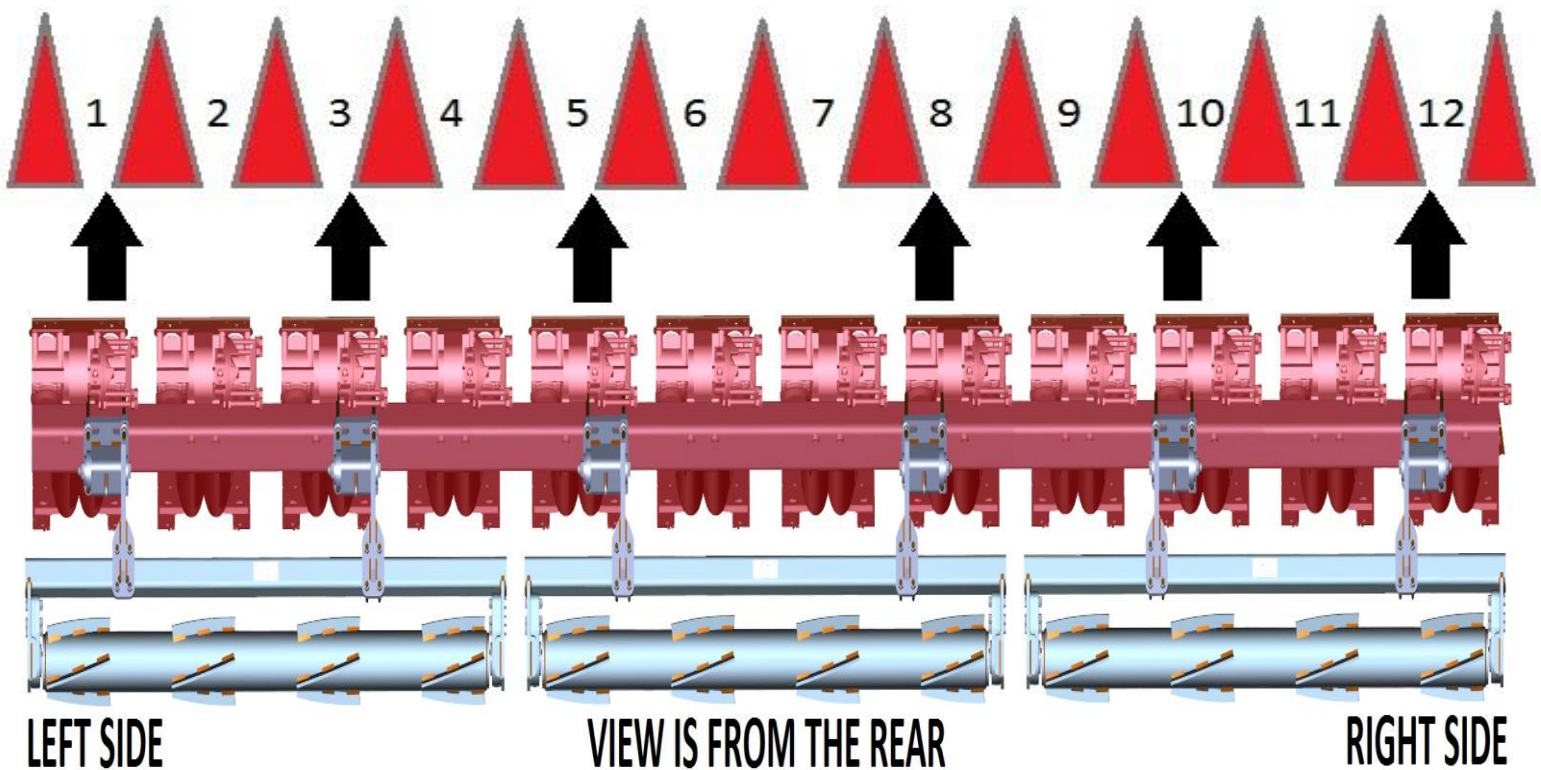

ASSEMBLY INSTRUCTIONS

Step 1: Attach each 5000-187 locking torsion assembly to the frame using 2) 5/8 X 4 X 5 1/2 U-Bolts & 4) 5/8 – 11 Hex Flange Nuts. See [pages 7 – 8](#) for each locking torsion pivot assembly mounting location for your corn head. On some corn head models, the locking torsion assembly will have to go between the gearbox mounting straps. It is also possible that the locking torsion assembly will need mounted using the gearbox holes, longer bolts will be needed.

NOTE: If corn head is equipped with shields between the rows, loosen shields to allow U-bolts to pass & then retighten shields.

DIRECTION OF
TRAVEL

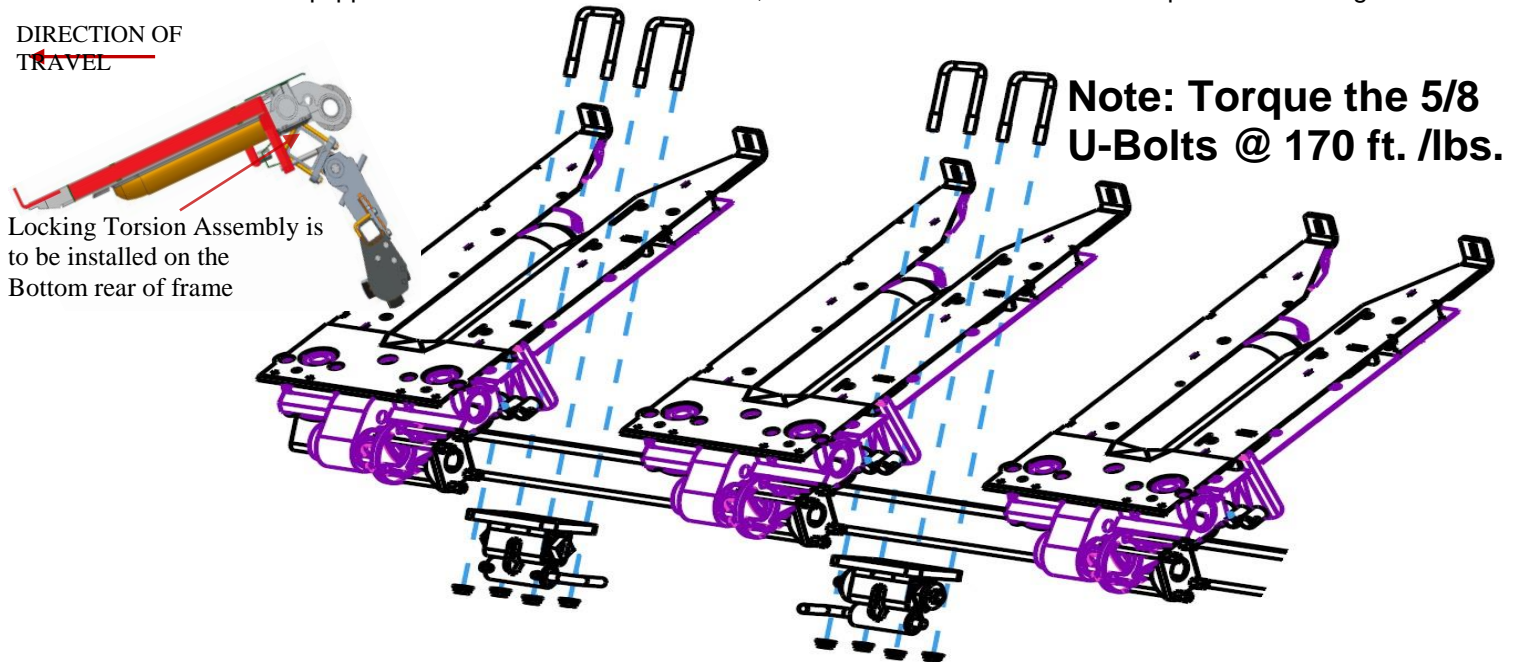

Step 2: Install the 5000-294A Torsion Arm onto the 5000-187 Locking Torsion Assembly & secure with 3/4" x 8" bolts & 3/4" lock nuts. Refer to the diagrams on the previous pages to determine which side of the 5000-187 Locking Torsion Assembly to install the 5000-292A Torsion Arm. See [pages 7-8](#) to determine which side of the torsion arm to mount the torsion pivot to for your corn head.

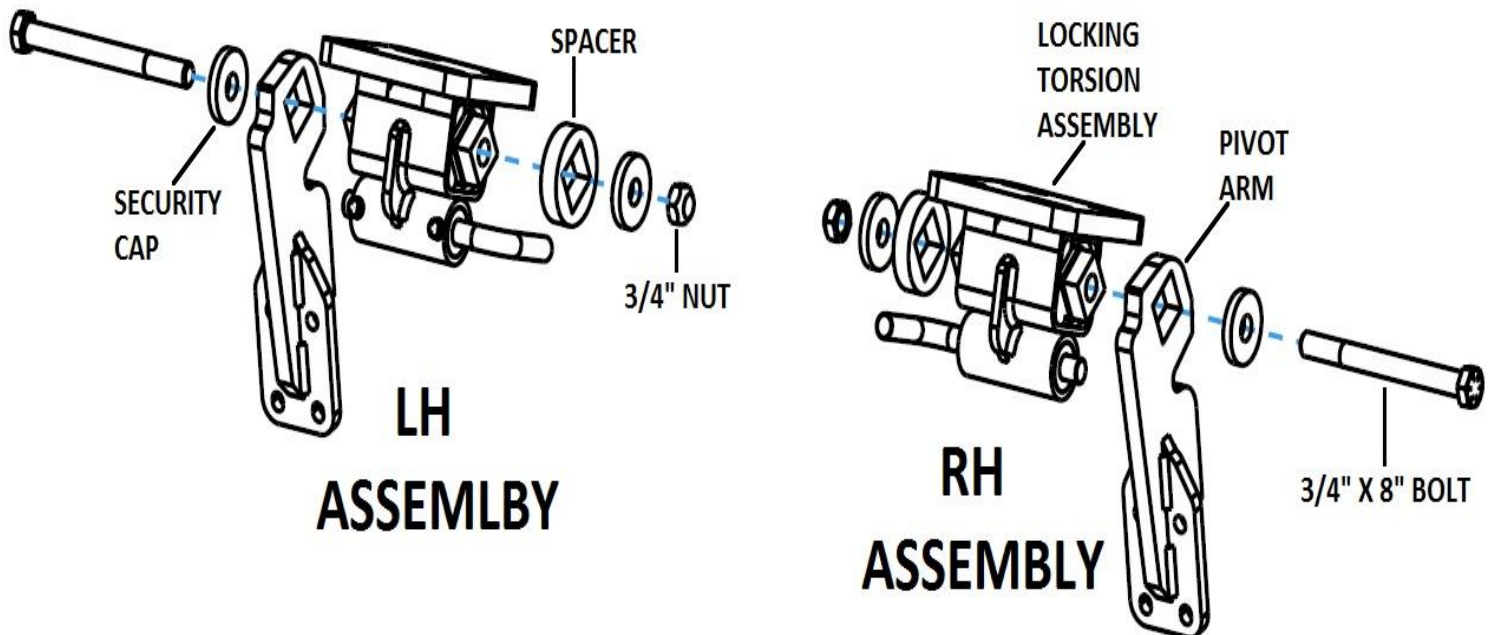

ASSEMBLY INSTRUCTIONS

Step 3: Attach the roller mount to pivot arms using $\frac{1}{2}$ " x 2-1/2" x 3-1/2" U-bolts & lock nuts. See diagrams on **pages 7 – 8** to determine orientation of roller & roller mount tube locations for your corn head. **DO NOT TIGHTEN HARDWARE YET!!**

NOTE: The bearing support tab on the roller mount tube should be on the backside of the bearing mount plate.

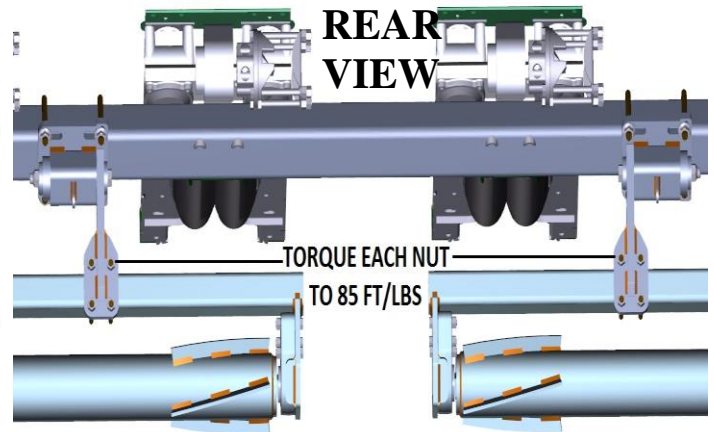
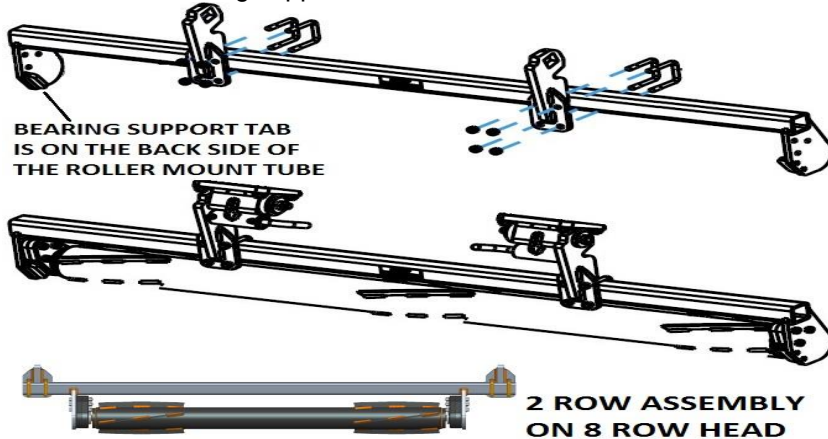

Step 4: Insert the 5000-322 shim washer over the shaft on each end of roller. Install the 5000-355 bearing over the shaft on each end of roller so that the side of casting that has bearing protruding past the housing surface is away from the bearing mount plate. Lift each roller into place so that the bolt holes on the cast line up with the holes on the bearing mount plate on the roller arm mount tube. Install the $\frac{1}{2}$ " X 2 $\frac{1}{2}$ " bolts and tighten the $\frac{1}{2}$ " lock nuts. Once the roller & bearing hardware is fastened, spin the roller to ensure the bearing was installed correctly. If the roller was installed incorrectly, the roller will not spin or will have drag. Slide the roller mount tube to gain clearance on each end of the corn head, center the traction bar under the row as much as possible, & then tighten the hardware from **Step 3**. In some circumstances, the traction bar may have to be off-center of the row some.

The spacer must be installed between the roller and the bearing. The notches of the bearing housing must face the mounting plate. The extended race on the bearing will face away from the roller.

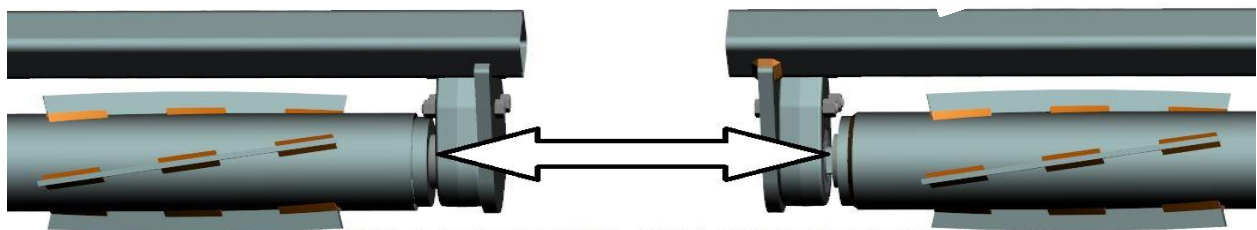
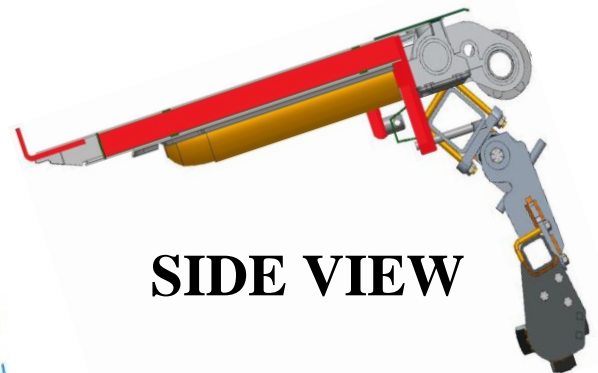
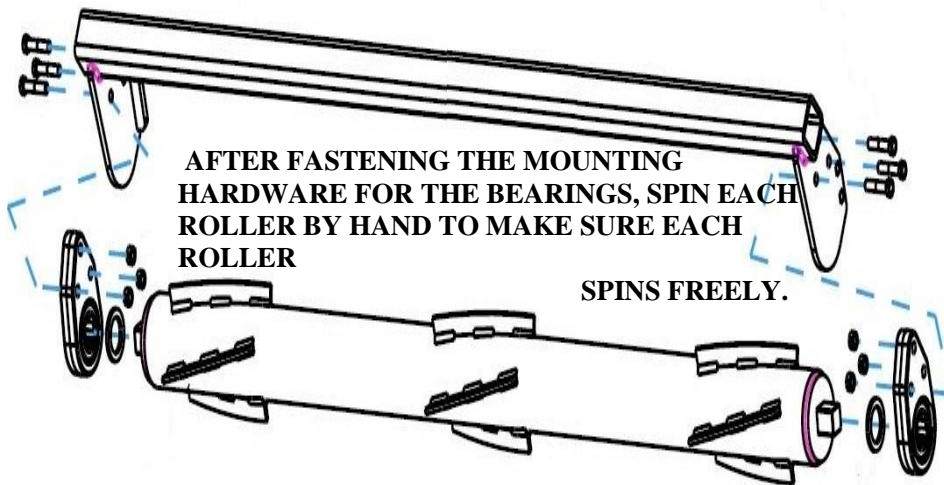

ASSEMBLY INSTRUCTIONS

Step 5: Slide roller mount tubes to align the row center with the traction bars. Fully tighten hardware from **Step 3**. In some circumstances, the traction bar may have to be off-center of the row some.

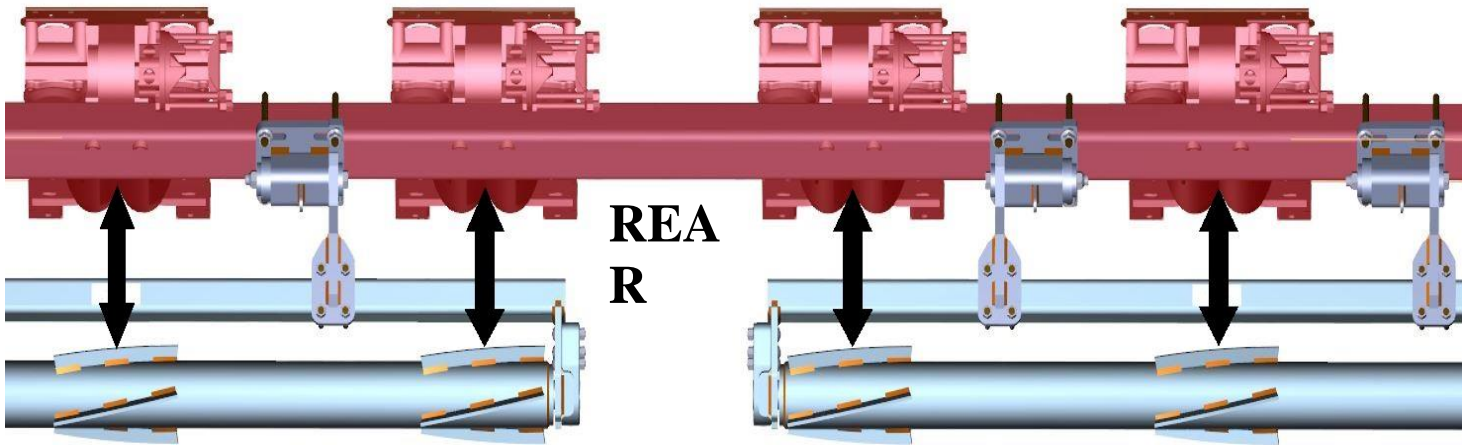

Step 6: (If Applicable) On chopping corn heads, trim 3 inches off the bottom of the back curtain to keep the roller from contacting the curtain.

NOTE: Make sure the chopping blades are sharp enough to size the residue into smaller pieces for better flow between the back curtain & roller mount tube.

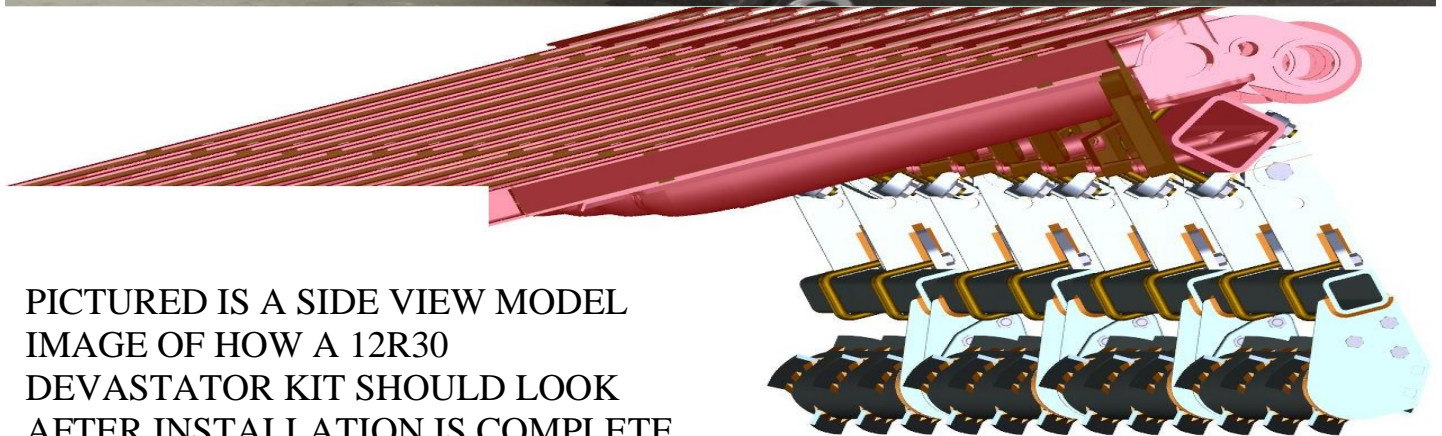

PICTURED IS A SIDE VIEW MODEL
IMAGE OF HOW A 12R30
DEVASTATOR KIT SHOULD LOOK
AFTER INSTALLATION IS COMPLETE

LOCK UP

To “lock up” Devastator rollers, lower head down & rotate the locking handle 90 degrees. If the handle is vertical, the devastator will be in operation mode. If the handle is horizontal & is in front of the pivot arm (see yellow circle below), the devastator is locked up. On torsion style devastators without the lock up feature, a 5000-430 Lock Pin can be ordered separately to lock up devastator rollers. 6 row heads require 1 lock pin, 8/12 row heads require 2, 18 row heads require 3.

Operating Position



Locked Up Position

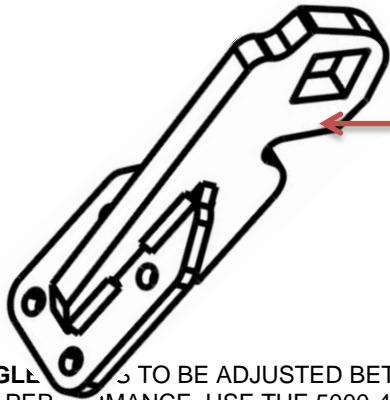

NOTE: The locking pin will slide into this notch when locked up.

OPERATION

CORN HEAD ANGLE IS TO BE ADJUSTED BETWEEN 22 – 25° FOR OPTIMUM DEVASTATOR PERFORMANCE. USE THE 5000-455 TO CHECK CORN HEAD ANGLE:

- Put the combine on a level surface. Lower corn head to your normal working head height. Place the magnetic protractor on the stripper plate to get the angle. Adjust the feeder house as needed, fore or aft, to achieve 22 – 25 degrees.



ADJUST SNOOT AS NEEDED WHEN SETTING THE CORRECT HEAD ANGLE

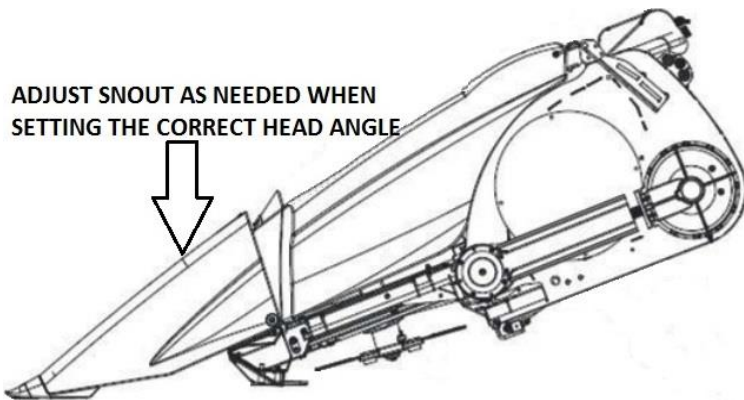

STORAGE/TRANSPORT

- Head cart may need adjusted to fit the head with devastator correctly. E.g. raising or fore/aft adjustment of saddles/top rail on the head cart.
- If head cart does not have these adjustments, adding a tube extension to top rail or adding extension to saddle/corn head may be required.
- Side to side tilt may need used to clear taller head cart tires or locking the devastator up.
- When disconnecting from the head, leaving pressure on the torsion pivot of the devastator will not damage the devastator.

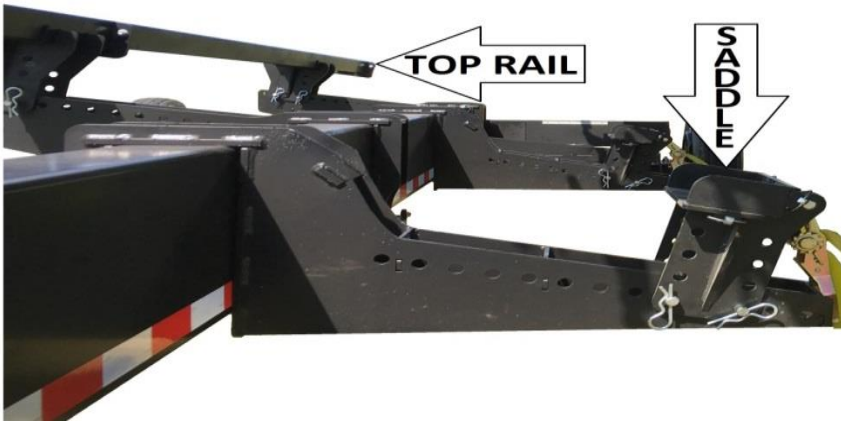

BEARING REPLACEMENT

Put the bearing housing in a vice, use a pry bar to turn the bearing in the housing parallel with the slots, remove the old bearing, apply anti-seize lubricant to the interior of the bearing housing, insert the new bearing in the slots, & use a pry bar to move back to position. Wobble the bearing around to help work the lubricant into the outer race of the bearing.

Anti-seize needs to be applied each year to the bearings to allow them wobble/pivot freely to extend service life.



5000-060C PART IDENTIFICATIONS

CASE 4406 6R30 DEVASTATOR

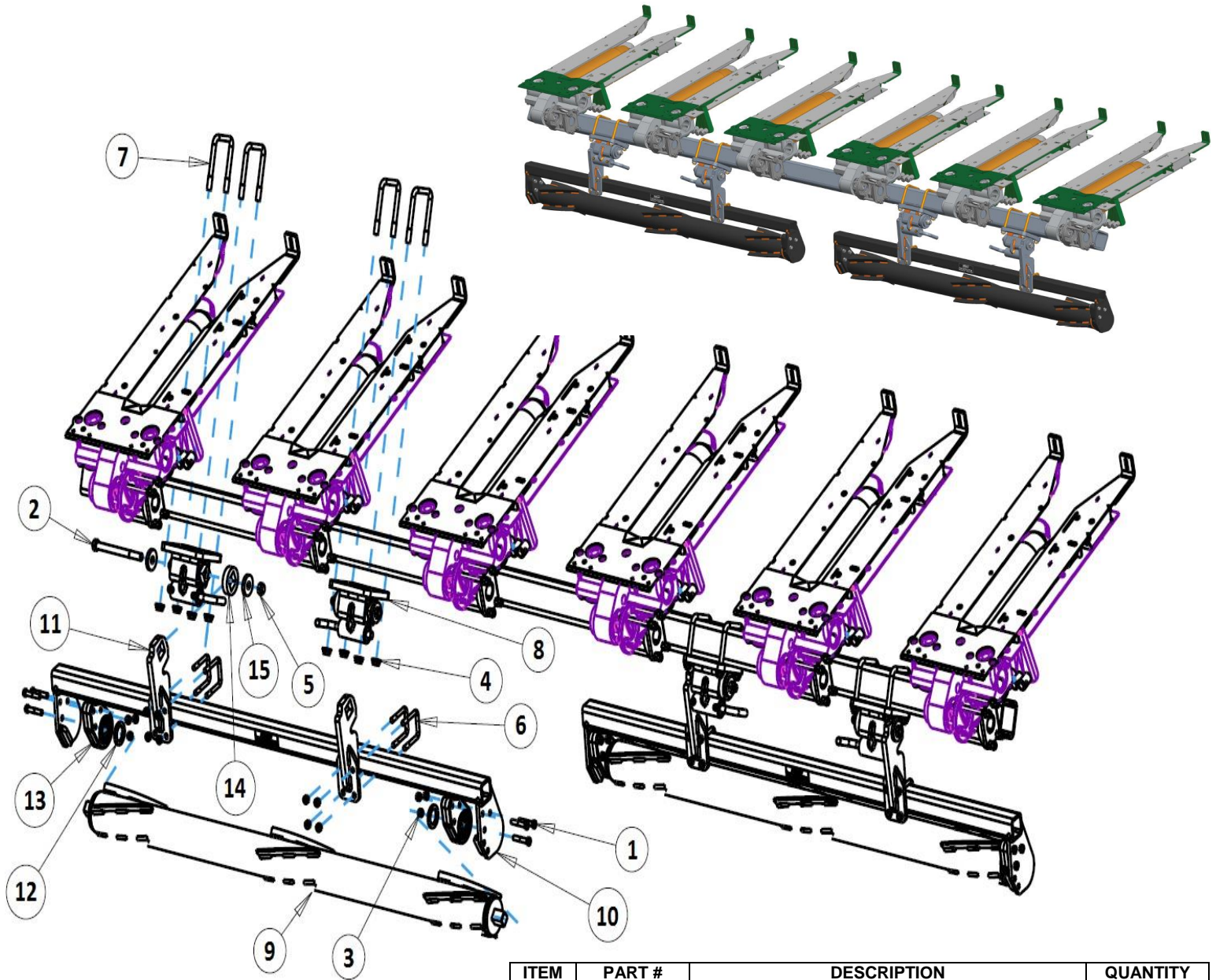

ITEM	PART #	DESCRIPTION	QUANTITY
1	2502-353	1/2 - 13 X 2 1/2 HHCS GR 8 ZP	12
2	2502-430	3/4 - 10 X 8 HHCS GR 8 ZP	4
3	2520-357	1/2-13 LOCK HEX NUT, GR A, ZP	28
4	2520-476	5/8 - 11 HEX FLANGE NUT	16
5	2520-604	3/4 - 10 HEX TOP LOCK NUT	4
6	2570-568	1/2 X 2 1/2 X 3 1/2 U-BOLT	8
7	2570-588	5/8 X 4 X 5 1/2 U-BOLT, ZYD	8
8	5000-187	LOCKING TORSION ASSEMBLY	4
9	5000-272	3R30 ROLLER W.A.	2
10	5000-275A	4R20/3R30 ROLLER MOUNT W.A.	2
11	5000-294A	TORSION ARM W.A., 10 DEG, CNH	4
12	5000-322	SHIM WASHER ZP	4
13	5000-355	BEARING ASSEMBLY	4
14	2550-059	DEVASTATOR BEARING (NO CAST HOUSING)	4
15	5000-468	SPACER	4
	5000-469	SECURITY CAP	8

5000-061C PART IDENTIFICATIONS

CASE 4408 8R30 DEVASTATOR

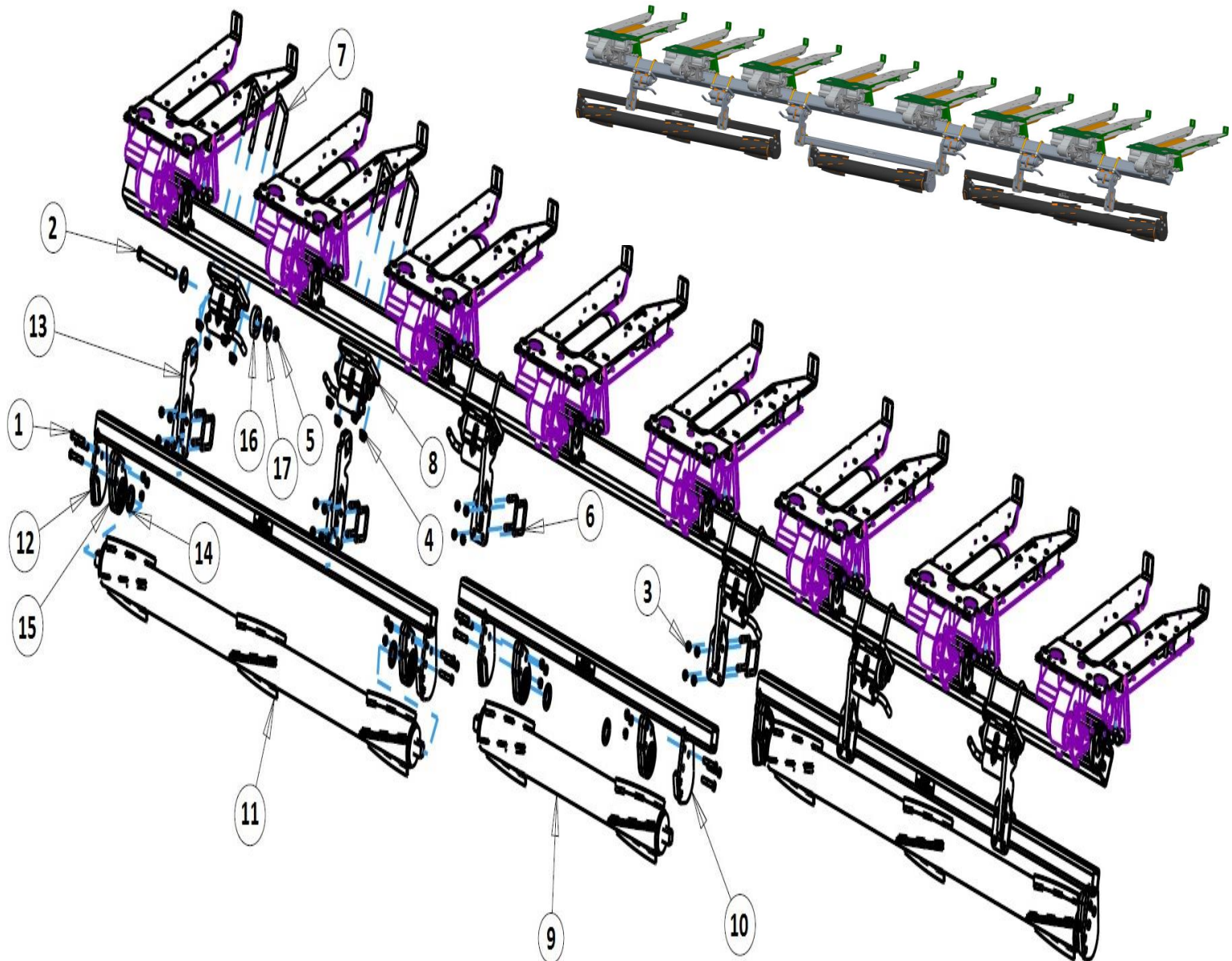

ITEM	PART #	DESCRIPTION	QTY
1	2502-353	1/2 - 13 X 2 1/2 HHCS GR 8 ZP	18
2	2502-430	3/4 - 10 X 8 HHCS GR 8 ZP	6
3	2520-357	1/2-13 LOCK HEX NUT, GR A, ZP	42
4	2520-476	5/8 - 11 HEX FLANGE NUT	24
5	2520-604	3/4 - 10 HEX TOP LOCK NUT	6
6	2570-568	1/2 X 2 1/2 X 3 1/2 U-BOLT	12
7	2570-588	5/8 X 4 X 5 1/2 U-BOLT. ZYD	12
8	5000-187	LOCKING TORSION ASSEMBLY	6
9	5000-268	2R30 ROLLER W.A.	1
10	5000-269A	2R30 ROLLER MOUNT W.A.	1
11	5000-272	3R30 ROLLER W.A.	2
12	5000-275A	4R20/3R30 ROLLER MOUNT W.A.	2
13	5000-294A	TORSION ARM W.A., 10 DEG, CNH	6
14	5000-322	SHIM WASHER ZP	6
15	5000-355	BEARING ASSEMBLY	6
	2550-059	BEARING ONLY (NO CAST HOUSING)	6
16	5000-468	SPACER	6
17	5000-469	SECURITY CAP	12

5000-062C PART IDENTIFICATION

CASE 4412 12R30 DEVASTATOR

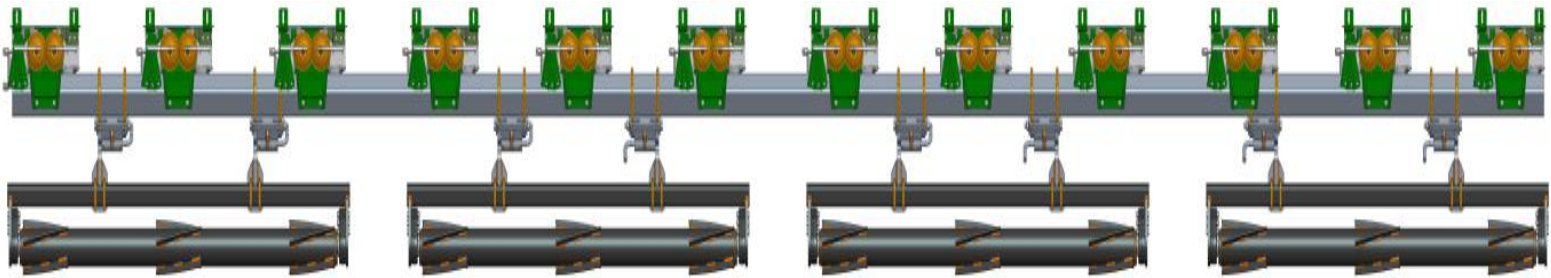

FRONT VIEW



LEFT HAND SIDE
ROWS 1 - 6

ITEM	PART #	DESCRIPTION	QTY
1	2502-353	1/2 - 13 X 2 1/2 HHCS GR 8 ZP	24
2	2502-430	3/4 - 10 X 8 HHCS GR 8 ZP	8
3	2520-357	1/2-13 LOCK HEX NUT, GR A, ZP	56
4	2520-476	5/8 - 11 X HEX FLANGE NUT	32
5	2520-604	3/4 - 10 HEX TOP LOCK NUT	8
6	2570-568	1/2 X 2 1/2 X 3 1/2 U-BOLT	16
7	2570-588	5/8 X 4 X 5 1/2 U-BOLT, ZYD	16
8	5000-187	LOCKING TORSION ASSEMBLY	8
9	5000-272	3R30 ROLLER W.A.	4
10	5000-275A	4R20/3R30 ROLLER MOUNT W.A.	4
11	5000-294A	TORSION ARM W.A., 10 DEG, CNH	8
12	5000-322	SHIM WASHER ZP	8
13	5000-355	BEARING ASSEMBLY	8
	2550-059	BEARING ONLY (NO CAST HOUSING)	8
14	5000-468	SPACER	8
15	5000-469	SECURITY CAP	16

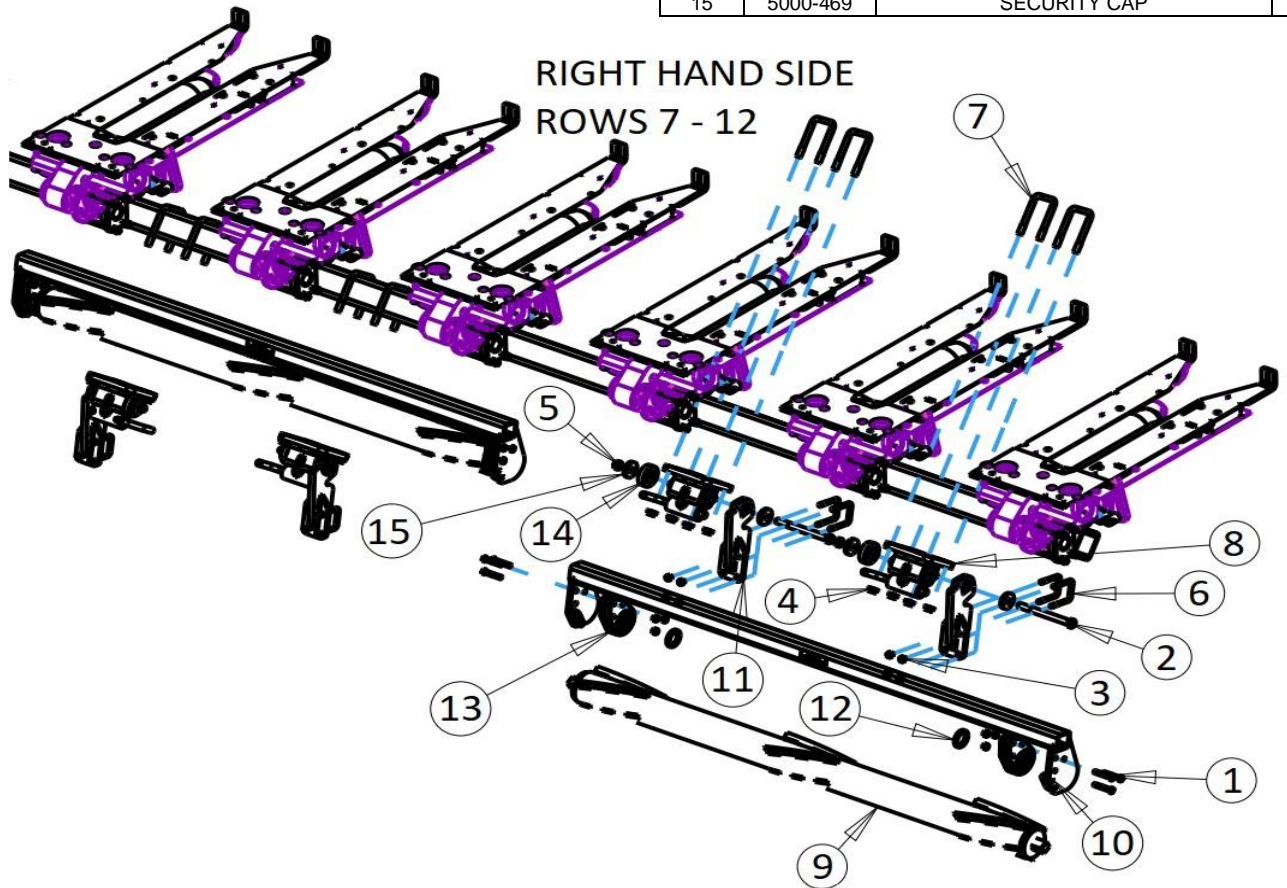

RIGHT HAND SIDE
ROWS 7 - 12

5000-063C PART IDENTIFICATION

CASE 4412 12R20 DEVASTATOR

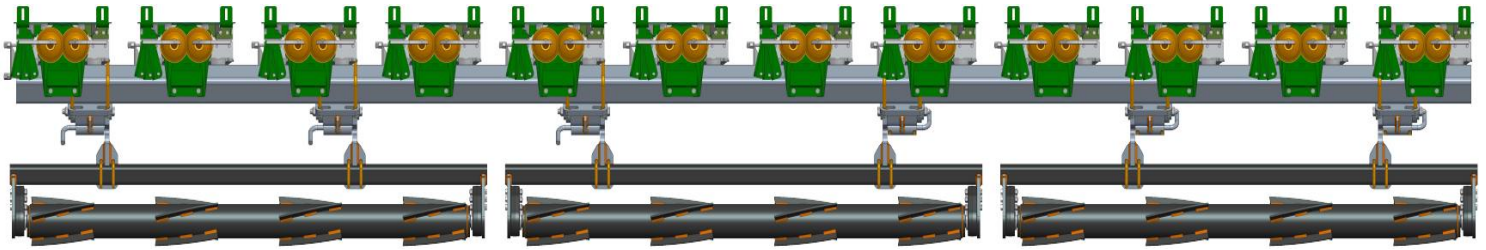

ITEM	PART #	DESCRIPTION	QTY
1	2502-353	1/2 - 13 X 2 1/2 HHCS GR 8 ZP	18
2	2502-430	3/4 - 10 X 8 HHCS GR 8 ZP	6
3	2520-357	1/2-13 LOCK HEX NUT, GR A, ZP	42
4	2520-476	5/8 - 11 X HEX FLANGE NUT	24
5	2520-604	3/4 - 10 HEX TOP LOCK NUT	6
6	2570-568	1/2 X 2 1/2 X 3 1/2 U-BOLT	12
7	2570-588	5/8 X 4 X 5 1/2 U-BOLT, ZYD	12
8	5000-167	TORSION PIVOT ASSEMBLY	6
9	5000-267	4R20 ROLLER W.A.	3
10	5000-275A	4R20/3R30 ROLLER MOUNT W.A.	3
11	5000-294	TORSION ARM W.A.	6
12	5000-322	SHIM WASHER ZP	6
13	5000-355	BEARING ASSEMBLY	6
	2550-059	DEVASTATOR BEARING (NO CAST HOUSING)	6
14	5000-468	SPACER	6
15	5000-469	SECURITY CAP	12

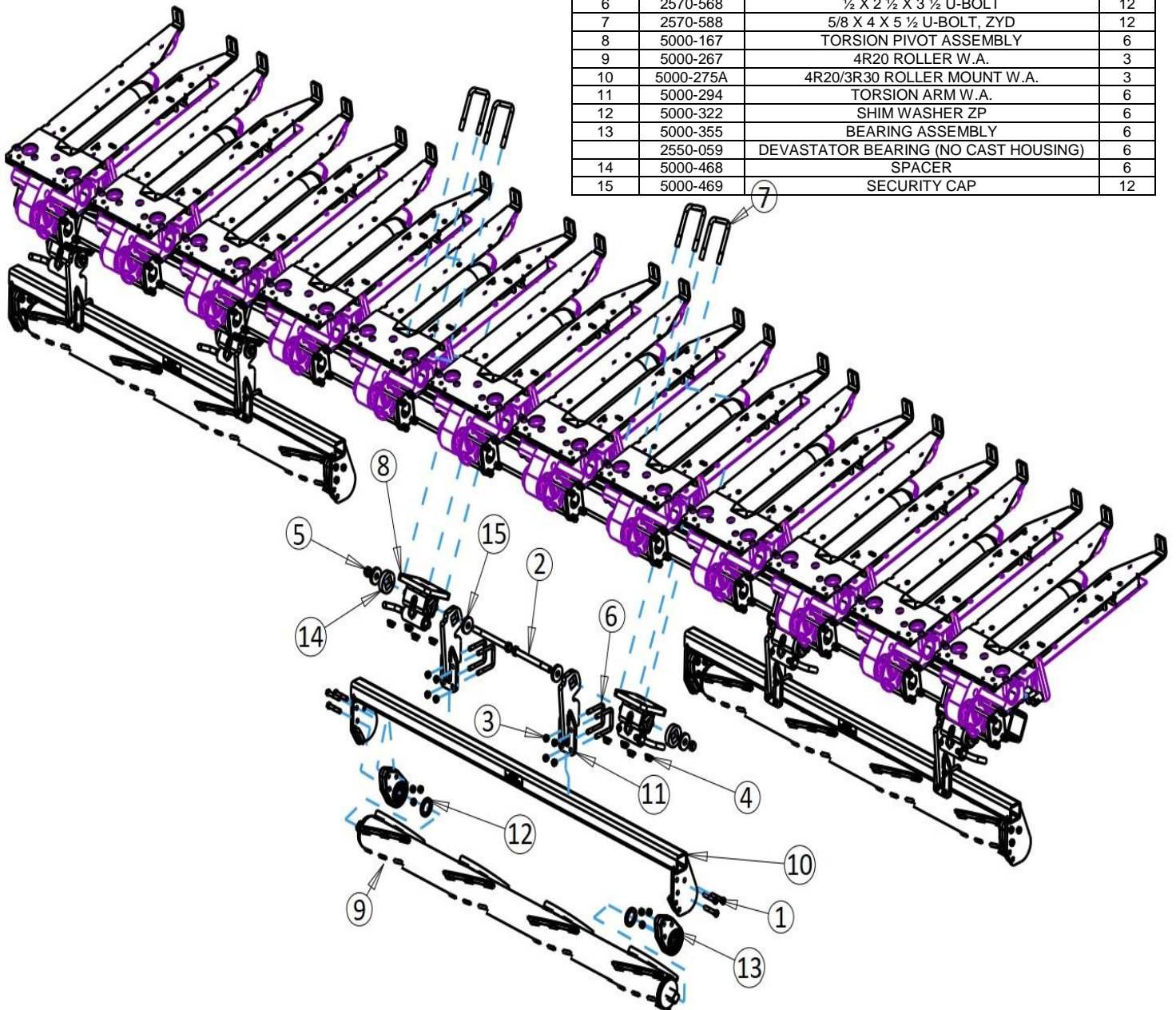

TROUBLESHOOTING

ISSUE	CAUSE	CORRECTIVE ACTION
Residue Plugging	<ol style="list-style-type: none"> 1. Incorrect Head Angle 2. Roller Mount Tube incorrectly installed 3. Pivot arm orientation incorrect 4. Bearing installed incorrectly 	<ol style="list-style-type: none"> 1. Adjust head angle to 22 – 25 degrees (see page 12) 2. Make sure the Bearing Support Tab is on the backside of the Roller Mount Tube 3. Reposition the pivot arm so that it offsets under the snout & not under the row 4. Make sure the side of the bearing that protrudes outside of the cast housing is facing AWAY from the bearing plate (each roller should spin freely by hand)
Stalk aren't "devastated"	<ol style="list-style-type: none"> 1. Operating corn head too high 	<ol style="list-style-type: none"> 1. Lower corn head until the rollers engage
Corn Head won't fit on head cart	<ol style="list-style-type: none"> 1. Devastators bottom out 2. Storage stands don't rest in the saddles on the cart 	<ol style="list-style-type: none"> 1. Adjust top rail & saddles higher on cart 2. Make Stand Extensions for Saddle Extensions for head cart







A Tradition of Solutions since 1930

Yetter Farm Equipment Co

PO BOX 358 109 S. McDonough

Colchester, IL 62326-0358

Phone: 309-776-4111

Toll Free: 800-447-5777

Email: info@yetterco.com

For updated models and manuals visit the Yetter website:

www.yetterco.com

© Yetter Farm Equipment Co. All Rights Reserved

2565-970_REV_C • 08/2024