



2968-090 Rear Knife Kit

OWNER'S MANUAL
PART IDENTIFICATION
2565-966 02/2019



YETTER MANUFACTURING CO.

Founded 1930

Colchester, IL 62326

Toll free: (800)447-5777.

Fax: (309)776-3222

Website: yetterco.com

E-mail: info@yetterco.com

YETTER

TABLE OF CONTENTS

BOLT TORQUE..... 2
FOREWORD..... 3
SAFETY..... 4
PICTORIAL PART LIST..... 5 – 6
INSTALLATION..... 7 – 9
OPERATION..... 10 – 11
PARTS IDENTIFICATION..... 12 – 13

BOLT TORQUE







Important: Over-tightening hardware can cause just as much damage as under-tightening. Tightening hardware beyond the recommended range can reduce its shock load capacity.

All hardware is either Grade 5 unless otherwise noted. Grade 5 cap screws are marked with three radial lines on the head. Grade 8 cap screws are marked with six radial lines on the head. If hardware must be replaced, be sure to replace it with hardware of equal size, strength and thread type. Refer to the torque values chart when tightening hardware.

The chart below is a guide for proper torque. Use it unless a specified torque is called out elsewhere in the manual. Torque is the force applied to the end of the handle or cheater bar, times the length of the handle or bar. Tightening hardware beyond the recommended range can reduce its shock load capacity.

Use a torque wrench wherever possible

The following table shows torque in ft.-lbs. for coarse thread hardware.

Bolt Diameter and Threads per Inch	 Grade 2	 Grade 5	 A-325	 Grade 8
1/4	6		10	14
5/16	12		20	30
3/8 – 16	25		35	50
7/16 – 14	35		55	80
1/2 – 13	55		85	125
9/16 – 12	75		125	175
5/8 – 11	105		170	235
3/4-10	185		305	425
7/8 – 9	170		445	690
1-8	260		670	1030
1 1/8 – 7	365		900	1460
1 1/4 - 7	515		1275	2060
1 3/8 – 6	675		1675	2700
1 1/2 - 6	900		2150	3500
1 3/4 – 5	1410		3500	5600

FOREWORD

You've just joined an exclusive but rapidly growing club.

For our part, we want to welcome you to the group and thank you for buying a Yetter product.

We hope your new Yetter products will help you achieve both goals-increase your productivity and increase your efficiency so that you may generate more profit.

This operator's manual has been designed into four major sections: Foreword, Safety Precautions, Installation Instructions and Parts Breakdown.



This **SAFETY ALERT SYMBOL** indicates important safety messages in the manual. When you see this symbol, be alert to the possibility of **PERSONAL INJURY** and carefully read the message that follows.

The word **NOTE** is used to convey information that is out of context with the manual text. It contains special information such as specifications, techniques and reference information of a supplementary nature.

The word **IMPORTANT** is used in the text when immediate damage will occur to the machine due to improper technique or operation.

Important will apply to the same information as specified by note only of an immediate and urgent nature.

It is the responsibility of the user to read the operator's manual and comply with the safe and correct operating procedure and to lubricate and maintain the product according to the maintenance schedule in the operator's manual.

The user is responsible for inspecting his machine and for having parts repaired or replaced when continued use of the product would cause damage or excessive wear to the other parts.

It is the user's responsibility to deliver his machine to the Yetter dealer who sold him the product for service or replacement of defective parts, which are covered by the warranty policy.

If you are unable to understand or follow the instructions provided in this publication, consult your local Yetter dealer or contact:

YETTER MANUFACTURING CO.

309/776-4111

800/447-5777

309/776-3222 (FAX)

Website: www.yetterco.com

E-mail: info@yetterco.com

WARRANTY

Yetter Manufacturing warrants all products manufactured and sold by it against defects in material. This warranty being expressly limited to replacement at the factory of such parts or products as shall appear to be defective after inspection. This warranty does not obligate the Company to bear cost of labor in replacement of parts. It is the policy of the Company to make improvements without incurring obligations to add them to any unit already sold. No warranty is made or authorized to be made, other than herein set forth. This warranty is in effect for one year after purchase.

DEALER: _____

Yetter Manufacturing warrants its own products only and cannot be responsible for damages to equipment on which mounted.

BE ALERT!

YOUR SAFETY IS INVOLVED



WATCH FOR THIS SYMBOL. IT POINTS OUT IMPORTANT SAFETY PRECAUTIONS. IT MEANS “ATTENTION – BE ALERT!”

It is your responsibility as an owner, operator, or supervision to know and instruct everyone using this machine at the time of initial assignment and at least annually thereafter, of the proper operation, precautions, and work hazards which exist in the operation of the machine in accordance with OSHA regulations.

Safety Is No Accident



The following safety instructions, combined with common sense, will save your equipment from needless damage and the operator from unnecessary exposure to personal hazard. Pay special attention to the caution notes in the text. Review this manual at least once a year with all operators.

1. Read and understand the operator's manual before operating this machine. Failure to do so is considered a misuse of the equipment.
2. Make sure equipment is secure before operating.
3. Always keep children away from equipment when operating.
4. Make sure everyone that is not directly involved with the operation is out of the work area before beginning operation.
5. Make sure all safety devices, shields, and guards are in place and functional before beginning operation
6. Shut off all power to adjust, service, or clean.
7. Keep hands, feet, and clothing away from moving parts. It is a good idea to remove all jewelry before operating.
8. Inspect the machine periodically during operation for signs of excessive wear, loose fasteners, and unusual noises.

2968-090-L Pictorial Parts List

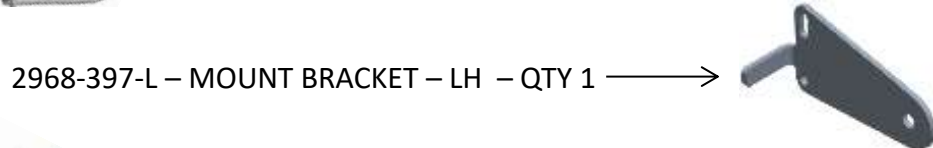
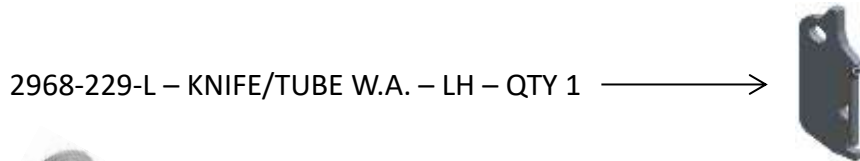
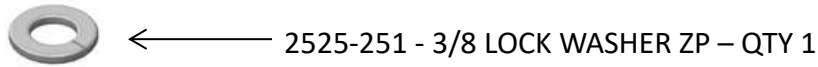
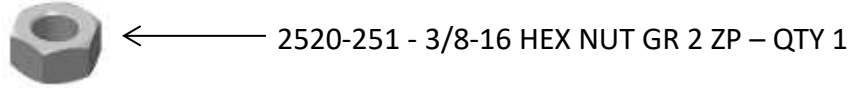
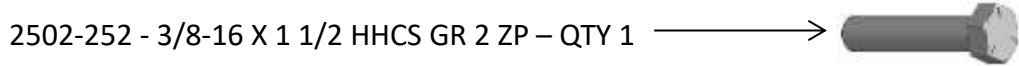
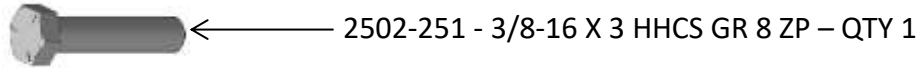

2968-090-R Pictorial Parts List

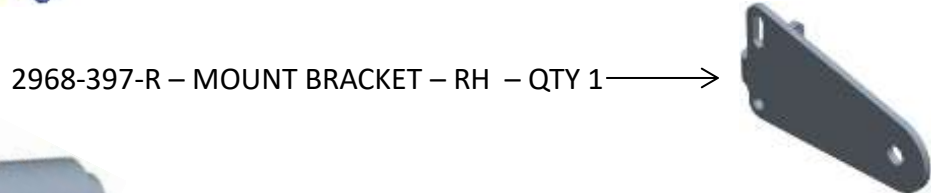
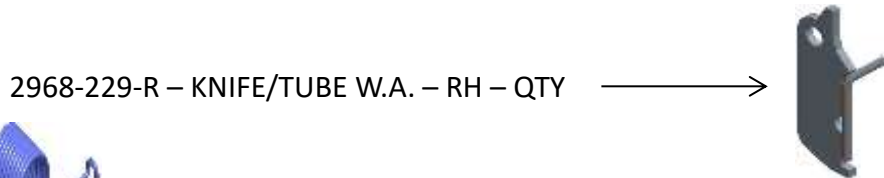
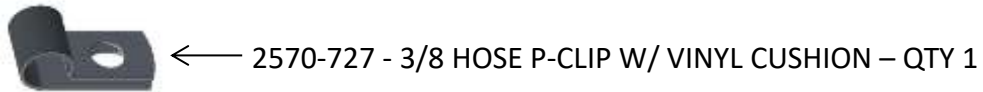
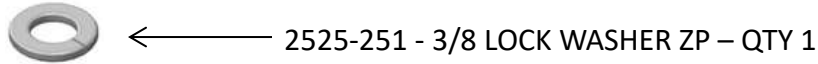
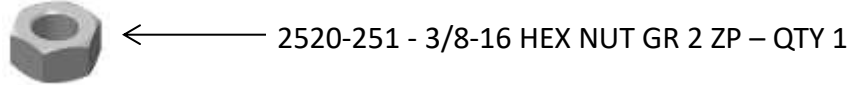
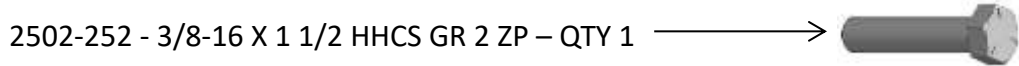
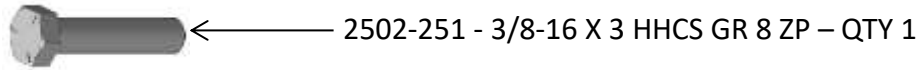

INSTALLATION INSTRUCTIONS

STEP 1: The Yetter Rear Knife Kit works on 2968 models that are 2017 & newer. For field installation, remove the injector holder & hardware from the slotted hole on the fertilizer wheel L mount bracket. The Yetter 2968 blade(s) will also need removed. If installing all new product, skip to **STEP 2**.

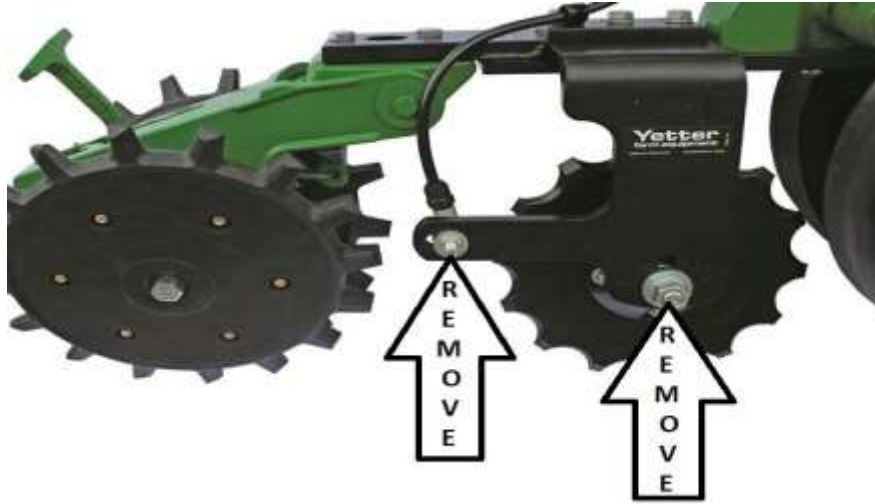

STEP 2: Install the fertilizer wheel into the D-Bolt hole (see page 10 for depth setting chart) so that the blade is on the inside of the fertilizer wheel L mount bracket. Place the larger hole on the 2968-397 mount bracket over the D-Bolt and thread the 5/8 flange whizlock nut on by hand, do not tighten yet.



LEFT HAND SHOWN BELOW



STEP 3: Install the 3/8 X 3 Bolt, 3/8 Flat Washer, P Clip through the vertically slotted hole on the 2968-397 and then through the horizontally slotted hole on the fertilizer mount plate. Install a 3/8 flat washer & 3/8 lock washer on the bolt against the inside of the fertilizer mount plate & hand tighten the 3/8 hex nut.

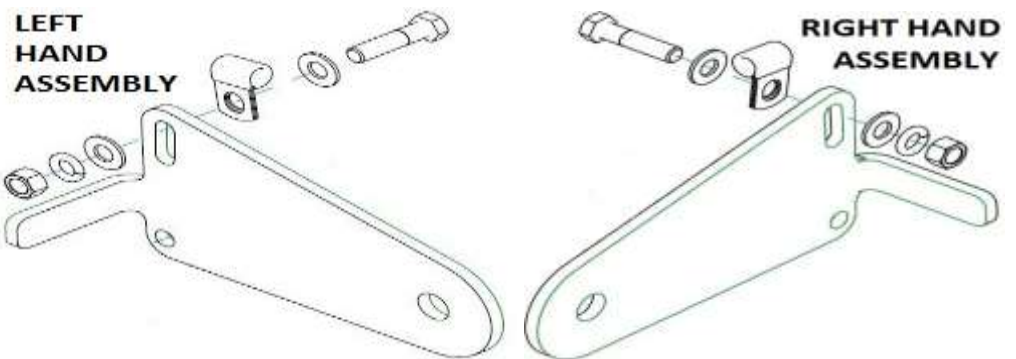

INSTALLATION INSTRUCTIONS

STEP 4: Tighten the hardware from **STEP 1 – 3**. Position the depth of the knife assembly in relationship to where the depth of the fertilizer wheel assembly is placed. Use the diagram at the bottom of this page as a guide to set the position of the knife. For example, if the fertilizer wheel is set at the deepest setting (setting 1), the fertilizer knife should also be in the deepest setting (setting 1).

NOTE: Make sure the knife is centered behind the blade. Use washers to shim the knife if necessary. Failure to center the knife to the blade will increase wear on 1 or both sides of the knife & shorten the service life.

LEFT HAND ASSEMBLY

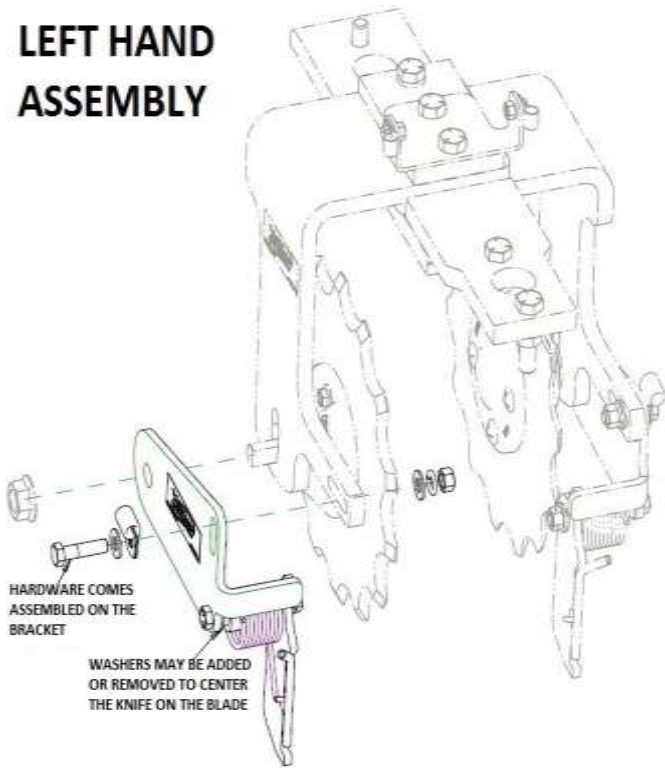

RIGHT HAND ASSEMBLY

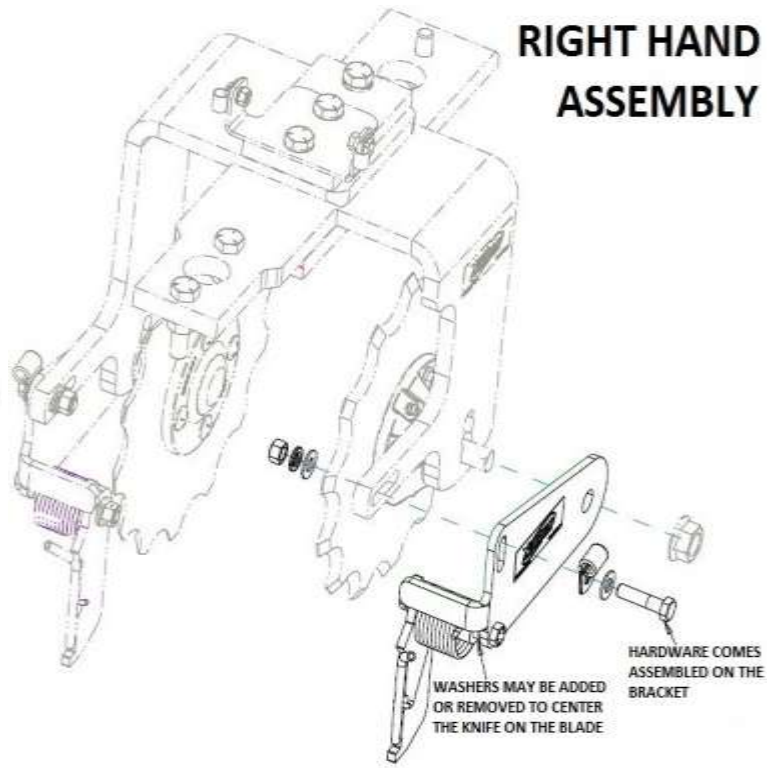

FERTILIZER KNIFE MOUNT BRACKET

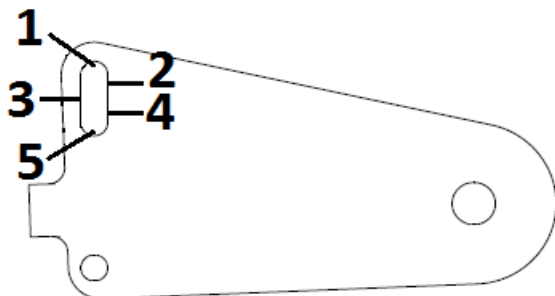

FERTILIZER WHEEL MOUNT BRACKET

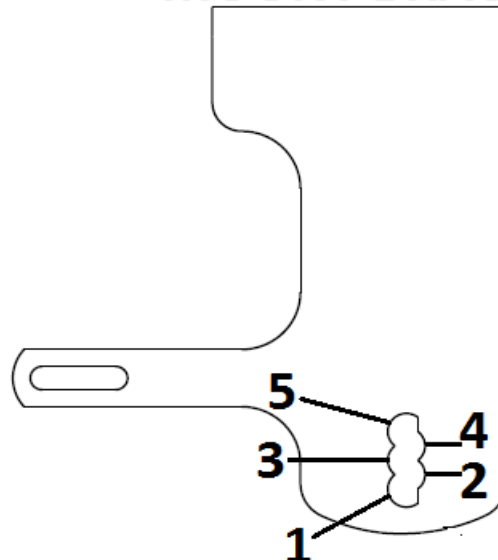

INSTALLATION INSTRUCTIONS

STEP 5: Adjust the fertilizer wheel assembly away from the seed furrow. It is recommended to adjust the fertilizer wheel L mount brackets in the setting furthest from the seed furrow to gain more clearance between the knife assembly & the closing wheels. Running the fertilizer wheel L mount brackets in the setting closest to the seed furrow is possible, but contact between the closing wheels & knife could happen.

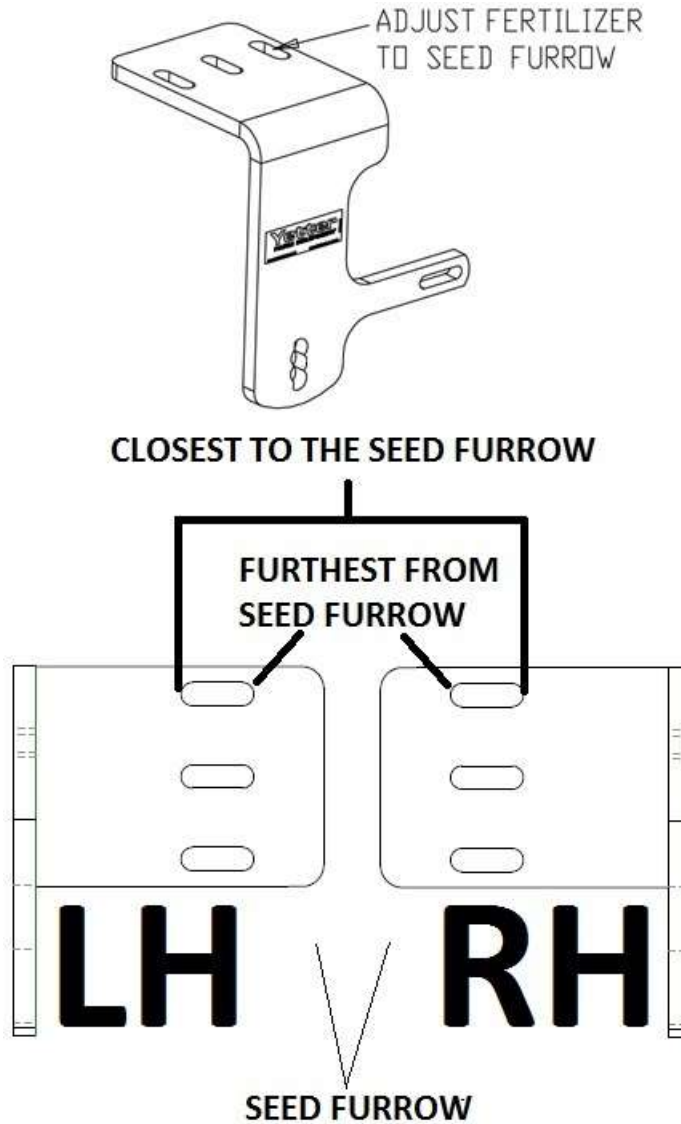

STEP 6: Route the fertilizer hose through the P-Clip and attach it to the knife tube. The outside diameter of the knife tube is $\frac{1}{4}$ ". No tubing clamp/fastener is provided.

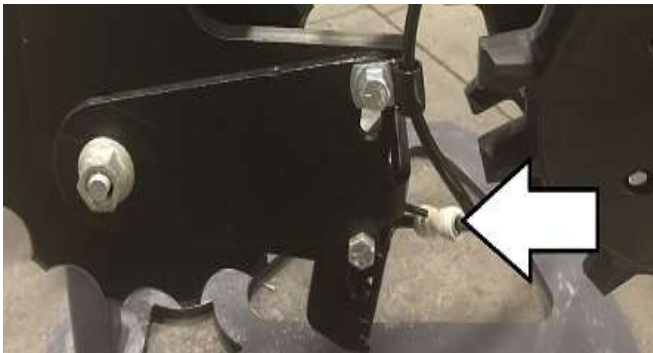

OPERATION

The 2968-398 Stepped Bushing has a reversible design. When one end is wore down from the pivoting action of the knife, flip the bushing end for end.

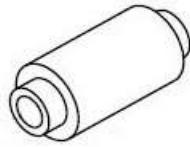

FERTILIZER WHEEL MOUNT BRACKET

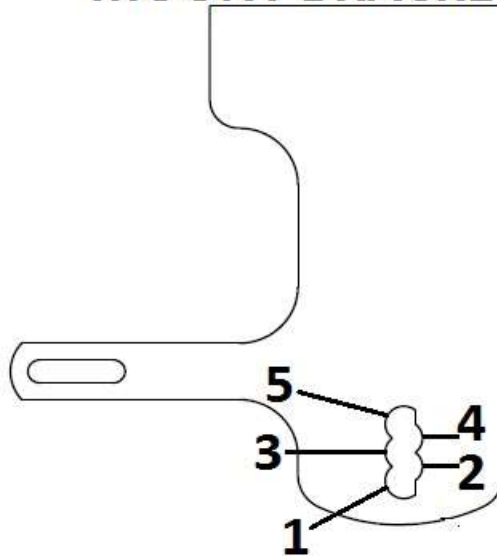

<u>POSITION</u>	<u>DEPTH (USING 10" NOTCHED BLADE)</u>
1	$\frac{3}{4}$ " BELOW DOUBLE DISC OPENERS
2	$\frac{1}{2}$ " BELOW DOUBLE DISC OPENERS
3	$\frac{1}{4}$ " BELOW DOUBLE DISC OPENERS
4	EVEN WITH DOUBLE DISC OPENERS
5	$\frac{1}{4}$ " ABOVE DOUBLE DISC OPENERS

<u>POSITION</u>	<u>DEPTH (USING 11" NOTCHED BLADE)</u>
1	1 $\frac{1}{4}$ " BELOW DOUBLE DISC OPENERS
2	1" BELOW DOUBLE DISC OPENERS
3	$\frac{3}{4}$ " BELOW DOUBLE DISC OPENERS
4	$\frac{1}{2}$ " BELOW DOUBLE DISC OPENERS
5	$\frac{1}{4}$ " BELOW DOUBLE DISC OPENERS

FOR MORE INFORMATION, SEE THE 2968 ROW UNIT MID-MOUNT FERTILIZER OPENER MANUAL

OPERATION

LIQUID FERTILIZER APPLICATION RATE AND PRESSURE CHART TABLES ARE BASED ON 30" NOZZLE SPACING

TIP #	LIQUID PRESSURE IN PSI	CAPACITY 1 NOZZLE IN GPM	GALLONS PER ACRE (USING WATER)					
			4 MPH H2O	5 MPH H2O	5.5 MPH H2O	6 MPH H2O	7 MPH H2O	8 MPH H2O
#00015	20	0.11	5.45	4.36	3.96	3.63	3.11	2.72
	25	0.12	5.94	4.75	4.32	3.96	3.39	2.97
	30	0.13	6.44	5.15	4.68	4.29	3.68	3.22
	40	0.15	7.43	5.94	5.40	4.95	4.24	3.71
	50	0.17	8.42	6.73	6.12	5.61	4.81	4.21
	60	0.18	8.91	7.13	6.48	5.94	5.09	4.46
#0002	20	0.14	6.93	5.54	5.04	4.62	3.96	3.47
	25	0.16	7.92	6.34	5.76	5.28	4.53	3.96
	30	0.17	8.42	6.73	6.12	5.61	4.81	4.21
	40	0.20	9.90	7.92	7.20	6.60	5.66	4.95
	50	0.23	11.39	9.11	8.28	7.59	6.51	5.69
	60	0.25	12.38	9.90	9.00	8.25	7.07	6.19
#0003	20	0.21	10.40	8.32	7.56	6.93	5.94	5.20
	25	0.24	11.88	9.50	8.64	7.92	6.79	5.94
	30	0.26	12.87	10.30	9.36	8.58	7.35	6.44
	40	0.30	14.85	11.88	10.80	9.90	8.49	7.43
	50	0.34	16.83	13.46	12.24	11.22	9.62	8.42
	60	0.37	18.32	14.65	13.32	12.21	10.47	9.16
#0004	20	0.28	13.86	11.09	10.08	9.24	7.92	6.93
	25	0.32	15.84	12.67	11.52	10.56	9.05	7.92
	30	0.35	17.33	13.86	12.60	11.55	9.90	8.66
	40	0.40	19.80	15.84	14.40	13.20	11.31	9.90
	50	0.45	22.28	17.82	16.20	14.85	12.73	11.14
	60	0.49	24.26	19.40	17.64	16.17	13.86	12.13
#0005	20	0.35	17.33	13.86	12.60	11.55	9.90	8.66
	25	0.40	19.80	15.84	14.40	13.20	11.31	9.90
	30	0.43	21.29	17.03	15.48	14.19	12.16	10.64
	40	0.50	24.75	19.80	18.00	16.50	14.14	12.38
	50	0.56	27.72	22.18	20.16	18.48	15.84	13.66
	60	0.61	30.20	24.16	21.96	20.13	17.25	15.10
#0006	20	0.42	20.79	16.63	15.12	13.86	11.88	10.40
	25	0.47	23.27	18.61	16.92	15.51	13.29	11.63
	30	0.52	25.74	20.59	18.72	17.16	14.71	12.87
	40	0.60	29.70	23.76	21.60	19.80	16.97	14.85
	50	0.67	33.17	26.53	24.12	22.11	18.95	16.58
	60	0.74	36.63	29.30	26.64	24.42	20.93	18.32
#0008	20	0.57	28.22	22.57	20.52	18.81	16.12	14.11
	25	0.63	31.19	24.95	22.68	20.79	17.82	15.59
	30	0.69	34.16	27.32	24.84	22.77	19.52	17.08
	40	0.80	39.60	31.68	28.80	26.40	22.63	19.80
	50	0.89	44.06	35.24	32.04	29.37	25.17	22.03
	60	0.98	48.51	38.81	35.28	32.34	27.72	24.26
#0010	20	0.71	35.15	28.12	25.56	23.43	20.08	17.57
	25	0.79	39.11	31.28	28.44	26.07	22.35	19.55
	30	0.87	43.07	34.45	31.32	28.71	24.61	21.53
	40	1.00	49.50	39.60	36.00	33.00	28.29	24.75
	50	1.12	55.44	44.35	40.32	36.96	31.68	27.72
	60	1.23	60.89	48.71	44.28	40.59	34.79	30.44
#0015	20	1.06	52.47	41.98	38.16	34.98	29.98	26.24
	25	1.19	58.91	47.12	42.84	39.27	33.66	29.45
	30	1.30	64.35	51.48	46.80	42.90	36.77	32.18
	40	1.50	74.25	59.40	54.00	49.50	42.43	37.13
	50	1.68	83.16	66.53	60.48	55.44	47.52	41.58
	60	1.81	89.60	71.68	65.16	59.73	51.20	44.80
ROW SPACING MULTIPLIER		10" X 3.3	15" X 2.0	18" X 1.66	20" X 1.5	36" X .83	38" X .79	40" X .75

Values in this chart area based on using water. To calculate nozzle size required for your fertilizer application, the weight of the fertilizer solution must be accounted for by using a conversion factor for specific gravity. The Conversion factor for 28% liquid nitrogen is 1.13. Example: desired rate of application is 10 GPA of 28% N multiply 10 gallons per acre of fertilizer you want to apply x the conversion factor for 28% N (1.13) to get an equivalent rate for water. 10 x 1.13 refers to the chart for 11.13 gallons per acre at your desired speed/MPH.

GPA (Per Nozzle) = $\frac{5940 \times \text{GPM}}{\text{MPH} \times \text{W}}$

H2O = WATER
GPA = GALLON PER ACRE
GPM = GALLON PER MINUTES
MPH = MILES PER HOUR
W = WIDTH

SOLUTION
28% = H2O/1.13
32% = H2O/1.15

This table is a reference only. Please calibrate your equipment to insure proper rate of application.

The information contained in this issue is offered in good faith by Yetter Mfg. Co. to further the understanding of liquid fertilizer application.

However, the use of the information provided is beyond the control of Yetter Mfg. Co. and in no case shall Yetter Mfg. Co. or any seller of its products be responsible for any damages that may occur from the use of this information.

2968-090-L PART IDENTIFICATION

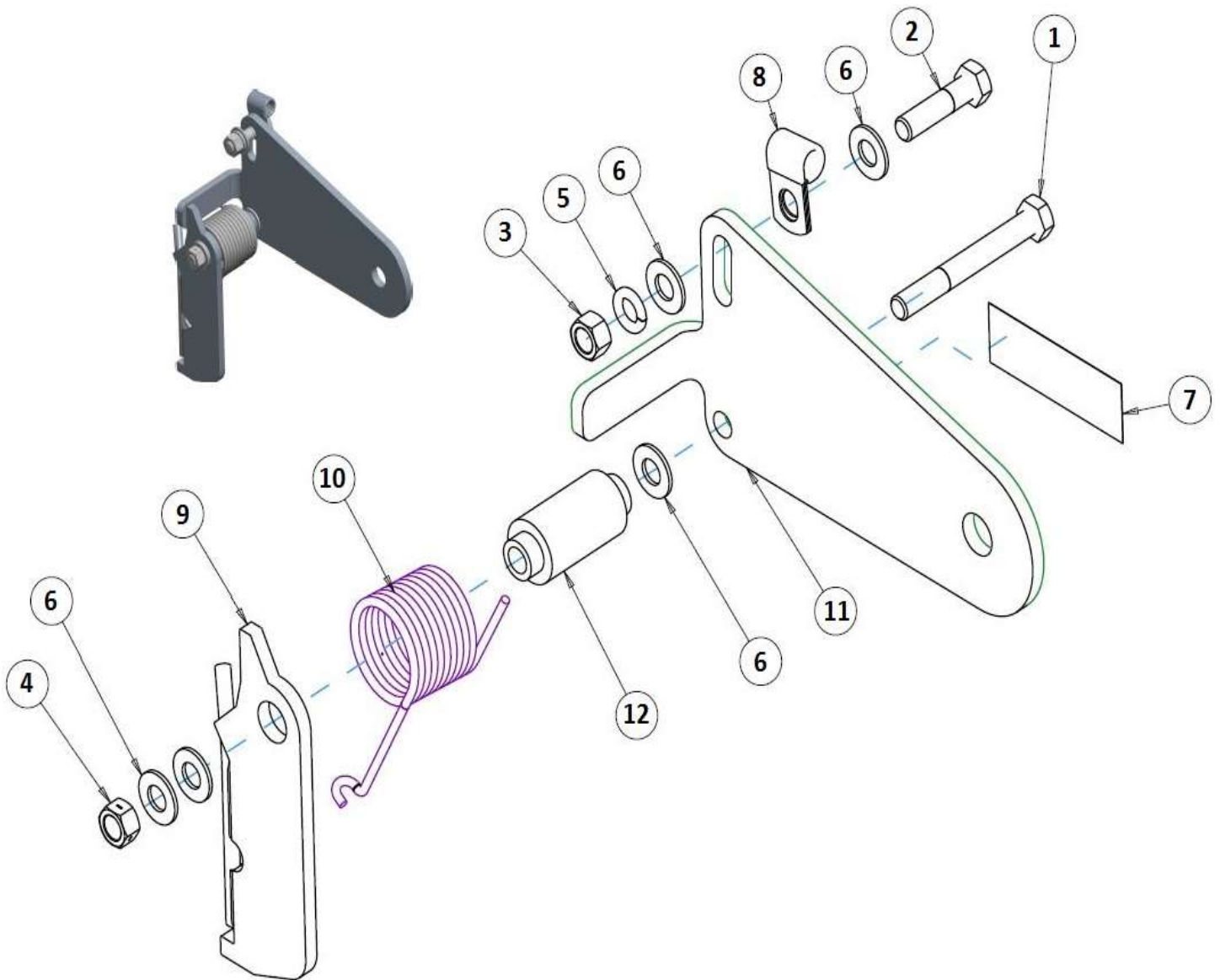

<u>ITEM</u>	<u>PART #</u>	<u>DESCRIPTION</u>	<u>QTY</u>
1	2502-251	3/8 – 16 X 3" HHCS GR 8 ZP	1
2	2502-252	3/8 – 16 X 1 1/2" HHCS GR 2 ZP	1
3	2520-251	3/8 – 16 HEX NUT ZP	1
4	2520-255	3/8 – 16 LOCK HEX NUT, GR A, ZP	1
5	2525-251	3/8 LOCK WASHER ZP	1
6	2526-253	3/8 SAE FLAT WASHER ZP	5
7	2565-179	YETTER DECAL	1
8	2570-727	3/8 HOSE P-CLIP WITH VINYL CUSHION	1
9	2968-229-L	KNIFE – TUBE W.A. – LH	1
10	2968-396-L	TORSION SPRING – LH WOUND	1
11	2968-397-L	MOUNT BRACKET – LH	1
12	2968-398	STEPPED BUSHING 1.00 X 2.25	1

2968-090-R PART IDENTIFICATION

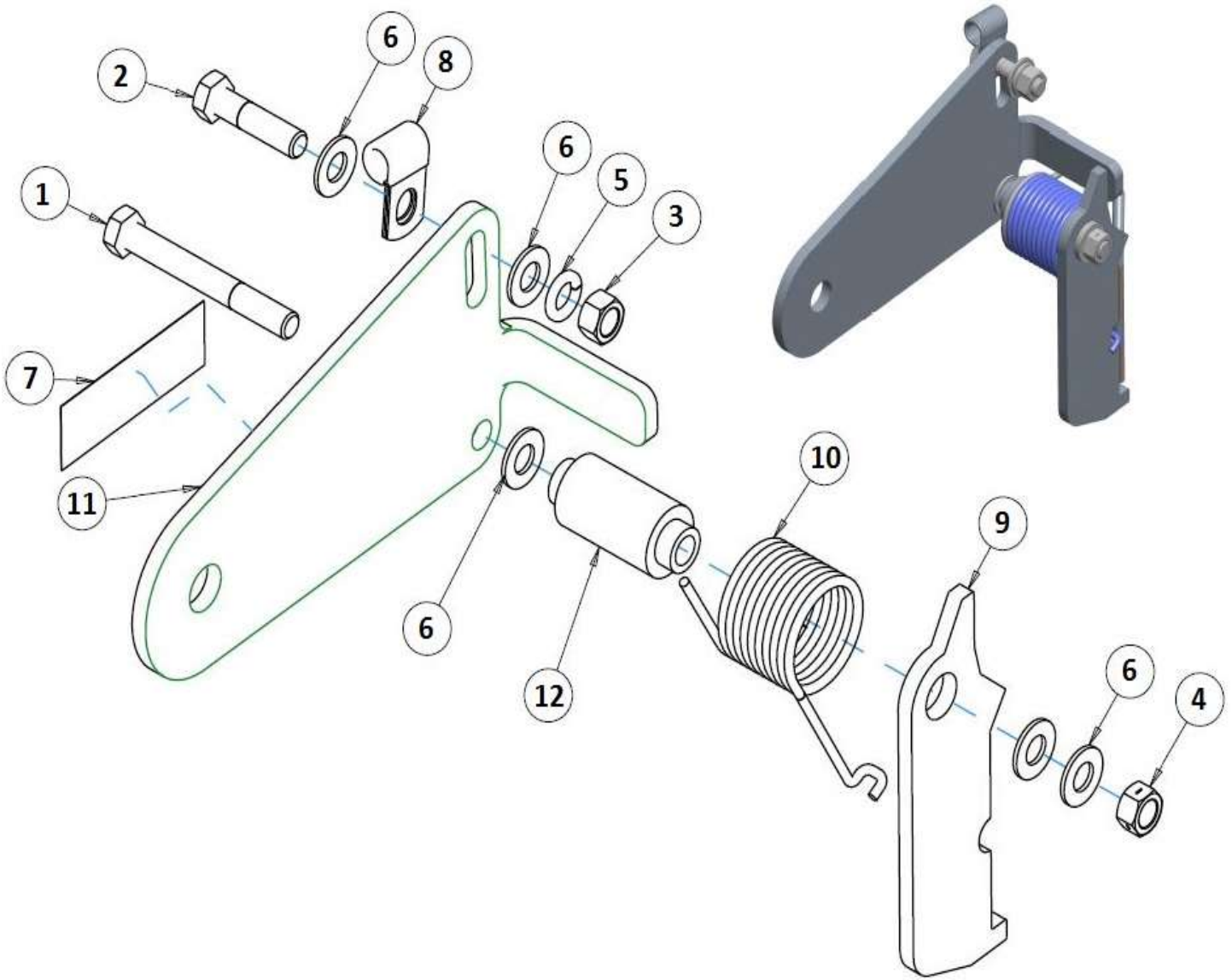

ITEM	PART #	DESCRIPTION	QTY
1	2502-251	3/8 – 16 X 3" HHCS GR 8 ZP	1
2	2502-252	3/8 – 16 X 1 1/2" HHCS GR 2 ZP	1
3	2520-251	3/8 – 16 HEX NUT ZP	1
4	2520-255	3/8 – 16 LOCK HEX NUT, GR A, ZP	1
5	2525-251	3/8 LOCK WASHER ZP	1
6	2526-253	3/8 SAE FLAT WASHER ZP	5
7	2565-179	YETTER DECAL	1
8	2570-727	3/8 HOSE P-CLIP WITH VINYL CUSHION	1
9	2968-229-R	KNIFE – TUBE W.A. – RH	1
10	2968-396-R	TORSION SPRING – RH WOUND	1
11	2968-397-R	MOUNT BRACKET – RH	1
12	2968-398	STEPPED BUSHING 1.00 X 2.25	1



NOTES:





A Tradition of Solutions since 1930

Yetter Farm Equipment Co

PO BOX 358 109 S. McDonough

Colchester, IL 62326-0358

Phone: 309-776-4111

Toll Free: 800-447-5777

Email: info@yetterco.com

For updated models and manuals visit the Yetter website:

www.yetterco.com

© Yetter Farm Equipment Co. All Rights Reserved

2565-966 – 02/2019