



**2966-001**  
**RESIDUE MANAGER**  
**FOR 60/90 AIR DRILL OPENER**

**OPERATOR'S MANUAL**  
**PART IDENTIFICATION**



2565-739\_REV\_B • 08/2024

**YETTER MANUFACTURING CO.**  
*FOUNDED 1930*

Colchester, IL 62326-0358  
Toll free: 800/447-5777  
309/776-3222 (Fax)  
Website: [www.yetterco.com](http://www.yetterco.com)  
E-mail: [info@yetterco.com](mailto:info@yetterco.com)

**YETTER**

# FOREWORD

You've just joined an exclusive but rapidly growing club.

For our part, we want to welcome you to the group and thank you for buying a Yetter product.

We hope your new Yetter products will help you achieve both goals-increase your productivity and increase your efficiency so that you may generate more profit.

This operator's manual has been designed into four major sections: Foreword, Safety Precautions, Installation Instructions and Parts Breakdown.

This **SAFETY ALERT SYMBOL** indicates important safety messages in the manual. When you see this symbol, be alert to the possibility of **PERSONAL INJURY** and carefully read the message that follows.



**DANGER:** Indicates an imminently hazardous situation which, if not avoided "will" result in death or serious injury. This signal word is to be limited to the most extreme situations



**WARNING:** Indicates a potentially hazardous situation which, if not avoided, "could" result in death or serious injury.



**CAUTION:** Indicates a potentially hazardous situation, which if not avoided, "may" result in minor or moderate injury. It may also be used to alert against unsafe practices.



**NOTICE:** Indicates information considered important, but not hazard related (e.g., messages relating to property damage).

It is the responsibility of the user to read the operator's manual and comply with the safe and correct operating procedure and to lubricate and maintain the product according to the maintenance schedule in the operator's manual.

The user is responsible for inspecting his machine and for having parts repaired or replaced when continued use of the product would cause damage or excessive wear to the other parts.

It is the user's responsibility to deliver his machine to the Yetter dealer who sold him the product for service or replacement of defective parts, which are covered by the warranty policy.

If you are unable to understand or follow the instructions provided in this publication, consult your local Yetter dealer or contact:

## YETTER MANUFACTURING CO.

309/776-4111

800/447-5777

309/776-3222 (FAX)

Website: [www.yetterco.com](http://www.yetterco.com)

E-mail: [info@yetterco.com](mailto:info@yetterco.com)

# WARRANTY

Yetter Manufacturing warrants all products manufactured and sold by it against defects in material. This warranty being expressly limited to replacement at the factory of such parts or products as shall appear to be defective after inspection. This warranty does not obligate the Company to bear cost of labor in replacement of parts. It is the policy of the Company to make improvements without incurring obligations to add them to any unit already sold. No warranty is made or authorized to be made, other than herein set forth. This warranty is in effect for one year after purchase.

DEALER: \_\_\_\_\_

**Yetter Manufacturing warrants its own products only and cannot be responsible for damages to equipment on which mounted.**



## SAFETY PRECAUTIONS



A brief description of signal words that may be used in this manual:

**DANGER:** Indicates an imminently hazardous situation which, if not avoided “will” result in death or serious injury. This signal word is to be limited to the most extreme situations.

**WARNING:** Indicates a potentially hazardous situation which, if not avoided, “could” result in death or serious injury.

**CAUTION:** Indicates a potentially hazardous situation, which if not avoided, “may” result in minor or moderate injury. It may also be used to alert against unsafe practices.

**NOTICE:** Indicates information considered important, but not hazard related (e.g., messages relating to property damage).

Consult your implement and tractor operator’s manual for correct and safe operating practices. Be aware of towed implement width and allow safe clearance.

Safety decals are placed on the implement to alert the operator and others to the risk of personal injury or unsafe operation during normal operations and servicing.

1. The safety decals must be kept clean and in good condition to ensure that they are legible.
2. Safety decals must be replaced if they are missing or illegible.
3. When components are replaced during repair or servicing, check that the new components include the necessary safety signs.
4. Replacement safety decals may be obtained from your local dealer.



### WARNING

Read these instructions carefully to acquaint yourself with the Equipment. Working with unfamiliar equipment can lead to accidents.

Never park the equipment on a steep incline or leave the equipment running unattended.

Never clean, lubricate or adjust a machine that is in motion.

Always check that straps are secure.

Make sure latches are in pinned position when moving equipment.

Do not allow children to operate this equipment.

Do not allow riders on the equipment, trailer and/or pick-up.

Use speed and caution dictated by the terrain being traversed. Do not operate on any slope steep enough to cause tipping or loss of control.

Read and understand the operator’s manual and require all other persons who will operate the equipment to do the same.

If operating on public roadways, where legal, be certain all lighting is operating properly and observe all traffic laws.

Beware of increased stopping distances and control effort when operating with implements attached.

Be familiar with all controls and be prepared to stop equipment quickly in an emergency.

**FAILURE TO HEED MAY RESULT IN PERSONAL INJURY OR DEATH.**

## BOLT TORQUE

### Mounting bolts and hardware

Before operating the Residue Manager for the first time, check to be sure that all hardware is tight. Check all hardware again after approximately 50 hours of operation and at the beginning of each planting season.

All hardware used on the Residue Manager is Grade 5 unless otherwise noted. Grade 5 cap screws are marked with three radial lines on the head. If hardware must be replaced, be sure to replace it with hardware of equal size, strength and thread type. Refer to the torque values chart when tightening hardware.





**NOTICE:** Over tightening hardware can cause as much damage as when under tightening. Tightening hardware beyond the recommended range can reduce its shock load capacity.

The chart below is a guide for proper torque. Use it unless a specified torque is called out elsewhere in the manual.

Torque is the force you apply to the wrench handle or the cheater bar, times the length of the handle or bar.

Use a torque wrench whenever possible.

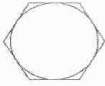
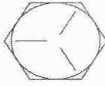
The following table shows torque in ft. lbs. for coarse thread hardware.

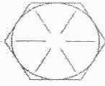
| BOLT DIA.<br>AND<br>THREADS PER<br>INCH | <br>GRADE 2 |  OR <br>GRADE 5      A-325 | <br>GRADE 8 |
|---|--|---|--|
| 1/4                                     | 6  | 10  | 14   |
| 5/16                                    | 12   | 20  | 30   |
| 3/8 – 16                                | 25   | 35  | 50   |
| 7/16 – 14                               | 35   | 55  | 80   |
| 1/2 – 13                                | 55   | 85  | 125  |
| 9/16 – 12                               | 75   | 125   | 175  |
| 5/8 – 11                                | 105  | 170   | 235  |
| 3/4 - 10                                | 185  | 305   | 425  |
| 7/8 – 9                                 | 170  | 445   | 690  |
| 1-8                                     | 260  | 670   | 1030   |
| 1 1/8 – 7                               | 365  | 900   | 1460   |
| 1 1/4 - 7                               | 515  | 1275  | 2060   |
| 1 3/8 – 6                               | 675  | 1675  | 2700   |
| 1 1/2 - 6                               | 900  | 2150  | 3500   |
| 1 3/4 – 5                               | 1410   | 3500  | 5600   |

Lubricate all bearings and moving parts as assembled and make certain that they work freely.



**WARNING:** Never work around the toolbar/implement while in a raised position without using safety lockups.



**CAUTION:** The Residue manager attachments are very heavy. Pay extra attention to lifting techniques while handling and or maneuvering the opener during assembly. Failure to do so may lead to personal injury.

# ASSEMBLY INSTRUCTIONS

2966-001-L

Left Hand Model Illustrated

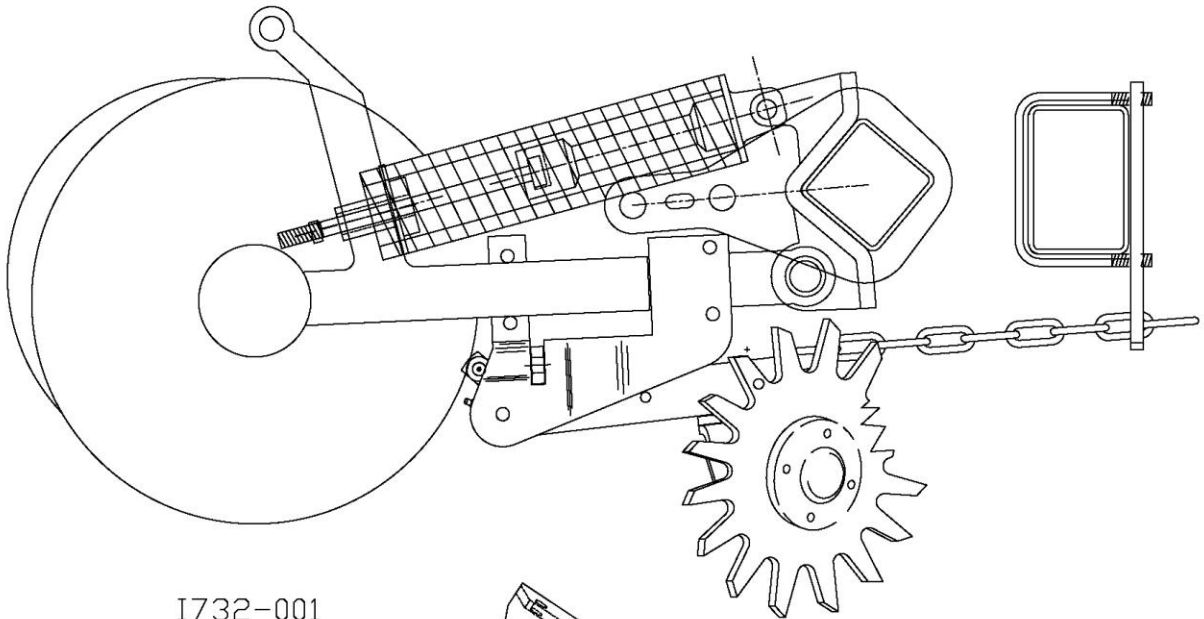

I732-001

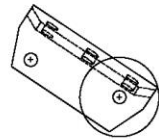

INCORRECT



IMPORTANT:  
MOUNTING HOLE CLOSEST TO THE  
CORNER SHOULD ALWAYS BE TO  
THE FRONT.

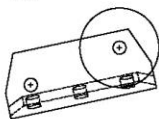

CORRECT

# OPERATING INSTRUCTIONS

## DEPTH

Remove spring locking pin and adjustment pin from the wheel support. Raise or lower the stem and wheel assembly so the teeth of the wheels are in solid contact with the residue and lightly touching the soil.

The function of the row cleaner is to sweep aside residue and not move soil. When using pre-plant incorporated herbicide, the row cleaner depth should be adjusted to minimize soil disturbance so the cleaner will not reduce the effectiveness of the incorporated herbicide.

## ROW CLEANER DO'S AND DON'TS

1. **DO NOT** move soil, Residue Managers are designed to move crop residue only.
2. **DO NOT** operate planter at slow speeds, ground speed affects how aggressive the spoke wheels are; operate at sufficient speed to maintain good residue flow.
3. **DO NOT** expect 100% of crop residue to be cleared, it is not necessary and would necessitate engaging the soil. The width of path cleared depends on ground conditions, depth setting and ground speed.
4. **DO** expect to see wheels occasionally quit turning, indicates ideal (shallow) setting which is not moving dirt.

# MAINTENANCE

## BEARING ASSEMBLY AND LUBRICATION

### Practice Safety

Understand and practice safe service procedures before doing work. Follow ALL the operating, maintenance and safety information in the equipment operator manual. Clear the area of bystanders, especially small children, when performing any maintenance or adjustments. Keep work area clean and dry. Use adequate lighting for the job. Use only tools, jacks and hoists of sufficient capacity for the job.

Never lubricate, service, or adjust machine while it is moving. Keep hands, feet, and clothing from power-driven moving and rotating parts. Disengage all power and operate controls to relieve pressure. Lower equipment to the ground and stop the engine. Remove the key. Wait for all moving parts to stop before servicing, adjusting, repairing or unplugging.

Securely support any machine elements with blocks or safety stands that must be raised for service work.

Keep all parts in good condition and properly installed. Fix damaged equipment immediately. Replace worn or broken parts. Remove any buildup of grease, oil, or debris. Make sure all guards are in place and properly secured when maintenance work is completed.

### Assembly

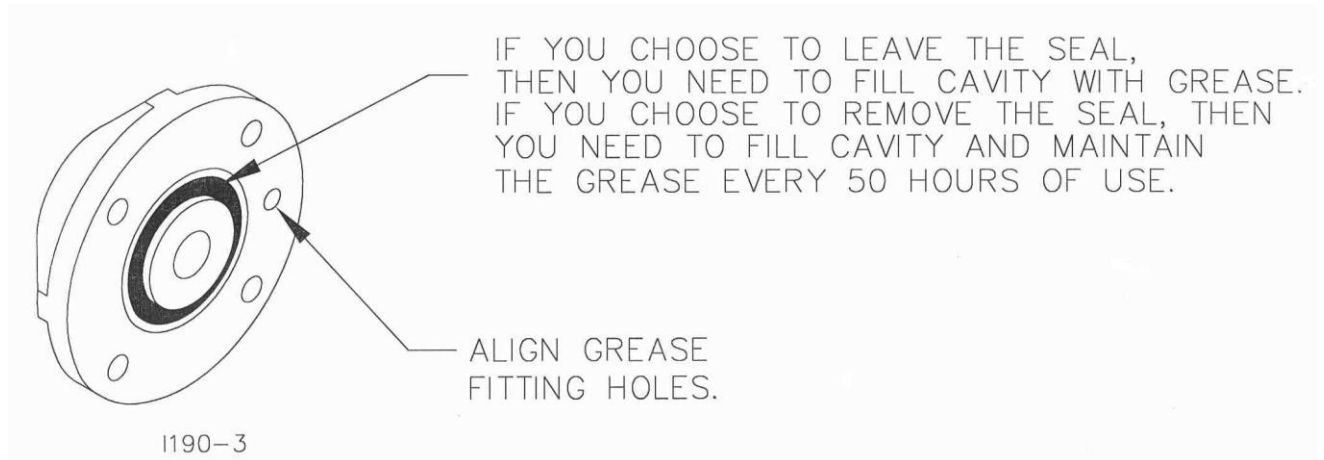

## MAINTENANCE

ALIGN THE HUB CAP GROOVE,  
WITH THE WHEEL SLOT AND  
GREASE FITTING

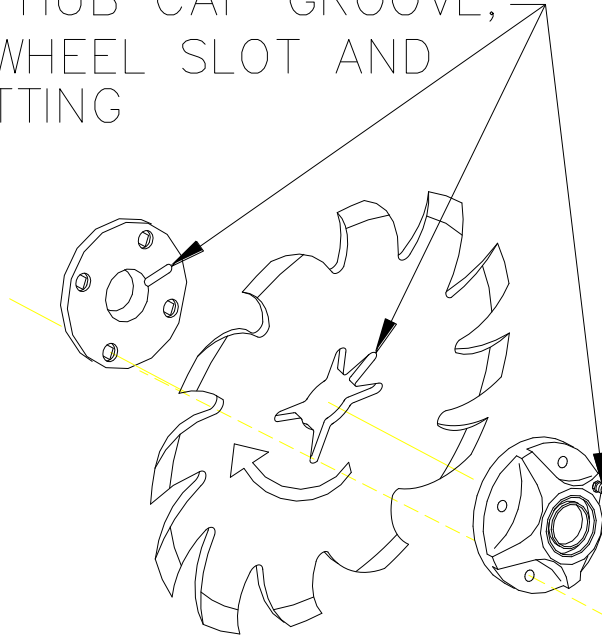

**NOTICE:** Be certain to align the grease fitting with the slot in the wheel and the hubcap so that the grease can flow freely.

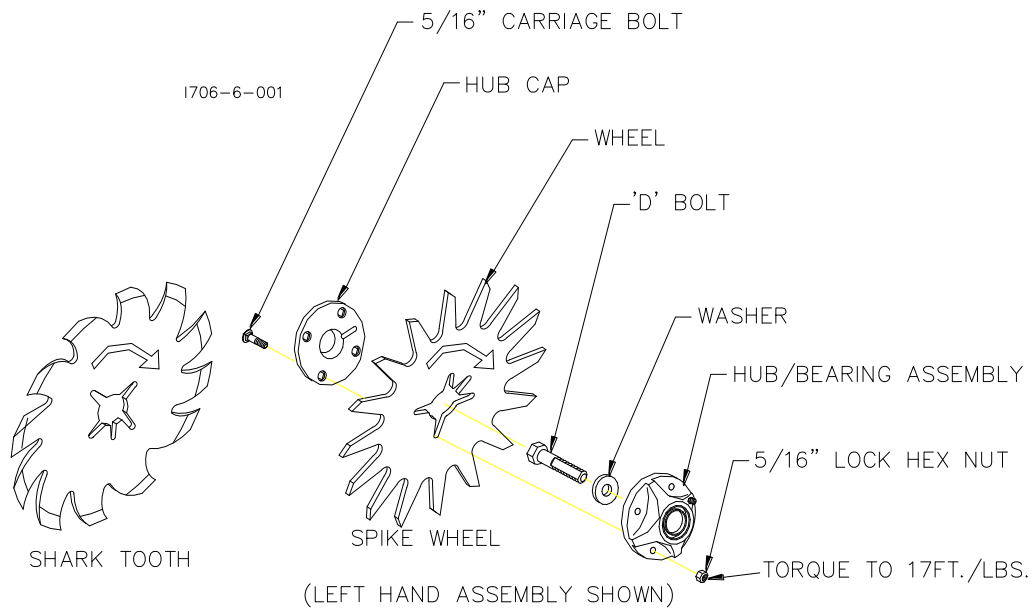

**NOTICE:** THE 2527-530 WASHER MUST BE INSTALLED OR THE WHEEL AND HUB ASSEMBLY WILL FALL OFF DURING USE.



## MAINTENANCE

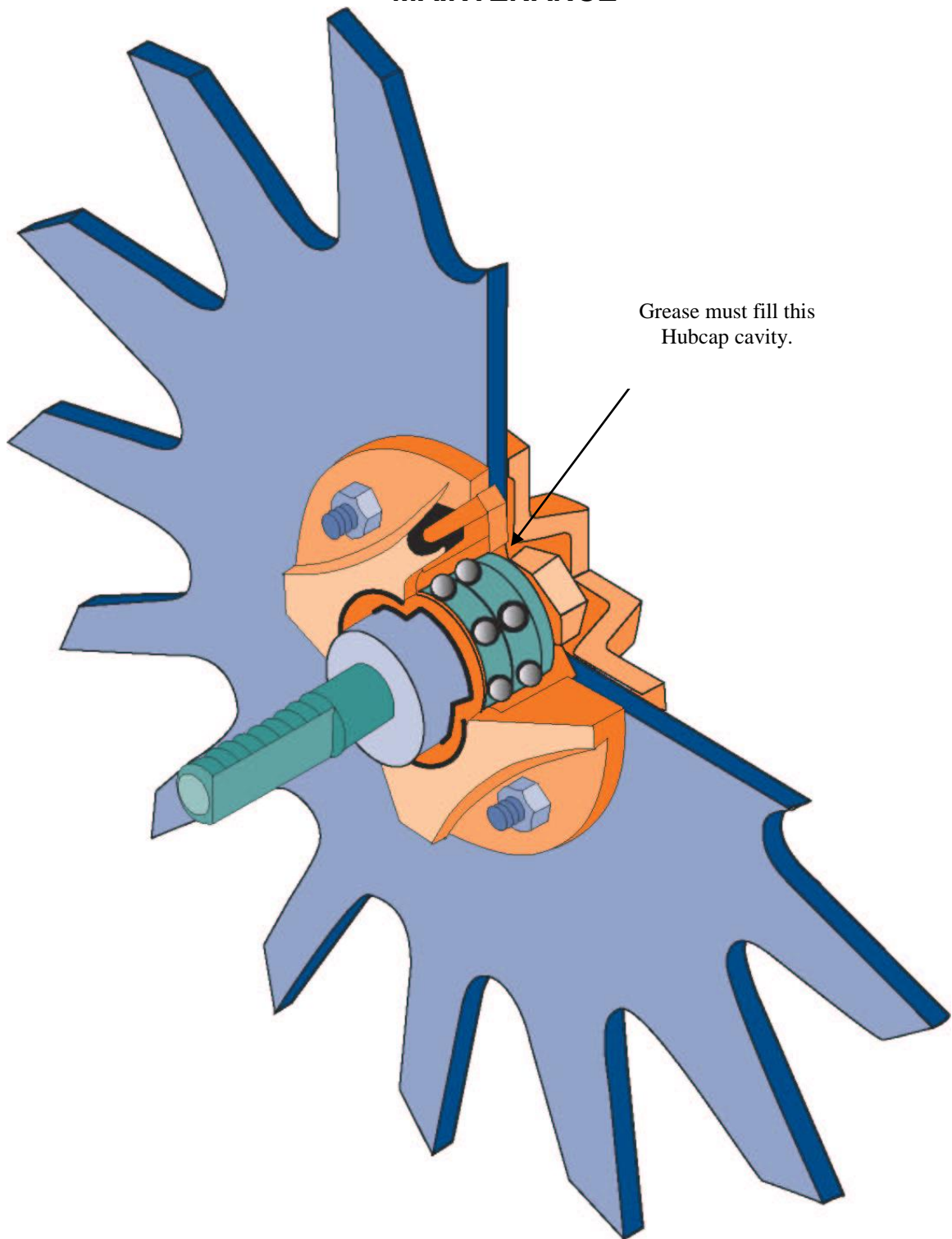

## MAINTENANCE

### Lubrication



**CAUTION:** To help prevent serious injury or death to you or others caused by unexpected movement, service machine on a level surface. Lower machine to ground or sufficiently lock or block raised machine before servicing. If machine is connected to tractor, engage parking brake and place transmission in "PARK", shut off engine and remove key. If machine is detached from tractor, block wheels and use shop stands to prevent movement.



**CAUTION:** Do not clean, lubricate, or adjust machine while in motion.

Use grease based on NLGI consistency numbers and the expected air temperature range during the service interval.

Use a **multi-purpose lithium, water resistant, moderate speed, and NLGI grade #2** grease.

Other greases may be used if they meet the following **NLGI Performance Classification: GC-LB**



**NOTICE:** Some types of grease thickener are not compatible with others. Consult your grease supplier before mixing different types of grease.

### Alternative Lubricants

Conditions in certain geographical areas may require special lubricants and lubrication practices which do not appear in the operator's manual. If there are any questions, consult Yetter Manufacturing Co. to obtain latest information and recommendation.

| PART #   | DESCRIPTION  | OUNCES OF GREASE |
|----------|--|------------------|
| 2967-404 | 13" TAPER TOOTH R.M. WHEEL                             | 1.12 OZ          |
| 2967-602 | 13" SHARK TOOTH R.M. WHEEL                             | 1.12 OZ          |
| 2967-186 | FLOATER WHEEL KIT W/R.M. WHEEL                         | 2.08 OZ          |
| 2967-596 | HEAVY DUTY OR BEVEL R.M. WHEEL W/<br>FLOATER WHEEL KIT | 2.40 OZ          |

### Storing Lubricants

Your machine can operate at top efficiency only if clean lubricants are used.

Use clean containers to handle all lubricants.

Store them in an area protected from dust, moisture and other contaminants.

## MAINTENANCE

### Lubrication Symbols

 Lubricate with grease at hourly interval indicated on symbol.

### Lubrication Intervals

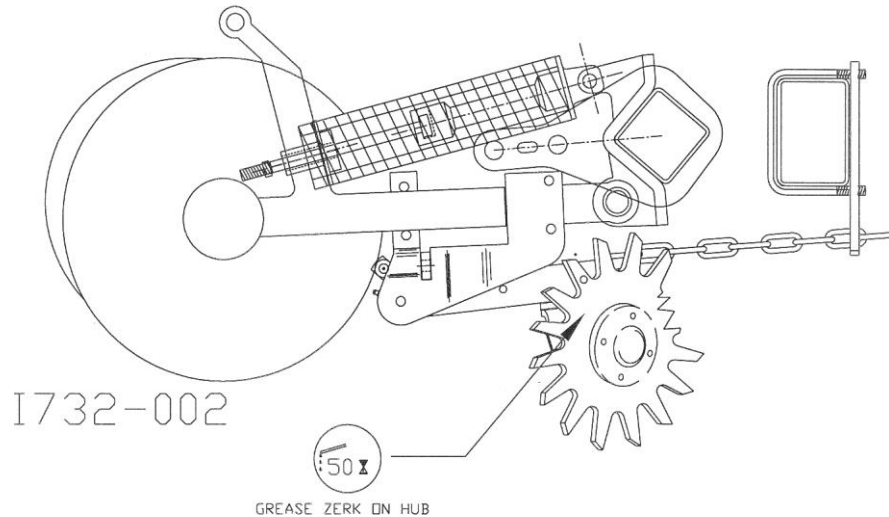

**NOTICE: The recommended service intervals are based on normal conditions; severe or unusual conditions may require more frequent lubrication.**

Perform each lubrication and service procedure at the beginning and end of each season. Clean grease fittings before using grease gun, to avoid injecting dirt and grit into the bearing. Replace any lost or broken fittings immediately. If a fitting fails to take grease, remove and clean thoroughly, replace fitting if necessary. Also check for failure of adjoining parts.

### BEARING REPLACEMENT INSTALLATION

1. If you wish to be able to grease the bearings in the hubs, remove the seal from one side of the bearings as illustrated before assembly. Otherwise the bearings may be left "sealed for life".
2. When assembling the spoke wheels, bearing assembly and hubcap, be sure to align the grease transfer hole in the spoke wheel with the groove in the hubcap and hole in the hub to allow grease passage.
3. Install/assemble the wheels, hubs and caps. **IMPORTANT: THE 2527-530 WASHER MUST BE INSTALLED OR THE WHEEL AND HUB ASSEMBLY WILL FALL OFF DURING USE.**
4. Grease the wheel/hub/bearing assembly.

## **MAINTENANCE**

### **Storing the Equipment**

Store the machine in an area away from human activity

Store machine in RAISED position.

Install service locks on all wheel cylinders.

At the end of the season, the machine should be thoroughly inspected and prepared for storage. Repair or replace any worn or damaged components to prevent down time at the start of the next season. Store machine under cover with all parts in operating condition.

- Clean machine thoroughly to remove all dirt, debris and crop residue, which would hold moisture and cause rusting.
- Inspect machine for worn or broken parts. See your Yetter Farm Equipment dealer during the off-season so that parts or service can be acquired when machine is not needed in the field.
- Lubricate bearings as outlined in the Lubrication section
- Paint all parts which are chipped or worn and require repainting.
- Store machine in a clean, dry place with the planting unit out of the sun.
- If the machine cannot be stored inside, cover with a waterproof tarpaulin and tie securely in place.
- Do not allow children to play on or around the machine

# PARTS IDENTIFICATION

2966-001-L

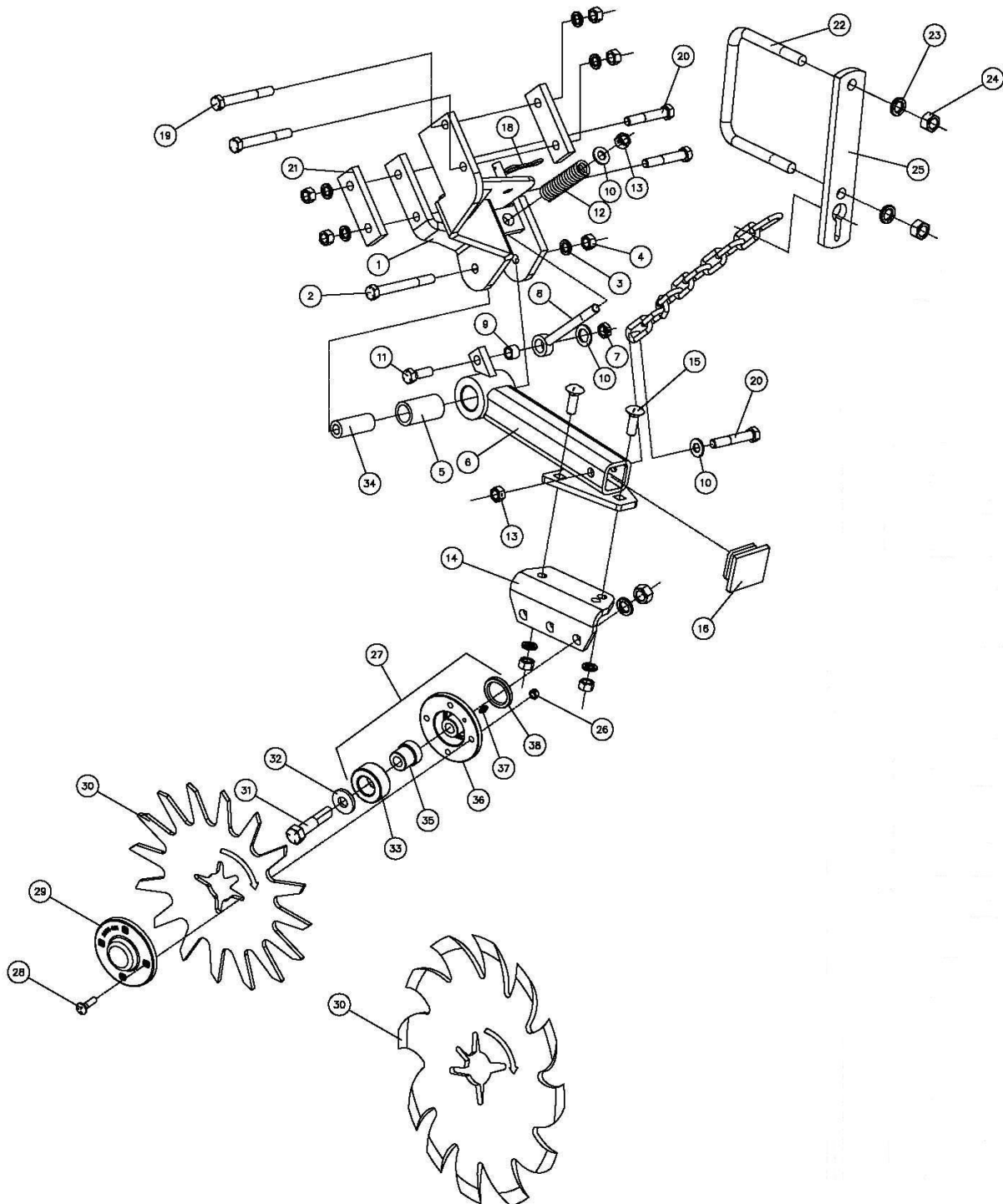

I732

## PARTS IDENTIFICATION

2966-001-L

FLOATING SINGLE WHEEL R.M., 1860/1890

| DET | QTY | PART NO.   | DESCRIPTION                                 |
|-----|-----|------------|---|
| 1   | 1   | 2966-235   | FLOATING RM MOUNT II W.A., LH (SHOWN)       |
|     | 1   | 2966-236   | FLOATING RM MOUNT II W.A., RH               |
| 2   | 1   | 2502-363   | 1/2-13 X 4-1/2 HHCS GR. 5 ZP                |
| 3   | 7   | 2525-352   | 1/2 MED LOCKWASHER ZP                       |
| 4   | 7   | 2520-352   | 1/2-13 HEX NUT ZP                           |
| 5   | 1   | 2528-600   | POLY BUSHING                                |
| 6   | 1   | 2966-234   | FLOATING SINGLE WHEEL STEM W.A.             |
| 7   | 1   | 2520-364   | 1/2-13 HEX LOCKNUT, JAM ZP                  |
| 8   | 1   | 2570-774   | 90 SERIES RM EYEBOLT, ZYD                   |
| 9   | 1   | 2967-622   | 9/16" SPACER ZYD.                           |
| 10  | 3   | 2526-352   | 1/2 SAE FLATWASHER ZP                       |
| 11  | 1   | 2502-294   | 1/2-13 X 1-1/2 HHCS GR. 5 ZP                |
| 12  | 1   | 2550-776   | LEE SPRING #LC 135L 08 M                    |
| 13  | 2   | 2520-357   | 1/2-13 LOCK HEX NUT ZP                      |
| 14  | 1   | 2967-720-L | FLOATING SINGLE WHEEL MOUNT, LH (SHOWN)     |
|     | 1   | 2967-720-R | FLOATING SINGLE WHEEL MOUNT, RH             |
| 15  | 2   | 2505-339   | 1/2-13 X 1-1/2 CAR BLT GR 5 ZP              |
| 16  | 1   | 2515-730   | END CAP, 2 X 2 X 1/4" WL                    |
| 17  | 1   | 2967-718   | LIFT CHAIN                                  |
| 18  | 1   | 2570-448   | .120 BOWTIE LOCKING COTTER ZYD              |
| 19  | 2   | 2502-364   | 1/2-13 X 4 HHCS GR. 5 ZP                    |
| 20  | 3   | 2502-313   | 1/2-13 X 3 HHCS GR. 5 ZP                    |
| 21  | 2   | 2967-714   | CLAMP PLATE                                 |
| 22  | 1   | 2570-765   | 5/8 X 6 X 5-1/2 U-BOLT ZYD                  |
| 23  | 3   | 2525-451   | 5/8 MED LOCKWASHER ZP                       |
| 24  | 3   | 2520-452   | 5/8-11 HEX NUT ZP                           |
| 25  | 1   | 2967-711   | CLAMP PLATE                                 |
| 26  | 4   | 2520-205   | 5/16-18 LOCK HEX NUT ZP                     |
| 27  | 1   | 2965-128   | HUB AND BEARING ASS'Y., 4 BOLT              |
| 28  | 4   | 2505-207   | 5/16-18 X 1 1/4 CAR BLT GR5 ZP              |
|     |     | 2505-208   | 5/16-18 X 1 1/2 CAR BLT GR5 ZP (-HD MODELS) |
| 29  | 1   | 2965-352   | HUB CAP CASTING, 4 BOLT, BLACK              |
| 30  | 1   | 2967-404   | 13" TAPER TOOTH SPOKE WHEEL (SHOWN)         |
|     | 1   | 2967-596   | 3/8" TAPER TOOTH SPOKE WHEEL (-HD MODELS)   |
|     | 1   | 2967-602   | 13" SHARK TOOTH WHEEL (SHOWN)               |
| 31  | 1   | 2570-740   | 5/8-11 X 3" 'D' BOLT GR.5 ZYD               |
| 32  | 1   | 2527-530   | 1.50D X 21/32ID 3/16TK MA BU                |
| 33  | 1   | 2570-594   | BEARING, 2 ROW NTN# DF0654LU                |
| 34  | 1   | 2967-710   | INNER BUSHING                               |
| 35  | 1   | 2570-715   | BEARING INSERT, TRASHMASTER                 |
| 36  | 1   | 2965-351   | HUB CAST., MACHINED, 4 BOLT                 |
| 37  | 1   | 2533-110   | 1/4-28 ZERK STRAIGHT SELF-TAP               |
| 38  | 1   | 2550-052   | SEAL, CR# 13548                             |

## NOTES:

# Our name Is getting known

Just a few years ago, Yetter products were sold primarily to the Midwest only. Then we embarked on a program of expansion and moved into the East, the South, the West and now north into Canada. We're even getting orders from as far away as Australia and Africa.

So, when you buy Yetter products . . .you're buying a name that's recognized. A name that's known and respected. A name that's become a part of American agriculture and has become synonymous with quality and satisfaction in the field of conservation tillage.

Thank you.

**YETTER MANUFACTURING CO.**

Colchester, IL 62326-0358 • 309/776-4111

Toll Free 800/447-5777

Fax 309/776-3222

Website: [WWW.YETTERCO.COM](http://WWW.YETTERCO.COM)

E-MAIL: [INFO@YETTERCO.COM](mailto:INFO@YETTERCO.COM)

2565-739\_REV\_B • 08/2024