



Yetter Strip Freshener



YETTER MANUFACTURING CO.
FOUNDED 1930

Colchester, IL 62326-0358
Toll free: 800/447-5777
309/776-3222 (Fax)
Website: www.yetterco.com
E-mail: info@yetterco.com

YETTER

FOREWORD

You've just joined an exclusive but rapidly growing club.

For our part, we want to welcome you to the group and thank you for buying a Yetter product.

We hope your new Yetter products will help you achieve both goals-increase your productivity and increase your efficiency so that you may generate more profit.

This operator's manual has been designed into four major sections: Foreword, Safety Precautions, Installation Instructions and Parts Breakdown.



This **SAFETY ALERT SYMBOL** indicates important safety messages in the manual. When you see this symbol, be alert to the possibility of **PERSONAL INJURY** and carefully read the message that follows.

The word **NOTE** is used to convey information that is out of context with the manual text. It contains special information such as specifications, techniques and reference information of a supplementary nature.

The word **IMPORTANT** is used in the text when immediate damage will occur to the machine due to improper technique or operation. Important will apply to the same information as specified by

note only of an immediate and urgent nature.

It is the responsibility of the user to read the operator's manual and comply with the safe and correct operating procedure and to lubricate and maintain the product according to the maintenance schedule in the operator's manual.

The user is responsible for inspecting his machine and for having parts repaired or replaced when continued use of the product would cause damage or excessive wear to the other parts.

It is the user's responsibility to deliver his machine to the Yetter dealer who sold him the product for service or replacement of defective parts, which are covered by the warranty policy.

If you are unable to understand or follow the instructions provided in this publication, consult your local Yetter dealer or contact:

YETTER MANUFACTURING CO.

309/776-4111

800/447-5777

309/776-3222 (FAX)

Website: www.yetterco.com

E-mail: info@yetterco.com

WARRANTY

Yetter Manufacturing warrants all products manufactured and sold by it against defects in material. This warranty being expressly limited to replacement at the factory of such parts or products as shall appear to be defective after inspection. This warranty does not obligate the Company to bear cost of labor in replacement of parts. It is the policy of the Company to make improvements without incurring obligations to add them to any unit already sold. No warranty is made or authorized to be made, other than herein set forth. This warranty is in effect for one year after purchase.

Dealer _____

Yetter Manufacturing warrants its own products only and cannot be responsible for damages to equipment on which mounted.

SAFETY

A brief description of signal words that may be used in this manual:

CAUTION: Used as a general reminder of good safety practices or to direct attention to unsafe practices.

WARNING: Denotes a specific potential hazard.

DANGER: Denotes the most serious specific potential hazard.



SAFETY PRECAUTIONS

You can make your farm a safer place to live and work if you observe the safety precautions given. Study these precautions carefully and insist that they be followed by those working with you and for you.

Finally, remember this: an accident is usually caused by someone's carelessness, neglect or oversight.



WARNING

Never clean, lubricate or adjust a machine that is in motion. Always lower or block the implement before performing service.

If machine must be serviced in the raised position, jack or block it up to prevent it from accidentally falling and injuring someone.

Do not allow riders on the tractor or implement.

Use speeds and caution dictated by the terrain being traversed. Do not operate on any slope steep enough to cause tipping or loss of control.

Be sure all personnel are clear of the immediate area before operating.

Read and understand the operator's manual and require all other persons who will operate the equipment to do the same.

Be familiar with all tractor and implement controls and be prepared to stop engine and implements quickly in an emergency.



CAUTION

Consult your implement and tractor operator's manual for correct and safe operating practices.

Beware of towed implement width and allow safe clearance.

FAILURE TO HEED MAY RESULT IN PERSONAL INJURY OR DEATH.

OPERATION PRECAUTIONS

STOP

Read this before using the Yetter product.

- MACHINE OPERATION

IMPORTANT: failure to properly set the frame height and levelness can result in less than successful operation of the Yetter product and may result in damaged equipment. All operators should read and thoroughly understand the instructions given prior to using the Yetter product.

NOTE: **DO NOT** use this product if the frame is not adjusted properly!

Leveling the toolbar:

With the FRAME lowered to proper operating height (**22" or 26"**). Check to be sure the toolbar is level side to side. **Check** when the toolbar is in the **field** and has been **fully loaded** with fertilizer, etc. Also, a field check with a bubble level on the frame should be made of the hitch height to ensure level operation front to back.

It is important for the toolbar to operate level laterally. Tire pressure must be maintained at pressures specified by the manufacturer.

Field conditions can change and will dictate toolbar frame height.

2984-150

Yetter Strip Freshener

Features:

- Adjustable arm linkage for toolbar frame heights between 22-26"
- Can run any style row cleaner in front of the row unit
- Single tillage coulter cleanly cuts residue without hair pinning, Optional fluted coulter, smooth coulter, or SharkTooth Wheel
- Two SharkTooth wheels run at an angle to churn dirt for optimal seed bed
- Optional fertilizer injector
- Heavy Duty Rolling basket gauges the depth of the row unit

Model Options:

- Able to utilize Cutting Ripple Coulter, Shallow Wave Coulter, or Shark Tooth Wheel
- 3 models: 2984-150-ST, 2984-150-SW (2571-162), & 2984-150-R (2571-161)
- 9 degree angle on Shark Tooth Wheels
- Has universal mounting bracket to fit 4"x4", 4"x6", 6"x6", 5"x7", and 7"x7" toolbars
- Operating Speeds at 6-10 mph and 2"-4" deep

2984-150

Yetter Strip Freshener

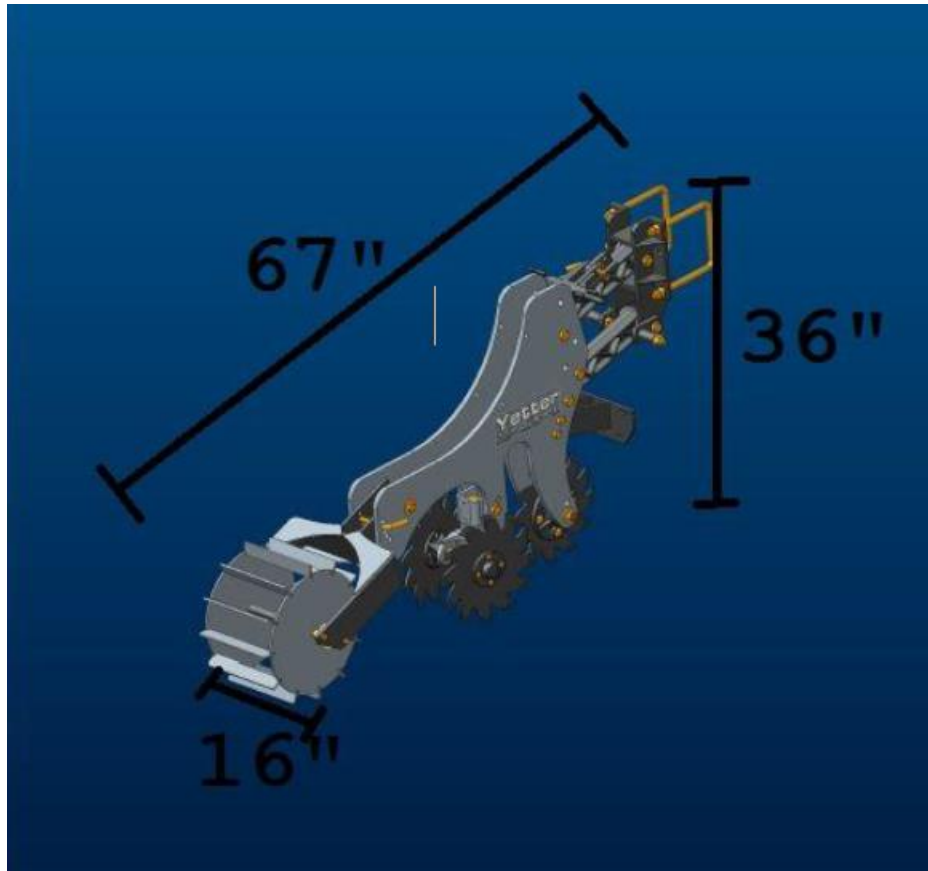

PARTS IDENTIFICATION

2984-150-R

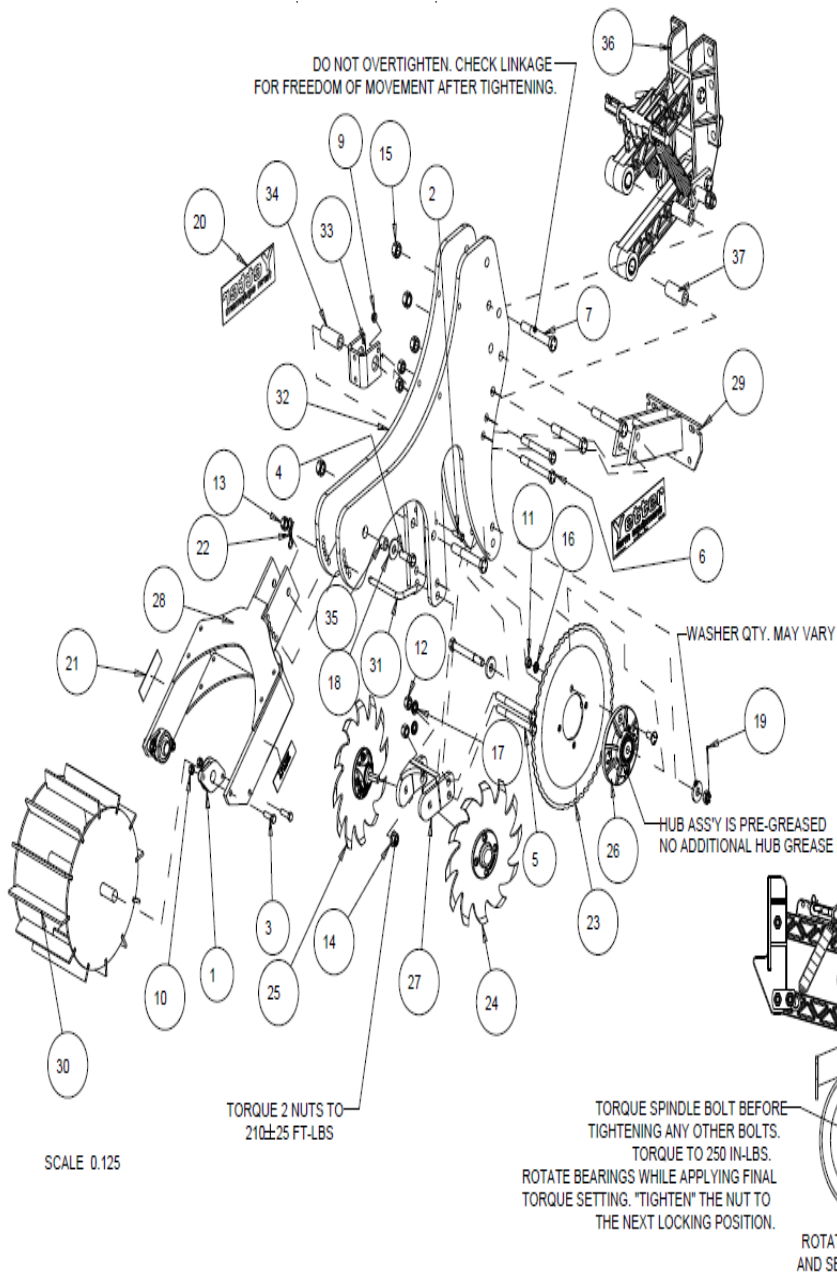

ITEM	PART NO.	DESCRIPTION	QTY
1	1310-333	FLANG MOUNT BEARING	2
2	2502-232	3/8-16 X 1 1/2 HHCS GR 5 ZVD	1
3	2502-266	7/16-14X1-1/2 HHCS GR 5 YD	4
4	2502-391	5/8-11 X 2 HHCS GR 5 ZP	2
5	2502-395	5/8-11 X 5 1/2 HHCS GR5 ZP	2
6	2502-397	5/8-11 X 5 1/2 HHCS GR5 YD	2
7	2502-508	3/4-10 X 5-1/2 HHCS GR5ZVD	4
8	2505-337	1/2-13 X 1 1/4 CARBIL G5ZP	4
9	2520-258	3/8-16HEX FLANGE LCK NUT ZP	1
10	2520-267	7/16-14 LCK HX NT ZVD	4
11	2520-352	1/2-13 HEX NUT ZP	4
12	2520-452	5/8-11 HEXNUT ZP	4
13	2520-459	5/8-11 LOCK HEX NUT ZP	2
14	2520-464	5/8-11 WHIZLOOK HEX NUT ZP	2
15	2520-515	3/4-10 LOCK HEX NUT ZP	4
16	2525-352	1/2 MED LOCKWASHER ZP	4
17	2525-451	5/8 MED. LOCKWASHER ZP	4
18	2526-451	5/8 STD FLATWASHER ZP	2
19	2531-102	1/8 X 1-1/4 COTTER PIN	1
20	2565-058	YET FRM EQUI DE 3-7/16X10-5/16	2
21	2565-162	YETTER DECAL, 1-1/2 X 4-1/2	2
22	2570-448	.120BOWTIE LOCKING COTTER ZVD	1
23	2571-161	.157 X 17" RIPPLE BLADE	1
24	2986-140-0T	SHARKTOOTH ASSY, RH, 3" D-BOLT	1
25	2986-141-0T	SHARKTOOTH ASSY, LH, 3" D-BOLT	1
26	2984-105	HUB ASSEMBLY, GEN II MAVERICK	1
27	2984-234	WHEEL MOUNT W.A.	1
28	2984-235	BASKET MOUNT W.A.	1
29	2984-236	FACEPLATE W.A.	1
30	2984-237	ROLLING BASKET W.A.	1
31	2984-320	PIN, SHD. ADJUSTMENT ZVD	1
32	2984-432	BODY PLATE	2
33	2984-442	FERTILIZER MOUNT BRACKET	1
34	2984-443	INJ. MOUNT SPACER	1
35	2984-444	BASKET PIVOT BUSHING, ZP	2
36	3000-149	PARALLEL ARM ASSEMBLY '09	1
37	3000-408	INNER BUSHING, MAV LINKAGE ZVD.	2

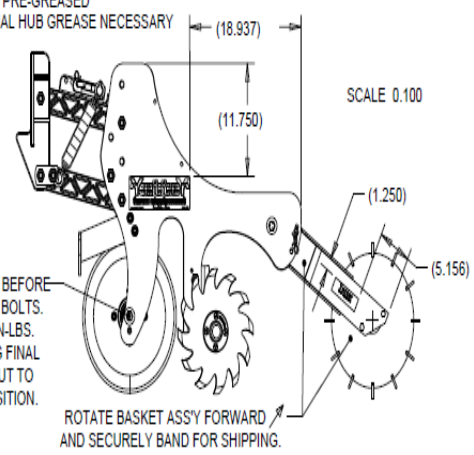

PARTS IDENTIFICATION

2984-150-ST

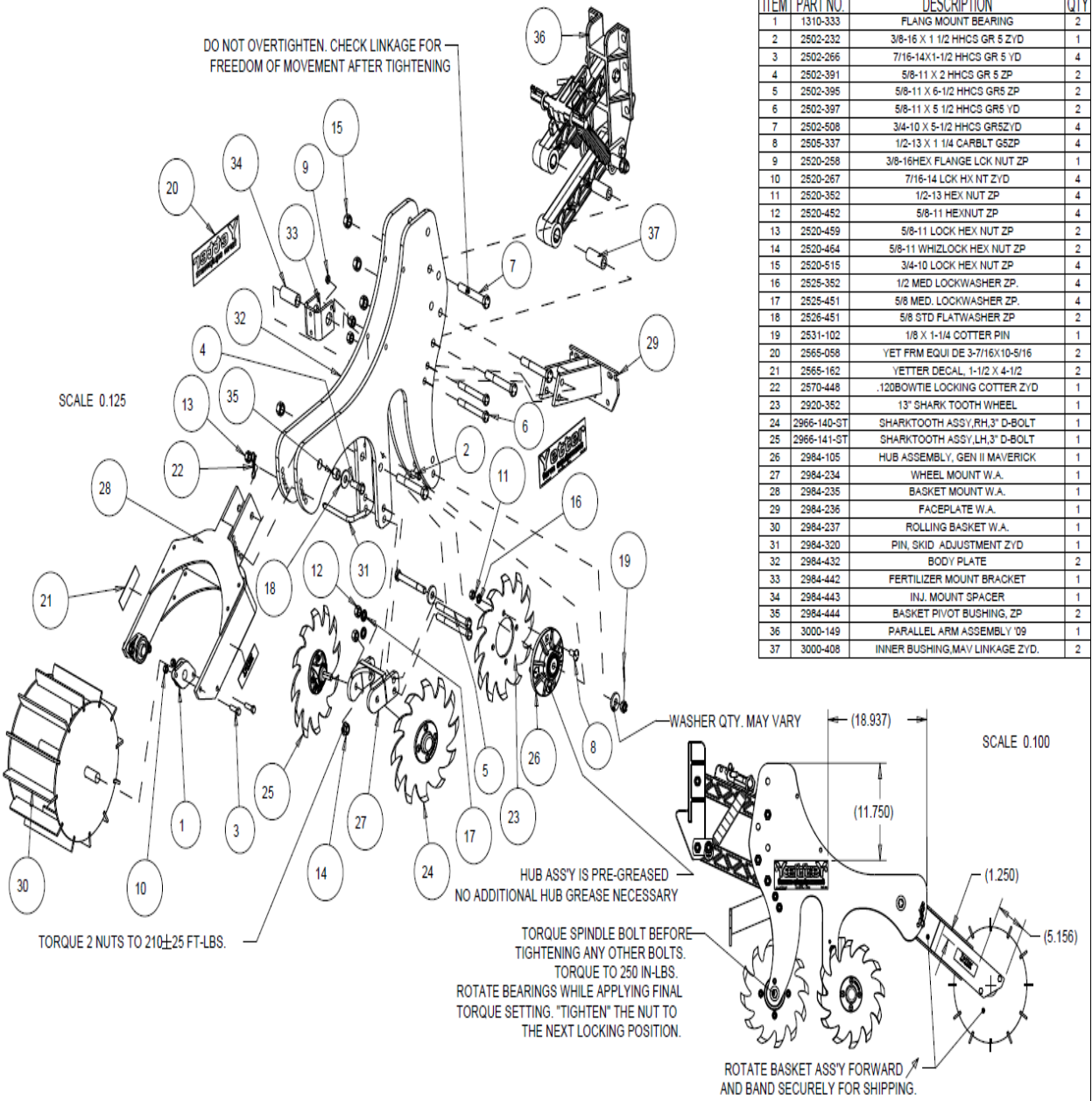

ITEM	PART NO.	DESCRIPTION	QTY
1	1310-333	FLANG MOUNT BEARING	2
2	2502-232	3/8-16 X 1 1/2 HHCS GR 5 ZYD	1
3	2502-266	7/16-14X1-1/2 HHCS GR 5 YD	4
4	2502-391	5/8-11 X 2 HHCS GR 5 ZP	2
5	2502-395	5/8-11 X 6-1/2 HHCS GR5 ZP	2
6	2502-397	5/8-11 X 5 1/2 HHCS GR5 YD	2
7	2502-508	3/4-10 X 5-1/2 HHCS GR5ZYD	4
8	2505-337	1/2-13 X 1 1/4 CARBLT GSZP	4
9	2520-258	3/8-16HEX FLANGE LCK NUT ZP	1
10	2520-267	7/16-14 LCK HX NT ZYD	4
11	2520-352	1/2-13 HEX NUT ZP	4
12	2520-452	5/8-11 HEXNUT ZP	4
13	2520-459	5/8-11 LOCK HEX NUT ZP	2
14	2520-464	5/8-11 WHIZLOCK HEX NUT ZP	2
15	2520-515	3/4-10 LOCK HEX NUT ZP	4
16	2525-352	1/2 MED LOCKWASHER ZP.	4
17	2525-451	5/8 MED. LOCKWASHER ZP.	4
18	2525-451	5/8 STD FLATWASHER ZP	2
19	2531-102	1/8 X 1-1/4 COTTER PIN	1
20	2565-058	YET FRM EQUI DE 3-7/16X10-5/16	2
21	2565-162	YETTER DECAL, 1-1/2 X 4-1/2	2
22	2570-448	.120BOWTIE LOCKING COTTER ZYD	1
23	2920-352	13" SHARK TOOTH WHEEL	1
24	2966-140-ST	SHARKTOOTH ASSY,RH,3" D-BOLT	1
25	2966-141-ST	SHARKTOOTH ASSY,LH,3" D-BOLT	1
26	2984-105	HUB ASSEMBLY, GEN II MAVERICK	1
27	2984-234	WHEEL MOUNT W.A.	1
28	2984-235	BASKET MOUNT W.A.	1
29	2984-236	FACEPLATE W.A.	1
30	2984-237	ROLLING BASKET W.A.	1
31	2984-320	PIN, SKID ADJUSTMENT ZYD	1
32	2984-432	BODY PLATE	2
33	2984-442	FERTILIZER MOUNT BRACKET	1
34	2984-443	INJ. MOUNT SPACER	1
35	2984-444	BASKET PIVOT BUSHING, ZP	2
36	3000-149	PARALLEL ARM ASSEMBLY '09	1
37	3000-408	INNER BUSHING,MAV LINKAGE ZYD.	2

PARTS IDENTIFICATION

2984-150-SW

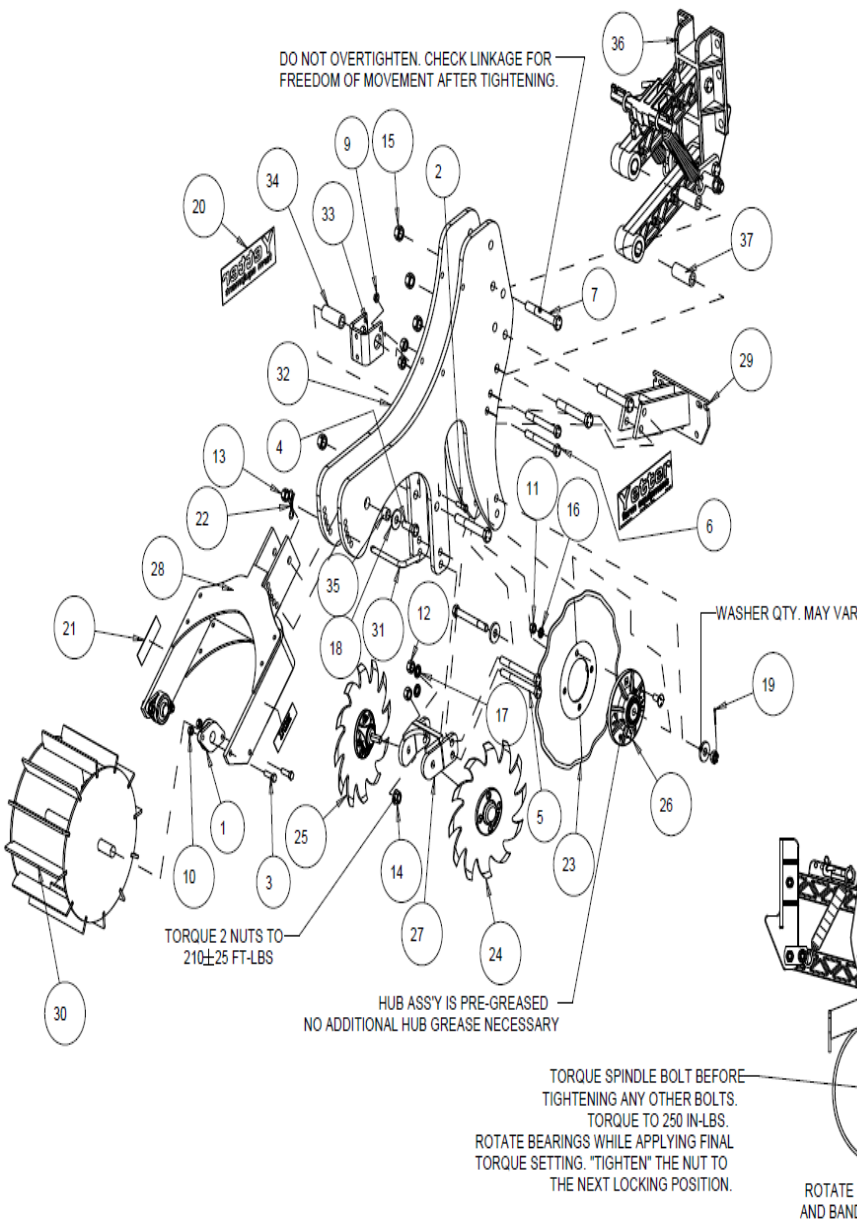

ITEM	PART NO.	DESCRIPTION	QTY
1	1310-333	FLANG MOUNT BEARING	2
2	2502-232	3/8-16 X 1 1/2 HHCS GR 5 ZVD	1
3	2502-266	7/16-14X1-1/2 HHCS GR 5 YD	4
4	2502-391	5/8-11 X 2 HHCS GR 5 ZP	2
5	2502-395	5/8-11 X 6-1/2 HHCS GR5 ZP	2
6	2502-397	5/8-11 X 5 1/2 HHCS GR5 YD	2
7	2502-508	3/4-10 X 5-1/2 HHCS GR5ZVD	4
8	2505-337	1/2-13 X 1 1/4 CARBLT GSZP	4
9	2520-258	3/8-16HEX FLANGE LCK NUT ZP	1
10	2520-267	7/16-14 LCK HX NT ZVD	4
11	2520-352	1/2-13 HEX NUT ZP	4
12	2520-452	5/8-11 HEXNUT ZP	4
13	2520-459	5/8-11 LOCK HEX NUT ZP	2
14	2520-464	5/8-11 WHIZLOCK HEX NUT ZP	2
15	2520-515	3/4-10 LOCK HEX NUT ZP	4
16	2525-352	1/2 MED LOCKWASHER ZP.	4
17	2525-451	5/8 MED. LOCKWASHER ZP.	4
18	2526-451	5/8 STD FLATWASHER ZP	2
19	2531-102	1/8 X 1-1/4 COTTER PIN	1
20	2565-058	YET FRM EQUI DE 3-7/16X10-5/16	2
21	2565-162	YETTER DECAL, 1-1/2 X 4-1/2	2
22	2570-448	.120BOWTIE LOCKING COTTER ZVD	1
23	2571-162	.157X 15.937" 13 FLUTE BLADE	1
24	2966-140-ST	SHARKTOOTH ASSY,RH,3" D-BOLT	1
25	2966-141-ST	SHARKTOOTH ASSY,LH,3" D-BOLT	1
26	2984-105	HUB ASSEMBLY, GEN II MAVERICK	1
27	2984-234	WHEEL MOUNT W.A.	1
28	2984-235	BASKET MOUNT W.A.	1
29	2984-236	FACEPLATE W.A.	1
30	2984-237	ROLLING BASKET W.A.	1
31	2984-320	PIN, SKID ADJUSTMENT ZVD	1
32	2984-432	BODY PLATE	2
33	2984-442	FERTILIZER MOUNT BRACKET	1
34	2984-443	INJ. MOUNT SPACER	1
35	2984-444	BASKET PIVOT BUSHING, ZP	2
36	3000-149	PARALLEL ARM ASSEMBLY '09	1
37	3000-408	INNER BUSHING,MAV LINKAGE ZVD.	2

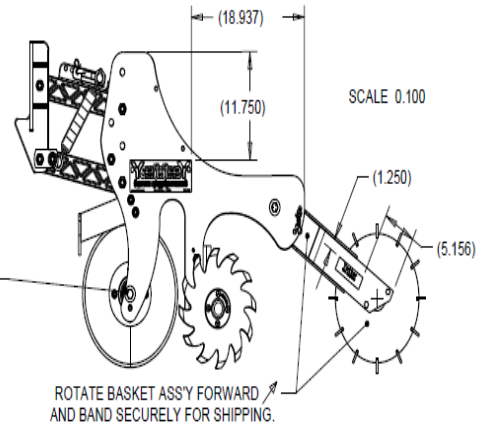

Lubrication



CAUTION: To help prevent serious injury or death to you or others caused by unexpected movement, service machine on a level surface. Lower machine to ground or sufficiently lock or block raised machine before servicing. If machine is connected to tractor, engage parking brake and place transmission in "PARK", shut off engine and remove key. If machine is detached from tractor, block wheels and use shop stands to prevent movement.



CAUTION: Do not clean, lubricate, or adjust machine while in motion.

Use grease based on NLGI consistency numbers and the expected air temperature range during the service interval.

Use a **multi-purpose lithium, water resistant, moderate speed, and NLGI grade #2** grease.

Other greases may be used if they meet the following **NLGI Performance**

Classification: GC-LB

IMPORTANT: Some types of grease thickener are not compatible with others.

Consult your grease supplier before mixing different types of grease.

Alternative Lubricants

Conditions in certain geographical areas may require special lubricants and lubrication practices which do not appear in the operator's manual. If there are any questions, consult Yetter Manufacturing Co. to obtain latest information and recommendation.

PART #	DESCRIPTION	OUNCES OF GREASE
2967-404	13" TAPER TOOTH R.M. WHEEL	1.12 OZ
2967-602	13" SHARK TOOTH R.M. WHEEL	1.12 OZ
2967-186	FLOATER WHEEL KIT W/R.M. WHEEL	2.08 OZ
2967-596	HEAVY DUTY OR BEVEL R.M. WHEEL W/ FLOATER WHEEL KIT	2.40 OZ

Storing Lubricants

Your machine can operate at top efficiency only if clean lubricants are used.

Use clean containers to handle all lubricants.

Store them in an area protected from dust, moisture and other contaminants.

RESIDUE MANAGER WHEELS

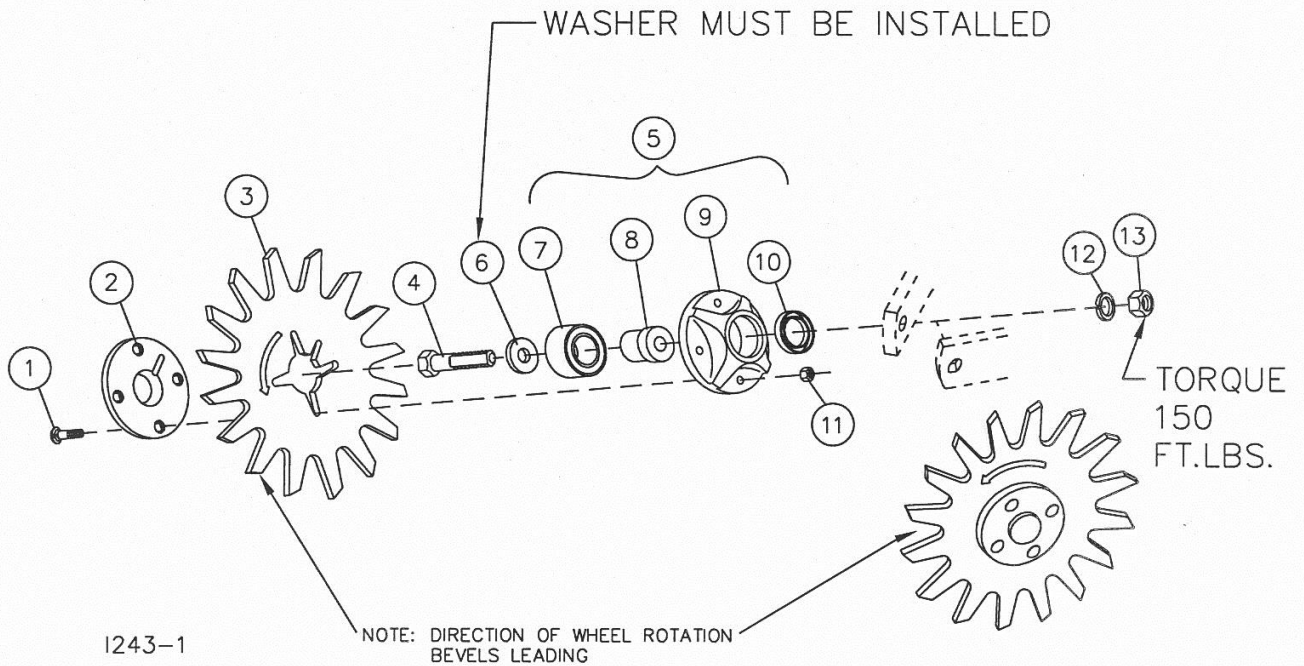

DET	QTY	PART NO.	DESCRIPTION
1	4	2505-207	5/16-18 X 1-1/4 CAR BOLT GR5 ZP
2	1	2965-352	HUB CAP CASTING, 4 BOLT, BLACK
3	1	2967-404	13" TAPER TOOTH SPOKE WHEEL (SHOWN)
	1	2967-602	13" SHARKTOOTH WHEEL
	1	2967-596	3/8" TAPER TOOTH SPOKE WHEEL
4	1	2570-740	5/8-11 X 3" 'D' BOLT GR5 ZP
5	1	2965-128	HUB & BEARING ASS'Y, 4 BOLT INCLUDES NO.S 7, 8, 9 AND 10
6	1	2527-530	1.50D X 21/32ID 3/16 TK MA BU
7	1	2570-594	BEARING, 2 ROW NTN# DF0654L
8	1	2570-715	BEARING INSERT, TRASHMASTER
9	1	2965-351	HUB CAST., MACHINED, 4 BOLT
	1	2533-110	1/4" SELF TAP ZERK (NOT SHOWN)
10	1	2550-052	SEAL, CR# 13548
11	4	2520-205	5/16-18 LOCK HEX NUT ZP
12	1	2525-451	5/8 MED LOCKWASHER ZP
13	1	2520-452	5/8-11 HEX NUT ZP

REVISED 06/03/09

Our name Is getting known

Just a few years ago, Yetter products were sold primarily to the Midwest only. Then we embarked on a program of expansion and moved into the East, the South, the West and now north into Canada. We're even getting orders from as far away as Australia and Africa.

So, when you buy Yetter products . . .you're buying a name that's recognized. A name that's known and respected. A name that's become a part of American agriculture and has become synonymous with quality and satisfaction in the field of conservation tillage.

Thank you.

YETTER MANUFACTURING CO.
Colchester, IL 62326-0358 • 309/776-4111
Toll Free 800/447-5777
Fax 309/776-3222
WEBSITE: WWW.YETTERCO.COM
E-MAIL: INFO@YETTERCO.COM

04/02/2015 JDL