



**2967-115
RESIDUE MANAGER ATTACHMENT
FOR
2960 SERIES II**

**UNIT MOUNTED
CONSERVATION
COULTER**

2565-327_REV_C • 02/2012

YETTER MANUFACTURING CO.
FOUNDED 1930

Colchester, IL 62326-0358
Toll free: 800/447-5777
309/776-3222 (Fax)
Website: www.yetterco.com
E-mail: info@yetterco.com

YETTER

FOREWORD

You've just joined an exclusive but rapidly growing club.

For our part, we want to welcome you to the group and thank you for buying a Yetter product.

We hope your new Yetter products will help you achieve both goals-increase your productivity and increase your efficiency so that you may generate more profit.

This operator's manual has been designed into four major sections: Foreword, Safety Precautions, Installation Instructions and Parts Breakdown.

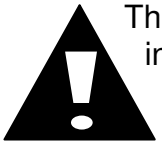

This **SAFETY ALERT SYMBOL** indicates important safety messages in the manual. When you see this symbol, be alert to the possibility of **PERSONAL INJURY** and carefully read the message that follows.

The word **NOTE** is used to convey information that is out of context with the manual text. It contains special information such as specifications, techniques and reference information of a supplementary nature.

The word **IMPORTANT** is used in the text when immediate damage will occur to the machine due to improper technique or operation. Important will apply to the same information as specified by

note only of an immediate and urgent nature.

It is the responsibility of the user to read the operator's manual and comply with the safe and correct operating procedure and to lubricate and maintain the product according to the maintenance schedule in the operator's manual.

The user is responsible for inspecting his machine and for having parts repaired or replaced when continued use of the product would cause damage or excessive wear to the other parts.

It is the user's responsibility to deliver his machine to the Yetter dealer who sold him the product for service or replacement of defective parts, which are covered by the warranty policy.

If you are unable to understand or follow the instructions provided in this publication, consult your local Yetter dealer or contact:

YETTER MANUFACTURING CO.

309/776-4111

800/447-5777

309/776-3222 (FAX)

Website: www.yetterco.com

E-mail: info@yetterco.com

WARRANTY

Yetter Manufacturing warrants all products manufactured and sold by it against defects in material. This warranty being expressly limited to replacement at the factory of such parts or products as shall appear to be defective after inspection. This warranty does not obligate the Company to bear cost of labor in replacement of parts. It is the policy of the Company to make improvements without incurring obligations to add them to any unit already sold. No warranty is made or authorized to be made, other than herein set forth. This warranty is in effect for one year after purchase.

Dealer _____

Yetter Manufacturing warrants its own products only and cannot be responsible for damages to equipment on which mounted.

SAFETY

A brief description of signal words that may be used in this manual:

CAUTION: Used as a general reminder of good safety practices or to direct attention to unsafe practices.

WARNING: Denotes a specific potential hazard.

DANGER: Denotes the most serious specific potential hazard.



SAFETY PRECAUTIONS

You can make your farm a safer place to live and work if you observe the safety precautions given. Study these precautions carefully and insist that they be followed by those working with you and for you.

Finally, remember this: an accident is usually caused by someone's carelessness, neglect or oversight.



WARNING

Never clean, lubricate or adjust a machine that is in motion. Always lower or block the implement before performing service.

If machine must be serviced in the raised position, jack or block it up to prevent it from accidentally falling and injuring someone.

Do not allow riders on the tractor or implement.

Use speeds and caution dictated by the terrain being traversed. Do not operate on any slope steep enough to cause tipping or loss of control.

Be sure all personnel are clear of the immediate area before operating.

Read and understand the operator's manual and require all other persons who will operate the equipment to do the same.

Be familiar with all tractor and implement controls and be prepared to stop engine and implements quickly in an emergency.



CAUTION

Consult your implement and tractor operator's manual for correct and safe operating practices.

Beware of towed implement width and allow safe clearance.

FAILURE TO HEED MAY RESULT IN PERSONAL INJURY OR DEATH.

OPERATION PRECAUTIONS

STOP

Read this before using the Yetter product.

- MACHINE OPERATION

IMPORTANT: failure to properly set the planter frame height and levelness can result in less than successful operation of the planter and the Yetter product and may result in damaged equipment. All operators should read and thoroughly understand the instructions given prior to using the Yetter product.

NOTE: **DO NOT** use this product if the planter is not adjusted properly!

Leveling the planter:

With the planter lowered to proper operating height (**Usually 20"-22"**).

Read the planter operator's manual for recommended setting. Check to be sure the toolbar and row unit parallel arms are level fore and aft. **Re-check** when the planter is in the **field** and has been **fully loaded** with seed, fertilizer, granular chemicals, etc. Also, a field check with a bubble level on the frame should be made of the hitch height to ensure level operation front to back.

It is important for the planter to operate level laterally. Tire pressure must be maintained at pressures specified by the manufacturer.

Field and actual planting conditions change and will dictate planter frame heights. You must ensure that the row unit parallel arms are approximately parallel with the ground.

IMPORTANT: For proper operation of the planter attachments and row units, it is imperative that the planter toolbars and row unit parallel arms be level side-to-side and front-to-rear. The toolbar frame should operate at a 20"-22" height from the **planting surface**. Check the manufacturer's operator's manual for instructions on how to adjust the frame height and levelness.

PLANTER ADJUSTMENT

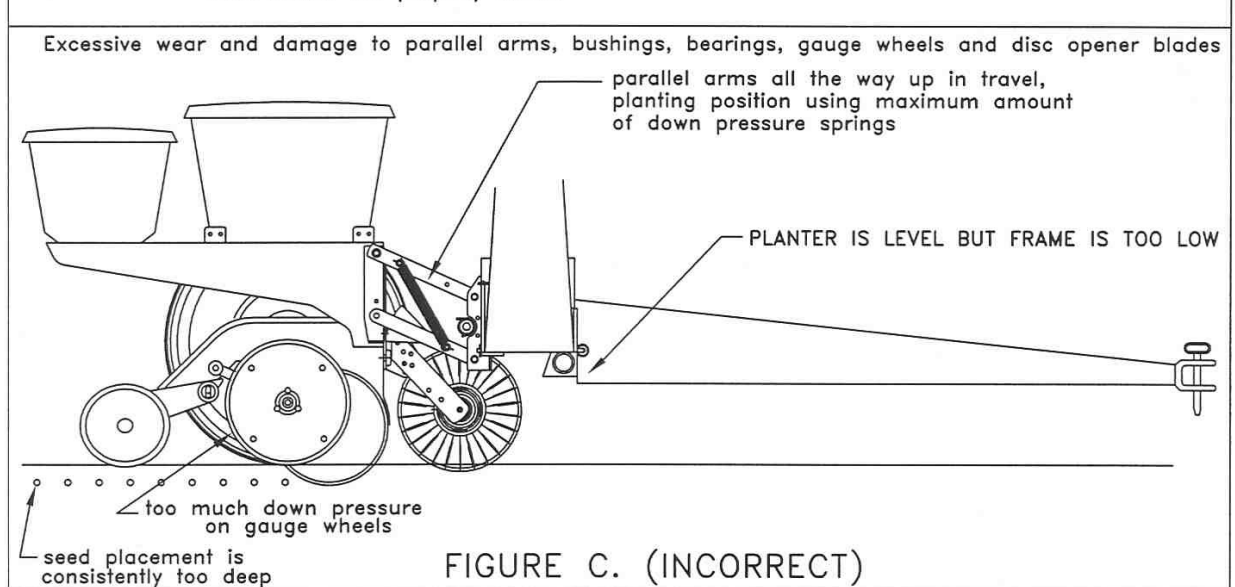
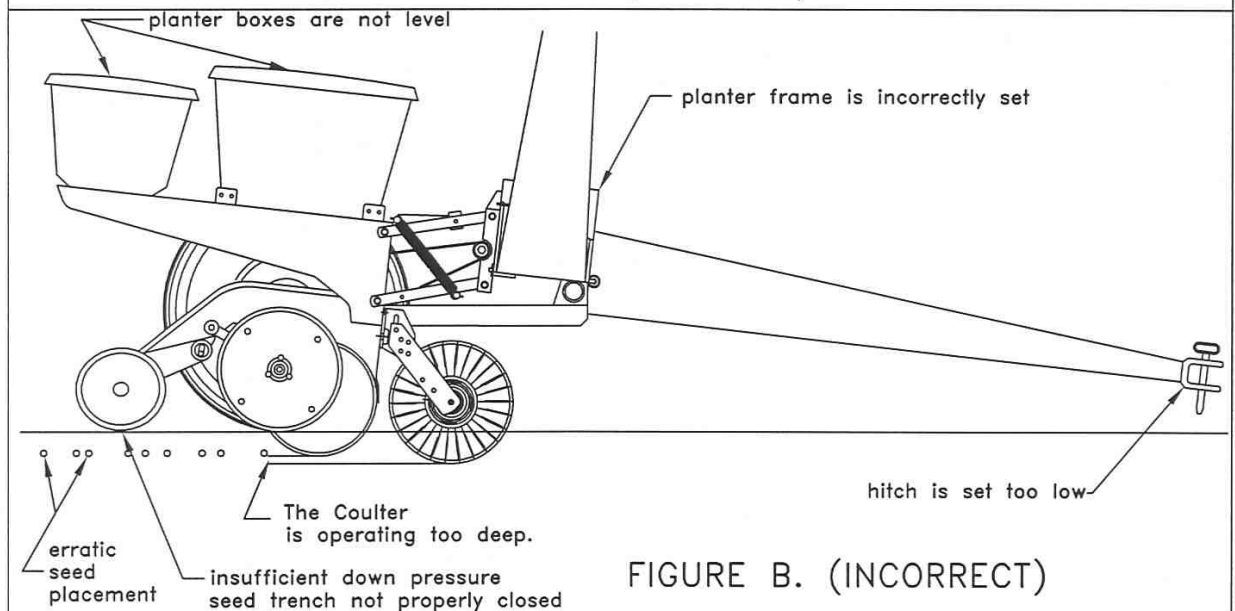
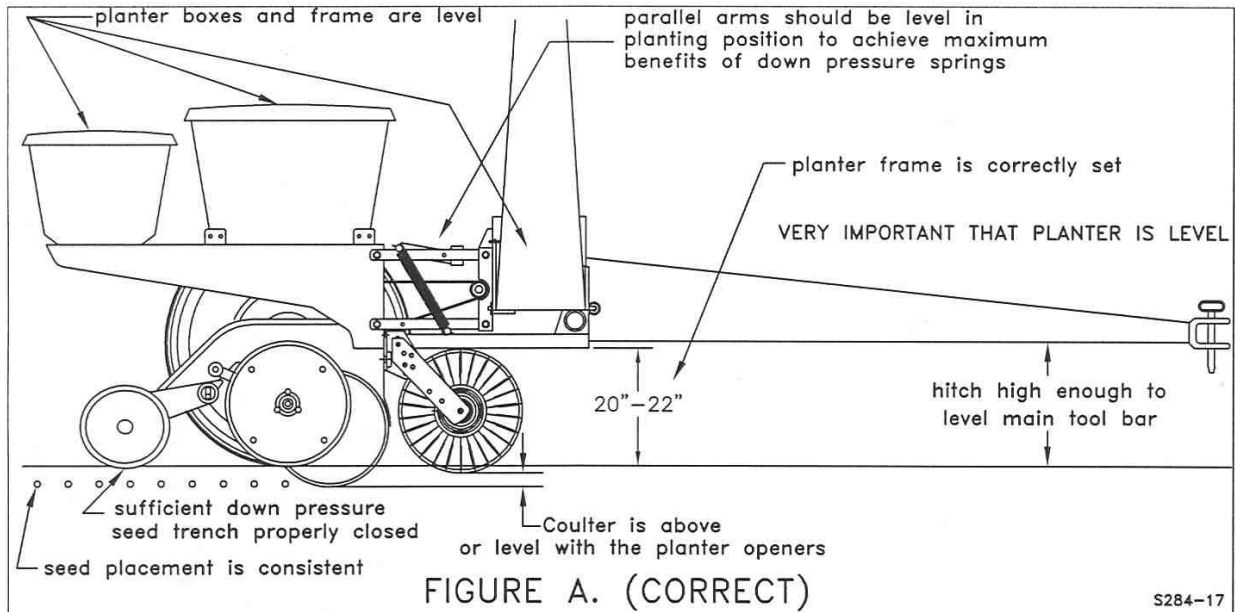

INSTALLATION

1. Remove the upper $\frac{1}{2}$ " x $2\frac{1}{2}$ " bolt which attaches the unit coulter arm to the bracket through the slot. The two flat washers are no longer required. Save the lock nut for later use.



CAUTION: DO NOT USE SPACER STRAP ON COMBO ARM W.A. AS A HANDLE, FINGERS MAY BE SERIOUSLY INJURED ON SHARP EDGE OF BLADE. USE $\frac{1}{2}$ " SQ. DRIVE SOCKET TOOLS TO ADJUST THIS PART.

2. Assemble the combo arm w.a. to the coulter with the $\frac{1}{2}$ " x 8" bolt, long spacer, short spacer and two flat washers supplied. Use the $\frac{1}{2}$ " locknut removed in step 1. Tighten this bolt securely. The $\frac{1}{2}$ " x 8" bolt must be through the TOP hole of the coulter arm.
3. Check the alignment of all holes in the combo arm and the adjustment plate with the combo adjustment pin.
4. Attach the spoke wheels to the ends of the combo arm with the "D" bolts, hex nuts and lock washers. Torque to 150 ft. lbs.

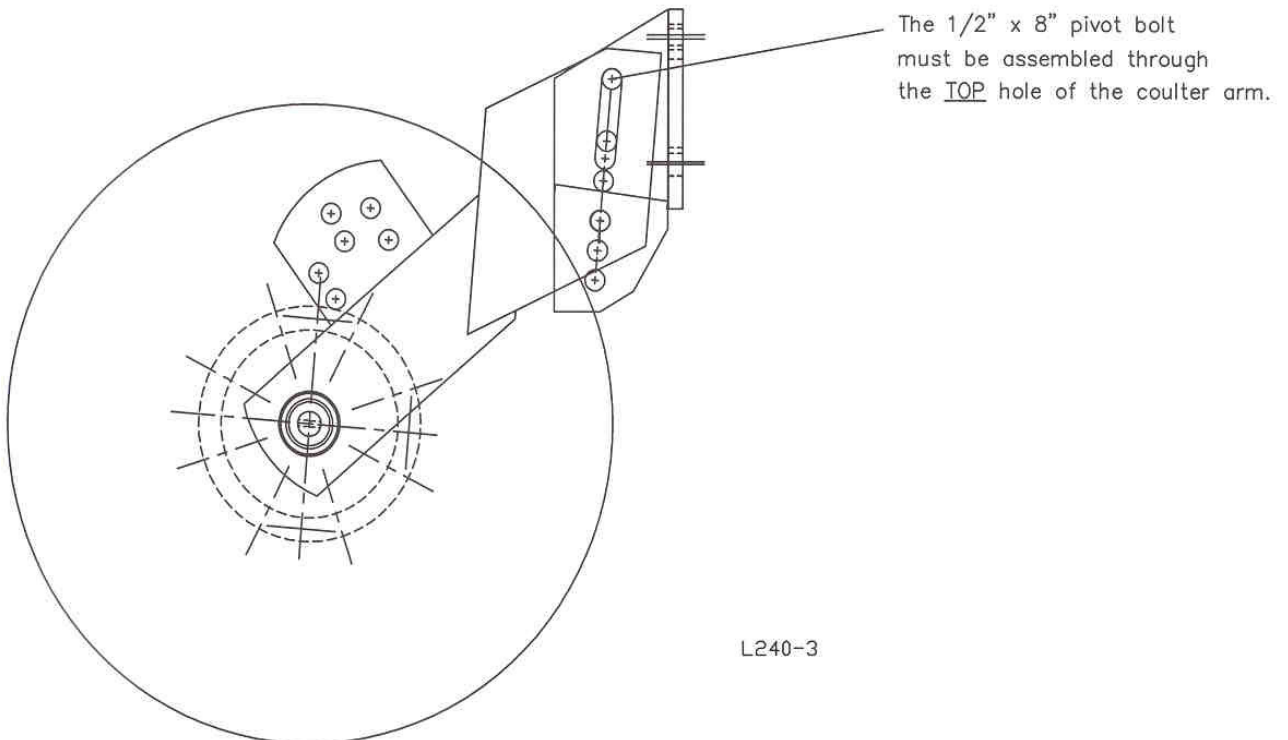

PARTS IDENTIFICATION

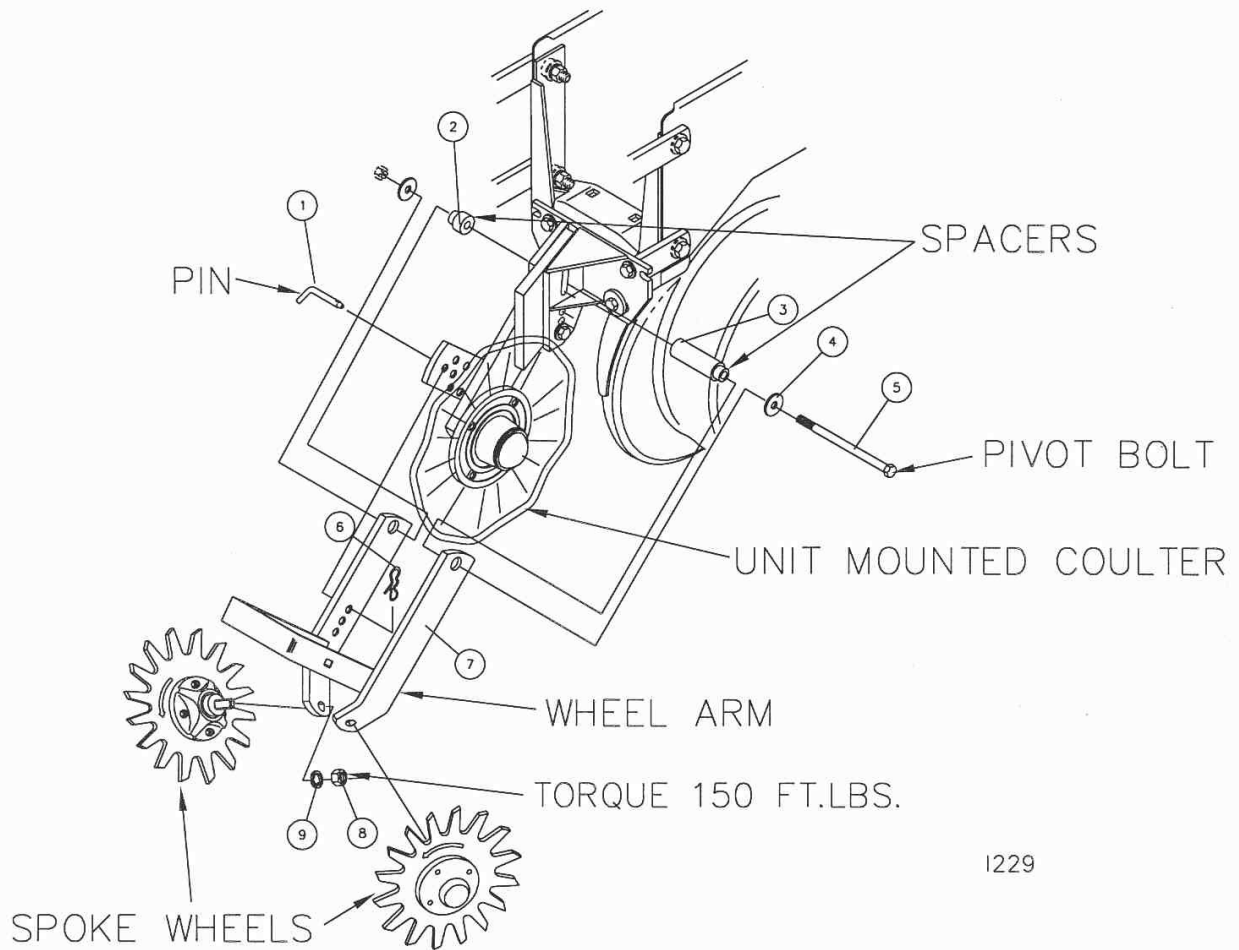

2967-115 RESIDUE MANAGER ATTACHMENT

KEY	QTY.	PART NO.	DESCRIPTION
1	1	2967-381	COMBO ADJUSTMENT PIN ZP
2	1	2967-342	SHORT COMBO SPACER ZYD
3	1	2967-341	LONG COMBO SPACER ZYD
4	2	2527-340	1/2 ID x 1 1/2 OD x 10 GA MACH BUSHING
5	1	2502-369	1/2-13 x 8" HHCS GR. 5 ZP
6	1	2570-448	1/8 BOWTIE LOCKING COTTER ZYD
7	1	2967-210	COMBO ARM, W.A.
8	2	2520-452	5/8-11 HEX NUT ZP
9	2	2525-451	5/8 LOCK WASHER ZP

REVISED 02/05/09

MANUFACTURED 10-92 TO 08-10

PARTS IDENTIFICATION

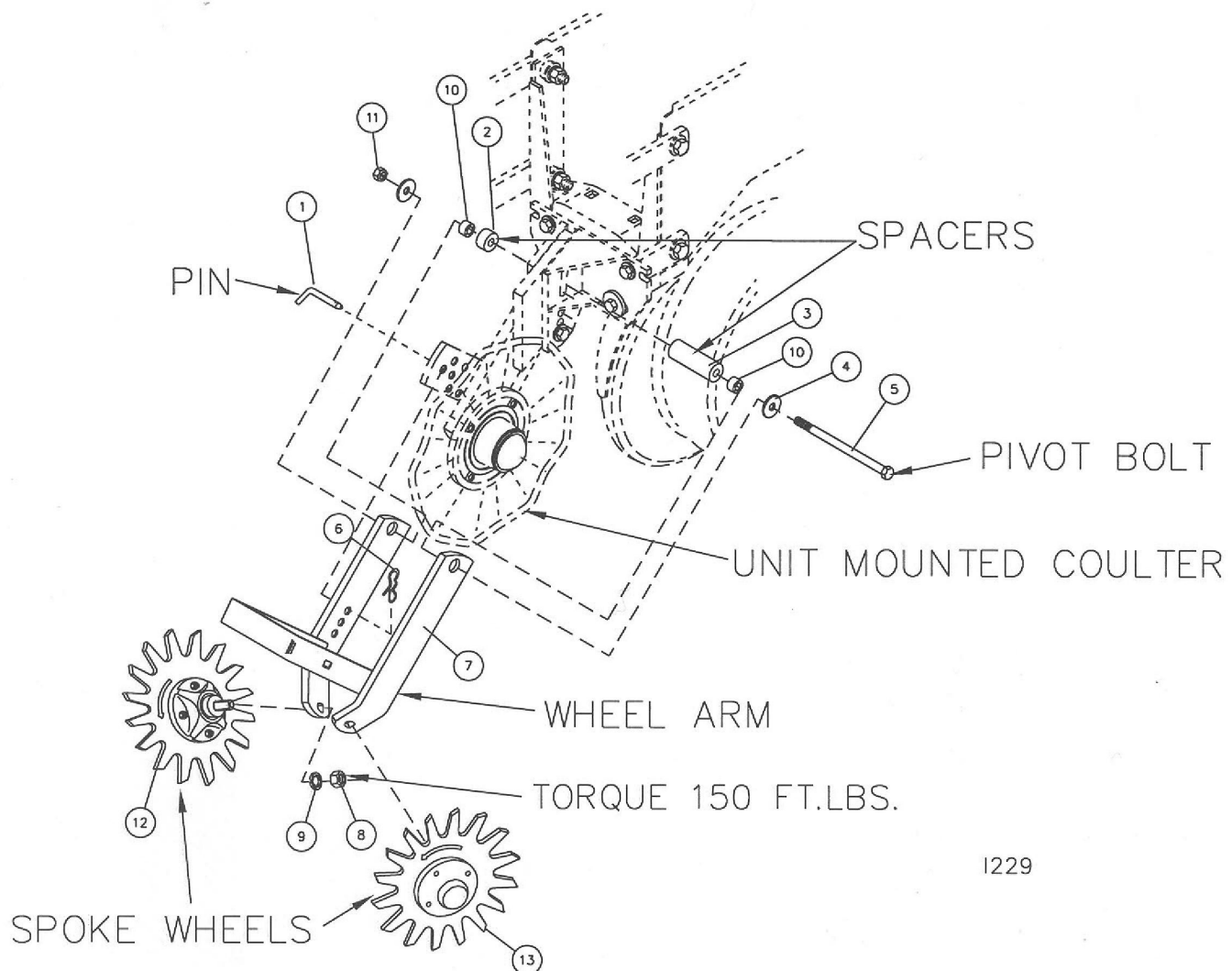

1229

2967-115 RESIDUE MANAGER ATTACHMENT

KEY	QTY.	PART NO.	DESCRIPTION
1	1	2967-381	COMBO ADJUSTMENT PIN ZP
2	1	2967-801	SHORT COMBO SPACER ZYD
3	1	2967-802	LONG COMBO SPACER ZYD
4	2	2527-340	1/2 ID x 1 1/2 OD x 10 GA MACH BUSHING
5	1	2502-369	1/2-13 x 8" HHCS GR. 5 ZP
6	1	2570-448	1/8 BOWTIE LOCKING COTTER ZYD
7	1	2967-210	COMBO ARM, W.A.
8	2	2520-452	5/8-11 HEX NUT ZP
9	2	2525-451	5/8 LOCK WASHER ZP
10	2	2967-803	BUSHING
11	1	2520-357	1/2-13 LOCK HEX NUT ZP
12	1	2966-140	SPOKE WHEEL ASSY, RH, 3" D-BOLT
13	1	2966-141	SPOKE WHEEL ASSY, LH, 3" D-BOLT

MANUFACTURED 9-2010 TO PRESENT

RESIDUE MANAGER WHEEL INSTALLATION

1. When assembling the spoke wheels, bearing assembly and hub cap, be sure to align the grease transfer hole in the spoke wheel with groove in the hub cap and hole in hub to allow grease passage.
2. Install/assemble the spoke wheels, hubs and caps as shown in illustration
3. Fill hub and bearing assembly with general purpose grease.

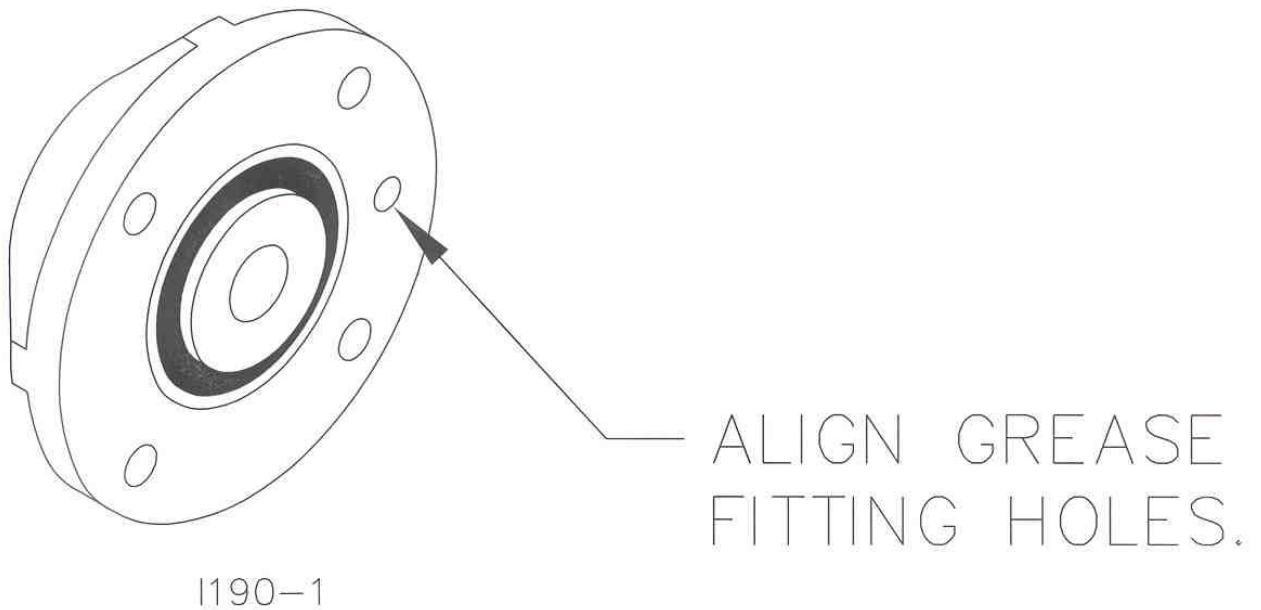

Lubrication



CAUTION: To help prevent serious injury or death to you or others caused by unexpected movement, service machine on a level surface. Lower machine to ground or sufficiently lock or block raised machine before servicing. If machine is connected to tractor, engage parking brake and place transmission in "PARK", shut off engine and remove key. If machine is detached from tractor, block wheels and use shop stands to prevent movement.



CAUTION: Do not clean, lubricate, or adjust machine while in motion.

Use grease based on NLGI consistency numbers and the expected air temperature range during the service interval.

Use a **multi-purpose lithium, water resistant, moderate speed, and NLGI grade #2** grease.

Other greases may be used if they meet the following **NLGI Performance**

Classification: GC-LB

IMPORTANT: Some types of grease thickener are not compatible with others.

Consult your grease supplier before mixing different types of grease.

Alternative Lubricants

Conditions in certain geographical areas may require special lubricants and lubrication practices which do not appear in the operator's manual. If there are any questions, consult Yetter Manufacturing Co. to obtain latest information and recommendation.

PART #	DESCRIPTION	OUNCES OF GREASE
2967-404	13" TAPER TOOTH R.M. WHEEL	1.12 OZ
2967-602	13" SHARK TOOTH R.M. WHEEL	1.12 OZ
2967-186	FLOATER WHEEL KIT W/R.M. WHEEL	2.08 OZ
2967-596	HEAVY DUTY OR BEVEL R.M. WHEEL W/ FLOATER WHEEL KIT	2.40 OZ

Storing Lubricants

Your machine can operate at top efficiency only if clean lubricants are used.

Use clean containers to handle all lubricants.

Store them in an area protected from dust, moisture and other contaminants.

RESIDUE MANAGER WHEELS

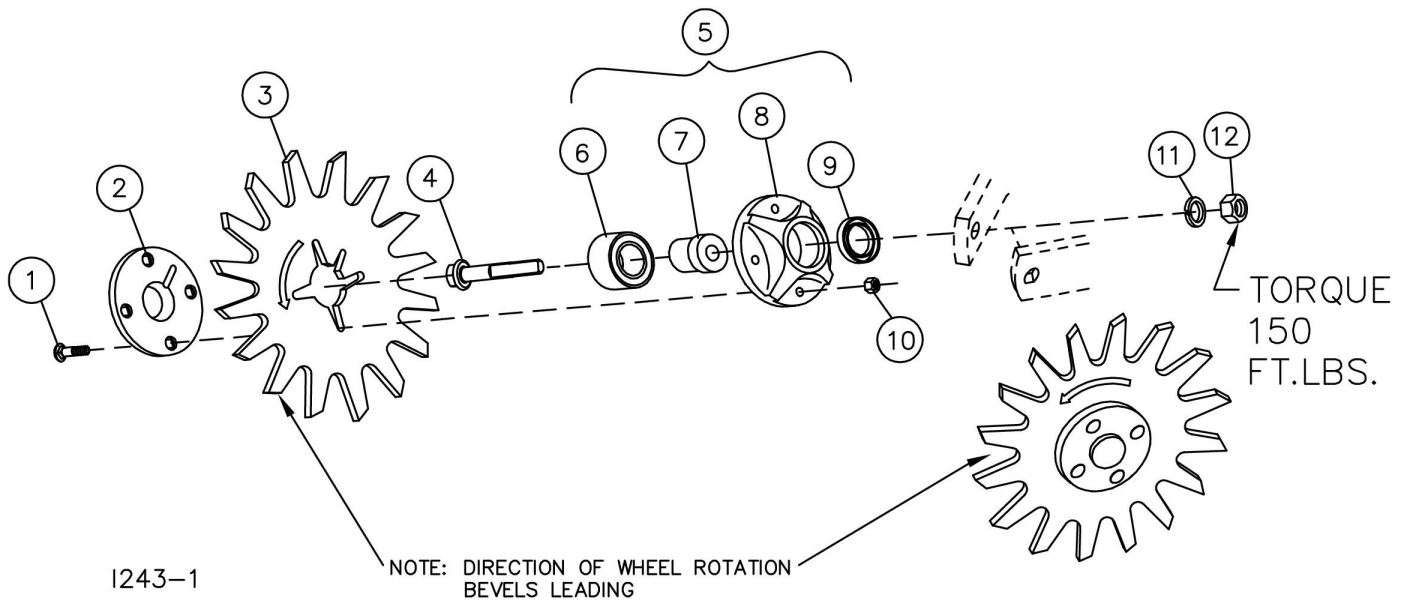

DET	QTY	PART NO.	DESCRIPTION
1	4	2505-207	5/16-18 X 1-1/4 CAR BOLT GR5 ZP
2	1	2965-352	HUB CAP CASTING, 4 BOLT, BLACK
3	1	2967-404	13" TAPER TOOTH SPOKE WHEEL (SHOWN)
	1	2967-602	13" SHARKTOOTH WHEEL
	1	2967-596	3/8" TAPER TOOTH SPOKE WHEEL
4	1	2570-740	D-BOLT, FLANGE, 5/8-11 X 2.812" GR8 ZP
5	1	2965-128	HUB & BEARING ASS'Y, 4 BOLT INCLUDES NO.S 6,7,8 AND 9
6	1	2570-594	BEARING, 2 ROW NTN# DF0654L
7	1	2570-715	BEARING INSERT, TRASHMASTER
8	1	2965-351	HUB CAST., MACHINED, 4 BOLT
	1	2533-110	1/4" SELF TAP ZERK (NOT SHOWN)
9	1	2550-069	SEAL, TRIPLE LIP, NTI# 1812-5
10	4	N10213	5/16-18 HEX FLANGE SERRATED NUT
11	1	2525-451	5/8 MED LOCKWASHER ZP
12	1	2520-452	5/8-11 HEX NUT ZP

REVISED 02/01/12

Our name Is getting known

Just a few years ago, Yetter products were sold primarily to the Midwest only. Then we embarked on a program of expansion and moved into the East, the South, the West and now north into Canada. We're even getting orders from as far away as Australia and Africa.

So, when you buy Yetter products . . .you're buying a name that's recognized. A name that's known and respected. A name that's become a part of American agriculture and has become synonymous with quality and satisfaction in the field of conservation tillage.

Thank you.

YETTER MANUFACTURING CO.

Colchester, IL 62326-0358 • 309/776-4111

Toll Free 800/447-5777

Fax 309/776-3222

WEBSITE: WWW.YETTERCO.COM

E-MAIL: INFO@YETTERCO.COM

2565-327_REV_C • 02/12