

**Yetter**  
...for land's sake

**2967-030**

**“TITAN”**

**UNIVERSAL  
UNIT MOUNTED  
FLOATING RESIDUE MANAGER**

**YETTER MANUFACTURING CO.**  
*FOUNDED 1930*

Colchester, IL 62326-0358  
Toll free: 800/447-5777  
309/776-3222 (Fax)

Website: [www.yetterco.com](http://www.yetterco.com)  
E-mail: [info@yetterco.com](mailto:info@yetterco.com)

**Yetter**

## FOREWORD

You've just joined an exclusive but rapidly growing club.

For our part, we want to welcome you to the group and thank you for buying a Yetter Product.

We hope your new Yetter implement will help you achieve both increased productivity and increased efficiency so that you may generate more profit. This operator's manual has been designed into six major sections.

Foreword, Safety Precautions, assembly instructions, Operation, parts identification and troubleshooting.

It is important the owner/operator knows the implement model number. Write the model number in the space provided and use it in all correspondence when referring to the implement.

Throughout the manual references may be made to left side and right side. These terms are used as viewed from the operator's seat facing the front of the tractor.

 This **SAFETY ALERT SYMBOL** indicates important safety messages in the manual. When you see this symbol, be alert to the possibility of **PERSONAL INJURY** and carefully read the message that follows.

The word **NOTE** is used to convey information that is out of context with the manual text. It contains special information such as specifications, techniques, reference information

and other information of a supplementary nature.

The word **IMPORTANT** is used in the text when immediate damage will occur to the machine due to improper technique or operation. Important will apply to the same information as specified by note only of an immediate and urgent nature.

It is the responsibility of the user to read the operator's manual and comply with the safe and correct operating procedure and to lubricate and maintain the product according to the maintenance schedule in the operator's manual.

The user is responsible for inspecting his machine and for having parts repaired or replaced when continued use of the product would cause damage or excessive wear to the other parts.

It is the user's responsibility to deliver his machine to the Yetter dealer who sold him the product for service or replacement of defective parts that are covered by the warranty policy.

 If you are unable to understand or follow the instructions provided in the publication, consult you local Yetter dealer or contact:

### YETTER MANUFACTURING CO.

309/776-4111

800/447-5777

309/776-3222 (FAX)

Website: [www.yetterco.com](http://www.yetterco.com)

E-mail: [info@yetterco.com](mailto:info@yetterco.com)

## WARRANTY POLICY

Yetter Manufacturing warrants all products manufactured and sold by it against defects in material. This warranty being expressly limited to replacement at the factory of such parts or products as will appear to be defective after inspection. This warranty does not obligate the Company to bear cost of labor in replacement of parts. It is the policy of the company to make improvements without incurring obligations to add them to any unit already sold. No warranty is made or authorized to be made, other than herein set forth. This warranty is in effect for one year after purchase.

Model Number: \_\_\_\_\_

Dealer : \_\_\_\_\_

**Yetter Manufacturing warrants its own products only and cannot be responsible for damage to equipment on which it is mounted.**

## TABLE OF CONTENTS

Introduction.....	2
Warranty.....	2
Table of Contents.....	3
Optional Equipment.....	3
Safety Information.....	4
Application/Use Guide.....	5
Assembly Instruction.....	6-8
Operation.....	9
Maintenance.....	9
Parts Identification.....	10
Trouble Shooting.....	11

## OPTIONAL EQUIPMENT

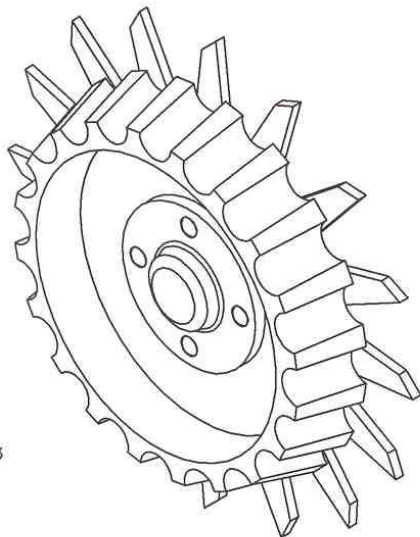

**2967-555 FLOATER WHEEL  
L.H. ASSEMBLY SHOWN  
(2) REQUIRED PER ROW**

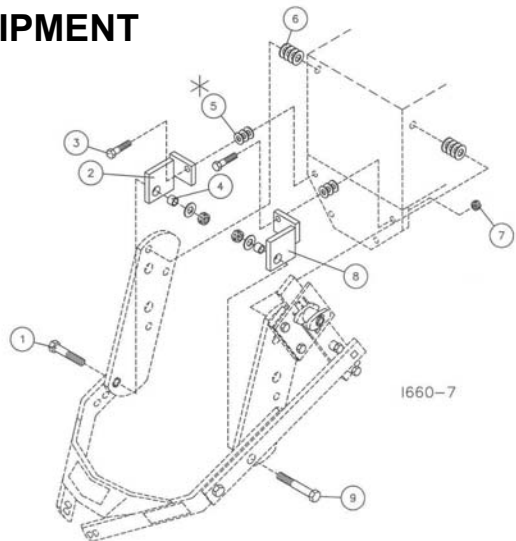

**2967-084 – KINZE PUSHER ADPTR. KIT, TITAN**

KEY	QTY.	PART NO.	DESCRIPTION
1	1	2502-393	5/8-11 X 2-1/2 HHCS GR. 5 ZP
2	1	2967-278	TITAN MNT. ADPTR. W.A. (RH), KINZE
3	2	2502-317	1/2-13 X 1-3/4 HHCS GR. 5 ZP
4	2	6000-335	9/16" BUSHING
*5	6	2526-351	1/2 STANDARD FLATWASHER ZP
6	8	2526-453	5/8 SAE FLATWASHER ZP
7	2	2520-357	1/2-13 LOCK HEX NUT ZP
8	1	2967-279	TITAN MNT. ADPTR. W.A. (LH), KINZE
9	1	2502-325	5/8-11 X 3 HHCS GR 5 ZP

\* PARTS NOT USED W/ UNIT MNTD. COULTERS

## **SAFETY**

**A brief description of signal words that may be used in this manual:**

**CAUTION:** Used as a general reminder of good safety practices or to direct attention to unsafe practices.

**WARNING:** Denotes a specific potential hazard.

**DANGER:** Denotes the most serious specific potential hazard.

## **SAFETY PRECAUTIONS**

You can make your farm a safer place to live and work if you observe the safety precautions given. Study these precautions carefully and insist that those working with you and for you follow them.

Finally, remember this: an accident is usually caused by someone's carelessness, neglect or oversight.



### **WARNING**

Never clean, lubricate or adjust a machine that is in motion. Always lower or block the implement before performing service.

If the machine must be serviced in the raised position, jack or block it up to prevent it from accidentally falling and injuring someone.

Do not allow riders on the tractor or implement.

Use speeds and caution dictated by the terrain being traversed. Do not operate on any slope steep enough to cause tipping or loss of control.

Be sure all personnel are clear of the immediate area before operating.

Read and understand the operator's manual and require all other persons who will operate the equipment to do the same.

Be familiar with all tractor and implement controls and be prepared to stop engine and implements quickly in an emergency.



### **CAUTION**

Consult your implement and tractor operator's manual for correct and safe operating practices.

Beware of towed implement width and allow safe clearance.

**FAILURE TO HEED MAY RESULT IN PERSONAL INJURY OR DEATH.**

# TITAN RESIDUE MANAGER

## APPLICATION / USE GUIDE

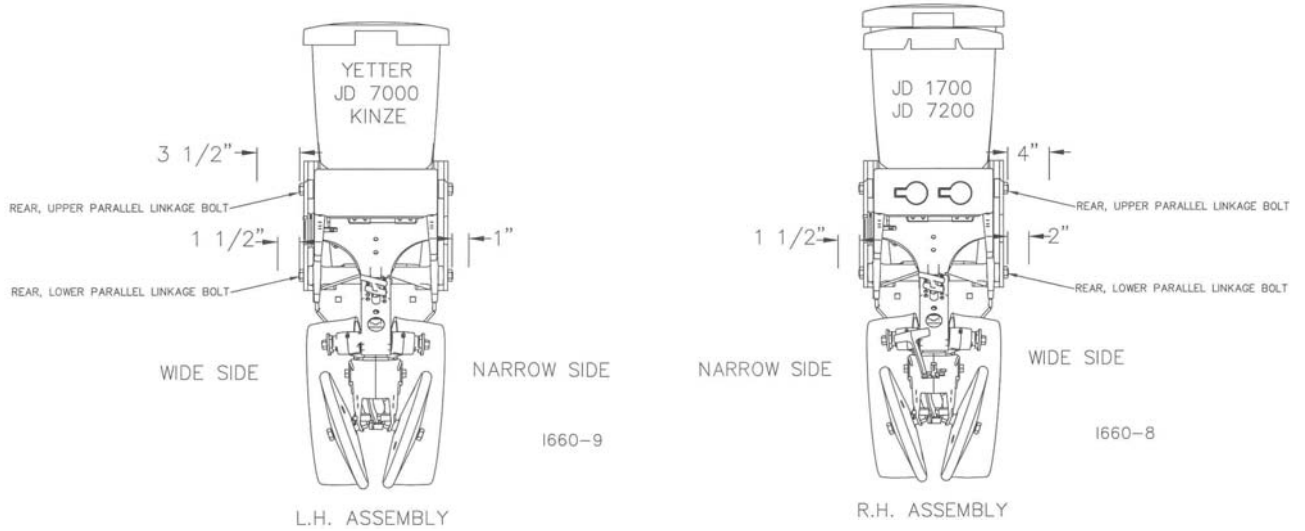

**IMPORTANT:** On some planters the row unit is closer to lift wheels, frames and chain idlers on one side of the row unit than the other side. Both sides of all row units need to be checked for sufficient clearance. The Titan Residue Manager can be assembled as a R.H. or a L.H. unit as needed for clearance. Measurements are taken at the bolt heads of the rear parallel linkage bolts.

**NOTE:** Measure for clearance when planter row units are in the planting position.

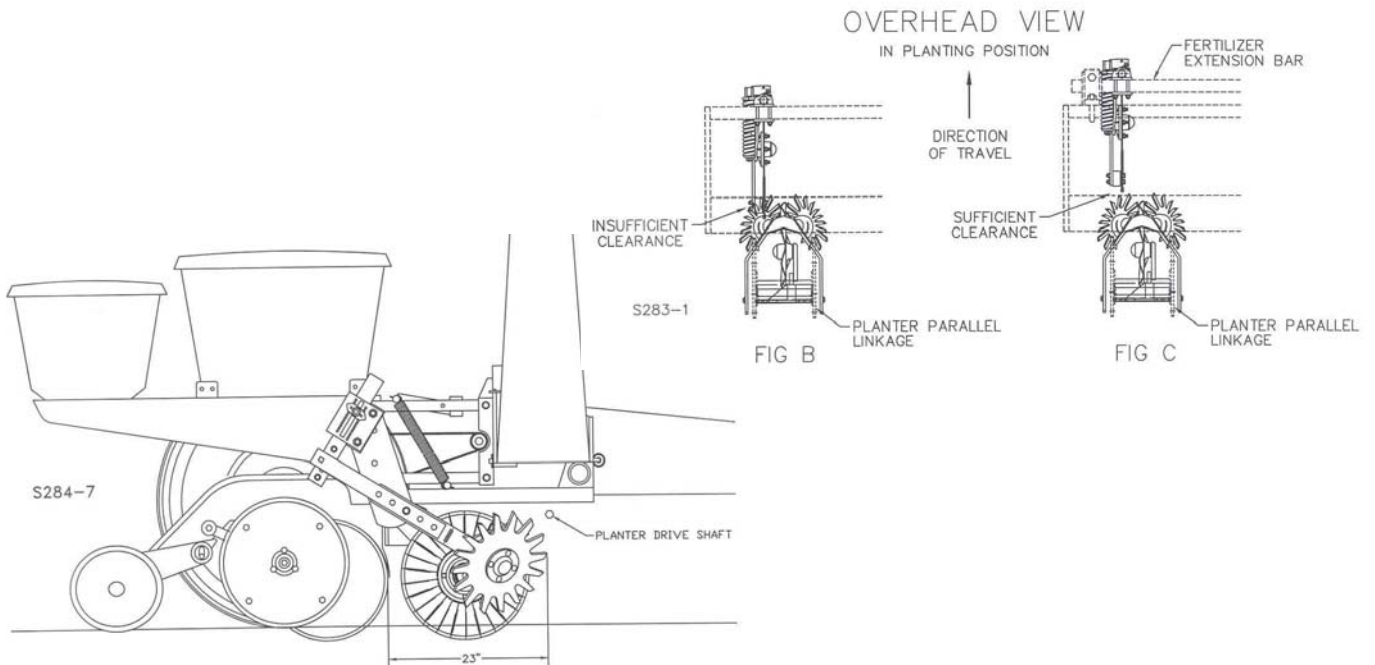

**IMPORTANT:** Fertilizer extension bar kit, set backs or longer parallel arms may have to be used on some planters to have enough clearance between the residue manager wheels, fertilizer openers, planter transport frames and drive shafts. Please check to see if your planter “measures up” to handle a Titan Residue Manager.

## ASSEMBLY INSTRUCTIONS

**STEP 1.** Attach a 2967-558 mount plate and the 2967-561 adapter plate (JD MEII/MEII PLUS ONLY) using 2) 5/8” x 3” bolts, 1) 5/8” flat washer and 2) 5/8” lock nuts to the R.H. side of the planter row units. Install the top bolt before removing the bottom bolt. Fully tighten the fasteners.  
NOTE: On some planters the 2967-561 adapter plate and the 5/8” flat washer are not used.

\*PARTS NOT USED W/JD7000/KINZE 2000, 3000/WHITE 6000 ROW UNITS

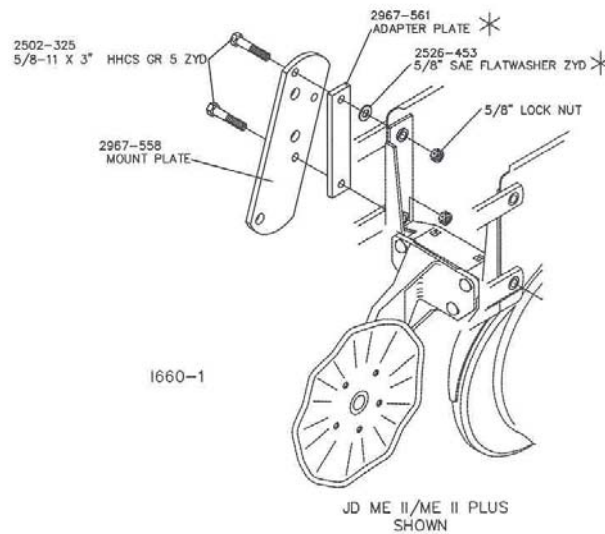

**STEP 2.** Assemble the quick adjust. Attach the 2) 2984-319 spacer bushings to the 2967-559 slide bar using 2) 1/2” x 1 3/4” bolts and lock nuts. Attach the 2967-560 quick adjust plate and 2967-562 handle to the 2967-559 slide bar using the 1/2” x 3” flat head bolt, 2550-769 spring, 6000-335 bushing and lock nut. Do not over tighten, the handle should be able to move on the 2967-560 adjustment plate when handle is pulled on and the spring compressed. Remove the rear upper L.H. bolt of the planter parallel linkage and attach the quick adjust assembly, 5/8” x 1” O.D. washer, 2967-557 spacer, 2967-558 mount plate, 2967-561 adapter plate and 5/8” flat washer using 1) 5/8” x 4” bolt and 5/8” lock nut. Remove the rear, lower L.H. bolt and attach the 2967-558 mount plate and 2967-561 adapter plate using 1) 5/8” x 3” bolt and 5/8” lock nut. Insert a 5/8” x 2” bolt through the 2967-558 mount plate, 2967-557 spacer, 5/8” x 1 O.D. washer, quick adjust assembly and locknut. Fully tighten all fasteners at this point.

\* PARTS NOT USED W/JD7000/KINZE 2000, 3000/WHITE 6000 ROW UNITS

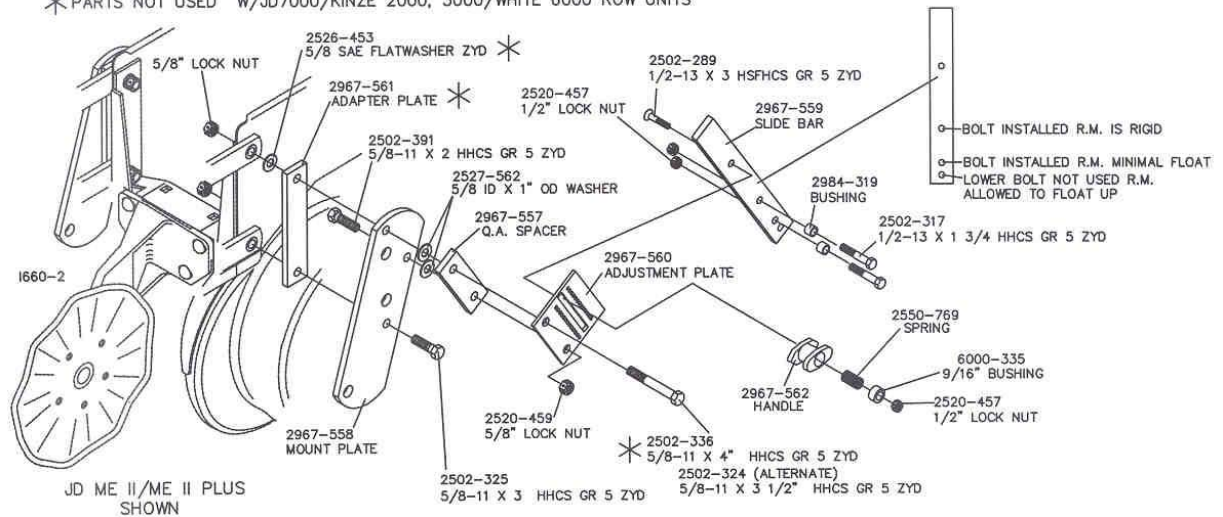

## ASSEMBLY INSTRUCTIONS

**STEP 3** Attach the 2967-273 combo arm to the R.H. 2967-558 mount plate using 1) 5/8" x 1 3/4" bolt, bushing, 5/8" flat washer and lock nut. Insert the 5/8" bolt through the middle hole of the combo arm.

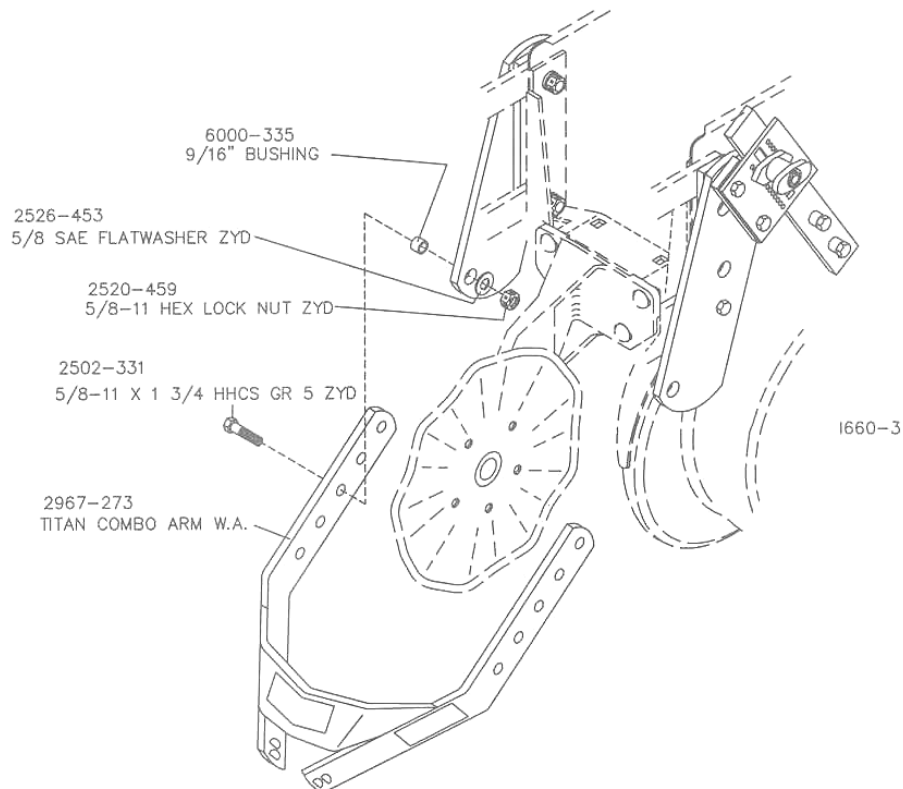

**STEP 4** Attach the 2967-273 combo arm and 29697-556 combo handle to the L.H. 2967-558 mount plate using 1) 5/8" x 2 1/2" bolt, bushing, 5/8" flat washer and 5/8" lock nut. Attach the 2967-556 combo handle to the 2967-273 combo arm using 1) 5/8" x 1 3/4" bolt and lock nut. Fully tighten all fasteners.

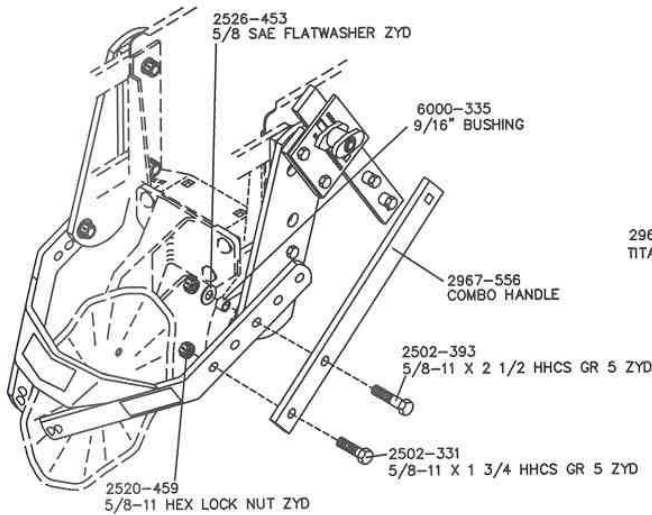

1660-4

**SIDE VIEW**

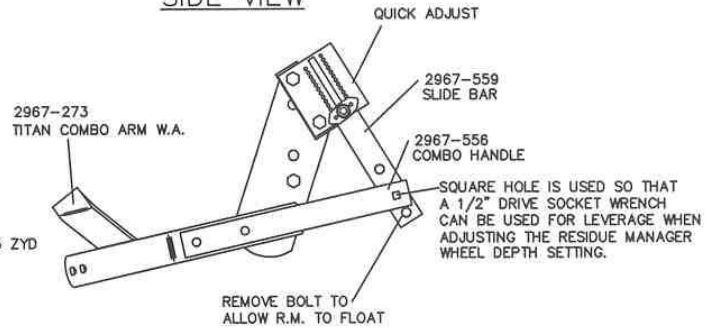

**ASSEMBLY INSTRUCTIONS**

**STEP 5.** Assemble the residue manager wheel to the hub and bearing.

NOTE: R.H. and L.H. wheel assemblies are needed.

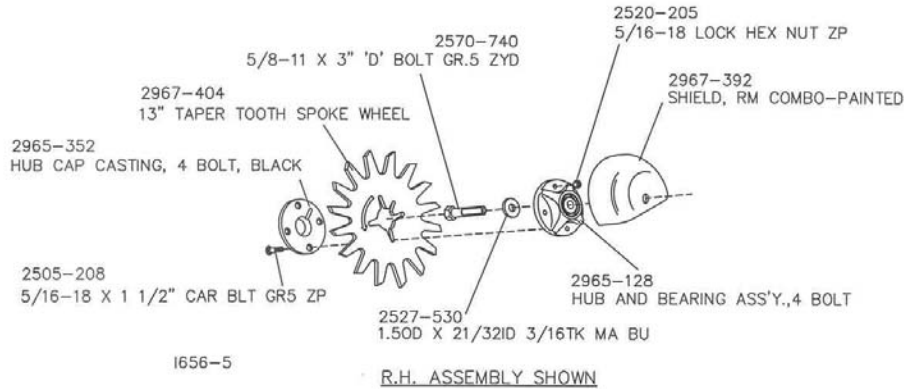

**IMPORTANT:** 2527-530 washers must be installed or Residue Manager Wheel and hub assembly will fall off during use.

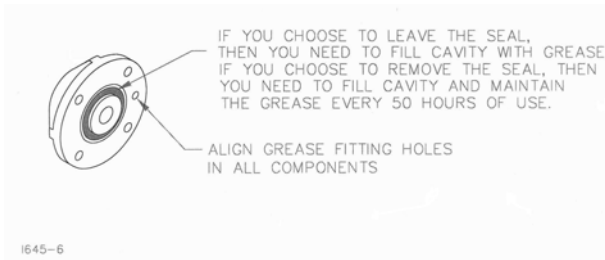

1645-6

L.H. — R.M. WHEEL ASSEMBLY



1656-6

NOTE: Remove the seal from the exposed side of the bearing if you choose to grease the bearing, otherwise the bearing is sealed.



NOTE: During assembly be sure to align the grease-fitting hole in all the components to assure proper lubrication of the bearing. Use a general-purpose grease before use of the Residue Managers.

**STEP 6.** Fasten the R.M. wheel assemblies to the 2967-273 combo arm using 5/8" lock washers and 5/8" hex nuts. Adjust the bearing shield to top dead center, rotated forward.

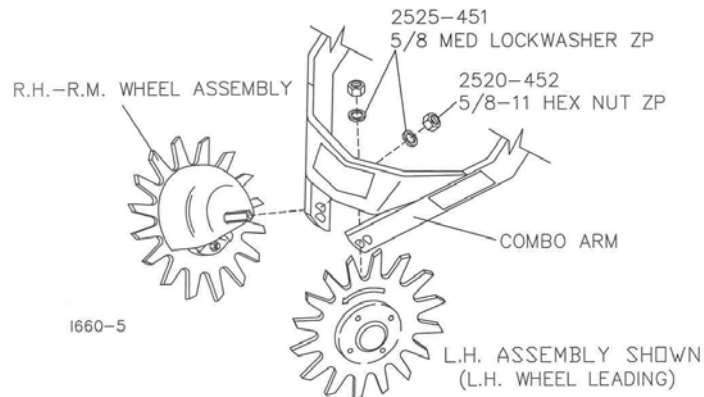

## OPERATION



**CAUTION:** Where rocks are present the residue manager should be set in the “float” position, not locked down.

**STEP 1.** Adjust the residue manager to move crop residue aside and not move any soil. Adjustments to the residue manager may have to be made when changing field conditions and type and amount of residue. Use a 1/2" drive socket wrench for leverage when changing depth settings. To adjust the R.M. wheels deeper, raise the quick adjust handle and to adjust the R.M. wheels shallower – lower the quick adjust handle. By removing the lowest bolt on the 2967-559 slide bar the residue manager wheels can be allowed to “float” and the quick adjust will act as a down stop. If residue managers are set to “float”, check for clearance with drive shafts and frames.

### ROW CLEANER DO'S AND DON'TS

1. **DO NOT** move soil; Residue Managers are designed to move crop residue only.
2. **DO NOT** operate planter at slow speeds, ground speed affects how aggressive the spoke wheels are; operate at sufficient speed (4-6 mph) to maintain good residue flow.
3. **DO NOT** expect 100% of crop residue to be cleared, it is not necessary and would necessitate engaging the soil. The width of path cleared depends on ground conditions, depth setting and ground speed.
4. **DO** expect to see wheels occasionally quit turning, indicates ideal (shallow) setting which is not moving soil.
5. **DO** adjust toolbar frame height 20"-22" and drawbar correctly. Very important to ensure planter opener will follow ground contours properly.

# MAINTENANCE

**STEP 1.** Regularly inspect the residue manager for loose or worn bolts. Repair and replace as needed.

**STEP 2.** If you choose to leave the seal, then you need to fill cavity with grease. If you choose to remove the seal, then you need to fill cavity and maintain the grease every 50 hours of use.

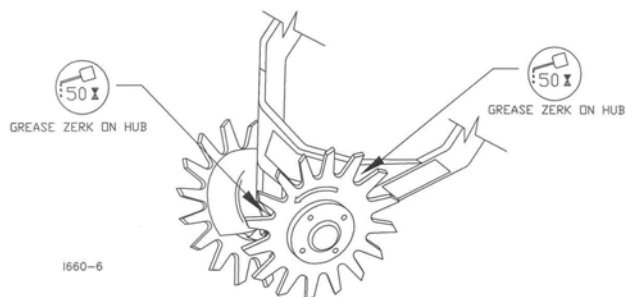

**IMPORTANT:** For proper operation, the planter frame must operate level (for, aft and side to side) and at the correct height, typically 20"-22".

# PARTS IDENTIFICATION

\* PARTS NOT USED W/JD7000/KINZE 2000, 3000/WHITE 6000 ROW UNITS

1660  
JD MEII/ ME II PLUS ROW UNIT ASSY SHOWN

2967-030 - TITAN RESIDUE MANAGER

KEY	QTY.	PART NO.	DESCRIPTION	KEY	QTY.	PART NO.	DESCRIPTION
1	8	2505-208	5/16-18 X 1 1/2 CAR BLT GR5 ZP	20	4	2526-453	5/8 SAE FLATWASHER ZYD
2	2	2965-352	HUB CAP CASTING, 4 BOLT, BLACK	21	2	2967-558	MOUNT PLATE
3	2	2967-404	13" TAPER TOOTH SPOKE WHEEL	22	1	2967-557	Q.A. SPACER
4	2	2570-740	5/8-11 X 3" "D" BOLT GR.5 ZYD	23	2	2967-561	ADAPTER PLATE
5	2	2527-530	1.500 X 21/32ID 3/16TK MA BU	24	3	2502-325	5/8-11 X 3 HHCS GR 5 ZYD
6	2	2570-594	BEARING, 2 ROW NTN# DF0654LU	25	1	2502-336	5/8-11 X 4 HHCS GR 5 ZYD (SHOWN)
7	2	2570-715	BEARING INSERT, TRASHMASTER	26	1	2502-324	5/8-11 X 3-1/2 HHCS GR 5 ZYD (ALTERNATE BOLT)
8	2	2965-351	HUB CAST, MACHINED, 4 BOLT	27	3	2502-391	5/8-11 X 2 HHCS GR 5 ZYD
9	2	2550-052	SEAL, CR# 13548	28	3	2520-357	1/2-13 HEX LOCK NUT ZYD
10	2	2965-128	HUB AND BEARING ASS'Y., 4 BOLT	29	3	6000-335	9/16" BUSHING
11	8	2520-205	5/16-18 LOCK HEX NUT ZP	30	1	2550-769	SPRING, ADJUSTMENT PIN, ZYD
12	2	2527-562	5/8ID X100 X.049+-002 M BU ZP	31	1	2967-562	Q.A. HANDLE (1/2")
13	2	2967-273	TITAN COMBO ARM W.A.	32	1	2967-560	Q.A. PLATE
14	2	2520-452	5/8-11 HEX NUT ZYD	33	2	2502-317	1/2-13 X 1 3/4 HHCS GR 5 ZYD
15	2	2525-451	5/8 MED LOCK WASHER ZYD	34	2	2984-319	SPACER BUSHING, GUIDE PLATE
16	8	2520-459	5/8-11 HEX LOCK NUT ZYD	35	1	2967-559	SLIDE BAR
17	1	2502-393	5/8-11 X 2 1/2 HHCS GR 5 ZYD	36	1	2502-289	1/2-13 X 3 HSFHCS GR 5 ZYD
18	2	2502-331	5/8-11 X 1 3/4 HHCS GR 5 ZYD	37	2	2967-392	SHIELD, RM COMBO-PAINTED
19	1	2967-556	COMBO HANDLE	38	2	2565-162	YETTER DECAL, 1-1/2 X 4-1/2
					1	2565-340	NOT A HANDLE WARNING DECAL

# TROUBLESHOOTING

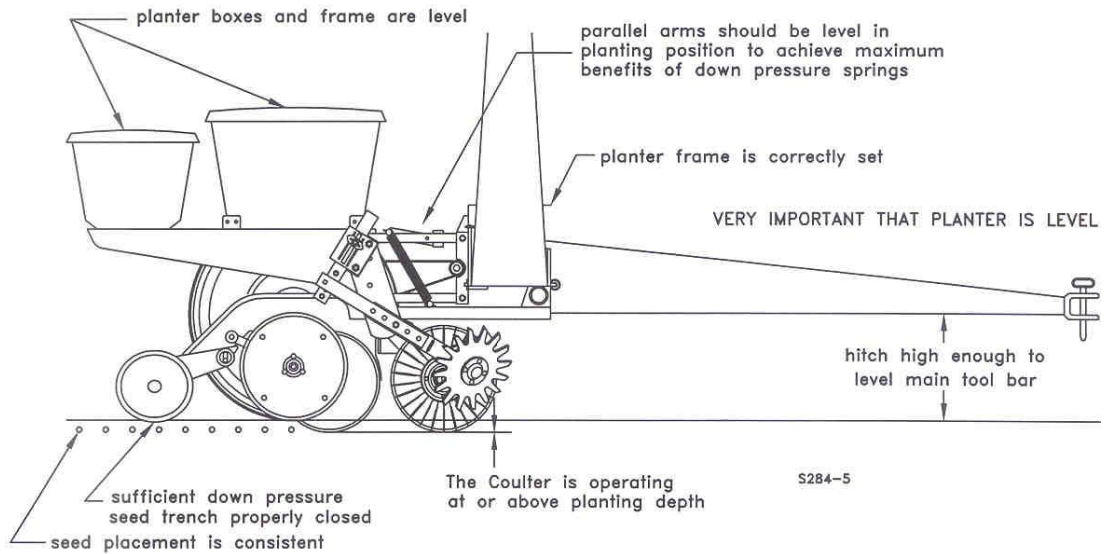

**Figure A. (Correct)**

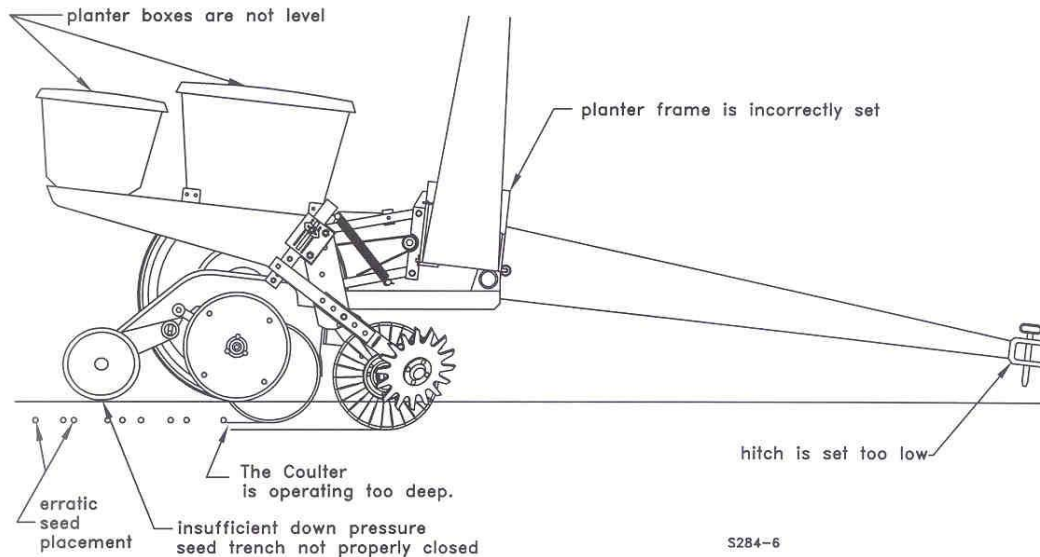

**Figure B. (Incorrect)**

**Figure A.** – The planter frame is 20” off the ground. To ensure this, visually check to see that the planter boxes are level and that the planter unit parallel arms are also parallel with the ground. **When using planter attachments located in front of the planter unit, this setting is very important.**

**Figure B.** – The planter hitch is set too low while the planter remains at 20” off the ground. Notice from the illustration that the unit mounted coulter is running deeper in the ground.

Note – Both illustrations are strictly for reference only. They are intended to show that proper adjustment of the hitch height is crucial. Consult your planter operator’s manual for the proper height adjustment of the hitch.

Note – The drawbar extension kit (6600-128) offered by Yetter Mfg. Co. may be used to alleviate the condition shown in figure B.

# Our name Is getting known

Just a few years ago, Yetter products were sold primarily to the Midwest only. Then we embarked on a program of expansion and moved into the East, the South, the West and now north into Canada. We're even getting orders from as far away as Australia and Africa.

So, when you buy Yetter products . . .you're buying a name that's recognized. A name that's known and respected. A name that's become a part of American agriculture and has become synonymous with quality and satisfaction in the field of conservation tillage.

Thank you.

**YETTER MANUFACTURING CO.**  
Colchester, IL 62326-0358 ☎ 309/776-4111  
Toll Free 800/447-5777  
Fax 309/776-3222  
Website: [www.yetterco.com](http://www.yetterco.com)  
E-mail: [info@yetterco.com](mailto:info@yetterco.com)