

Yetter

...for land's sake

2900 SERIES RIGID PLOW COULTER PARTS & INSTALLATION

RIGID DISC-CHISEL COULTER

KEY.	PART NO.	DESCRIPTION	QTY.
1	2900-110	1-1/4" SLEEVE (OPTIONAL)	1
2	2900-111	1-3/8" SLEEVE (OPTIONAL)	1
3	2900-104	BRACKET W.A.	1
	2900-124	RIGID BRACKET AND HUB ASSEMBLY	
4	2900-109	LOCKING COLLAR	1
5	2503-387	5/8-11 X 1-3/4 SQ.HCPSS GR2 ZP	1
6	2571-153	16" BUBBLE FLUTE COULTER BLADE	OPT.
	2571-167	17" RIPPLE BLADE	OPT.
	2571-168	20" RIPPLE BLADE	OPT.
	2571-154	1" FLUTED COULTER (17")	OPT.
7	2900-108	COULTER SPINDLE	1

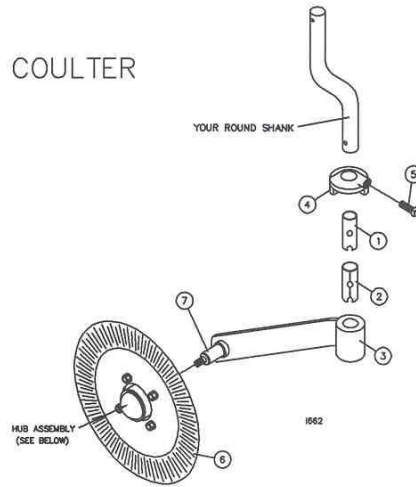

INSTALLATION AND OPERATING INSTRUCTIONS

Caution: COULTER BLADE HAS SHARP EDGE.
USE CARE WHEN WORKING WITH OR CLOSE TO BLADES

The 2900 series coulters come to you partially assembled. Remove any burrs from the lower end of your round shank and install any sleeves needed to fit shank tube into shank. (Shank tube is designed to fit 1-1/2" SHANK. Sleeve number 2900-111 is to be used for 1-3/8" shanks and numbers 2900-110 and 2900-111 both must be used on 1-1/4" shanks. Shank sleeves are not included in the units above. Please order sleeves separately.)

NOTE: Sleeves or shank tube must fit above retainer pin or cotter key in your shank. If none exists in your shank, drill a 5/16" or larger hole in your shank to accommodate a cotter key.

Place the coulters and locking collar over the shank (and sleeves, if used) then insert pin through the retainer hole. After aligning coulters for proper position, tighten setscrew in locking collar in center of slot in hinge casting for maximum swivel.

The Yetter coulters are equipped with automotive type tapered bearings; and are pre-lubricated during assembly. Grease the hub assembly periodically during use.

PERIODICALLY CHECK NUTS TO BE SURE THEY ARE TIGHT.

2910 AND 2900 SERIES HUB ASSEMBLIES

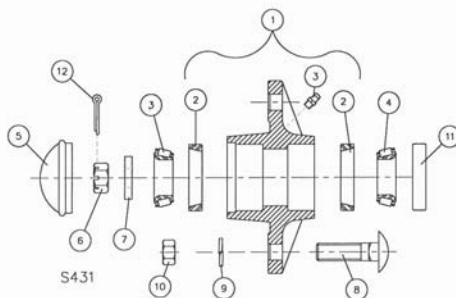

DET	QTY	PART NO.	DESCRIPTION
1	1	2900-105	HUB PRESSED ASSEMBLY
2	REF.	2550-029	LM67010 CUP (PRE-ASSEMBLED W/NO. 1)
3	REF.	2533-110	1/4-28 ZERK STRAIGHT SELF-TAP (PRE-ASSEMBLED W/NO. 1)
4	2	2550-027	LM67048 CONE
5	1	2570-375	HUB CAP
6	1	2520-469	5/8-18 SLOTTED HEX NUT, BLACK
7	1	2526-449	5/8" FLATWASHER, 1/4" THK.
8	4	2505-339	1/2-13 X 1-1/2 CAR BLT GR 5 ZYD
9	4	2525-352	1/2" MED LOCKWASHER ZYD.
10	4	2520-352	1/2-13 HEX NUT ZYD
11	1	2550-066	TRIPLE LIP SEAL, NTI #1812-4
12	1	2531-102	1/8 X 1/4 COTTER PIN, BLACK
		2900-123	HUB ASSEMBLY (INCLUDES #'S 1 THRU 11)

UPDATED 03/18/08

Yetter

Yetter

for land's sake

2910 SERIES SPRING CUSHIONED PLOW COULTER PARTS & INSTALLATION

KEY.	QTY.	PART NO.	DESCRIPTION
1	1	2502-410	3/4-16 x 3" HHCS GR5 ZP
2	1	2531-125	1/4 x 1 3/4" COTTER KEY
3	1	2526-561	1-17/64"IDx 7/8"x14GA MACHINERY BUSHING
4	1	2910-320	PIVOT CASTING
5	1	2910-311	SPRING
6	1	2910-302	SPRING BUSHING
7	1	2520-515	3/4-10 LOCK HEX NUT ZP
8	1	2520-508	3/4-16 HEX NUT ZP
9	1	2570-125	EYEBOLT, 3/4" EYE
10	1	2520-511	3/4-16 LOCK HEX NUT ZP
11	1	2910-205	COULTER ARM W.A.
	1	2910-119	COULTER BRACKET ASSEMBLY
	1	2910-127	SPRING CUSHIONED BRKT. AND HUB ASSEMBLY
12	1	2900-110	1 1/4" SHANK SLEEVE
13	1	2900-111	1 3/8" SHANK SLEEVE
14	1	2910-301	LOCKING COLLAR
15	1	2503-379	5/8"-11 x 1 SQ. HCPSS GR. 2
16	OPT.	2571-076	20" RIPPLE BLADE
	OPT.	2571-077	17" RIPPLE BLADE
	OPT.	2571-153	16" BUBBLE FLUTED BLADE
	OPT.	2571-154	1" FLUTED COULTER BLADE (17")

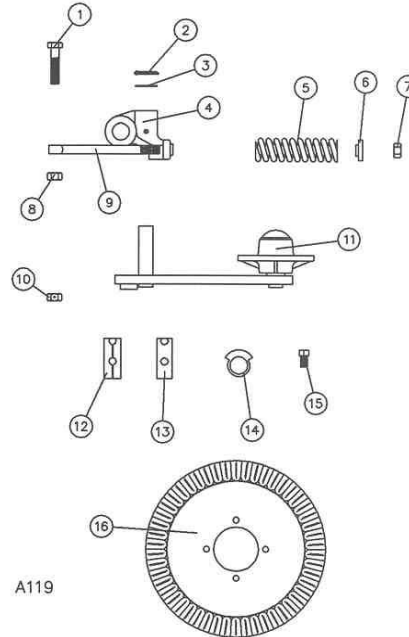

INSTALLATION AND OPERATING INSTRUCTIONS



**Caution: COULTER BLADE HAS SHARP EDGE.
USE CARE WHEN WORKING WITH OR CLOSE TO BLADES**

The 2910 series coulters come to you partially assembled. Remove any burrs from the lower end of your round shank and install any sleeves need to fit shank tube into shank. (Shank tube is designed to fit 1-1/2" shank. Sleeve number 2900-111 must be used for 1-3/8" shanks and part numbers 2900-110 and 2900-111 are both used on 1-1/4" shanks. Shank sleeves are not included in the units above. Please order sleeves separately.)

NOTE: Sleeves or shank tube must fit above retainer pin or cotter key in your shank. If none exists in your shank, drill a 5/16" or larger hole in your shank to accommodate a cotter key.

Place the coulters and locking collar (2900-301) over the shank (and sleeves, if used) then insert pin through the retainer hole. After aligning coulters for proper position, tighten setscrew in locking collar (make sure the set screw is through the notch in the sleeves and seated in your round shank). When tightening setscrew, align locking collar in center of slot in hinge casting for maximum swivel.

The Yetter coulters are equipped with automotive type tapered bearings; and are pre-lubricated during assembly. Grease the zerk on the hinge casting (2910-320) prior to using the coulters then grease the hinge casting and hub assembly on a periodic basis. Before going to the field, check the springs to be sure they have been given a preload tension. If the spring can be rotated on the push rod by hand, it is too loose and must be tightened. Failure to do so may result in lost parts or excessive wear. Approximately one inch of threads on the end of the push rod should be exposed when the spring is properly preloaded.

PERIODICALLY CHECK ALL NUTS TO BE SURE THEY ARE TIGHT.

YETTER MANUFACTURING CO.

FOUNDED 1930

Colchester, IL 62326-0358

Toll free: 800/447-5777

309/776-3222 (Fax)

Website: www.yetterco.com

E-mail: info@yetterco.com

Yetter