

Yetter

FARM EQUIPMENT

STALK DEVASTATOR ACCESSORIES

5000-080 – 5" EXTENSION KIT

5000-081 – JD HEAD EXTENSION KIT (2012-NEWER)

5000-082 – DEVASTATOR LIFT KIT

5000-083 – DEVASTATOR LOCK UP KIT (6 ROW)

5000-084 – DEVASTATOR LOCK UP KIT (8/12 ROW)

INSTALLATION INSTRUCTION

PART IDENTIFICATION

2565-961_REV_B – 08/2020



YETTER MANUFACTURING CO.

Founded 1930

Colchester, IL 62326

Toll free: (800)447-5777.

Fax: (309)776-3222

Website: yetterco.com

E-mail: info@yetterco.com

YETTER

TABLE OF CONTENTS

FOREWARD.....	2
SAFETY.....	3 – 5
5000-080 ASSEMBLY INSTRUCTIONS.....	6 – 8
5000-081 ASSEMBLY INSTRUCTIONS.....	9
5000-082 ASSEMBLY INSTRUCTIONS.....	10
5000-084 ASSEMBLY INSTRUCTIONS.....	11
PART IDENTIFICATION.....	12 – 14
PHOTOS.....	15 – 16
OPERATION.....	17
STORAGE/TRANSPORT.....	18

FOREWORD

You've just joined an exclusive but rapidly growing club.

For our part, we want to welcome you to the group and thank you for buying a Yetter product.

We hope your new Yetter products will help you achieve both goals-increase your productivity and increase your efficiency so that you may generate more profit.

This operator's manual has been designed into four major sections: Foreword, Safety Precautions, Installation Instructions and Parts Breakdown.



This **SAFETY ALERT SYMBOL** indicates important safety messages in the manual. When you see this symbol, be alert to the possibility of **PERSONAL INJURY** and carefully read the message that follows.

The word **NOTE** is used to convey information that is out of context with the manual text. It contains special information such as specifications, techniques and reference information of a supplementary nature.

The word **IMPORTANT** is used in the text when immediate damage will occur to the machine due to improper technique or operation.

Important will apply to the same information as specified by note only of an immediate and urgent nature.

It is the responsibility of the user to read the operator's manual and comply with the safe and correct operating procedure and to lubricate and maintain the product according to the maintenance schedule in the operator's manual.

The user is responsible for inspecting his machine and for having parts repaired or replaced when continued use of the product would cause damage or excessive wear to the other parts.

It is the user's responsibility to deliver his machine to the Yetter dealer who sold him the product for service or replacement of defective parts, which are covered by the warranty policy.

If you are unable to understand or follow the instructions provided in this publication, consult your local Yetter dealer or contact:

YETTER MANUFACTURING CO.

309/776-4111

800/447-5777

309/776-3222 (FAX)

Website: www.yetterco.com

E-mail: info@yetterco.com

WARRANTY

Yetter Manufacturing warrants all products manufactured & sold by it against defects in material. This warranty being expressly limited to replacement at the factory of such parts or products as shall appear to be defective after inspection. This warranty does not obligate the Company to bear cost of labor in replacement of parts. It is the policy of the Company to make improvements without incurring obligations to add them to any unit already sold. No warranty is made or authorized to be made, other than herein set forth. This warranty is in effect for one year after purchase.

DEALER: _____

Yetter Manufacturing warrants its own products only and cannot be responsible for damages to equipment on which mounted.

BE ALERT!

YOUR SAFETY IS INVOLVED



WATCH FOR THIS SYMBOL. IT POINTS OUT IMPORTANT SAFETY PRECAUTIONS. IT MEANS “ATTENTION – BE ALERT!”

It is your responsibility as an owner, operator, or supervision to know and instruct everyone using this machine at the time of initial assignment and at least annually thereafter, of the proper operation, precautions, and work hazards which exist in the operation of the machine in accordance with OSHA regulations.

Safety Is No Accident

The following safety instructions, combined with common sense, will save your equipment from needless damage and the operator from unnecessary exposure to personal hazard. Pay special attention to the caution notes in the text. Review this manual at least once a year with all operators.



1. Read and understand the operator's manual before operating this machine. Failure to do so is considered a misuse of the equipment.
2. Make sure equipment is secure before operating.
3. Always keep children away from equipment when operating.
4. Make sure everyone that is not directly involved with the operation is out of the work area before beginning operation.
5. Make sure all safety devices, shields, and guards are in place and functional before beginning operation
6. Shut off all power to adjust, service, or clean.
7. Keep hands, feet, and clothing away from moving parts. It is a good idea to remove all jewelry before operating.
8. Inspect the machine periodically during operation for signs of excessive wear, loose fasteners, and unusual noises.

PLEASE READ, VERY IMPORTANT



SECURE CORN HEADER AGAINST UNWANTED LOWERING BY APPLYING THE LOCKING MECHANISM ON THE HYDRAULIC CYLINDERS!



1. **Attach head to combine, lock head to combine**
2. **Raise the head off the ground and engage safety stop on the feeder house cylinder.**
3. **Apply combine parking brake, turn off combine engine, and remove the key**
4. **Wear personal protective equipment during installation: steel toe footwear, safety glasses, & gloves**

FOLLOW ALL INSTRUCTIONS GIVEN BY THE COMBINE MANUFACTURER

PLEASE READ, VERY IMPORTANT



Subject to the size and weight of the corn header, one or two additional hydraulic cylinders may be required.

The combine manufacturer generally keeps corresponding kits readily available for dealers.

Subject to the design of the corn header and the carrying capacity of different combines, the steering axle may require the fitting of additional weights and the rear tires be filled with ballast.

**FOLLOW ALL INSTRUCTIONS GIVEN BY THE COMBINE
MANUFACTURER**

5000-080 INSTALLATION

Purpose: Devastator Extension Kit will move the Devastator roller & roller tube back 5" from the standard positioning to increase the distance from the roller / tube & knife / snapping rolls.

***Tools Needed: Impact Wrench, 3/4" Impact Socket, and 3/4" Wrench**

****If adding the Extension Kit to an already installed Devastator, start at Step 1.**

*****If installing new Devastator & Extension Kit, start at Step 3.**

5000-080 BOM (per kit ordered)

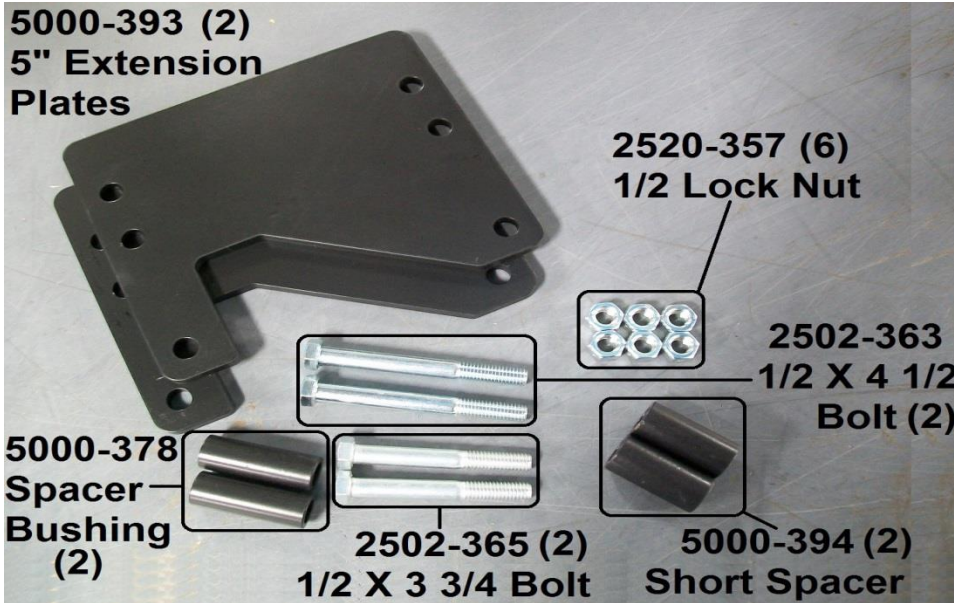

TOOLS NEEDED

- IMPACT
- 3/4" SOCKET
- 3/4" WRENCH



Step 1: Remove the Devastator roller from the roller mount tube by removing 3) 1/2" bolts from 1 bearing assembly. Drop the roller by sliding the shaft out of the bearing on the opposite end.



5000-080 INSTALLATION CONT'D

Step 2: Unbolt the roller mount tube from the Devastator pivot arms.

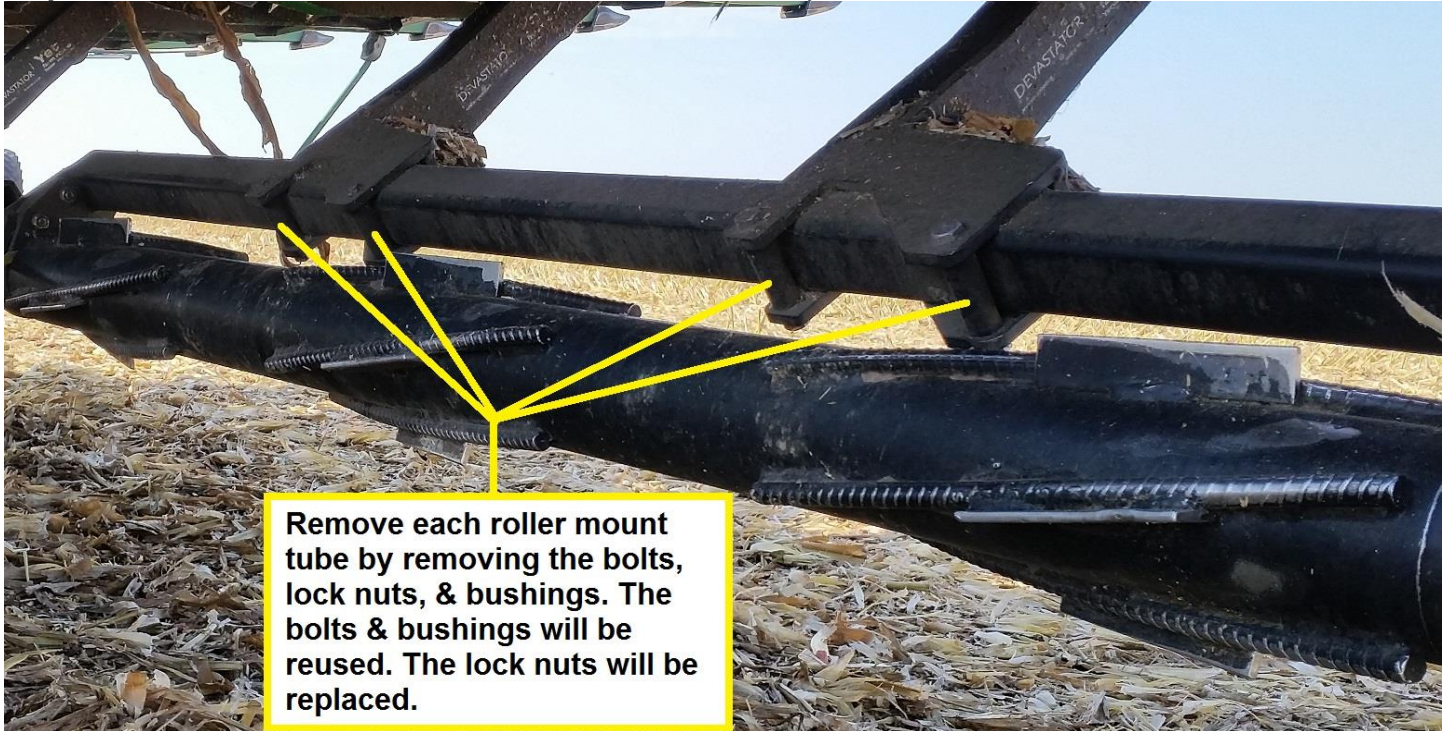

Step 3: Attach the Devastator extension plates to the existing pivot arms using the 2) 2502-363 ½"-13 X 4 ½" & 5000-394 shorter spacer through the front holes of the 5000-393 extension plate. Install the 2) 2502-365 ½"-13 X 3 ¾" & 5000-378 spacer bushing through the middle set of holes on the 5000-393 extension plates. The 5000-393 extension plates will set on top of the upper and lower plates on the pivot arm. The cutout on the extension plates should match that of the pivot arm.

***Install the bolts from the bottom up so the threads are facing corn head & not towards the ground**

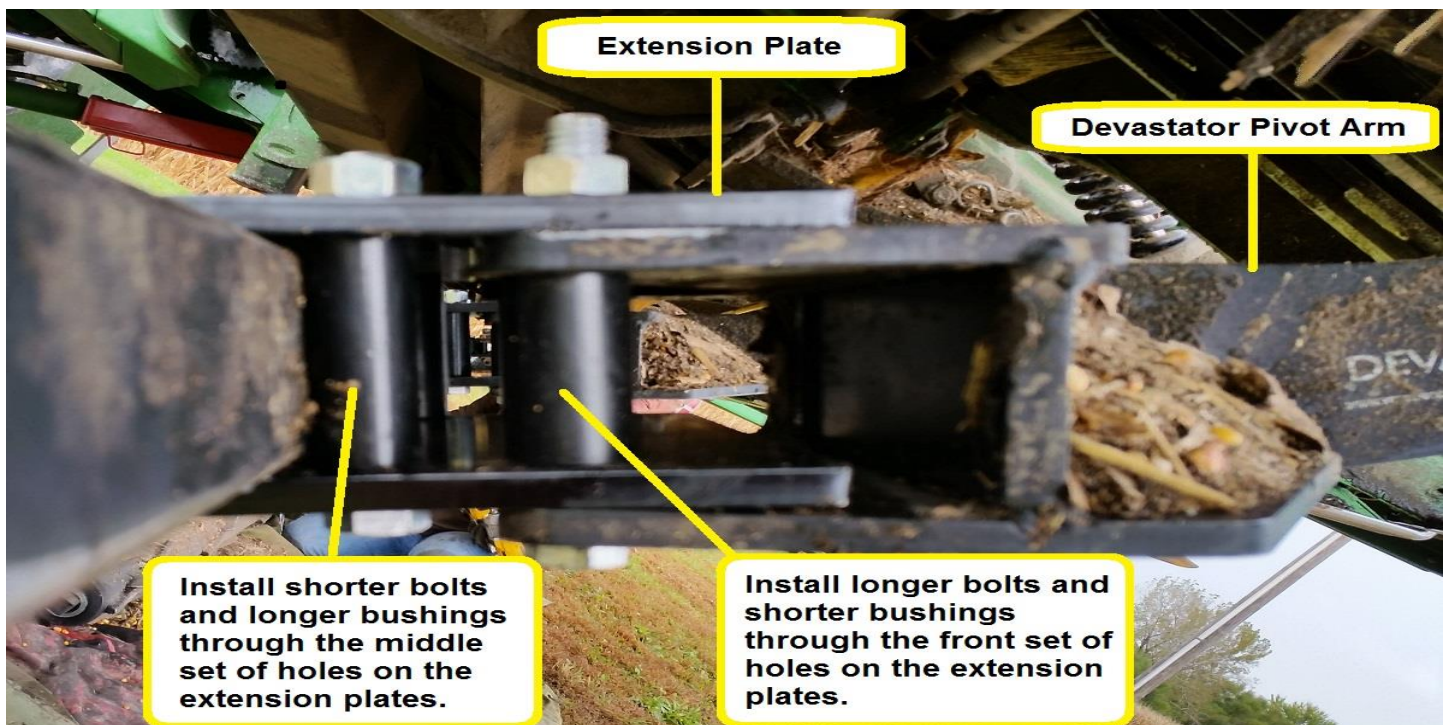

5000-080 INSTALLATION CONT'D

Step 4: Place the roller mount tube inside of the extension brackets similar to how the mount tube was originally installed into the Devastator pivot arm mount. Use the original bolts & bushings that were removed from the Devastator mount arms in **Step 2**.

***Install the bolts from the bottom up so the threads are facing corn head & not towards the ground**



Step 5: Install the roller back onto the roller mount arm by placing 1) 5000-322 shim washer on each end of the roller. Slide the shaft of the roller back into the bearing that was left installed on the roller mount tube. Place the bearing over the shaft at the other end of the roller, **making sure the side of the bearing assembly where the bearing is protruding outside of the cast housing is towards the roller!** Raise the roller into position to insert the 3) 1/2" bolts & then use the original nuts to secure the roller.



5000-081 INSTALLATION

NOTE: THE HEAD EXTENSION KIT IS ONLY COMPATIBLE WITH JD HEADS 2012-NEWER!

STEP 1: Place the extension bracket up against the bottom plate of the header stand with the welded in pivot bushing on the back side of the stand.

STEP 2: Install each mount plate over the pivot bushing. Install the 3) 1/2 X 7 1/2 bolts and flange nuts.

STEP 3: For transport on head trailer, insert L pin thru open hole on front side to lock the extension bracket in place & insert hairpin in L pin.

NOTE: For field operation, pivot extension bracket rearward & insert L pin thru open hole on back side to lock the extension bracket out of the way & insert hairpin in L pin.



TOOLS NEEDED:

IMPACT

3/4 SOCKET

3/4 WRENCH

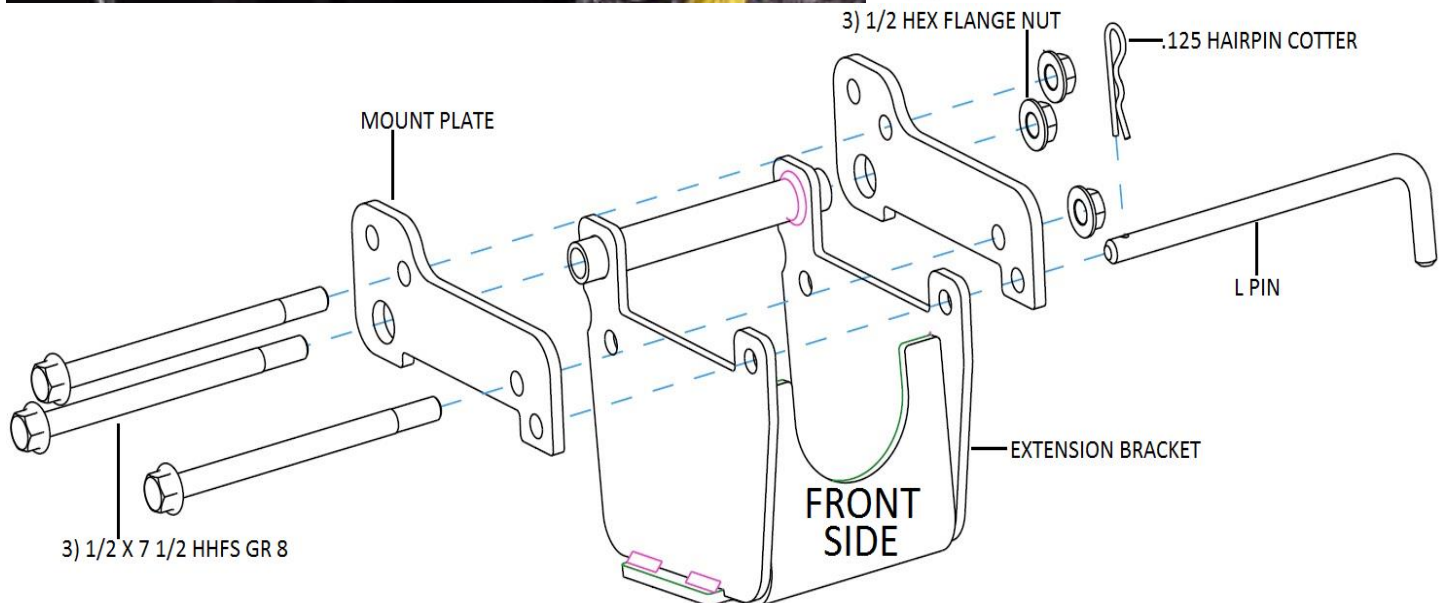

5000-082 INSTALLATION

STEP 1: Remove the 3/4" Lock nut from the pushrod to release the spring tension. Remove the shoulder bolt then rotate the pivot arm up so the lockup pin can be inserted.

STEP 2: Install the 5000-409 Connector pin and (2) extender plates on the pushrod and secure the extender plates to the pivot arm with the shoulder bolt and lock nut. The lockup pin will need to be removed. Install the 3/4" lock nut on the push rod.

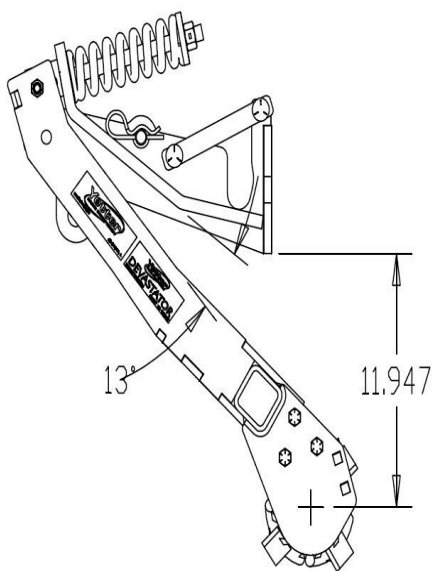
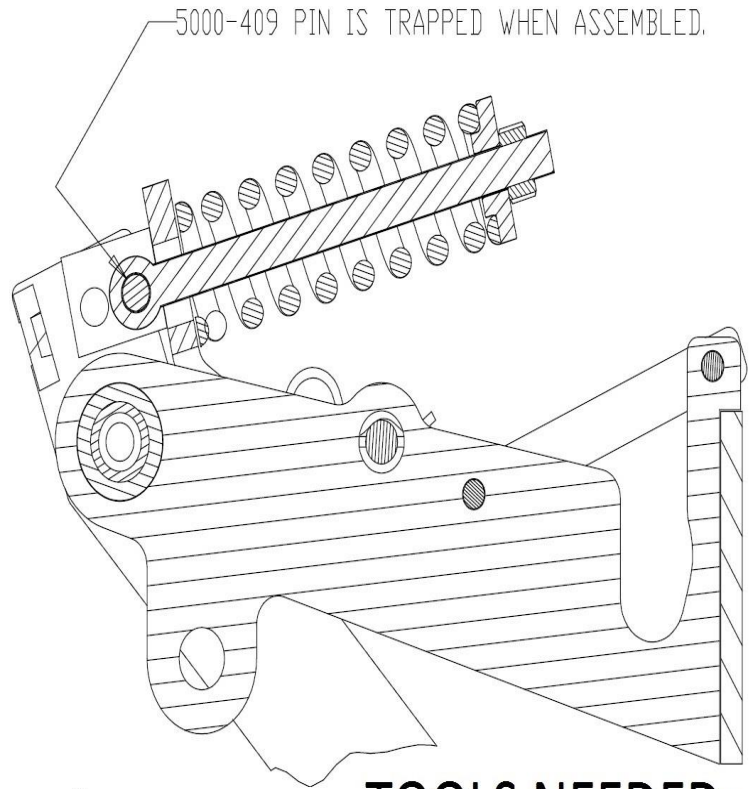
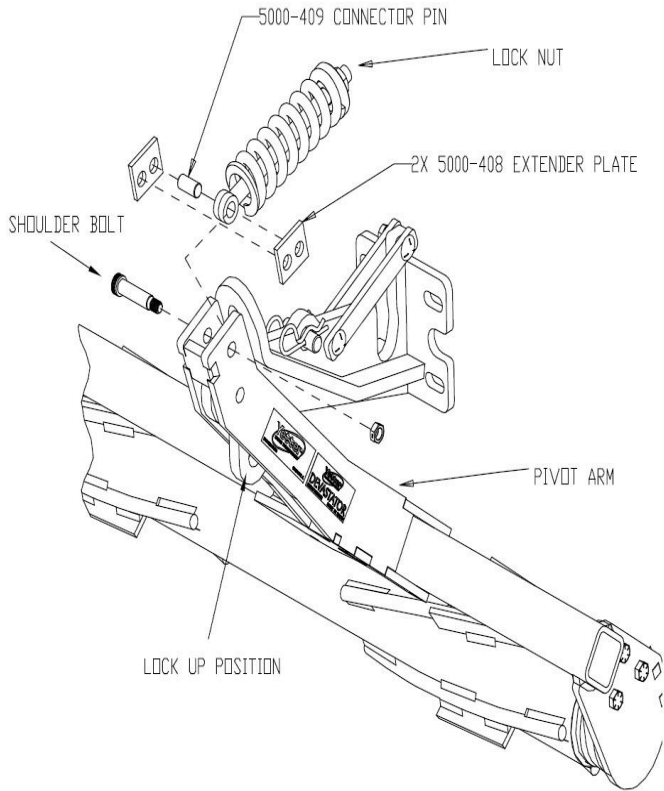

WITH 5000-082 KIT

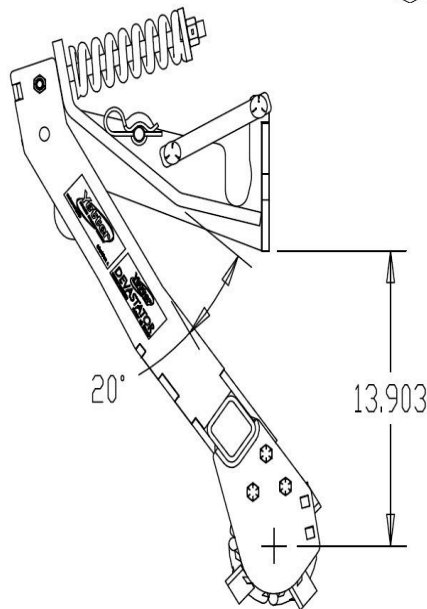

WITHOUT 5000-082 KIT

DEVASTATOR POSTIONS

TOOLS NEEDED:

5/16 ALLENWRENCH

3/4 WRENCH

1 1/8 WRENCH



5000-083 (6 ROW) & 5000-084 (8/12 ROW) INSTALLATION

NOTE: 5000-083 IS NOT COMPATIBLE WITH THE 5000-080 5" EXTENSION KIT

STEP 1: On 6 row heads, install the clamp plate & lock plate on the 3" X 4" frame, centered on the head to fit between the roller mount tubes.

On 8 row heads, install the clamp plate & lock plate on the 3" X 4" frame, on each side of the head, centered between the 3 row roller and 2 row roller to fit between the roller mount tubes.

On 12 row heads, install the clamp plate & lock plate on the 3" X 4" frame, on each side of the head, centered between the outer 3 row roller on each side & inner 3 row roller on each side to fit between the roller mount tubes.

STEP 2: To lock up the devastators, lower the head down, slide the locking pin into place.

To unlock the devastators, lower the head down to take pressure off the locking pin, remove locking pin.

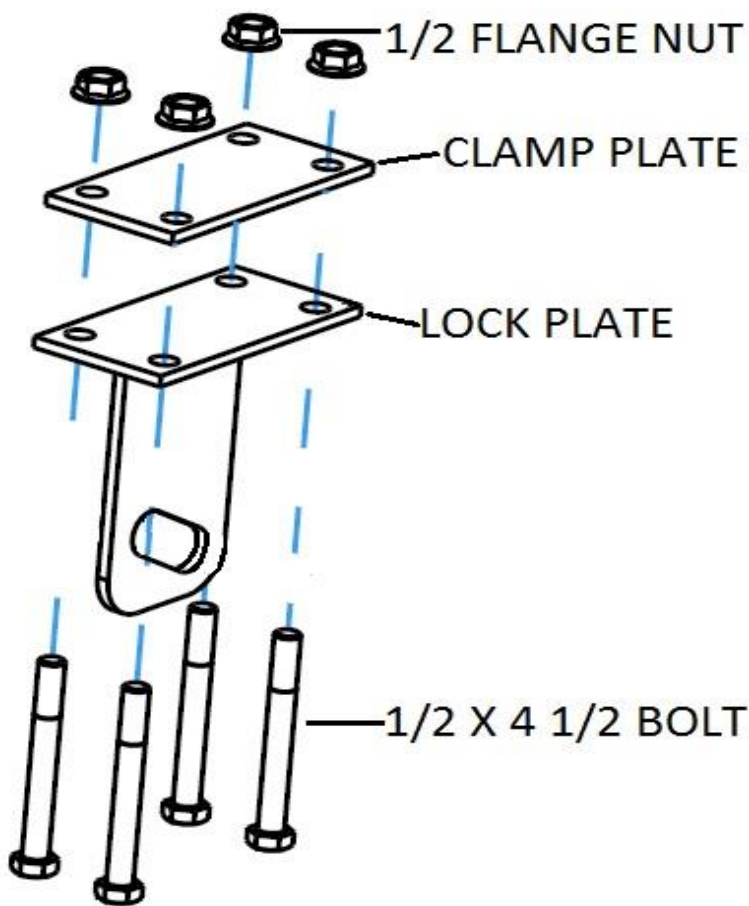

NOTE: LOCKING PIN CAN BE USED TO LOCK UP TORSION MODEL DEVASTATORS. LOWER CORN HEAD DOWN, SLIDE LOCK PIN THRU HOLE ON TORSION PIVOT SO THAT PIVOT ARM IS BEHIND THE LOCKING PIN. ON CNH/NH CORN HEADS WITH TORSION STYLE DEVASTATORS, LOCKING PIN WILL GO THRU HOLE ON TORSION PIVOT & HOLE IN THE PIVOT ARM, NOT IN FRONT OF THE ARM TO LOCK UP.

5000-080 PARTS IDENTIFICATION

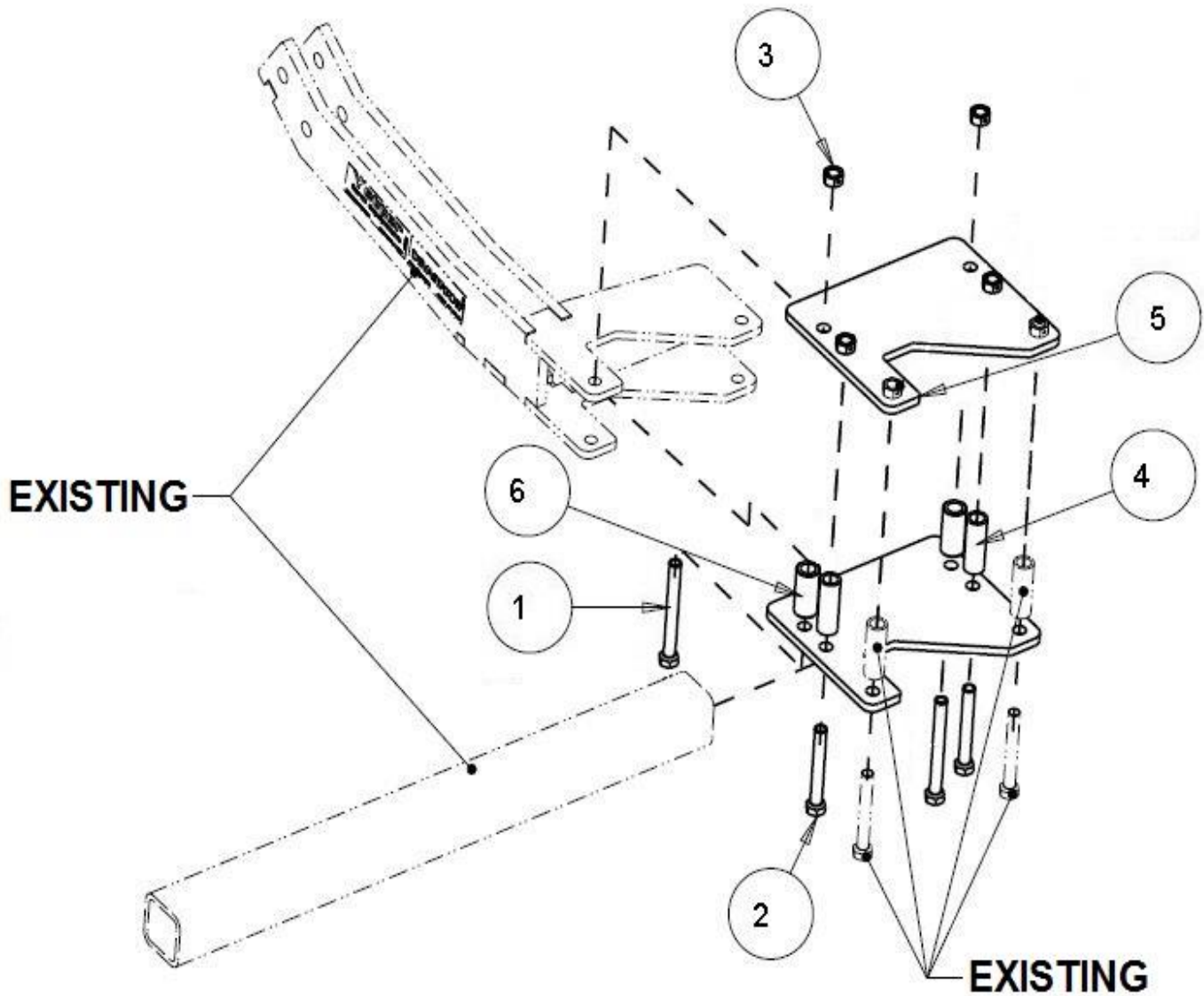

ITEM	PART NUMBER	DESCRIPTION	QUANTITY
1	2502-363	1/2 - 13 X 4 1/2 HHCS GR 5 ZP	2
2	2502-365	1/2 - 13 x 3 3/4 HHCS GR 5 ZP	2
3	2520-357	1/2 - 13 LOCK HEX NUT, GR A, ZP	6
4	5000-378	SPACER BUSHING	2
5	5000-393	5" EXTENSION PLATE	2
6	5000-394	SHORT SPACER	2

5000-081 PARTS IDENTIFICATION

ITEM	PART #	DESCRIPTION	QTY
1	2502-291	½ - 13 X 7 ½ HHFS GR 8 ZP	6
2	2520-368	½ - 13 HEX FLANGE NUT GR 3 ZP	6
3	2570-446	.125 HAIRPIN COTTER ZP	2
4	5000-265	EXTENSION BRACKET	2
5	5000-404	MOUNT PLATE	4
6	5000-407	L PIN	2

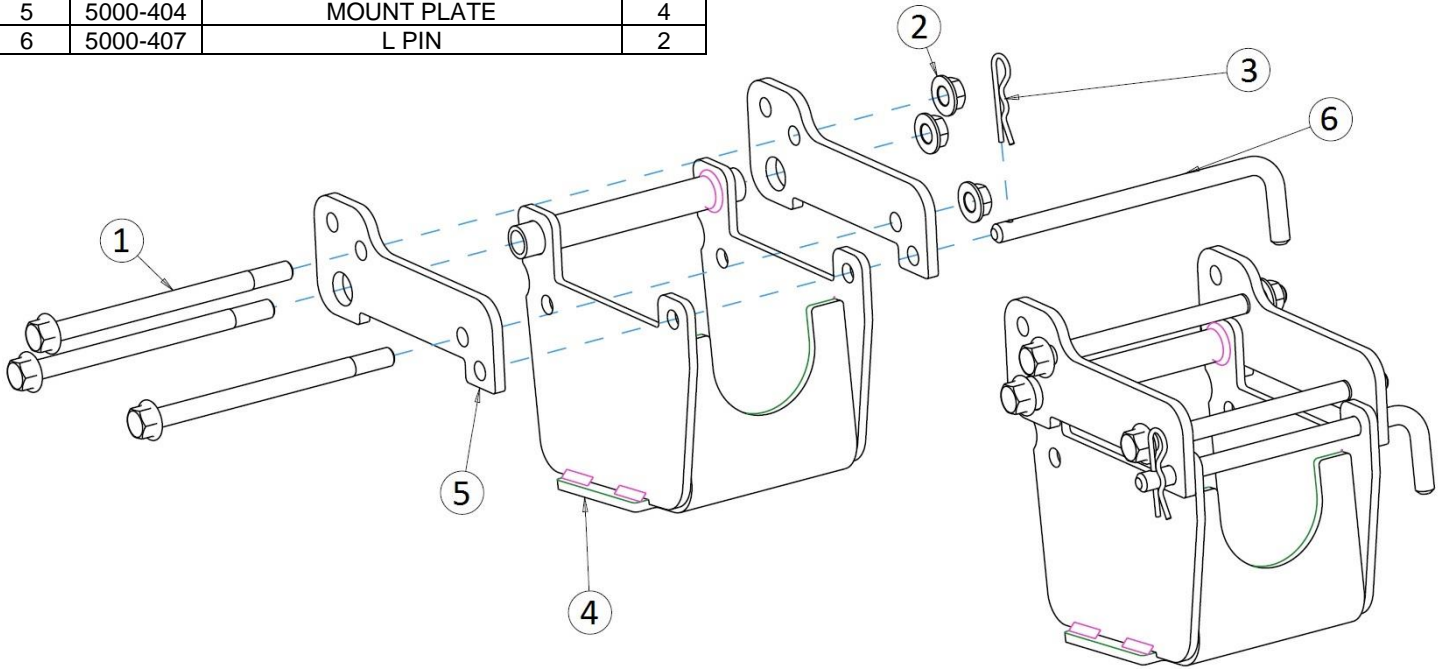

5000-082 PARTS IDENTIFICATION

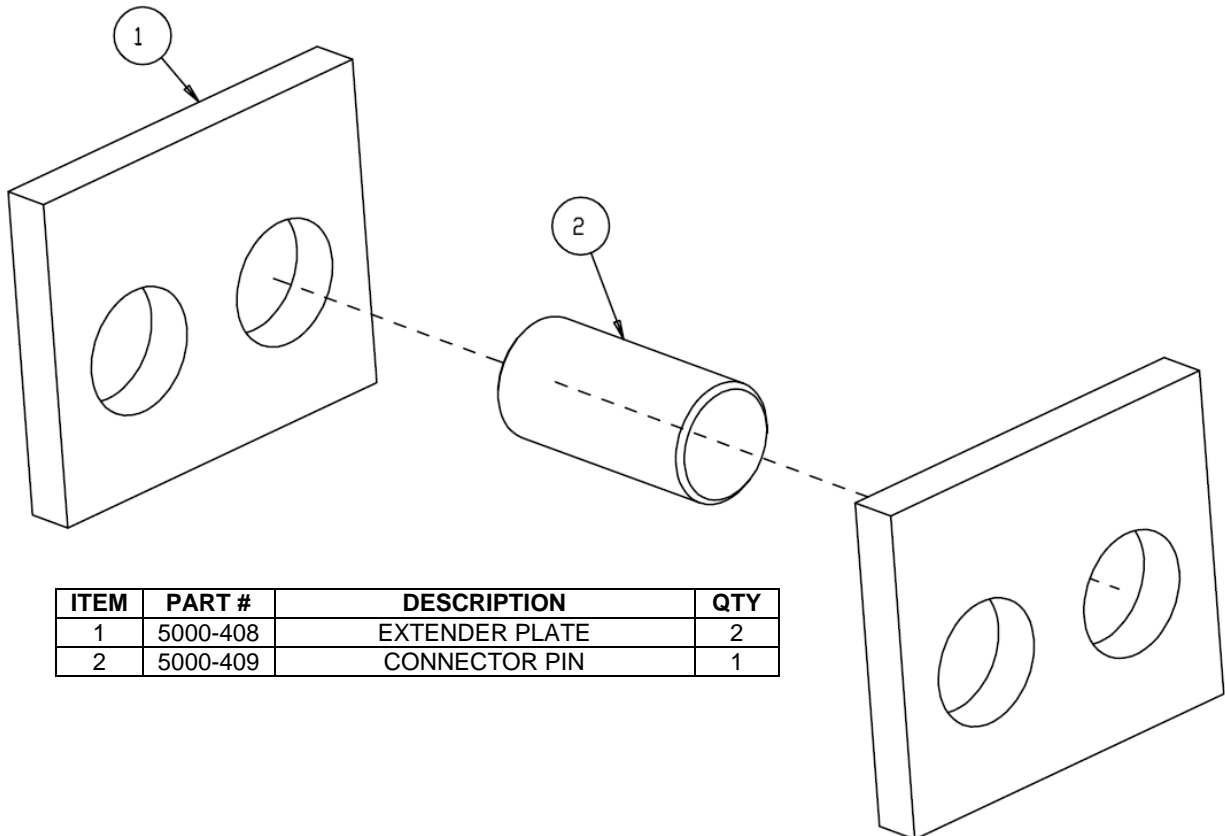

ITEM	PART #	DESCRIPTION	QTY
1	5000-408	EXTENDER PLATE	2
2	5000-409	CONNECTOR PIN	1

5000-083 & 5000-084 PARTS IDENTIFICATION

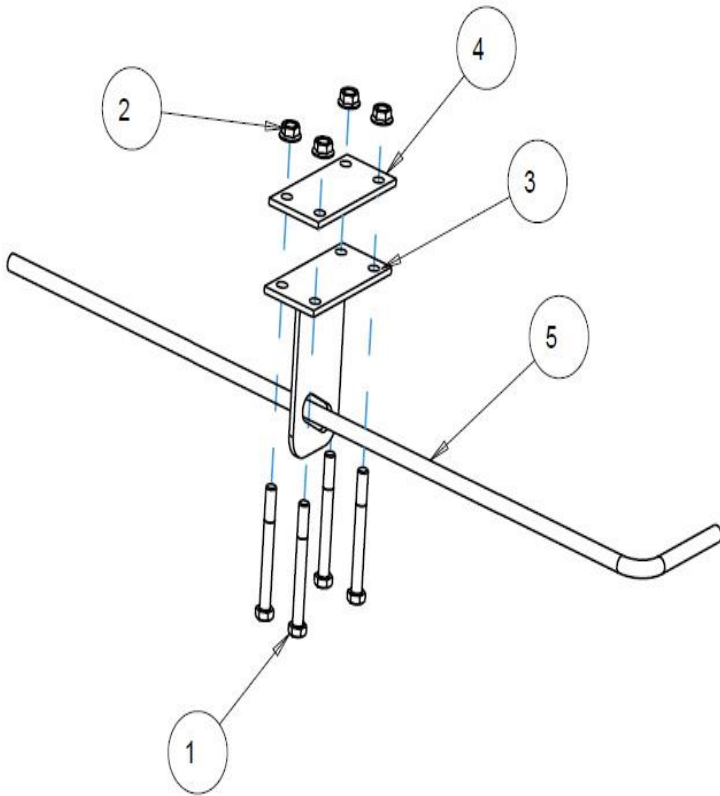

5000-083

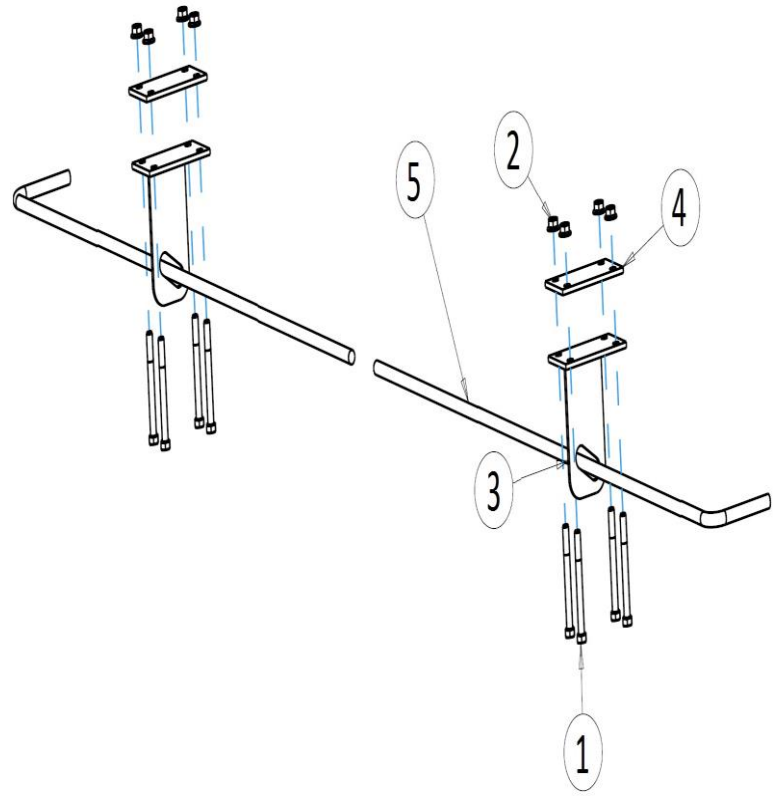

5000-084

ITEM	PART #	DESCRIPTION	QTY
1	2502-363	½ - 13 X 4 ½ HHCS GR 5 ZP	4
2	2520-361	½-13 FLANGE WHIZLOCK NUT GR 5 ZP	4
3	5000-276	LOCK PLATE W.A.	1
4	5000-428	CLAMP PLATE	1
5	5000-430	LOCK PIN	1

ITEM	PART #	DESCRIPTION	QTY
1	2502-291	½ - 13 X 4 ½ HHCS GR 5 ZP	6
2	2520-368	½-13 FLANGE WHIZLOCK NUT GR 5 ZP	6
3	2570-446	LOCK PLATE W.A.	2
4	5000-265	CLAMP PLATE	2
5	5000-404	LOCK PIN	4

5000-080 5" Set Back Kit Photos



5000-081 JD Head Stand Extension Photo



5000-082 2" Lift Kit Photo



5000-083 & 5000-084 Photo

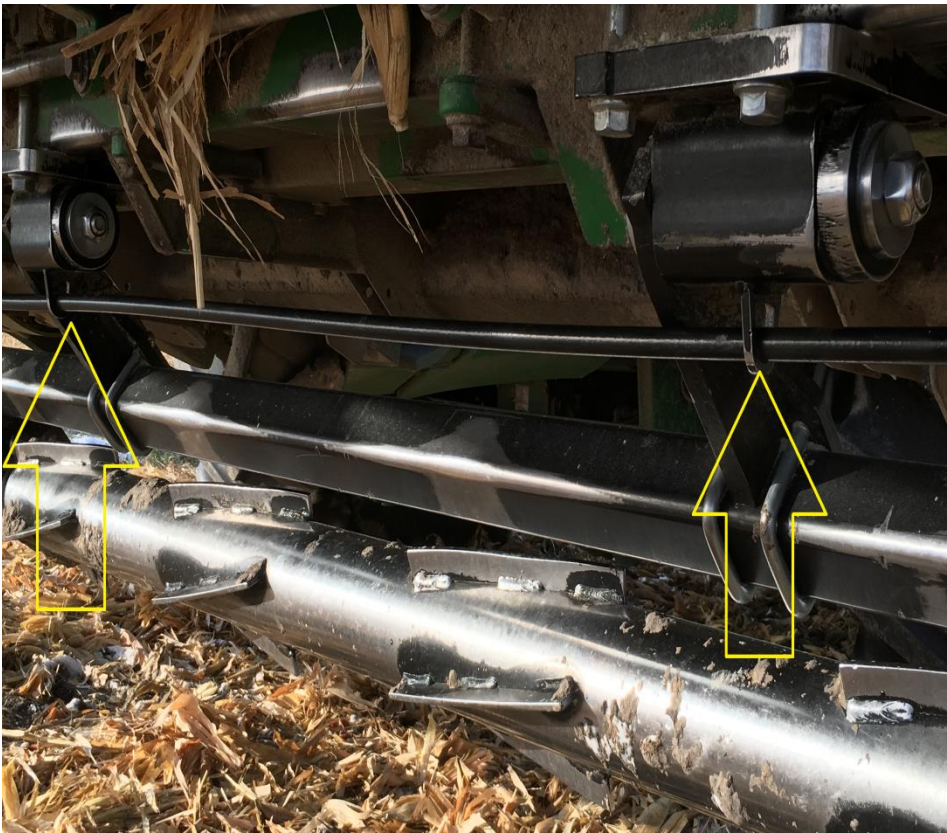

OPERATION

CORN HEAD ANGLE NEEDS TO BE ADJUSTED BETWEEN 23 – 25° FOR OPTIMUM DEVASTATOR PERFORMANCE.

USE THE 5000-455 TO CHECK CORN HEAD ANGLE:

- Put the combine on a level surface. Lower the Corn head to your normal working head height.
- Place the magnetic protractor on the stripper plate to get the angle. Adjust the feeder house as needed, fore or aft, to achieve 23 – 25 degrees.
- Adjust the snouts to raise/lower head to preferred head height.



1. Raise point (A) and lock latch (B).
2. Pull spring locking pin (C) and adjust height using location holes (D).
3. The points can also be fine adjusted by loosening jam nut (E) and adjusting cap screw (F) up or down.

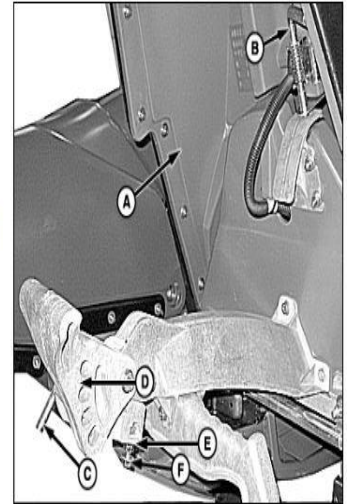

- A-Point
- B-Latch
- C-Locking Pin
- D-Location Hole
- E-Jam Nut
- F-Cap Screw

ADJUST SNOOT AS NEEDED WHEN SETTING THE CORRECT HEAD ANGLE

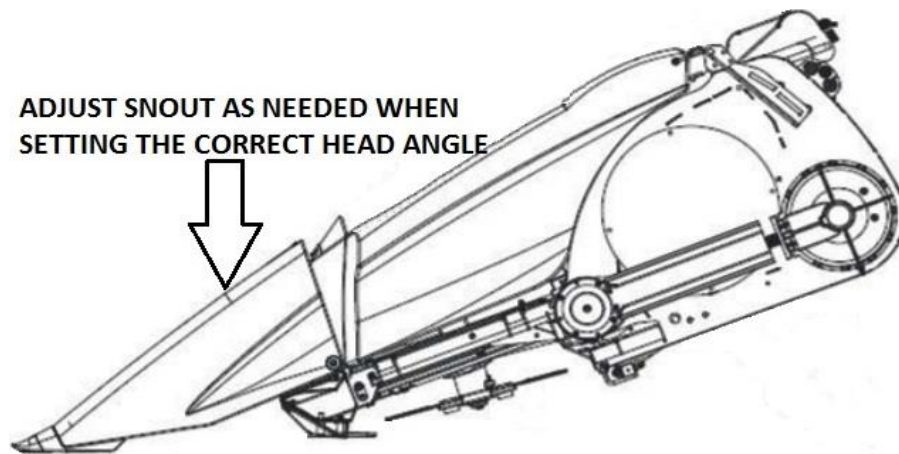

STORAGE/TRANSPORT

- Head cart may need adjusted to fit the head with devastator correctly. E.g. raising or fore/aft adjustment of saddles/top rail on the head cart.
- If head cart does not have these adjustments, adding a tube extension to top rail or adding extension to saddle/corn head may be required.
- Side to side tilt may need used to clear taller head cart tires or locking the devastator up.
- When disconnecting from the head, leaving pressure on the torsion pivot of the devastator will not damage the devastator.

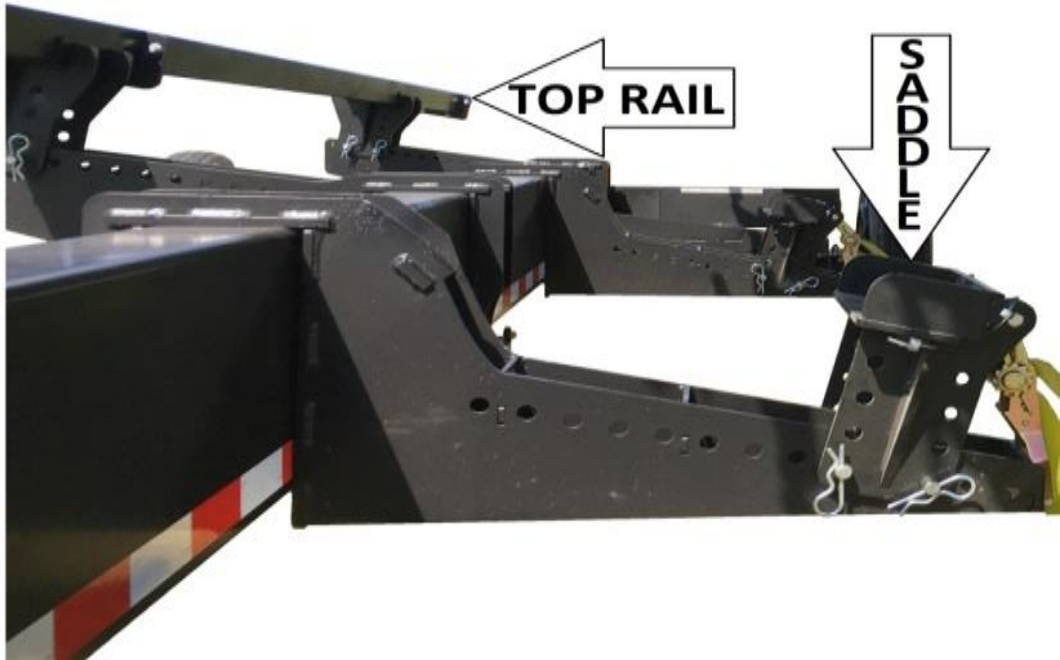

NOTES



A Tradition of Solutions since 1930

Yetter Farm Equipment Co

PO BOX 358 109 S. McDonough

Colchester, IL 62326-0358

Phone: 309-776-4111

Toll Free: 800-447-5777

Email: info@yetterco.com

For updated models and manuals visit the Yetter website:

www.yetterco.com

© Yetter Farm Equipment Co. All Rights Reserved

2565-961_REV_B – 08/2020