

Yetter

FARM EQUIPMENT

OWNER'S MANUAL
PART IDENTIFICATION

2565-950 11/2022

36"- 38" Row Devastator

5000-091, 5000-092, 5000-093



YETTER MANUFACTURING CO.

Founded 1930

Colchester, IL 62326

Toll free: (800)447-5777.

Fax: (309)776-3222

Website: yetterco.com

E-mail: info@yetterco.com

YETTER

TABLE OF CONTENTS

BOLT TORQUE..... 2
FOREWORD..... 3
SAFETY..... 4
INSTALLATION..... 5-8
OPERATION..... 8
PARTS IDENTIFICATION.....9-11



BOLT TORQUE





Important: Over-tightening hardware can cause just as much damage as under-tightening. Tightening hardware beyond the recommended range can reduce its shock load capacity.

All hardware is either Grade 5 unless otherwise noted. Grade 5 cap screws are marked with three radial lines on the head. Grade 8 cap screws are marked with six radial lines on the head. If hardware must be replaced, be sure to replace it with hardware of equal size, strength and thread type. Refer to the torque values chart when tightening hardware.

The chart below is a guide for proper torque. Use it unless a specified torque is called out elsewhere in the manual. Torque is the force applied to the end of the handle or cheater bar, times the length of the handle or bar. Tightening hardware beyond the recommended range can reduce its shock load capacity.

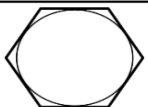
Use a torque wrench wherever possible

The following table shows torque in ft.-lbs. for coarse thread hardware.

Bolt Diameter and Threads per Inch	 Grade 2	 Grade 5	 A-325	 Grade 8
1/4	6	10		14
5/16	12	20		30
3/8 – 16	25	35		50
7/16 – 14	35	55		80
1/2 – 13	55	85		125
9/16 – 12	75	125		175
5/8 – 11	105	170		235
3/4-10	185	305		425
7/8 – 9	170	445		690
1-8	260	670		1030
1 1/8 – 7	365	900		1460
1 1/4 - 7	515	1275		2060
1 3/8 – 6	675	1675		2700
1 1/2 - 6	900	2150		3500
1 3/4 – 5	1410	3500		5600

FOREWORD

You've just joined an exclusive but rapidly growing club.

For our part, we want to welcome you to the group and thank you for buying a Yetter product.

We hope your new Yetter products will help you achieve both goals-increase your productivity and increase your efficiency so that you may generate more profit.

This operator's manual has been designed into four major sections: Foreword, Safety Precautions, Installation Instructions and Parts Breakdown.



This **SAFETY ALERT SYMBOL** indicates important safety messages in the manual. When you see this symbol, be alert to the possibility of **PERSONAL INJURY** and carefully read the message that follows.

The word **NOTE** is used to convey information that is out of context with the manual text. It contains special information such as specifications, techniques and reference information of a supplementary nature.

The word **IMPORTANT** is used in the text when immediate damage will occur to the machine due to improper technique or operation.

Important will apply to the same information as specified by note only of an immediate and urgent nature.

It is the responsibility of the user to read the operator's manual and comply with the safe and correct operating procedure and to lubricate and maintain the product according to the maintenance schedule in the operator's manual.

The user is responsible for inspecting his machine and for having parts repaired or replaced when continued use of the product would cause damage or excessive wear to the other parts.

It is the user's responsibility to deliver his machine to the Yetter dealer who sold him the product for service or replacement of defective parts, which are covered by the warranty policy.

If you are unable to understand or follow the instructions provided in this publication, consult your local Yetter dealer or contact:

YETTER MANUFACTURING CO.

309/776-4111

800/447-5777

309/776-3222 (FAX)

Website: www.yetterco.com

E-mail: info@yetterco.com

WARRANTY

Yetter Manufacturing warrants all products manufactured and sold by it against defects in material. This warranty being expressly limited to replacement at the factory of such parts or products as shall appear to be defective after inspection. This warranty does not obligate the Company to bear cost of labor in replacement of parts. It is the policy of the Company to make improvements without incurring obligations to add them to any unit already sold. No warranty is made or authorized to be made, other than herein set forth. This warranty is in effect for one year after purchase.

DEALER: _____

Yetter Manufacturing warrants its own products only and cannot be responsible for damages to equipment on which mounted.

BE ALERT!

YOUR SAFETY IS INVOLVED



WATCH FOR THIS SYMBOL. IT POINTS OUT IMPORTANT SAFETY PRECAUTIONS. IT MEANS “ATTENTION – BE ALERT!”

It is your responsibility as an owner, operator, or supervision to know and instruct everyone using this machine at the time of initial assignment and at least annually thereafter, of the proper operation, precautions, and work hazards which exist in the operation of the machine in accordance with OSHA regulations.

Safety Is No Accident



The following safety instructions, combined with common sense, will save your equipment from needless damage and the operator from unnecessary exposure to personal hazard. Pay special attention to the caution notes in the text. Review this manual at least once a year with all operators.

1. Read and understand the operator's manual before operating this machine. Failure to do so is considered a misuse of the equipment.
2. Make sure equipment is secure before operating.
3. Always keep children away from equipment when operating.
4. Make sure everyone that is not directly involved with the operation is out of the work area before beginning operation.
5. Make sure all safety devices, shields, and guards are in place and functional before beginning operation
6. Shut off all power to adjust, service, or clean.
7. Keep hands, feet, and clothing away from moving parts. It is a good idea to remove all jewelry before operating.
8. Inspect the machine periodically during operation for signs of excessive wear, loose fasteners, and unusual noises.

INSTALLATION INSTRUCTIONS

John Deere 644/694/606/706 5000-091

Arrows indicate 5000-187 Torsion Pivot locations

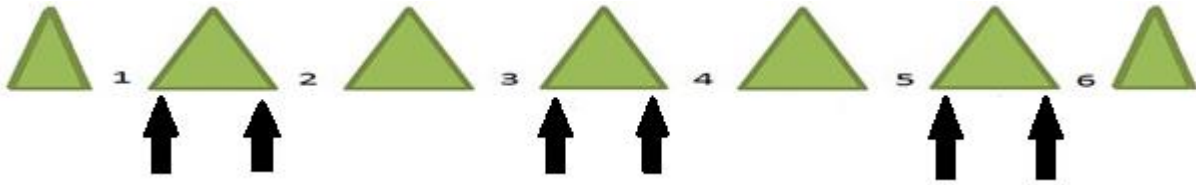

John Deere 844/894/608/708 5000-092

Arrows indicate 5000-187 Torsion Pivot locations

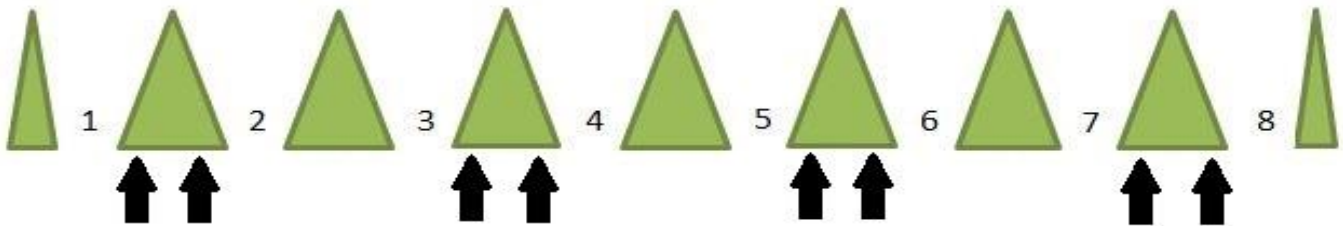

John Deere 1244/1294/612/712 5000-093

Arrows indicate 5000-187 Torsion Pivot locations

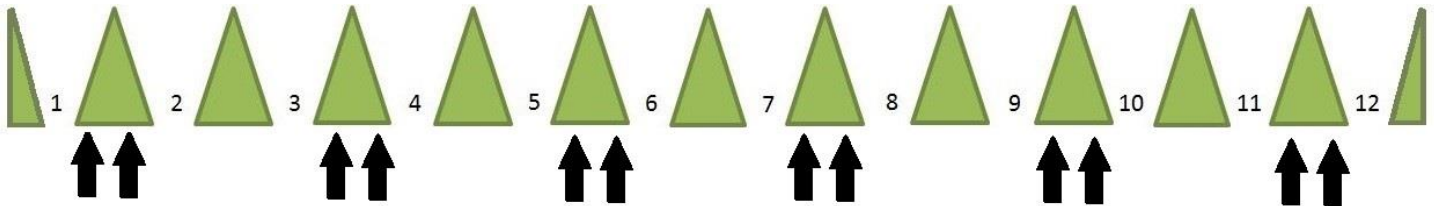

STEP 1:

Remove the row unit strap on the right hand side of row one, and the left hand side of row two. Install the torsion block by putting two 120MM bolts into the row unit mount holes, and two 110MM bolts into the threaded strap over top of the frame. Bolt locations indicated below by black arrows below. Ensure the lockup pin handles are facing each other. **Note: Torque the M16 bolts @ 236 ft. /lbs**

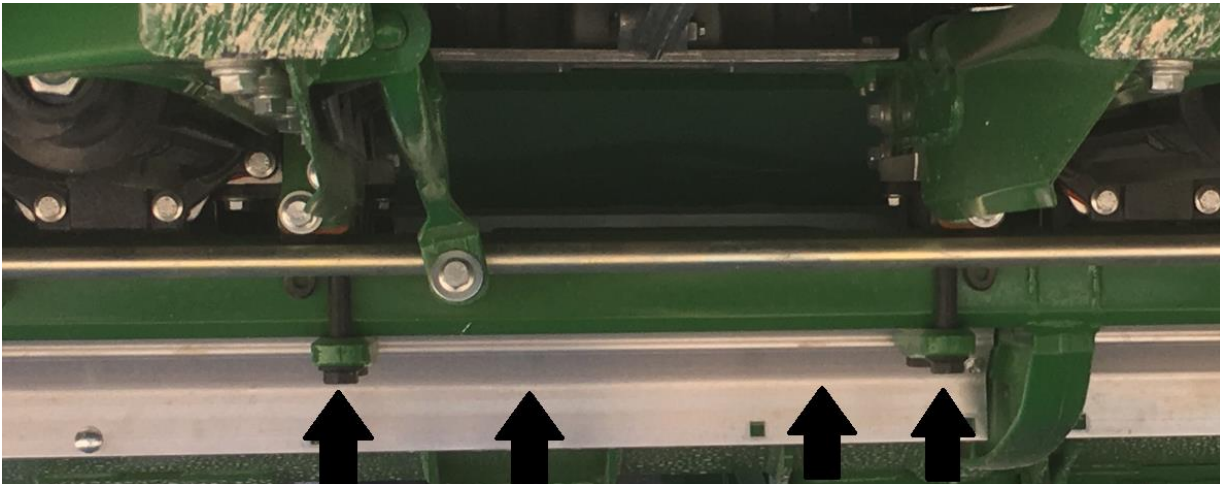

INSTALLATION INSTRUCTIONS

STEP 2:

Repeat step one for the rest of the torsion block mounts across the head. Page 5 has torsion block mount locations indicated by black arrows. Row one is always the left hand side of the head as you sit in the driver's seat.

STEP 3:

Install the torsion arm onto the torsion block opposite the lockup pin handles. Put the spacer with the square bore on the other side of the torsion block. Then use the 3/4" bolt, lock nut, and thick washers to secure. See diagrams below for reference.

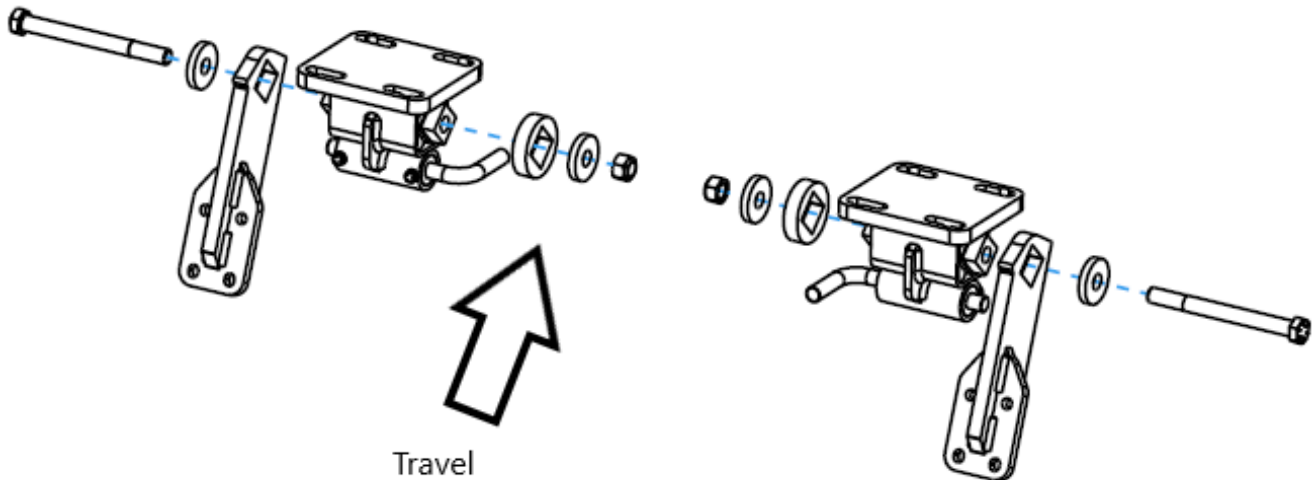

INSTALLATION INSTRUCTIONS

STEP 4:

Attach the square tube that holds the roller to the arms using the ½" U-bolts. Do not tighten the U-bolts until the roller is installed and centered on the row! Be sure the small bearing support tab on the bearing plate is on the back side facing the combine. Put the shim washer over the square shaft on each side of the roller, then put on the bearing and attach to the square tube using the ½" bolts and locknuts. Make sure the side of the bearing that is protruding out is towards the roller and away from the bearing plate.

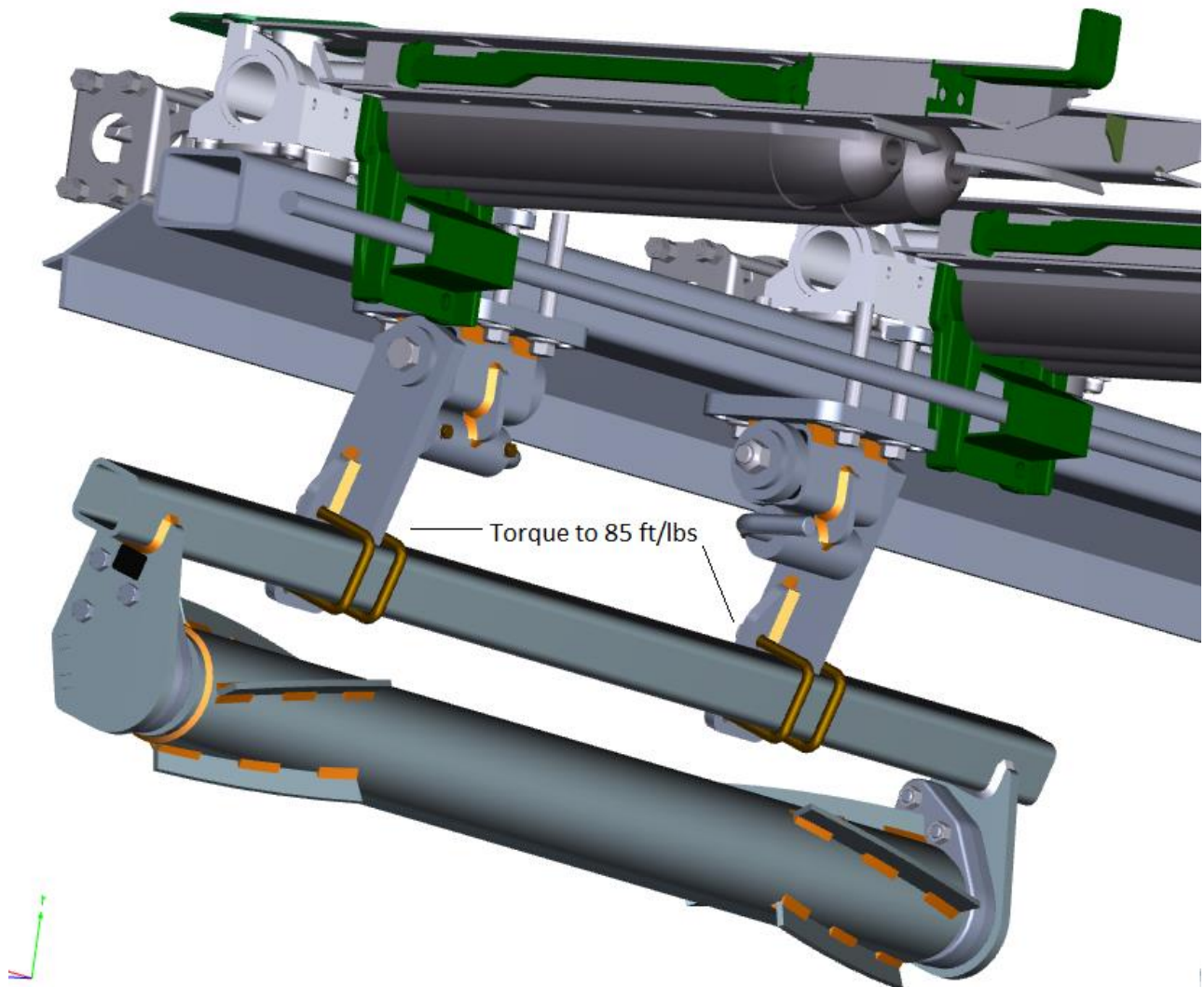

STEP 5:

Make sure the barrel can be spun using two fingers. Ensure that all hardware is tight.

INSTALLATION INSTRUCTIONS

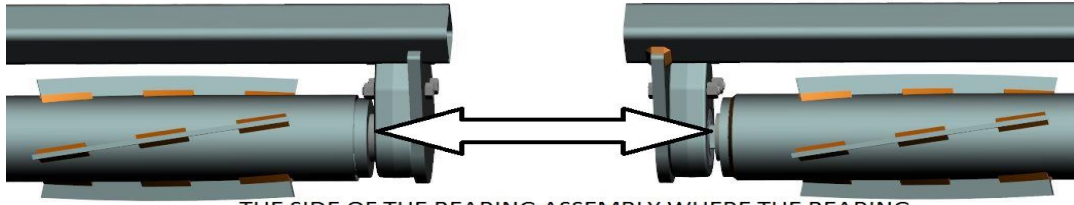

THE SIDE OF THE BEARING ASSEMBLY WHERE THE BEARING IS PROTRUDING MUST BE INSTALLED TOWARD THE ROLLER!

LOCK UP

To “lock up” Devastator rollers, lower head down & rotate the locking handle 90 degrees. If the handle is vertical, the devastator will be in operation mode. If the handle is horizontal & is in front of the pivot arm (see yellow circle below), the devastator is locked up. On torsion style devastators without the lock up feature, a 5000-430 Lock Pin can be ordered separately to lock up devastator rollers. 6 row heads require 1 lock pin, 8/12 row heads require 2.

Operating Position



Locked Up Position



OPERATION

CORN HEAD ANGLE NEEDS TO BE ADJUSTED BETWEEN 22 – 25° FOR OPTIMUM DEVASTATOR PERFORMANCE. USE THE ANGLE METER TO CHECK CORN HEAD ANGLE:

- Put the combine on a level surface. Lower the Corn head to your normal working head height.
 - Place the magnetic protractor on the stripper plate to get the angle. Adjust the feeder house as needed, fore or aft, to achieve 22 – 25 degrees
- Adjust the snouts to raise/lower head to preferred head height



Maintenance

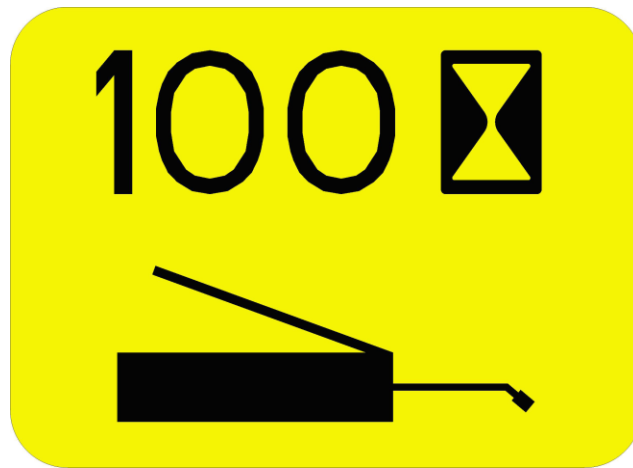

Grease the Bearing cavity every 100 hours until grease purges out.



5000-355 bearing assembly

ITEM	PART NO.	DESCRIPTION	QTY
1	2533-110	1/4-28 ZERK STRAIGHT SELF-TAP	1
2	2550-059	DEVASTATOR BEARING	1
3	5000-356	BEARING HOUSING, DEVASTATOR	1

PART IDENTIFICATION

5000-091

Deere 6 row wide (36"/38" rows)

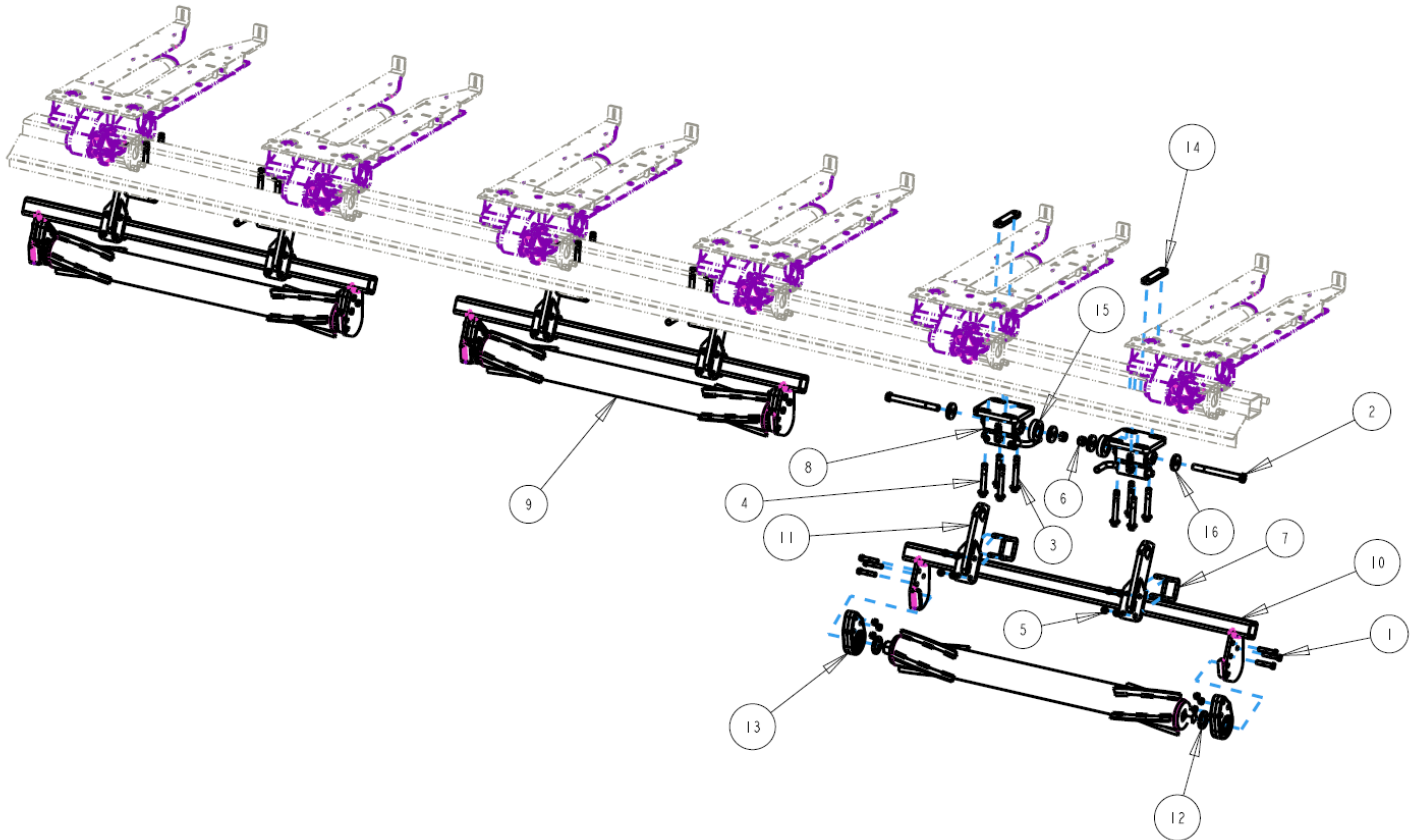

ITEM	PART NO.	DESCRIPTION	QTY
1	2502-353	1/2-13 X 2 1/2 HHCS GR8 ZP	18
2	2502-430	3/4-10 X 8 HHCS GR8, ZP	6
3	2502-805	M16 X 2 X 120 HEX FLANGE SCREW, THREADLOCK, ZP	12
4	2502-806	M16 X 2 X 110 HEX FLANGE SCREW, THREADLOCK, ZP	12
5	2520-357	1/2-13 LOCK HEX NUT, GR A, ZP	42
6	2520-604	3/4-10 HEX TOP LOCK, GR. C, ZP	6
7	2570-568	1/2 X 2-1/2 X 3-1/2 U-BOLT	12
8	5000-187	LOCKING TORSION ASSEMBLY	6
9	5000-2003	48" ROLLER W.A., 36"/38" ROWS	3
10	5000-255	ROLLER MOUNT W.A.,	3
11	5000-292	TORSION ARM W.A.	6
12	5000-322	SHIM WASHER ZP	6
13	5000-355	BEARING ASSEMBLY	6
14	5000-420	4" CLAMP STRAP, TAPPED	12
15	5000-468	SPACER	6
16	5000-469	SECURITY CAP	12

PART IDENTIFICATION

5000-092

Deere 8 row wide (36"/38" rows)

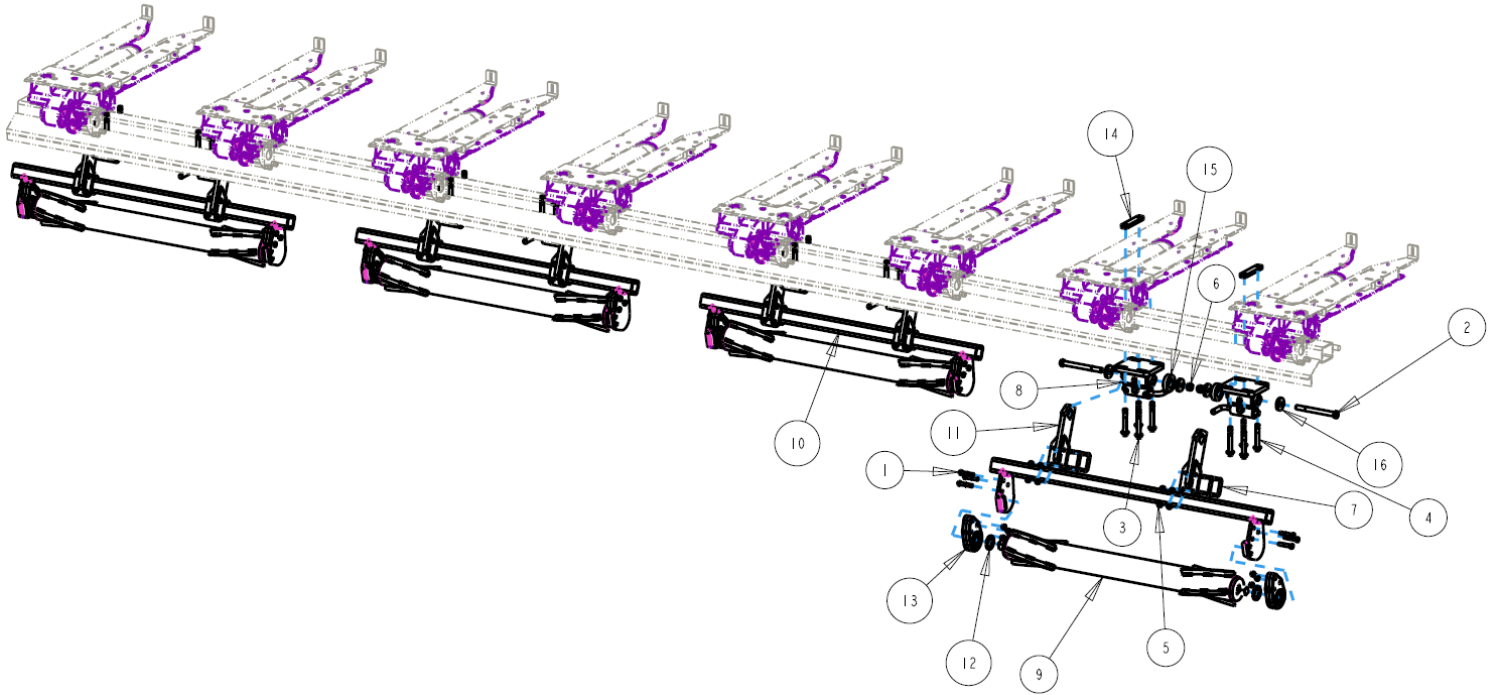

ITEM	PART NO.	DESCRIPTION	QTY
1	2502-353	1/2-13 X 2 1/2HHCS GR8 ZP	24
2	2502-430	3/4-10 X 8 HHCS GR8, ZP	8
3	2502-805	M16 X 2 X 120 HEX FLANGE SCREW, THREADLOCK, ZP	16
4	2502-806	M16 X 2 X 110 HEX FLANGE SCREW, THREADLOCK, ZP	16
5	2520-357	1/2-13 LOCK HEX NUT, GR A, ZP	56
6	2520-604	3/4-10 HEX TOP LOCK, GR. C, ZP	8
7	2570-568	1/2 X 2-1/2 X 3-1/2 U-BOLT	16
8	5000-187	LOCKING TORSION ASSEMBLY	8
9	5000-2003	48" ROLLER W.A., 36"/38" ROWS	4
10	5000-255	ROLLER MOUNT W.A.,	4
11	5000-292	TORSION ARM W.A.	8
12	5000-322	SHIM WASHER ZP	8
13	5000-355	BEARING ASSEMBLY	8
14	5000-420	4" CLAMP STRAP, TAPPED	16
15	5000-468	SPACER	8
16	5000-469	SECURITY CAP	16

PART IDENTIFICATION

5000-093

Deere 12 row wide (36"/38" rows)

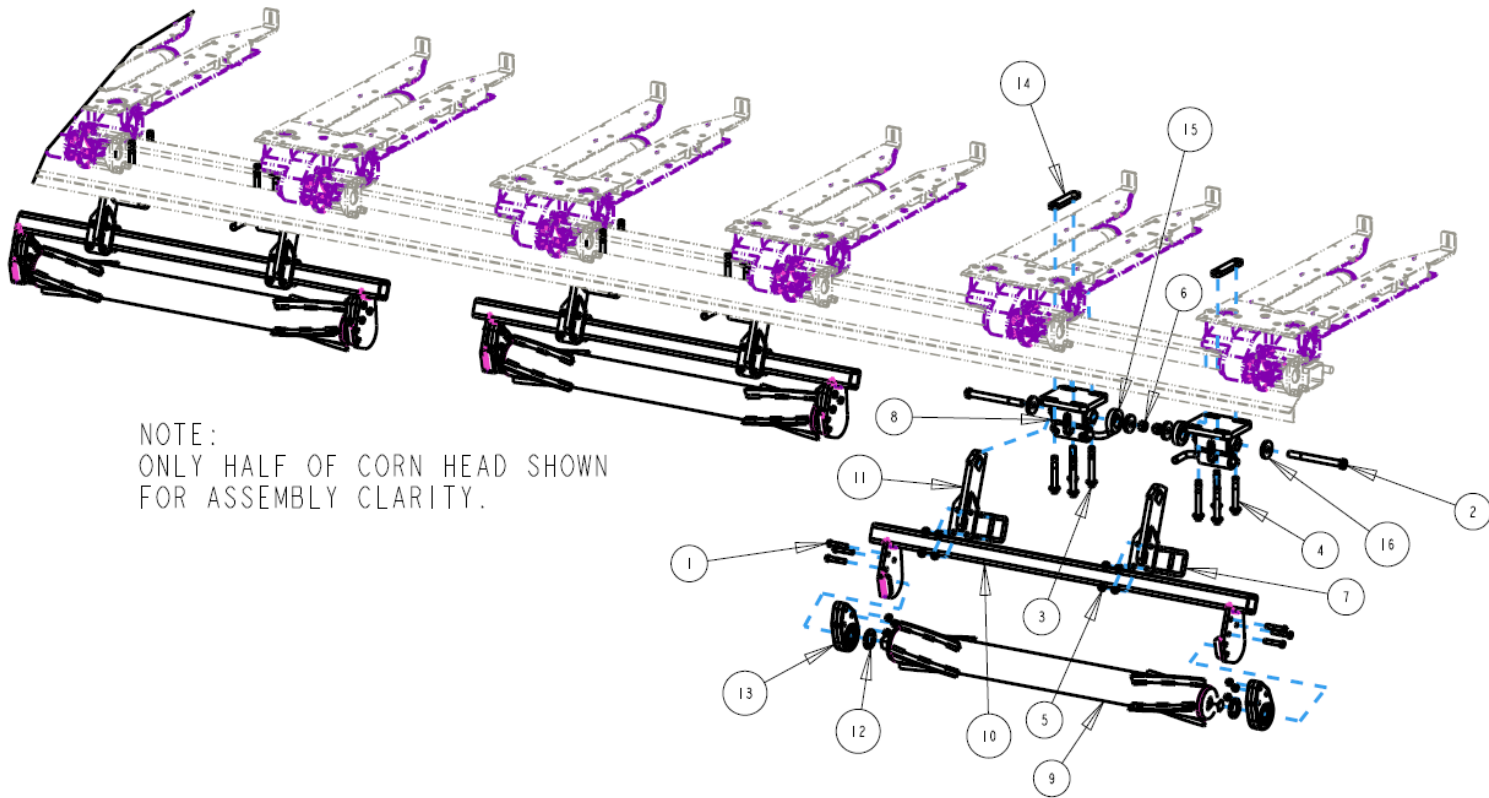

ITEM	PART NO.	DESCRIPTION	QTY
1	2502-353	1/2-13 X 2 1/2HHCS GR8 ZP	36
2	2502-430	3/4-10 X 8 HHCS GR8, ZP	12
3	2502-805	M16 X 2 X 120 HEX FLANGE SCREW, THREADLOCK, ZP	24
4	2502-806	M16 X 2 X 110 HEX FLANGE SCREW, THREADLOCK, ZP	24
5	2520-357	1/2-13 LOCK HEX NUT, GR A, ZP	84
6	2520-604	3/4-10 HEX TOP LOCK, GR. C, ZP	12
7	2570-568	1/2 X 2-1/2 X 3-1/2 U-BOLT	24
8	5000-187	LOCKING TORSION ASSEMBLY	12
9	5000-2003	48" ROLLER W.A., 36"/38" ROWS	6
10	5000-255	ROLLER MOUNT W.A.,	6
11	5000-292	TORSION ARM W.A.	12
12	5000-322	SHIM WASHER ZP	12
13	5000-355	BEARING ASSEMBLY	12
14	5000-420	4" CLAMP STRAP, TAPPED	24
15	5000-468	SPACER	12
16	5000-469	SECURITY CAP	24

TROUBLESHOOTING

ISSUE	CAUSE	CORRECTIVE ACTION
Residue Plugging	<ol style="list-style-type: none"> 1. Incorrect Head Angle 2. Roller Mount Tube incorrectly installed 3. Pivot arm orientation incorrect 4. Bearing installed incorrectly 5. Intermeshing snapping rolls 6. Too much Spring Tension 	<ol style="list-style-type: none"> 1. Adjust head angle to 23 – 25 degrees (see page 37) 2. Make sure the Bearing Support Tab is on the backside of the Roller Arm Mount Tube 3. Reposition the pivot arm so that it offsets under the snout & not under the row 4. Make sure the side of the bearing that protrudes outside of the cast housing is facing toward the roller (each roller should spin freely by hand) 5. Order the 5000-080 Set Back Kit (order 2 per roller) 6. Back the nut off of the push rod until the nut is flush
Stalk aren't "devastated"	<ol style="list-style-type: none"> 1. Insufficient spring down pressure 2. Operating corn head too high 	<ol style="list-style-type: none"> 1. Tighten push rod nut on spring bushing more 2. Lower corn head until the rollers engage
Corn Head won't fit on head cart	<ol style="list-style-type: none"> 1. Devastators bottom out 2. Roller won't clear cart tire 3. Storage stands don't rest in the saddles on the cart 	<ol style="list-style-type: none"> 1. Adjust top rail & saddles higher on cart 2. Order 5000-082 Lift Kit (raises roller 2") 3. Raise head cart saddles & top rail, order extensions for head if offered by OEM.

NOTES

NOTES



A Tradition of Solutions since 1930

Yetter Farm Equipment Co

PO BOX 358 109 S. McDonough

Colchester, IL 62326-0358

Phone: 309-776-4111

Toll Free: 800-447-5777

Email: info@yetterco.com

For updated models and manuals visit the Yetter website:

www.yetterco.com

© Yetter Farm Equipment Co. All Rights Reserved

2565-950 – 11/2022