



**ROW UNIT MID-MOUNT
FERTILIZER INJECTION OPENER
MODELS 2968-050 & 2968-052 – SINGLE WHEEL
MODELS 2968-051 & 2968-053 – DUAL WHEEL
CNH ROW UNITS
SET UP & PARTS MANUAL
2565-960-REV_A – 01/2020**



YETTER MANUFACTURING CO.
FOUNDED 1930
Colchester, IL 62326-0358
Toll free: 800/447-5777
309/776-3222 (Fax)
Website: www.yetterco.com
E-mail: info@yetterco.com

YETTER

TABLE OF CONTENTS

FOREWORD 3
 SAFETY 4
 PICTORIAL PART LIST 5 – 9
 INSTALLATION 10 – 16
 OPERATION 17 – 18
 MAINTENANCE 19 – 21
 PARTS IDENTIFICATION..... 22 – 32
 TROUBLESHOOTING..... 33

BOLT TORQUE





Important: Over-tightening hardware can cause just as much damage as under-tightening. Tightening hardware beyond the recommended range can reduce its shock load capacity.

All hardware is either Grade 5 unless otherwise noted. Grade 5 cap screws are marked with three radial lines on the head. Grade 8 cap screws are marked with six radial lines on the head. If hardware must be replaced, be sure to replace it with hardware of equal size, strength and thread type. Refer to the torque values chart when tightening hardware.

The chart below is a guide for proper torque. Use it unless a specified torque is called out elsewhere in the manual. Torque is the force applied to the end of the handle or cheater bar, times the length of the handle or bar. Tightening hardware beyond the recommended range can reduce its shock load capacity.

Use a torque wrench wherever possible

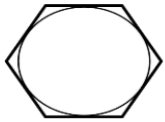
The following table shows torque in ft.-lbs. for coarse thread hardware.

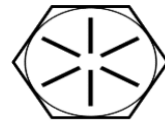
Bolt Diameter and Threads per Inch	 Grade 2	 Grade 5	 A-325	 Grade 8
1/4	6	10		14
5/16	12	20		30
3/8 – 16	25	35		50
7/16 – 14	35	55		80
1/2 – 13	55	85		125
9/16 – 12	75	125		175
5/8 – 11	105	170		235
3/4-10	185	305		425
7/8 – 9	170	445		690
1-8	260	670		1030
1 1/8 – 7	365	900		1460
1 1/4 - 7	515	1275		2060
1 3/8 – 6	675	1675		2700
1 1/2 - 6	900	2150		3500
1 3/4 – 5	1410	3500		5600

FOREWORD

You've just joined an exclusive but rapidly growing club.

For our part, we want to welcome you to the group and thank you for buying a Yetter product.

We hope your new Yetter products will help you achieve both goals-increase your productivity and increase your efficiency so that you may generate more profit.

This operator's manual has been designed into four major sections: Foreword, Safety Precautions, Installation Instructions and Parts Breakdown.



This **SAFETY ALERT SYMBOL** indicates important safety messages in the manual. When you see this symbol, be alert to the possibility of **PERSONAL INJURY** and carefully read the message that follows.

The word **NOTE** is used to convey information that is out of context with the manual text. It contains special information such as specifications, techniques and reference information of a supplementary nature.

The word **IMPORTANT** is used in the text when immediate damage will occur to the machine due to improper technique or operation.

Important will apply to the same information as specified by note only of an immediate and urgent nature.

It is the responsibility of the user to read the operator's manual and comply with the safe and correct operating procedure and to lubricate and maintain the product according to the maintenance schedule in the operator's manual.

The user is responsible for inspecting his machine and for having parts repaired or replaced when continued use of the product would cause damage or excessive wear to the other parts.

It is the user's responsibility to deliver his machine to the Yetter dealer who sold him the product for service or replacement of defective parts, which are covered by the warranty policy.

If you are unable to understand or follow the instructions provided in this publication, consult your local Yetter dealer or contact:

YETTER MANUFACTURING CO.
309/776-4111
800/447-5777
309/776-3222 (FAX)
Website: www.yetterco.com
E-mail: info@yetterco.com

WARRANTY

Yetter Manufacturing warrants all products manufactured and sold by it against defects in material. This warranty being expressly limited to replacement at the factory of such parts or products as shall appear to be defective after inspection. This warranty does not obligate the Company to bear cost of labor in replacement of parts. It is the policy of the Company to make improvements without incurring obligations to add them to any unit already sold. No warranty is made or authorized to be made, other than herein set forth. This warranty is in effect for one year after purchase.

DEALER: _____

Yetter Manufacturing warrants its own products only and cannot be responsible for damages to equipment on which mounted.

BE ALERT! YOUR SAFETY IS INVOLVED



WATCH FOR THIS SYMBOL. IT POINTS OUT IMPORTANT SAFETY PRECAUTIONS. IT MEANS “ATTENTION – BE ALERT!”

It is your responsibility as an owner, operator, or supervision to know and instruct everyone using this machine at the time of initial assignment and at least annually thereafter, of the proper operation, precautions, and work hazards which exist in the operation of the machine in accordance with OSHA regulations.

Safety Is No Accident



The following safety instructions, combined with common sense, will save your equipment from needless damage and the operator from unnecessary exposure to personal hazard. Pay special attention to the caution notes in the text. Review this manual at least once a year with all operators.

1. Read and understand the operator's manual before operating this machine. Failure to do so is considered a misuse of the equipment.
2. Make sure equipment is secure before operating.
3. Always keep children away from equipment when operating.
4. Make sure everyone that is not directly involved with the operation is out of the work area before beginning operation.
5. Make sure all safety devices, shields, and guards are in place and functional before beginning operation
6. Shut off all power to adjust, service, or clean.
7. Keep hands, feet, and clothing away from moving parts. It is a good idea to remove all jewelry before operating.
8. Inspect the machine periodically during operation for signs of excessive wear, loose fasteners, and unusual noises.

2968-050 Pictorial Parts List

For CNH 2000 Row Units, Single Disc, Left or Right Hand

 <p>2968-150 QTY 1 Bolt Bag</p>	 <p>2968-227 QTY 1 Close Wheel Mount</p>	 <p>ONLY IF -LH ORDERED 2968-472-LH – QTY 1 Tall Fert. Wheel Mount, LH</p>	 <p>ONLY IF -RH ORDERED 2968-472-RH – QTY 1 Tall Fert. Wheel Mount, RH</p>
--	---	---	---

2968-051-L & 2968-051-R Pictorial Parts List

For CNH 2000 Row Units, Dual Disc

 <p>2968-149 QTY 1 Bolt Bag</p>	 <p>2968-227 QTY 1 Close Wheel Mount</p>	 <p>ONLY IF -L ORDERED 2968-472-LH – QTY 1 Tall Fert. Wheel Mount, LH</p>	 <p>ONLY IF -L ORDERED 2968-473-RH – QTY 1 Short Fert. Wheel Mount, RH</p>	 <p>ONLY IF -R ORDERED 2968-472-RH – QTY 1 Tall Fert. Wheel Mount, RH</p>	 <p>ONLY IF -R ORDERED 2968-473-LH – QTY 1 Short Fert. Wheel Mount, LH</p>
---	---	--	---	--	---

2968-052 Pictorial Parts List

For CNH 1200 Row Units, Single Disc, Left or Right Hand

 <p>2968-113 QTY 1 Bolt Bag</p>	 <p>2968-230 – QTY 1 Close Wheel Mount</p>	 <p>ONLY IF -L ORDERED 2968-403-LH – QTY 1 TALL CNH 1200 LHL ARM</p>	 <p>ONLY IF -R ORDERED 2968-403-RH – QTY 1 TALL CNH 1200 RHL ARM</p>
--	---	--	---

2968-053-L Pictorial Parts List

For CNH 1200 Row Units, Dual Disc, LH Lead

 <p>2968-114 QTY 1 Bolt Bag</p>	 <p>2968-230 – QTY 1 Close Wheel Mount</p>	 <p>2968-403-LH – QTY 1 TALL CNH 1200 LHL ARM</p>	 <p>2968-404-RH – QTY 1 RH CNH 1200 SHORT ARM</p>
--	---	--	--

2968-053-R Pictorial Parts List

For CNH 1200 Row Units, Dual Disc, RH Lead

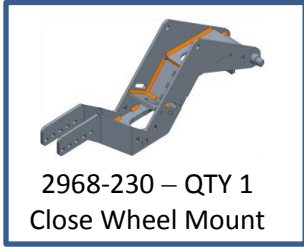

2968-054 Pictorial Parts List

Box Mount Kit For CNH 2100 Row Units

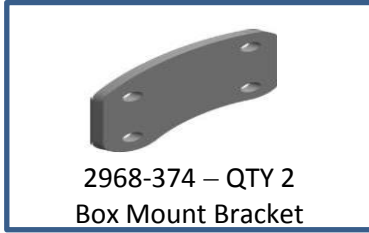
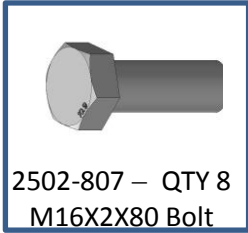

2968-132 Pictorial Parts List

10" Fertilizer Wheel Assembly

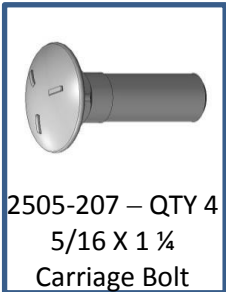

2968-090A-L & 2968-090A-R Pictorial Parts List

● = ONLY INCLUDED IN 2968-090A-L KIT

+ = ONLY INCLUDED IN 2960-090A-R KIT

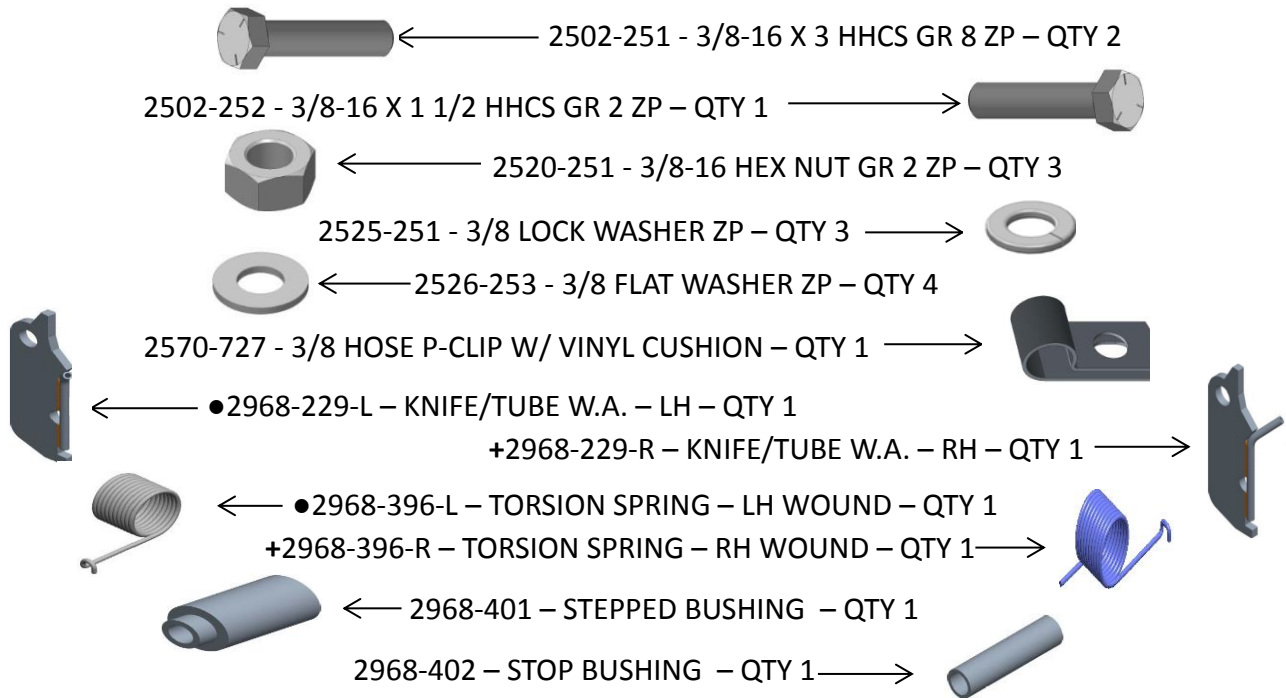

2968-091 INJECTOR KIT, ONE SIDE

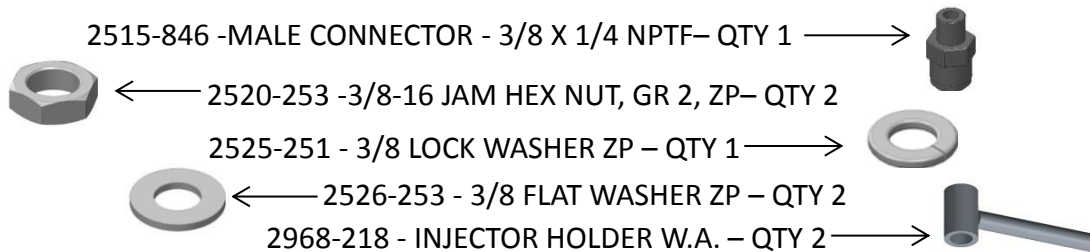

2968-113 Pictorial Parts List

Bolt Bag for 2968-052

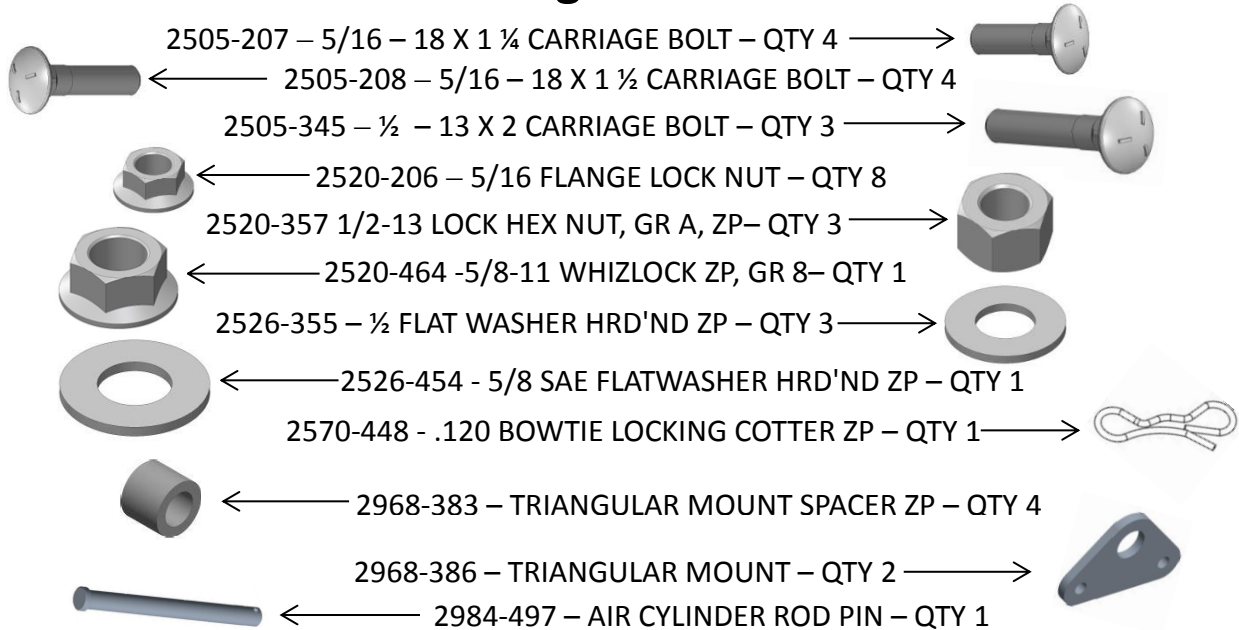

2968-114 Pictorial Parts List

Bolt Bag for 2968-053

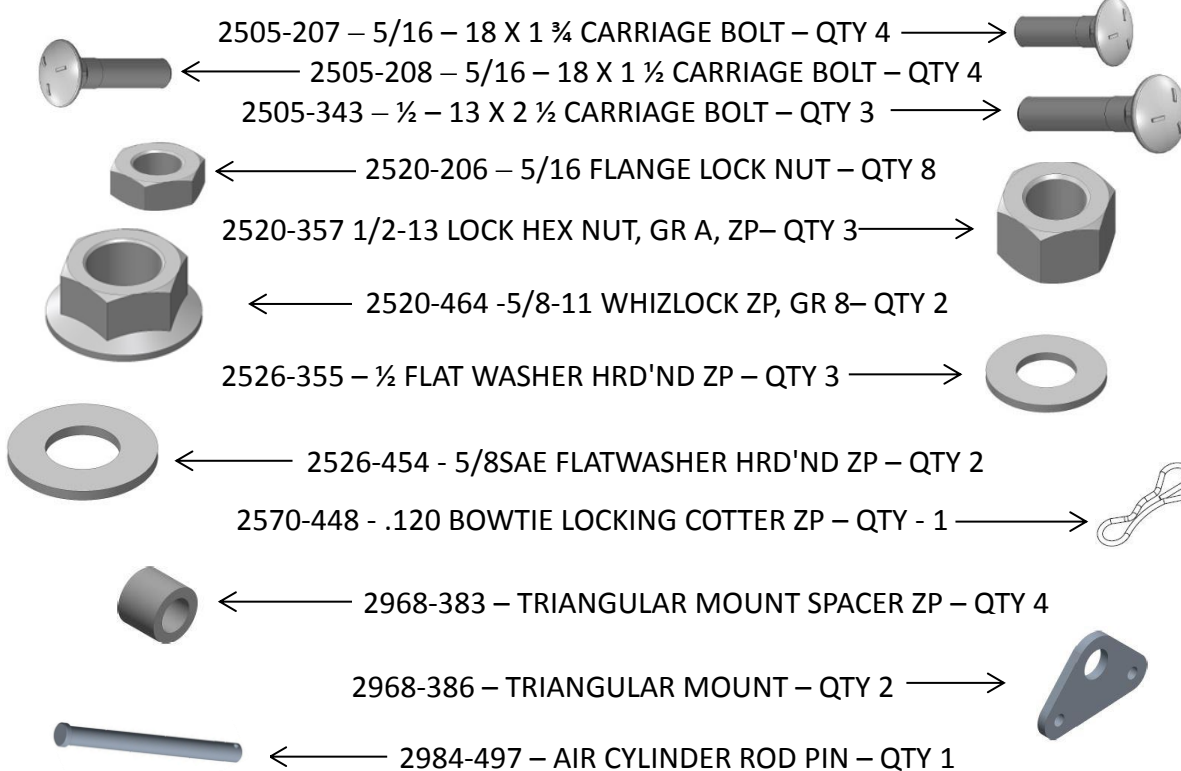

2968-149 Pictorial Parts List

Bolt Bag for 2968-051

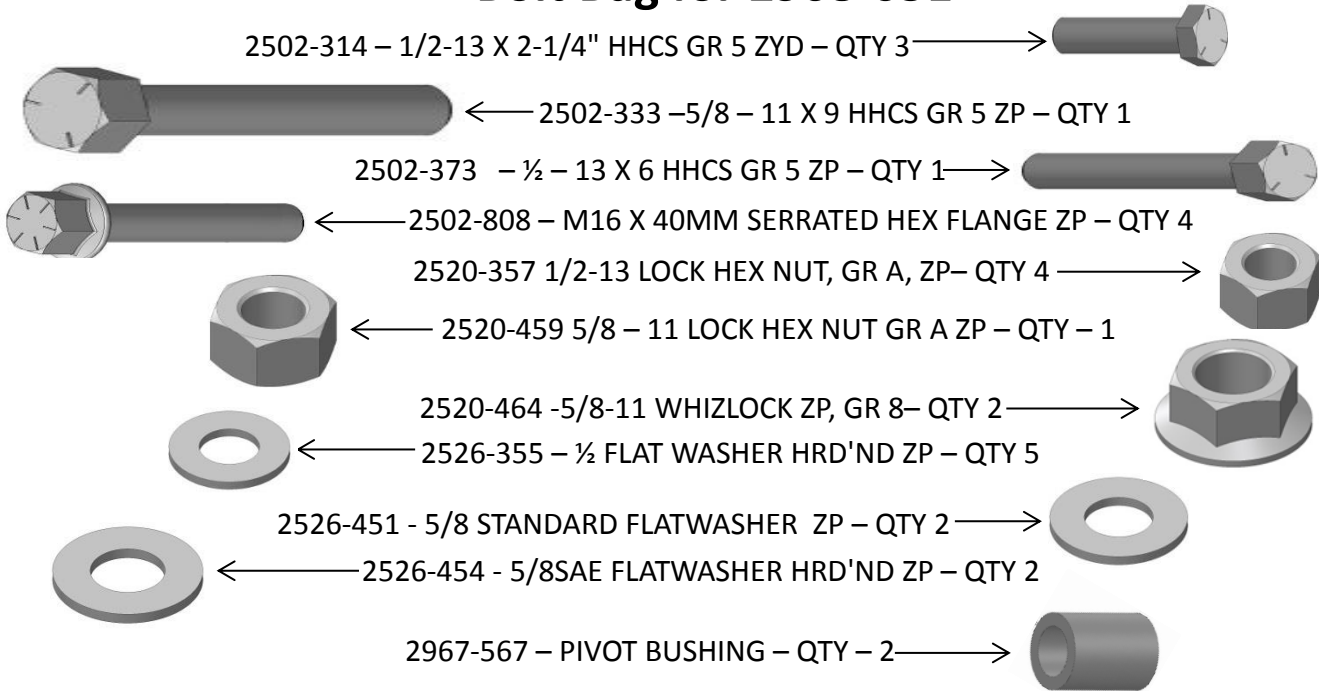

2968-150 Pictorial Parts List

Bolt Bag for 2968-050

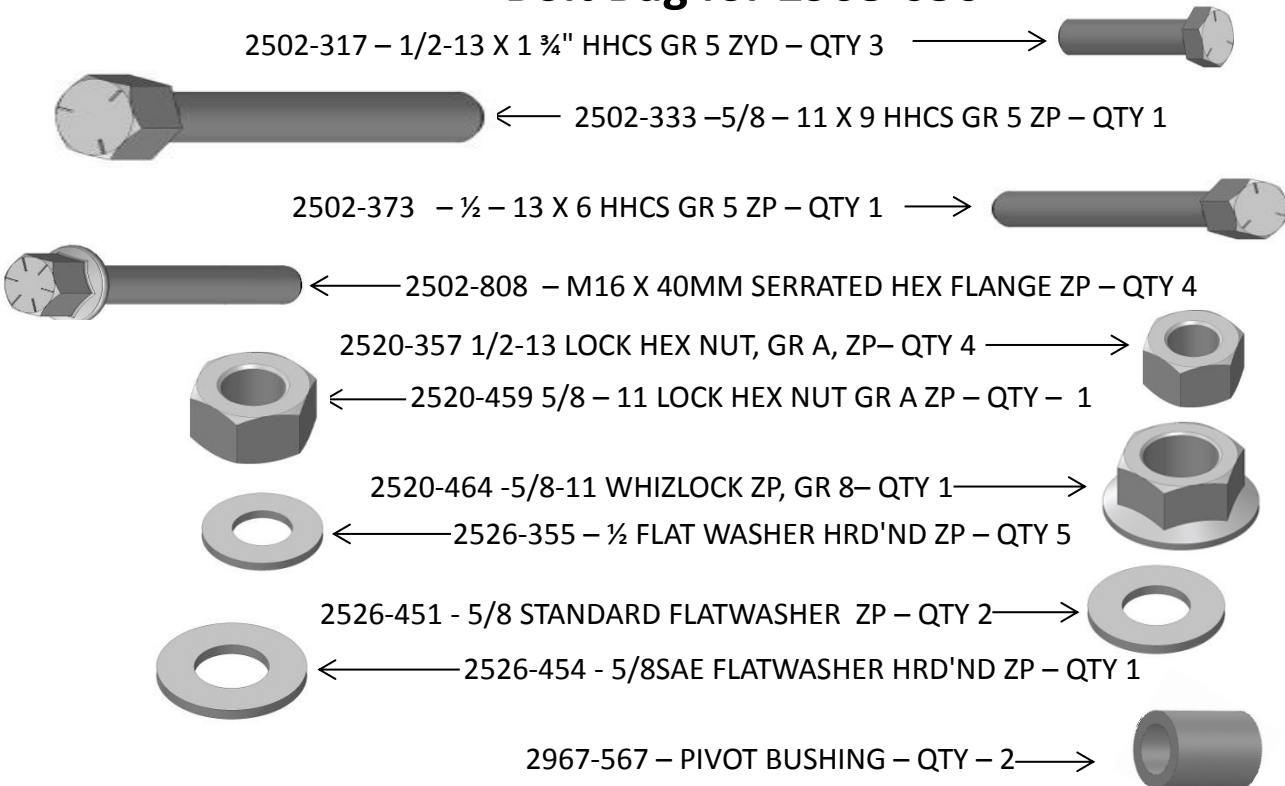

INSTALLATION INSTRUCTIONS

Step 1: Remove the items listed below that are part of the closing wheel assembly on the seeding unit. The closing discs will remain in the same location directly behind the gauge wheels. On 1200 row units, mark the set of holes on each side of the row unit that the disc scrapers (Item 2 in photo below) were mounted to.

1200 SERIES ROW UNIT

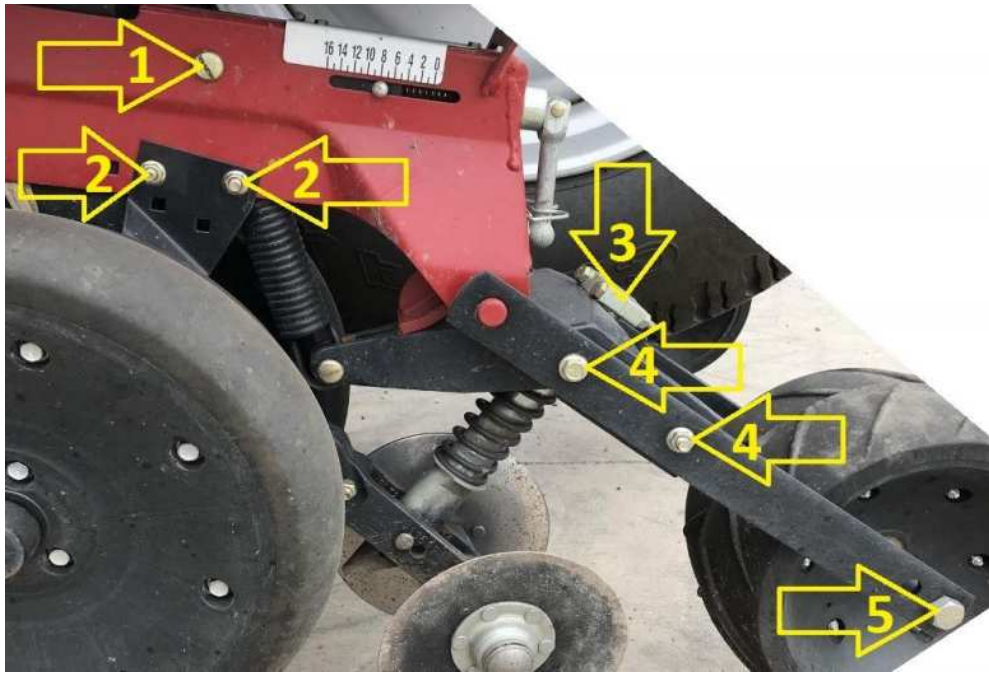

- 1 – SPRING PIN & CLIP
- 2 – HARDWARE FOR THE DISC SCRAPER
- 3 – HARDWARE THAT ATTACHES THE SPRING HOLDER
- 4 – HARDWARE FOR THE PRESS WHEEL BRACKET
- 5 – HARDWARE FOR THE PRESS WHEEL
- OPTIONAL – EACH GAUGE WHEEL

2100 SERIES ROW UNIT

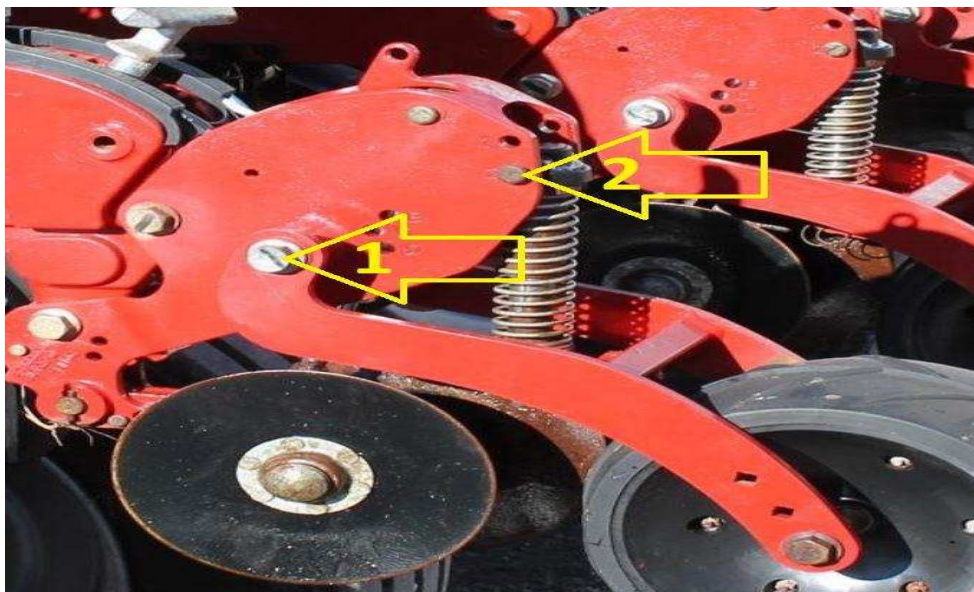

- 1 – HARDWARE FOR THE PRESS WHEEL BRACKET
- 2 – HARDWARE THAT ATTACHES THE PRESS WHEEL SPRING HOLDER

INSTALLATION INSTRUCTIONS

1200 SERIES ROW UNIT

Step 2: Attach the front of the Main Mount Bracket to the planter row unit by using the same set of holes that the scrapers were mounted in using 4) 5/16 X 1 ¼ carriage bolts & 4) 5/16 flange lock nuts. Attach the triangular mounts & triangular mount spacers to the row unit using 4) 5/16 X 1 ½ carriage bolts & 4) 5/16 flange lock nuts. Attach the rear firming wheel & compression spring to the rear of the main mount bracket using all original parts & hardware with the exception of the spring pin & hairpin cotter. **DO NOT** attach the closing wheel spring & spring holder to the Main Mount Bracket until after the fertilizer wheel mounts are installed in step 3.

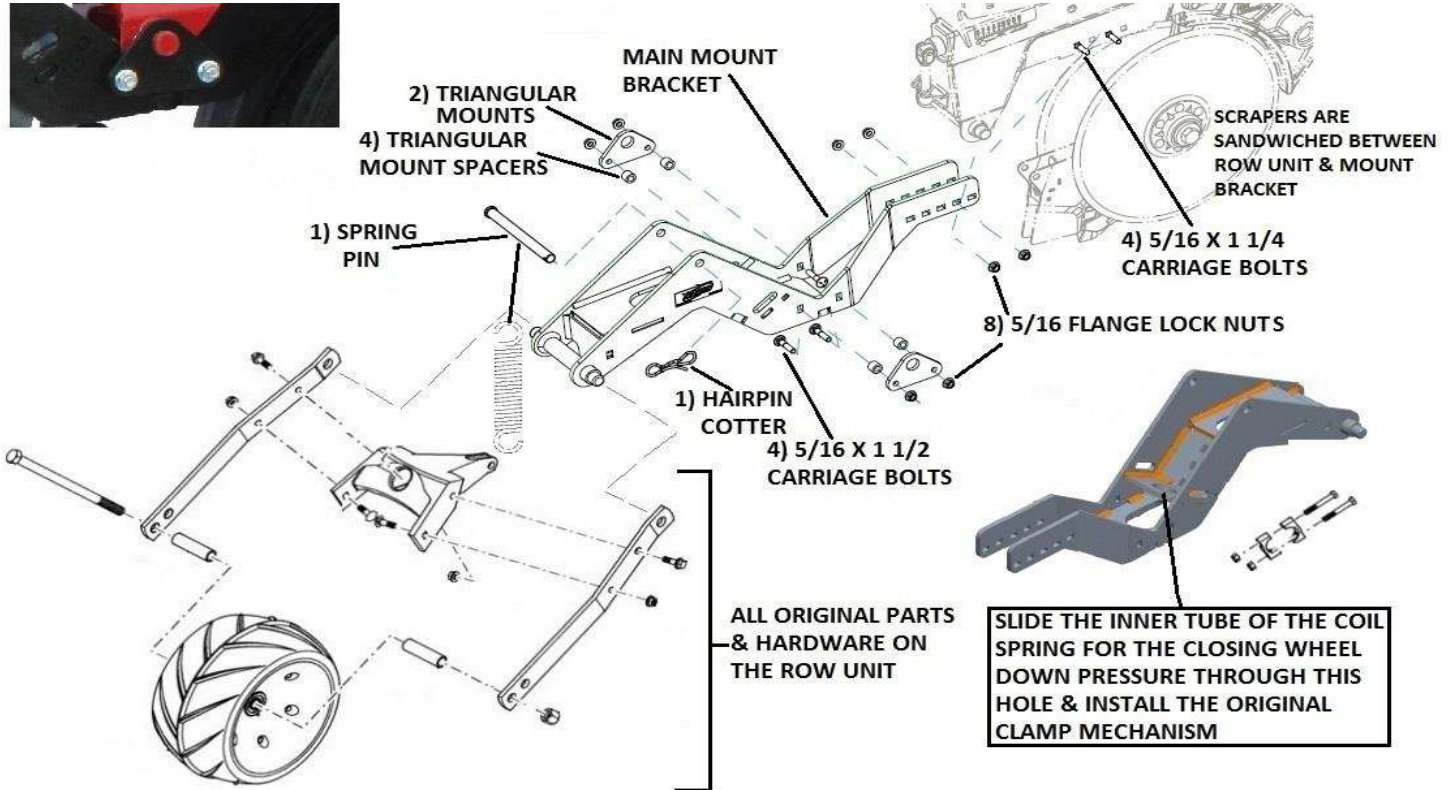

2100 SERIES ROW UNIT

Step 2: Attach the front of the Main Mount Bracket to each planter row unit using the 4) M16 X 40 bolts. Attach the rear firming wheel using 1) 5/8 X 9 bolt, 2) 5/8 flat washers, & 1) 5/8 lock nut. Attach the compression spring to the rear of the main mount bracket using 1) ½ X 6 bolt, 2) ½ flat washers, & 1) ½ lock nut.

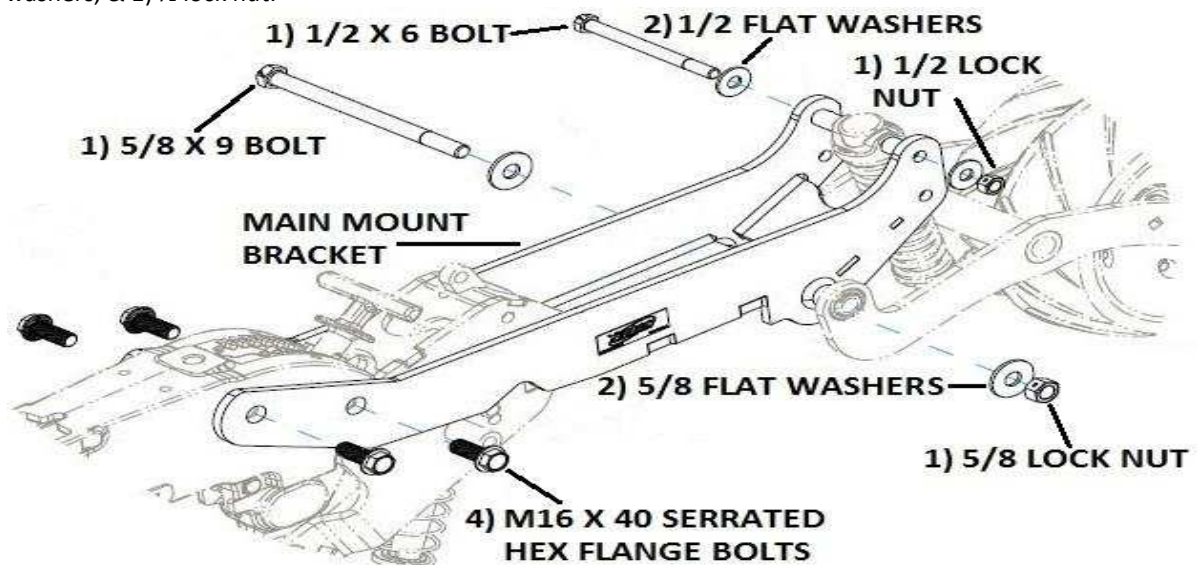

2968-050 & 2968-052 INSTALLATION INSTRUCTIONS

SINGLE DISC PLACEMENT

Step 3: 2000 Series Row Unit

Install the fertilizer wheel mount to the main mount bracket using 3) $\frac{1}{2}$ X $1 \frac{3}{4}$ bolts, 3) $\frac{1}{2}$ flat washers, & 3) $\frac{1}{2}$ lock nuts, **DO NOT** tighten hardware until **Step 5!**

5000-050-L

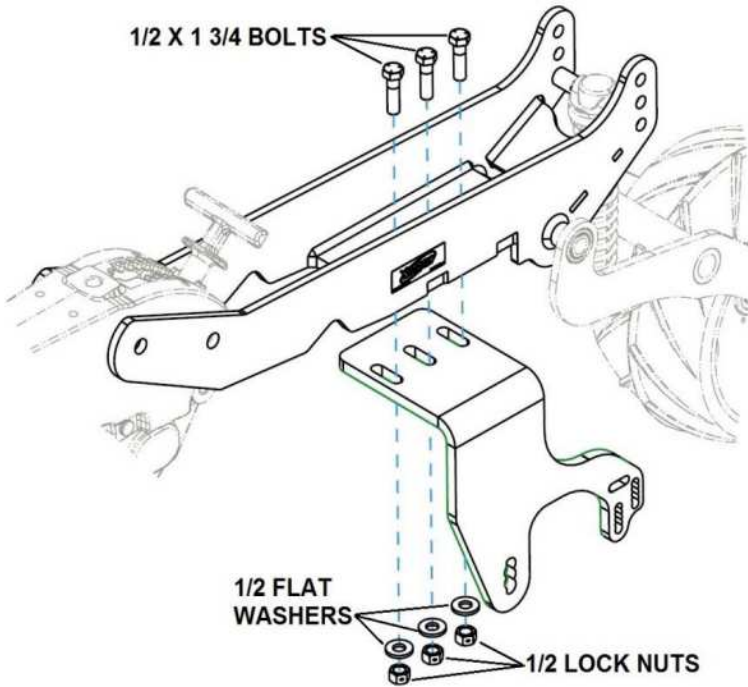

5000-050-R

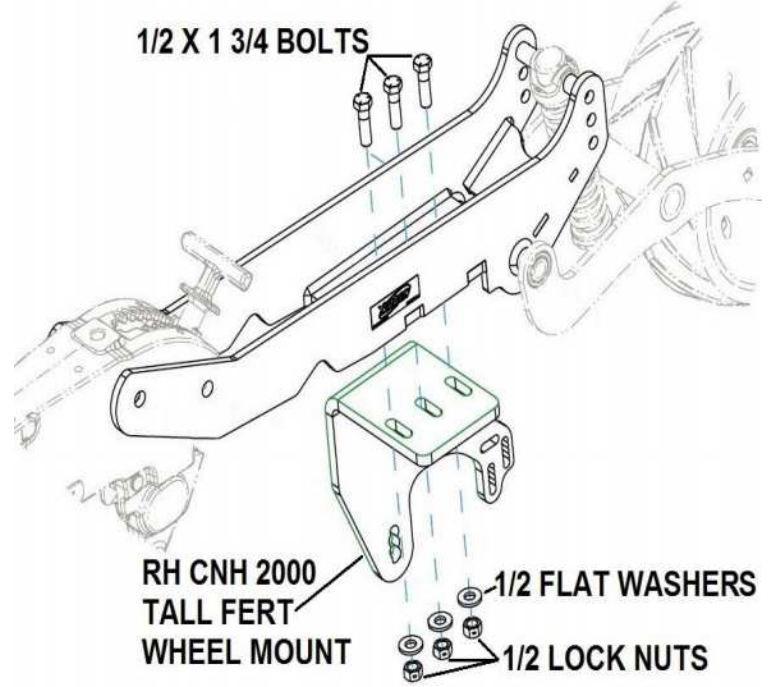

Step 3: 1200 Series Row Unit

Install the fertilizer wheel mount to the main mount bracket using 3) $\frac{1}{2}$ X 2 carriage bolts, 3) $\frac{1}{2}$ flat washers, & 3) $\frac{1}{2}$ lock nuts, **DO NOT** tighten hardware until **Step 5!** Attach the closing wheel springs to the Main Mount Bracket at this time by inserting the spring & spring holder thru the hole on the Main Mount Bracket & installing the original clamp assembly. (SEE **PAGE 11** FOR PHOTO REFERENCE)

5000-052-L

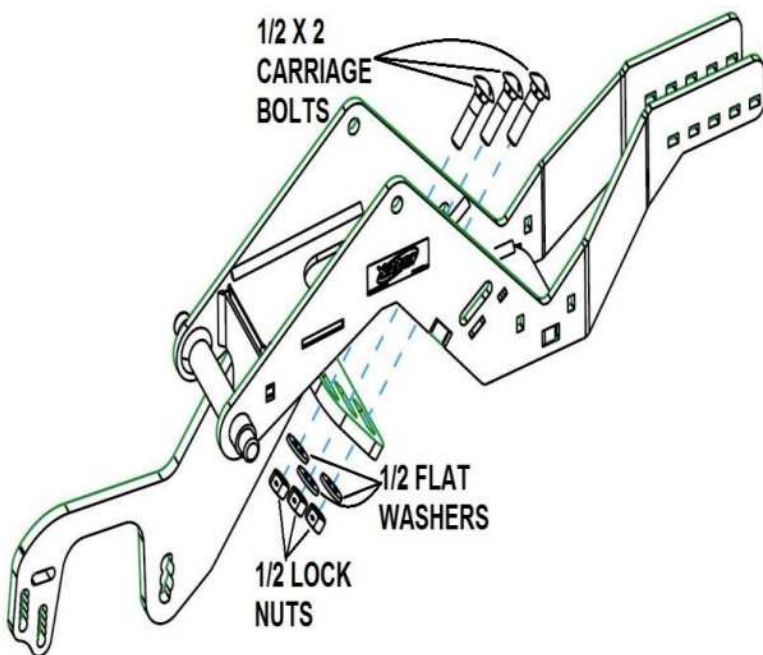

5000-052-R

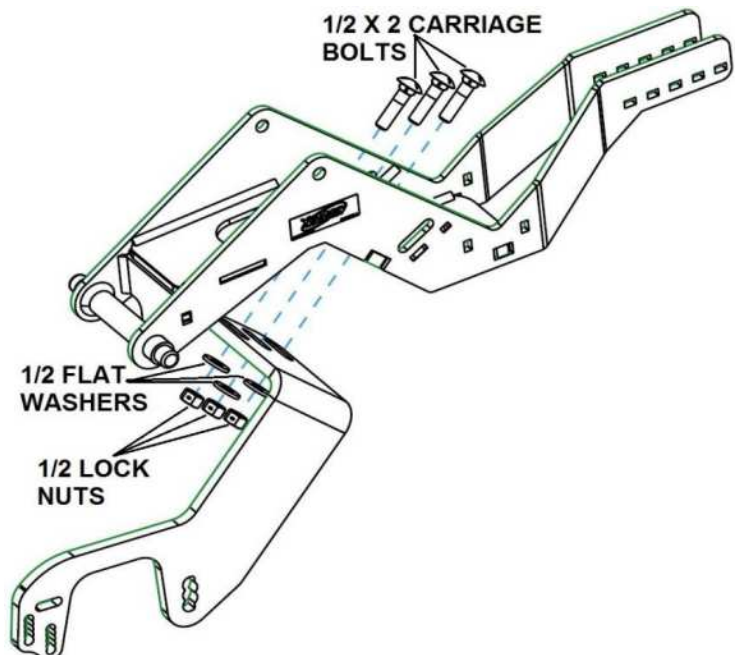

2968-051 & 2968-053 INSTALLATION INSTRUCTIONS

DUAL DISC PLACEMENT

Step 3: 2000 Series Row Units

Install the fertilizer wheel mounts to the main mount bracket using 3) $\frac{1}{2}$ X 2 $\frac{1}{4}$ bolts, 3) $\frac{1}{2}$ flat washers, & 3) $\frac{1}{2}$ lock nuts, **DO NOT** tighten hardware until **Step 5!** On the seeding units where the left closing wheel is leading, install a 2968-051-L. On the seeding units where the right closing wheel is leading, install a 2968-051-R.

2968-051-L

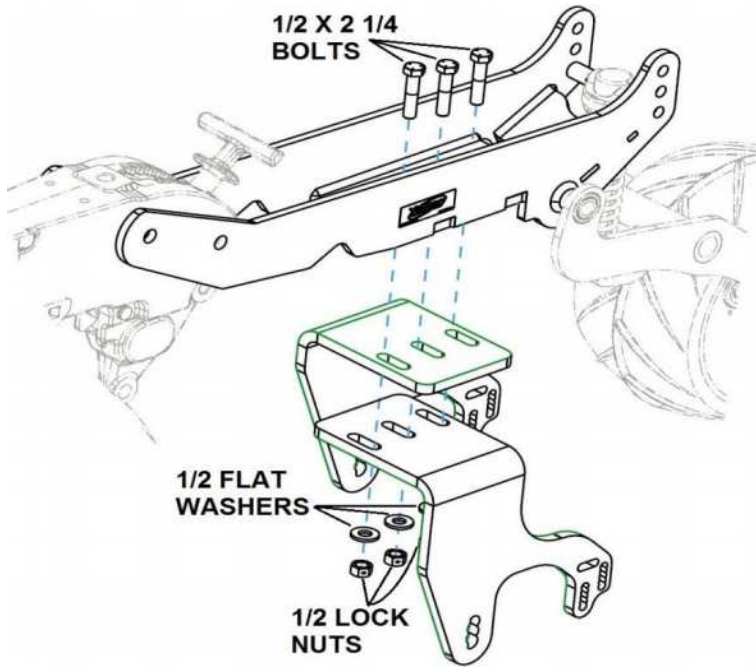

2968-051-R

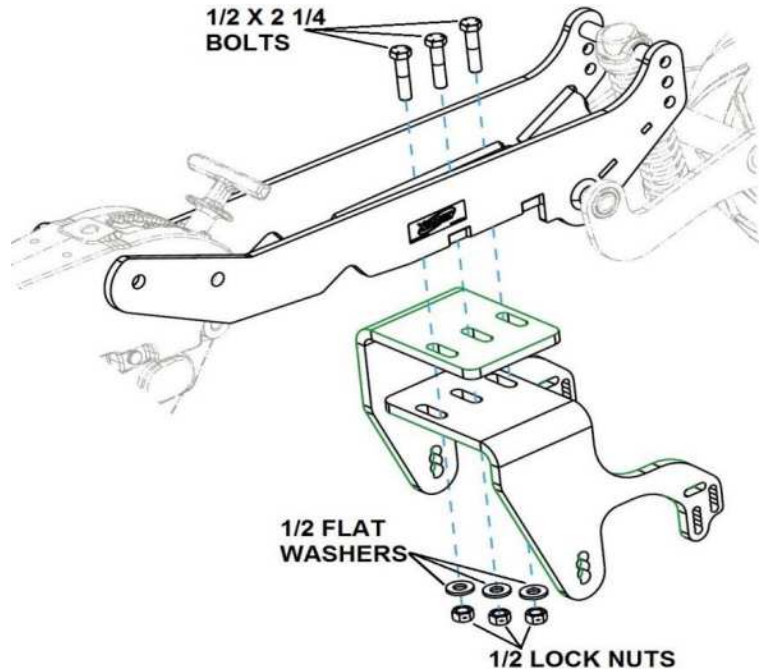

Step 3: 1200 Series Row Units

Install the fertilizer wheel mounts to the main mount bracket using 3) $\frac{1}{2}$ X 2 $\frac{1}{4}$ bolts, 3) $\frac{1}{2}$ flat washers, & 3) $\frac{1}{2}$ lock nuts, **DO NOT** tighten hardware until **Step 5!** On the seeding units where the left closing wheel is leading, install a 2968-051-L. On the seeding units where the right closing wheel is leading, install a 2968-051-R. Attach the closing wheel springs to the Main Mount Bracket at this time by inserting the spring & spring holder thru hole on Main Mount Bracket & installing the original clamp assembly. (SEE **PAGE 11** FOR PHOTO REFERENCE)

2968-053-L

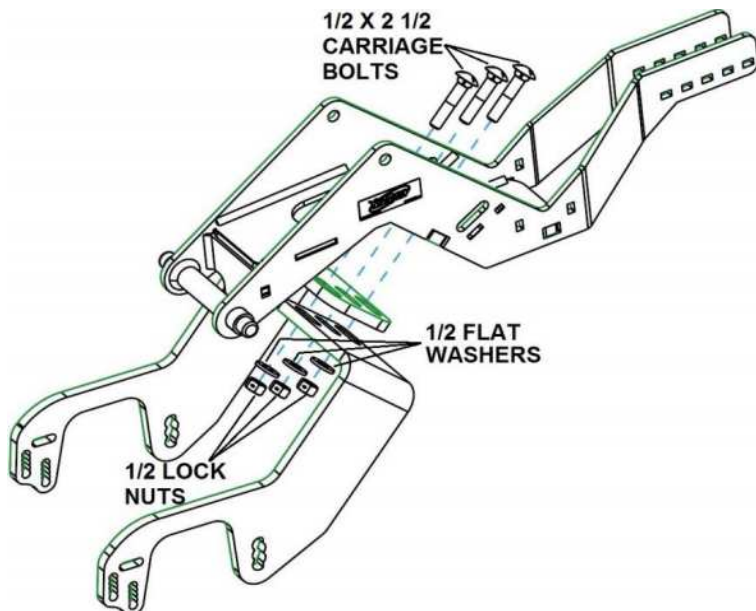

2968-053-R

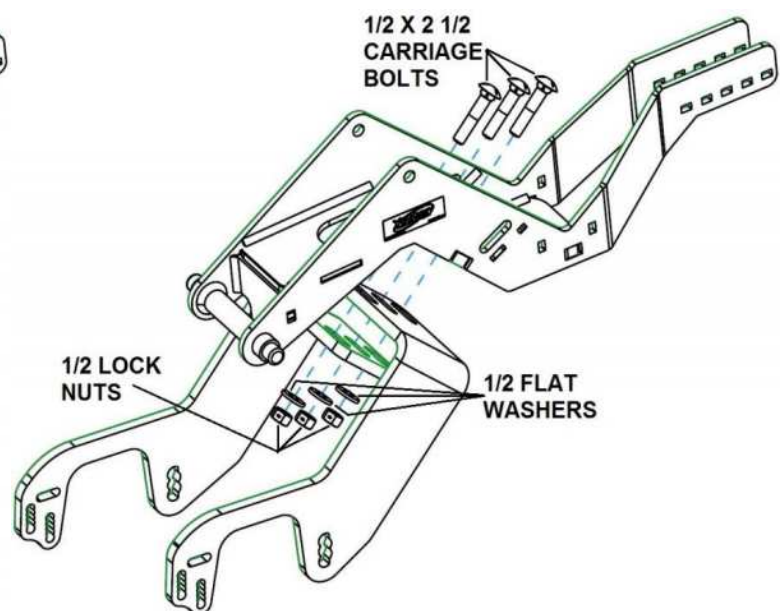

INSTALLATION INSTRUCTIONS

Step 4: Fertilizer Wheel Assembly

Place 1) 5/8" flat washer over the D-bolt & install the Fertilizer Wheel Assembly to Fertilizer Wheel Mount Plate & tighten 5/8" flange whiz lock nut. See [page 17](#) to determine which D-bolt hole to install the wheel assembly to achieve your desired depth.

SINGLE WHEEL (LH Shown)

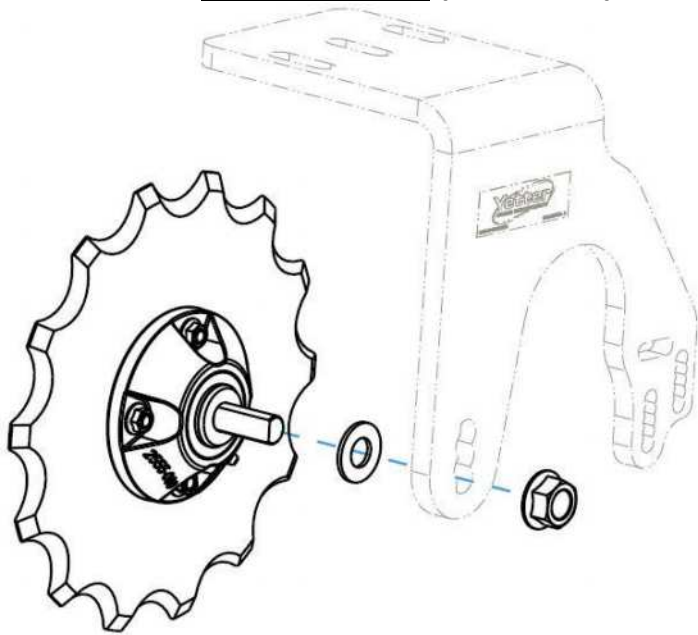

DUAL WHEEL

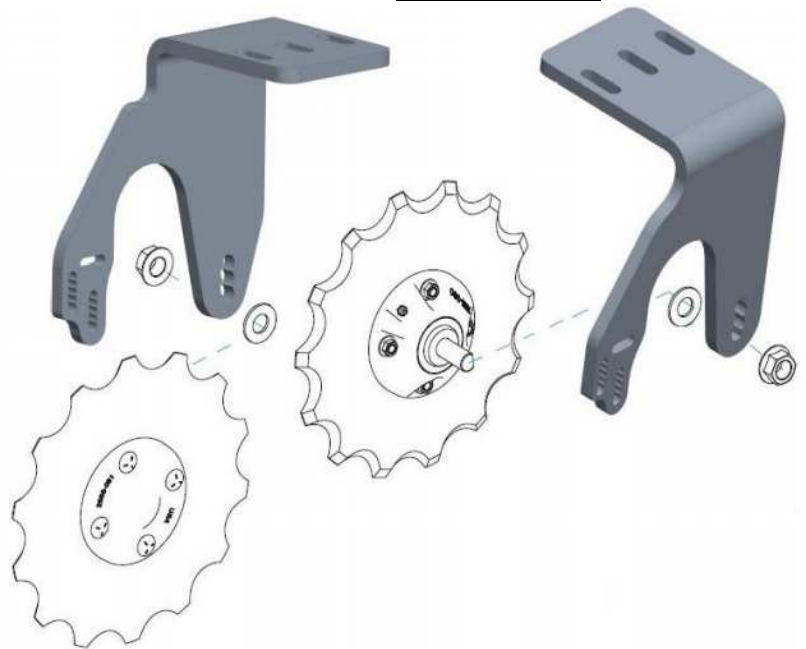

Step 5: Set the Fertilizer Wheel Assembly Width

Set each Fertilizer Wheel Assembly to the desired spacing off the row (2" – 3") & then tighten the 3) 1/2" bolts from **STEP 3**.

SINGLE WHEEL



SET THE FERT. WHEEL OFF THE ROW TO DESIRED SPACING

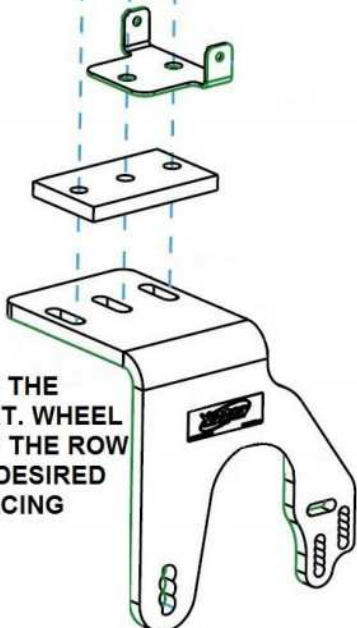

DUAL WHEEL



SET EACH FERT WHEEL OFF THE ROW TO THE DESIRED SPACING

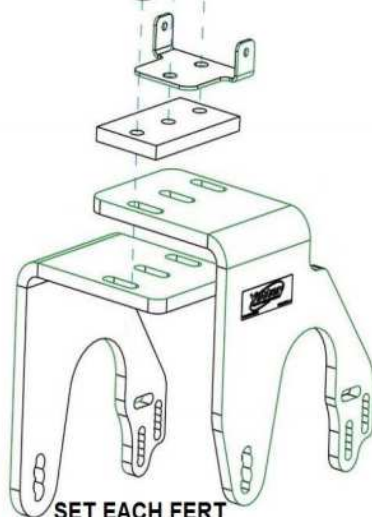

WHEEL ADJUSTMENT

USE THE SLOTTED HOLES IN THE FERTILIZER WHEEL MOUNT TO ADJUST EACH BLADE TOWARDS OR AWAY FROM THE SEED FURROW

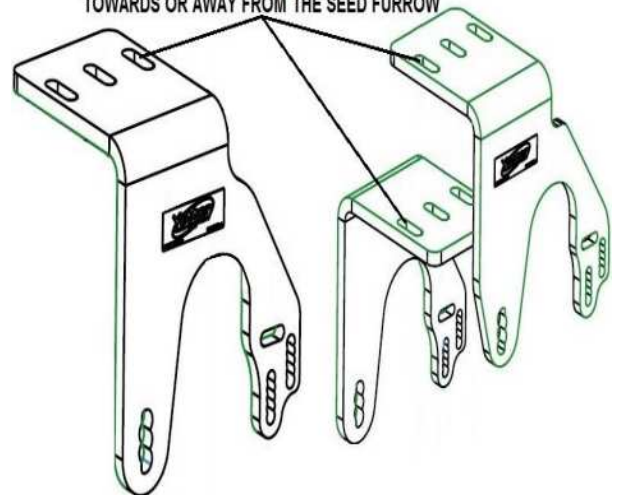

INSTALLATION INSTRUCTIONS

STEP 6: P-Clip Installation

Install each P-Clip to the Formed Hose Holder using $\frac{1}{4}$ " X $\frac{1}{2}$ " bolts, $\frac{1}{4}$ " lock washers, & $\frac{1}{4}$ " hex nuts. A P-Clip should be placed on the side with blade for single wheel placement & on both sides for dual wheel placement.

SINGLE WHEEL (LEFT SIDE SHOWN)

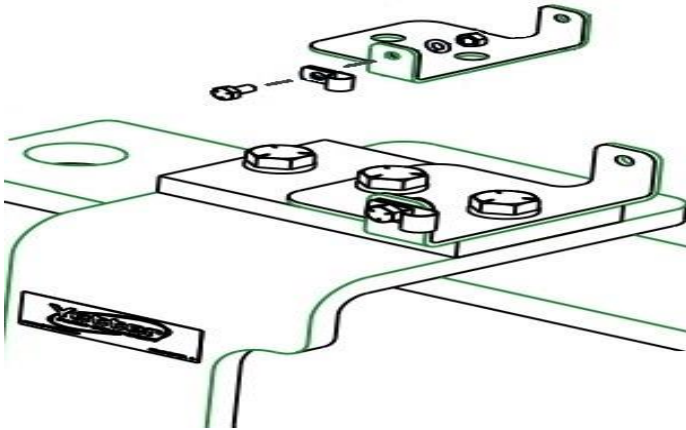

DUAL WHEEL

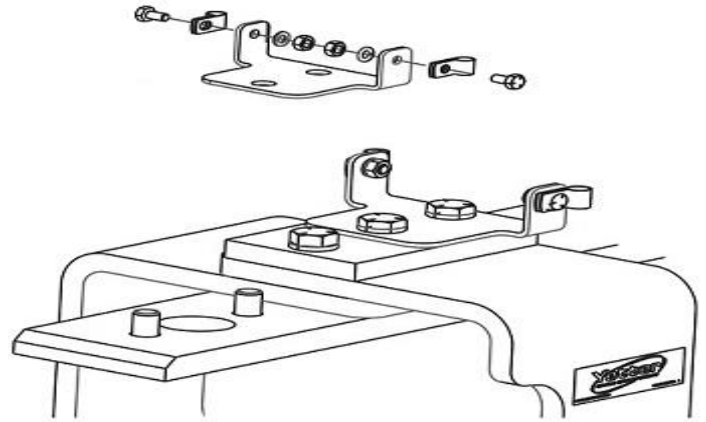

STEP 7A: INJECTOR INSTALLATION

Install each Injector Holder behind each blade. Thread a $\frac{3}{8}$ " hex jam nut on the threaded rod roughly 2", place a $\frac{3}{8}$ " flat washer over the threaded rod against the hex jam nut. Slide the threaded rod thru the horizontal slotted hole on the fertilizer wheel mount so that the threaded rod end is on the outside of the fertilizer wheel mount. Place a $\frac{3}{8}$ " flat washer & $\frac{3}{8}$ " lock washer over the end, & thread another $\frac{3}{8}$ " hex jam nut. Before tightening, center the coupler behind the blade & point the bottom of the coupler slightly forward. Install the push connect fitting on the top side of the coupler if you wish to use it.

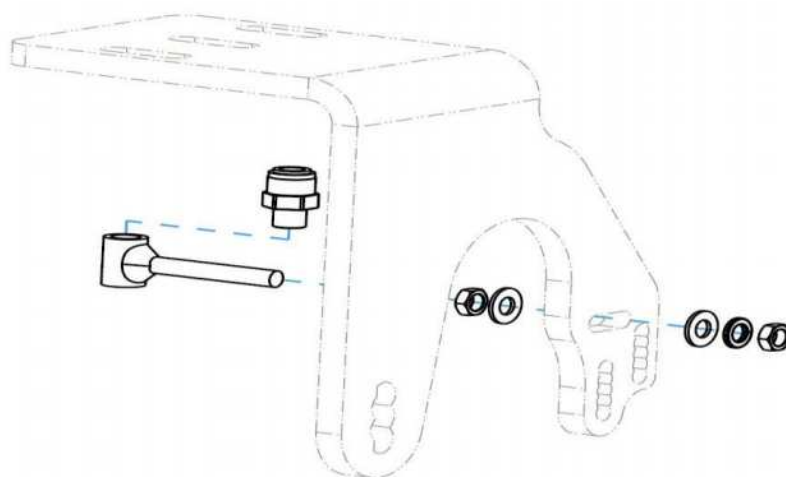

BLADE

WHEN HARDWARE FOR INJECTOR HOLDER IS TIGHTENED, THE COUPLER SHOULD BE CENTERED BEHIND THE BLADE



Assemble nozzle tip (not supplied) to each 2968-218 injector holder. Injector tips can be ordered through fertilizer equipment dealer. Calibrate the fertilizer pump and tips to **maximum recommended pressure of 30PSI and minimum 20PSI at the tip**. Attach the fertilizer hose to the top side of each coupler.

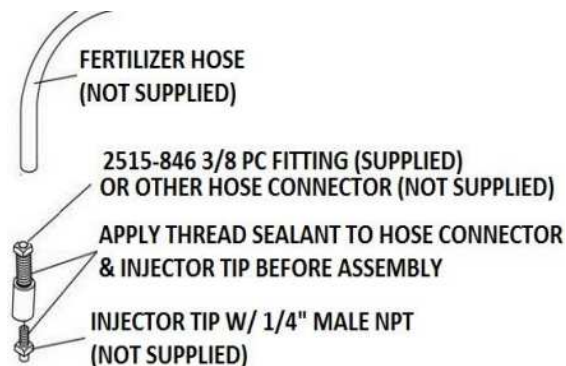

INSTALLATION INSTRUCTIONS

STEP 7B: REAR KNIFE INSTALLATION

Assemble the 3/8 Hose P Clip to the horizontally slotted hole by placing the P Clip over the bolt threads, insert the 3/8" bolt thru the slotted hole, place a 3/8" flat washer & 3/8" lock washer over the bolt, & install a 3/8 hex nut. Insert 1) 3/8" X 3" bolt thru the stop bushing & insert the bolt thru 1 of the rear set of vertical holes that matches the blade. (If blade is in the 2nd hole from the bottom, the stop bolt/bushing needs to be in the 2nd hole from bottom) Place a 3/8" flat washer & lock washer over the bolt on the outside of the mount plate & hand tighten the 3/8" nut. Insert the hook on the spring onto the notch on the knife & place the stepped bushing thru the spring. Place 1) 3/8" flat washer over the remaining 3/8" X 3" bolt, insert bolt thru knife/stepped bushing, & insert bolt thru 1 of the front set of vertical holes that match the stop bolt/bushing. Make sure the spring wire stop is on the back side of the stop bushing. Once the bolt is in position, place a 3/8" flat washer & lock washer over the bolt & hand tighten the 3/8" nut. Make sure the stepped bushing goes thru the knife & then tighten all the hardware down from this step.

LH KNIFE ASSEMBLY

RH KNIFE ASSEMBLY

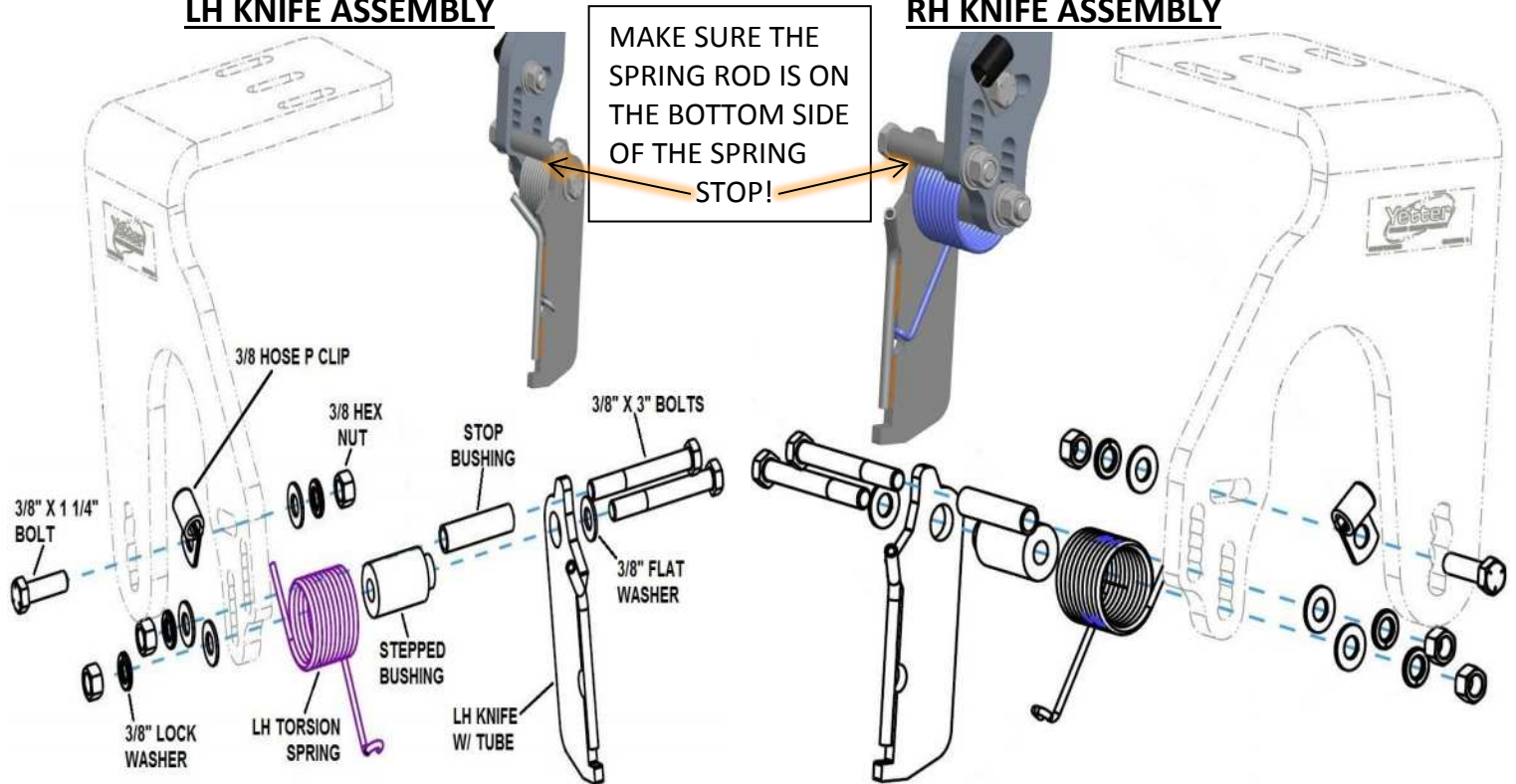

OPERATION

- On dual fertilizer placement, the wheels are staggered front to back to keep the soil from heaving.
- Fertilizer can be placed 2" – 3" off the seed furrow. Please see your agronomist to determine best spacing on the rate that's being applied.
- Calibrate the fertilizer pump and tips to **maximum pressure of 30PSI and minimum 20PSI at the tip.**
- Residue managers are recommended if residue is present in planting conditions to eliminate hair pinning.
- Blade replacement is necessary when the depth cannot be achieved or the blade struggles to penetrate the soil.
- If there is buildup of damp soil on the planter gauge wheels or opener disks, then conditions are less than ideal & some problems may also be encountered with the fertilizer wheel.
- Seed depth will need rechecked after fertilizer unit installation.
- More row unit down force will be needed to maintain fertilizer wheel depth.
- The knife hole positions are ¼" shallower than the blade. For example, if using a 10" blade, the bottom hole setting on the blade will be ¼" deeper than bottom hole setting for the knife.
- When the knife/spring is assembled correctly, the knife should have tension to keep it against the down stop.

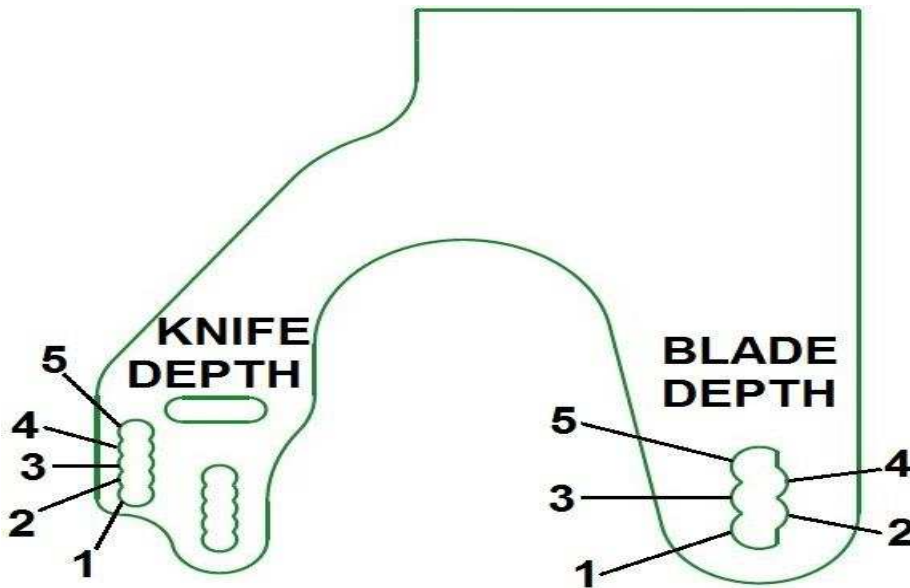

BLADE DEPTH SETTINGS

POSITION	DEPTH (USING 10" NOTCHED BLADE)
1	5/8" BELOW DOUBLE DISC OPENERS
2	3/8" BELOW DOUBLE DISC OPENERS
3	1/8" BELOW DOUBLE DISC OPENERS
4	1/8" ABOVE DOUBLE DISC OPENERS
5	3/8" ABOVE DOUBLE DISC OPENERS

KNIFE DEPTH SETTINGS

POSITION	KNIFE DEPTH
1	3/8" BELOW DOUBLE DISC OPENERS
2	1/8" BELOW DOUBLE DISC OPENERS
3	1/8" ABOVE DOUBLE DISC OPENERS
4	3/8" ABOVE DOUBLE DISC OPENERS
5	5/8" ABOVE DOUBLE DISC OPENERS

OPERATION

LIQUID FERTILIZER APPLICATION RATE & PRESSURE CHART – TABLES BASED ON 30” NOZZLE SPACING

TIP #	LIQUID PRESSURE IN PSI	CAPACITY 1 NOZZLE IN GPM	GALLONS PER ACRE (USING WATER)					
			4 MPH H2O	5 MPH H2O	5.5 MPH H2O	6 MPH H2O	7 MPH H2O	8MPH H2O
#00015	20	0.11	5.45	4.36	3.96	3.63	3.11	2.72
	25	0.12	5.94	4.75	4.32	3.96	3.39	2.97
	30	0.13	6.44	5.15	4.68	4.29	3.68	3.22
	40	0.15	7.43	5.94	5.40	4.95	4.24	3.71
	50	0.17	8.42	6.73	6.12	5.61	4.81	4.21
	60	0.18	8.91	7.13	6.48	5.94	5.09	4.46
#0002	20	0.14	6.93	5.54	5.04	4.62	3.96	3.47
	25	0.16	7.92	6.34	5.76	5.28	4.53	3.96
	30	0.17	8.42	6.73	6.12	5.61	4.81	4.21
	40	0.20	9.90	7.92	7.20	6.60	5.66	4.95
	50	0.23	11.39	9.11	8.28	7.59	6.51	5.69
	60	0.25	12.38	9.90	9.00	8.25	7.07	6.19
#0003	20	0.21	10.40	8.32	7.56	6.93	5.94	5.20
	25	0.24	11.88	9.50	8.64	7.92	6.79	5.94
	30	0.26	12.87	10.30	9.36	8.58	7.35	6.44
	40	0.30	14.85	11.88	10.80	9.90	8.49	7.43
	50	0.34	16.83	13.46	12.24	11.22	9.62	8.42
	60	0.37	18.32	14.65	13.32	12.21	10.47	9.16
#0004	20	0.28	13.86	11.09	10.08	9.24	7.92	6.93
	25	0.32	15.84	12.67	11.52	10.56	9.05	7.92
	30	0.35	17.33	13.86	12.60	11.55	9.90	8.66
	40	0.40	19.80	15.84	14.40	13.20	11.31	9.90
	50	0.45	22.28	17.82	16.20	14.85	12.73	11.14
	60	0.49	24.26	19.40	17.64	16.17	13.86	12.13
#0005	20	0.35	17.33	13.86	12.60	11.55	9.90	8.66
	25	0.40	19.80	15.84	14.40	13.20	11.31	9.90
	30	0.43	21.29	17.03	15.48	14.19	12.16	10.64
	40	0.50	24.75	19.80	18.00	16.50	14.14	12.38
	50	0.56	27.72	22.18	20.16	18.48	15.84	13.86
	60	0.61	30.20	24.16	21.96	20.13	17.25	15.10
#0006	20	0.42	20.79	16.63	15.12	13.86	11.88	10.40
	25	0.47	23.27	18.61	16.92	15.51	13.29	11.63
	30	0.52	25.74	20.59	18.72	17.16	14.71	12.87
	40	0.60	29.70	23.76	21.60	19.80	16.97	14.85
	50	0.67	33.17	26.53	24.12	22.11	18.95	16.58
	60	0.74	36.63	29.30	26.364	24.42	20.93	18.32
#0008	20	0.57	28.22	22.57	20.52	18.81	16.12	14.11
	25	0.63	31.19	24.95	22.68	20.79	17.82	15.59
	30	0.69	34.16	27.32	24.84	22.77	19.52	17.08
	40	0.80	39.60	31.68	28.80	26.40	22.63	19.80
	50	0.89	44.06	35.24	32.04	29.37	25.17	22.03
	60	0.98	48.51	38.81	35.28	32.34	27.72	24.26
#0010	20	0.71	35.15	28.12	25.56	23.43	20.08	17.57
	25	0.79	39.11	31.28	28.44	26.07	22.35	19.55
	30	0.87	43.07	34.45	31.32	28.71	24.61	21.53
	40	1.00	49.50	39.60	36.00	33.00	28.29	24.75
	50	1.12	55.44	44.35	40.32	36.96	31.68	27.72
	60	1.23	60.89	48.71	44.28	40.59	34.79	30.44
#0015	20	1.06	52.47	41.98	38.16	34.98	29.98	26.24
	25	1.19	58.91	47.12	42.84	39.27	33.66	29.45
	30	1.30	64.35	51.48	46.80	42.90	36.77	32.18
	40	1.50	74.25	59.40	54.00	49.50	42.43	37.13
	50	1.68	83.16	66.53	60.48	55.44	47.52	41.58
	60	1.81	89.60	71.68	65.16	59.73	51.20	44.80

Row Spacing Multiplier	10" X 3.3	15" X 2.0	20" X 1.5	36" X .83	38" X .79	40" X .75
------------------------	-----------	-----------	-----------	-----------	-----------	-----------

Values in this chart area based on using water. To calculate nozzle size required for your fertilizer application, the weight of the fertilizer solution must be accounted for by using a conversion factor for specific gravity. The Conversion factor for 28% liquid nitrogen is 1.13. Example: desired rate of application is 10 GPA of 28% N multiply 10 gallons per acre of fertilizer you want to apply x the conversion factor for 28% N (1.13) to get an equivalent rate for water. 10 x 1.13 refers to the chart for 11.13 gallons per acre at your desired speed/MPH.

GPA = 5940 X GPM / (MPH X W)

H2O = WATER
GPA = GALLON PER ACRE
GPM = GALLON PER MINUTES
MPH = MILES PER HOUR
W = WIDTH

SOLUTION
28% = H2O/1.13
32% = H2O/1.15

This table is a reference only. Please calibrate your equipment to insure proper rate of application.

The information contained in this issue is offered in good faith by Yetter Mfg. Co. to further the understanding of liquid fertilizer application.

However, the use of the information provided is beyond the control of Yetter Mfg. Co. and in no case shall Yetter Mfg. Co. or any seller of its products be responsible for any damages that may occur from the use of this information.

MAINTENANCE

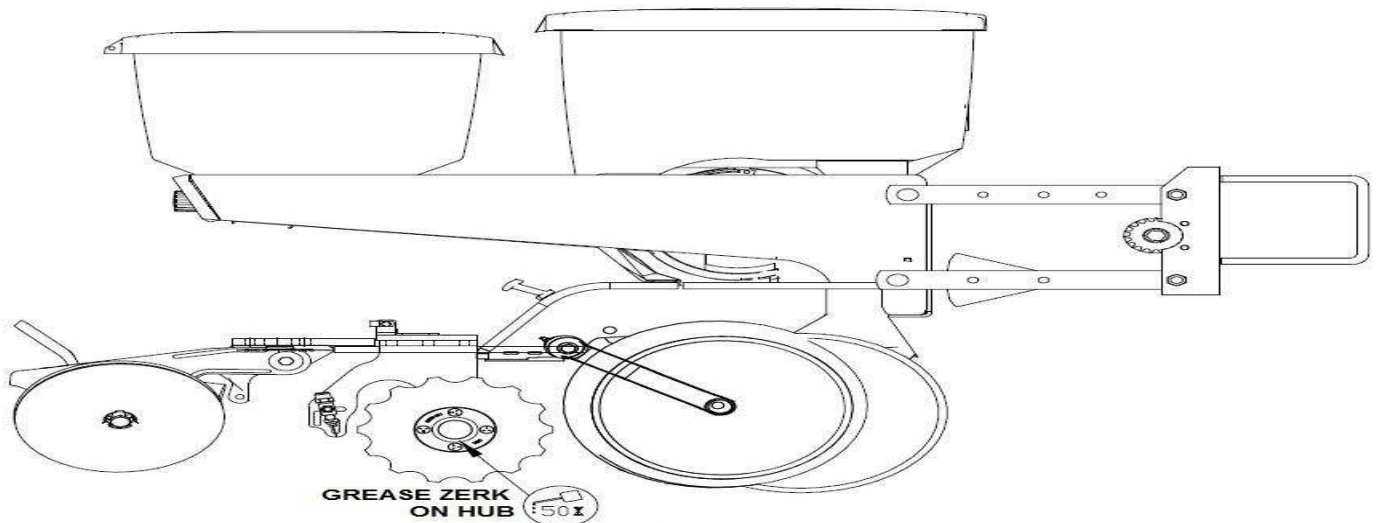

IMPORTANT: If seal is removed from hub/bearing assembly, grease bearing Every 50 hours. If seal is left assembled, 2-3 pumps of grease twice a year, depending on acres, is sufficient.



IMPORTANT: For proper operation, the planter frame must operate level (fore, aft & side to side) and at the correct height, typically 20" -22".

Regularly inspect the residue manager for loose or worn parts. Repair and replace as needed.

BEARING ASSEMBLY AND LUBRICATION

Practice Safety

Understand and practice safe service procedures before doing work. Follow ALL the operating, maintenance and safety information in the equipment operator manual. Clear the area of bystanders, especially small children, when performing any maintenance or adjustments. Keep work area clean and dry. Use adequate lighting for the job. Use only tools, jacks and hoists of sufficient capacity for the job.

Never lubricate, service, or adjust machine while it is moving. Keep hands, feet, and clothing from power-driven moving and rotating parts. Disengage all power and operate controls to relieve pressure. Lower equipment to the ground and stop the engine. Remove the key. Wait for all moving parts to stop before servicing, adjusting, repairing or unplugging.

Securely support any machine elements with blocks or safety stands that must be raised for service work.

Keep all parts in good condition and properly installed. Fix damaged equipment immediately.

Replace worn or broken parts. Remove any buildup of grease, oil, or debris.

Make sure all guards are in place and properly secured when maintenance work is completed.

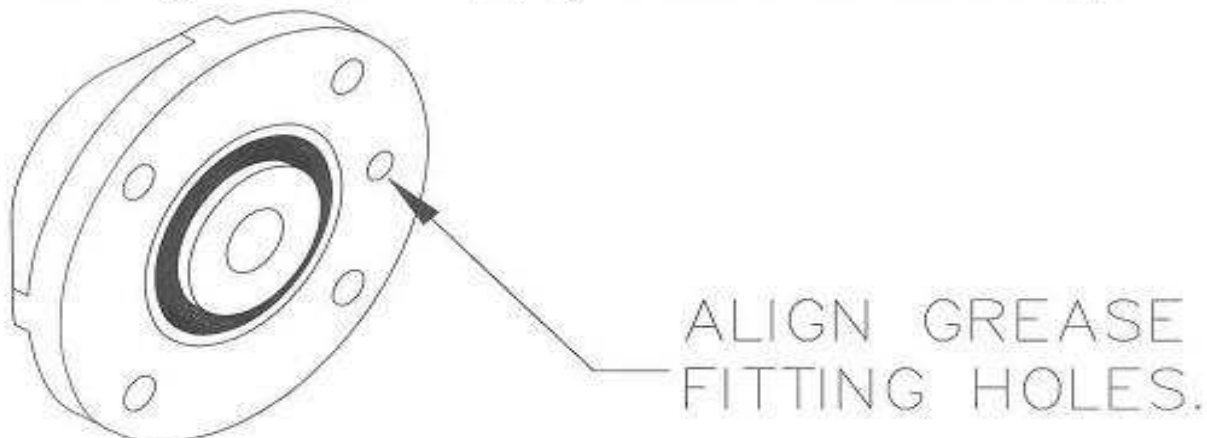

MAINTENANCE

ALIGN THE HUB CAP GROOVE WITH THE WHEEL SLOT & GREASE FITTING

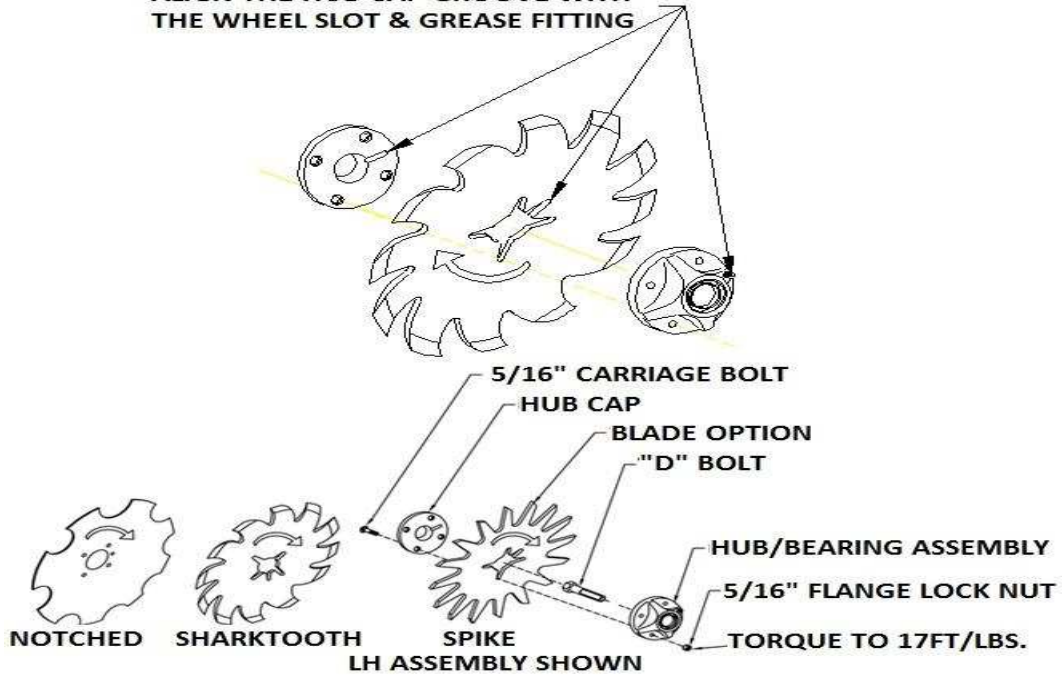

NOTE: BE CERTAIN TO ALIGN THE GREASE FITTING WITH THE SLOT IN THE WHEEL & HUBCAP SO THAT THE GREASE CAN FLOW FREELY.

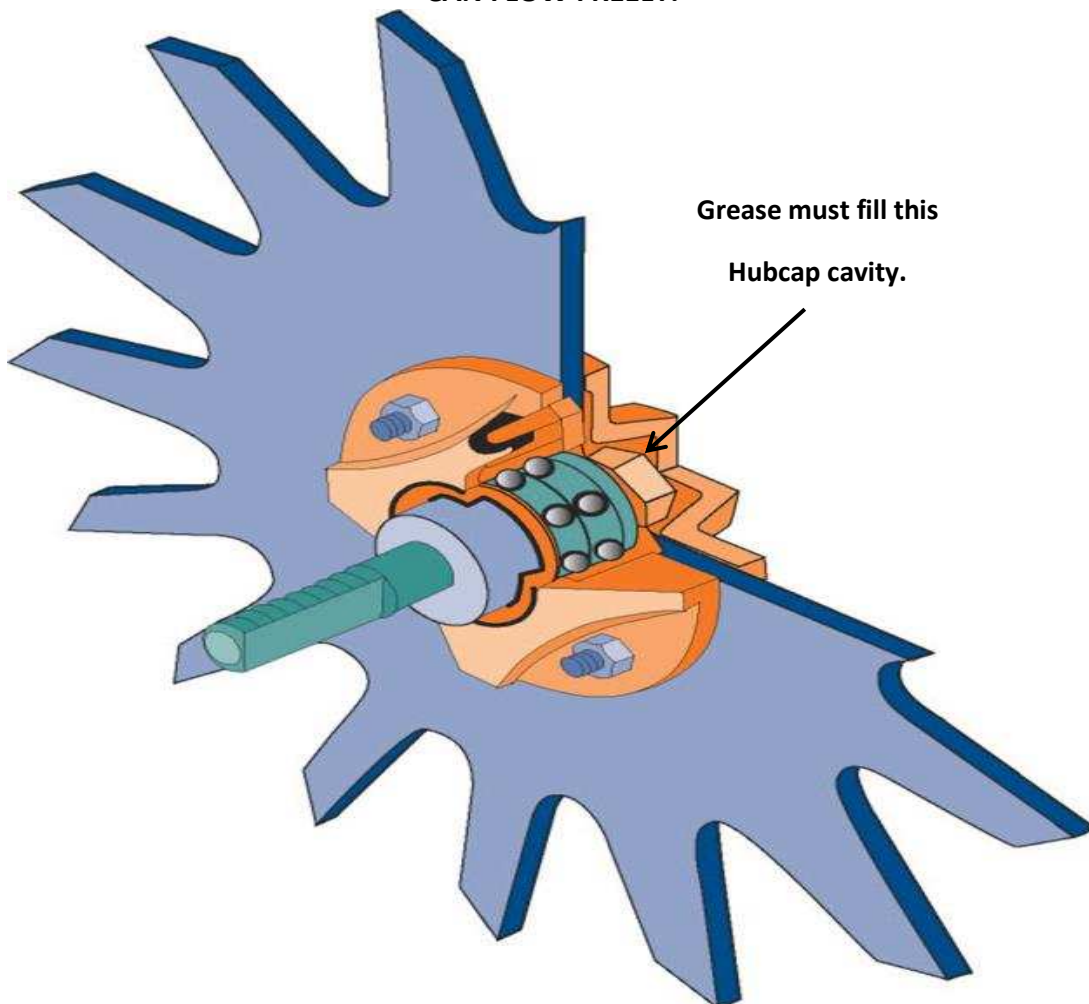

MAINTENANCE

CAUTION: To help prevent serious injury/death to you or others caused by unexpected movement, service machine on a level surface. Lower machine to ground or sufficiently lock or block raised machine before servicing. If machine is connected to tractor, engage parking brake & place transmission in "PARK", shut off engine, & remove key. If machine is detached from tractor, block wheels & use shop stands to prevent movement.



CAUTION: DO NOT CLEAN, LUBRICATE, OR ADJUST MACHINE WHILE IN MOTION

Use grease based on NLGI consistency numbers & the expected air temperature range during the service interval. Use a **multi-purpose polyurea, water resistant, moderate speed, & NLGI grade #2** grease. Other greases may be used if they meet the following **NLGI Performance**.

IMPORTANT: Some types of grease thickener are not compatible with others. Consult your grease supplier before mixing different types of greases.

Alternative Lubricants

Conditions in certain geographical areas may require special lubricants & lubrication practices which do not appear in the operator's manual. If there are any questions, consult Yetter Manufacturing Co. to obtain latest information & recommendation.

PART #	DESCRIPTION	OUNCES OF GREASE
2968-320	10" FERTILIZER WHEEL	1.12 OZ
2968-364	11" FERTILIZER WHEEL	1.12 OZ

Storing Lubricants

Your machine can operate at top efficiency only if clean lubricants are used. Use clean containers to handle all lubricants. **Store them in an area protected from dust, moisture and other contaminants**

LUBRICATION SYMBOLS

Lubricate with grease at hourly interval indicated on symbol if seal has been removed. If seal is left installed on hub/bearing assembly, apply 2 – 3 pumps of grease to each hub twice a season to keep cavity full.

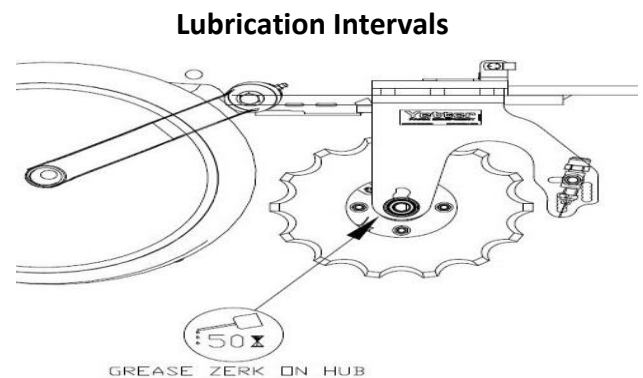

IMPORTANT: The recommended service intervals are based on normal conditions; severe or unusual conditions may require more frequent lubrication. Perform each lubrication and service procedure at the beginning & end of each season. Clean grease fittings before using grease gun, to avoid injecting dirt & grit into the bearing. Replace any lost or broken fittings immediately. If a fitting fails to take grease, remove & clean thoroughly, replace fitting if necessary. Also check for failure of adjoining parts.

BEARING REPLACEMENT INSTALLATION

1. When assembling the fertilizer blade, bearing assembly and hubcap, be sure to align the grease transfer hole in the fertilizer blade with the groove in the hubcap and hole in the hub to allow grease passage.
2. Assemble the blade, hubs and caps.
3. Grease the blade/hub/bearing assembly.

2968-050-L PART IDENTIFICATION

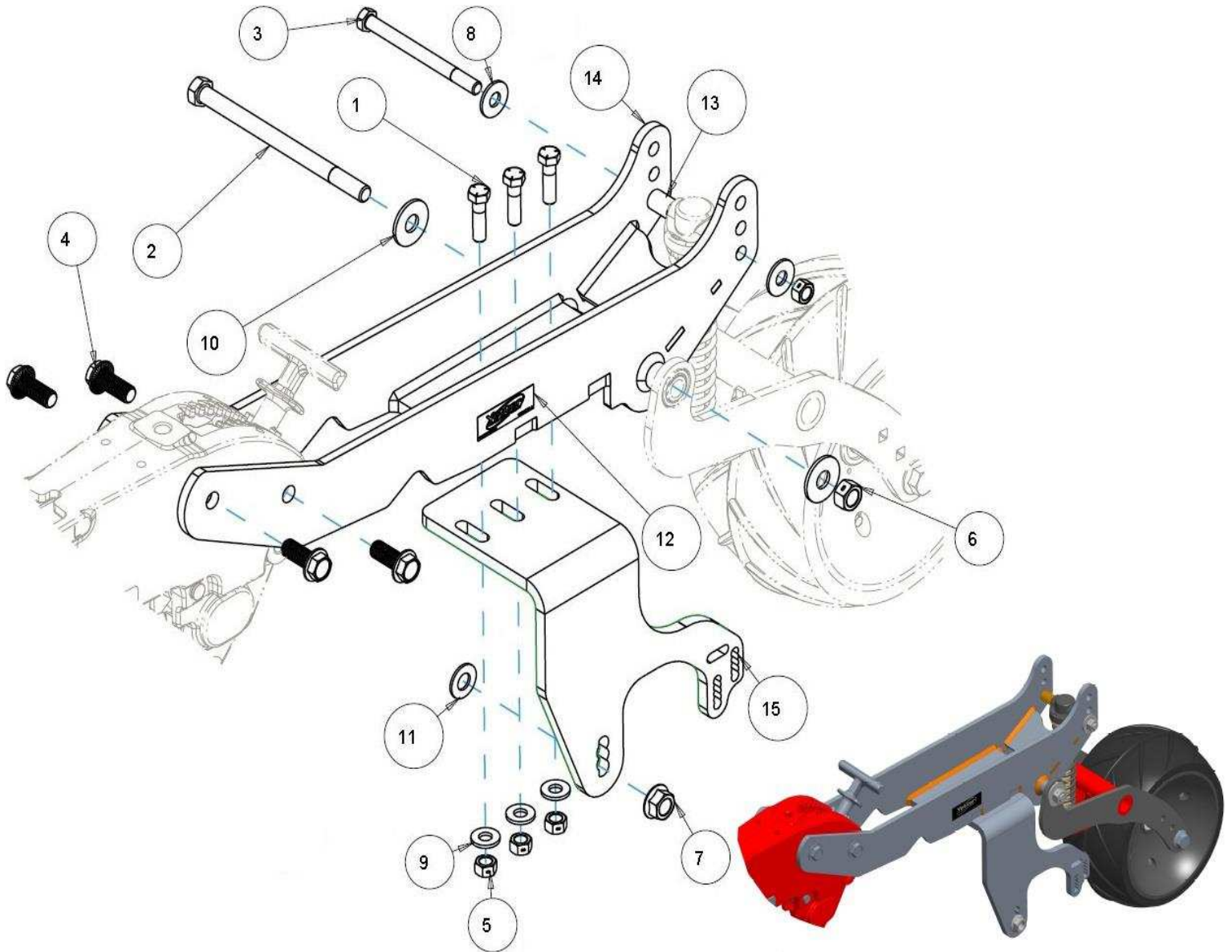

ITEM	PART #	DESCRIPTION	QTY
1	2502-317	½ - 13 X 1 ¼ HHCS GR 5 ZP	3
2	2502-333	5/8 – 11 X 9 HHCS GR 5 ZP	1
3	2502-373	½ - 13 X 6 HHCS GR 5 ZP	1
4	2502-808	M16 X 40 SERRATED HEX FLANGE BOLT ZP	4
5	2520-357	½ - 13 LOCK HEX NUT GR A ZP	4
6	2520-459	5/8 – 11 LOCK HEX NUT GR B ZP	1
7	2520-464	5/8 – 11 WHIZLOCK HEX NUT GR 2 ZP	1
8	2526-351	½ STANDARD FLAT WASHER ZP	2
9	2526-355	½ FLAT WASHER HARDENED ZP	3
10	2526-451	5/8 STANDARD FLAT WASHER ZP	2
11	2526-454	5/8 SAE FLAT WASHER HARDENED ZP	1
12	2565-179	YETTER DECAL	2
13	2967-567	PIVOT BUSHING ZP	2
14	2968-227	2968 MOUNT ASSEMBLY, CASE 2150	1
15	2968-472-LH	LH CNH 2000 TALL FERT WHEEL MOUNT	1

2968-050-R PART IDENTIFICATION

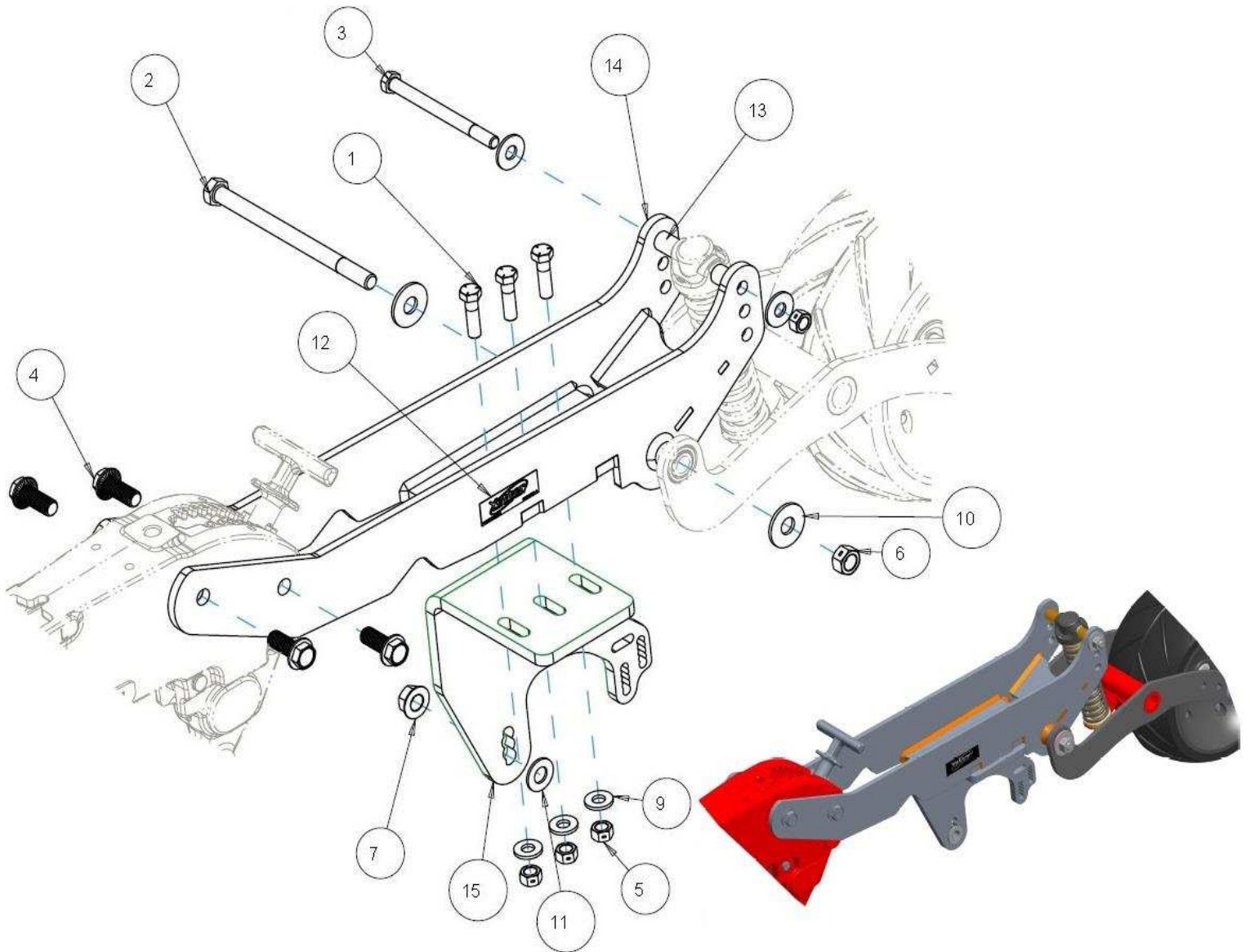

ITEM	PART #	DESCRIPTION	QTY
1	2502-317	½ - 13 X 1 ¼ HHCS GR 5 ZP	3
2	2502-333	5/8 – 11 X 9 HHCS GR 5 ZP	1
3	2502-373	½ - 13 X 6 HHCS GR 5 ZP	1
4	2502-808	M16 X 40 SERRATED HEX FLANGE BOLT ZP	4
5	2520-357	½ - 13 LOCK HEX NUT GR A ZP	4
6	2520-459	5/8 – 11 LOCK HEX NUT GR B ZP	1
7	2520-464	5/8 – 11 WHIZLOCK HEX NUT GR 2 ZP	1
8	2526-351	½ STANDARD FLAT WASHER ZP	2
9	2526-355	½ FLAT WASHER HARDENED ZP	3
10	2526-451	5/8 STANDARD FLAT WASHER ZP	2
11	2526-454	5/8 SAE FLAT WASHER HARDENED ZP	1
12	2565-179	YETTER DECAL	2
13	2967-567	PIVOT BUSHING ZP	2
14	2968-227	2968 MOUNT ASSEMBLY, CASE 2150	1
15	2968-472-RH	RH CNH 2000 TALL FERT WHEEL MOUNT	1

2968-051-L PART IDENTIFICATION

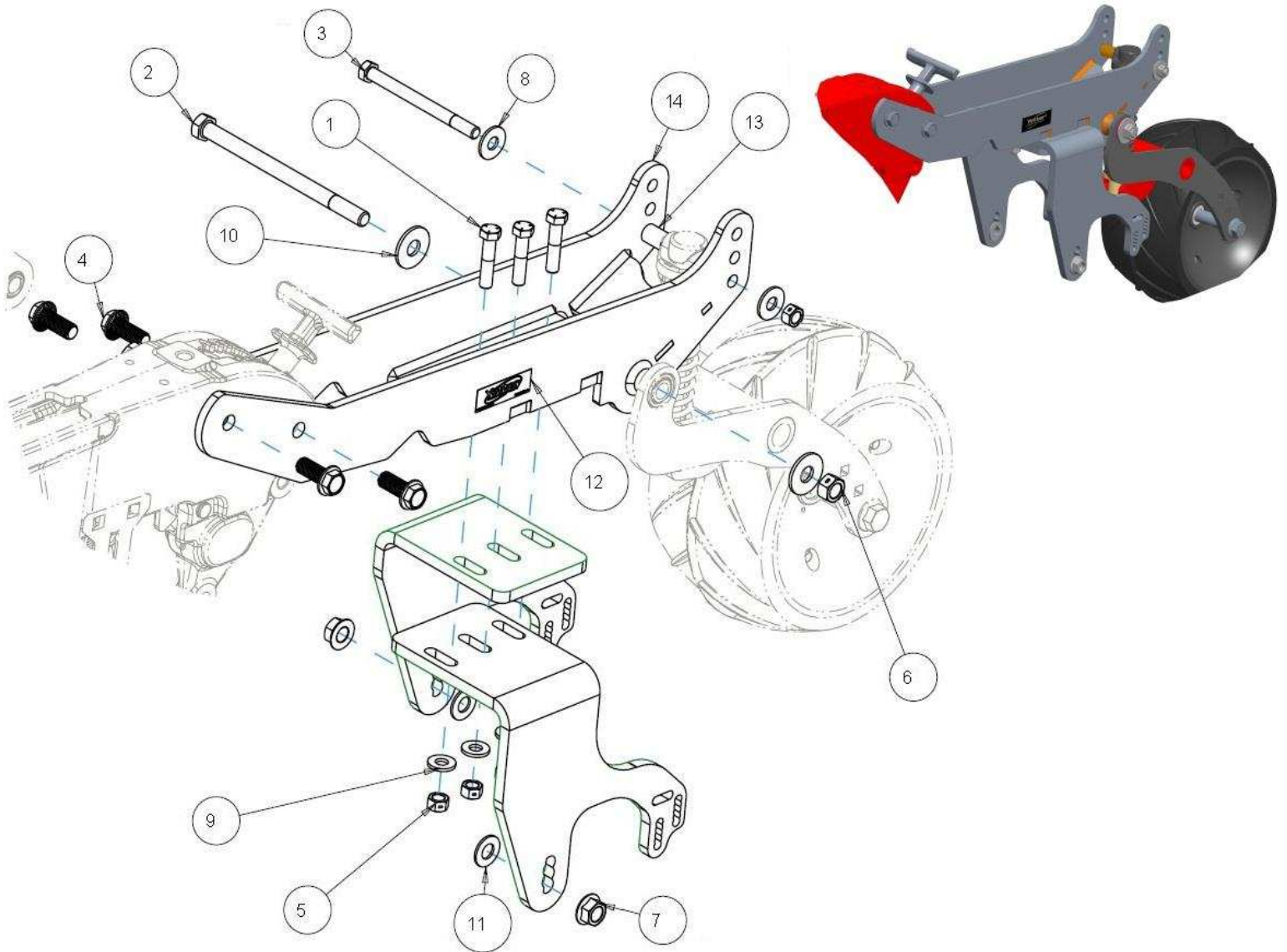

ITEM	PART #	DESCRIPTION	QTY
1	2502-314	½ - 13 X 2 ¼ HHCS GR 5 ZP	3
2	2502-333	5/8 – 11 X 9 HHCS GR 5 ZP	1
3	2502-373	½ - 13 X 6 HHCS GR 5 ZP	1
4	2502-808	M16 X 40 SERRATED HEX FLANGE BOLT ZP	4
5	2520-357	½ - 13 LOCK HEX NUT GR A ZP	4
6	2520-459	5/8 – 11 LOCK HEX NUT GR B ZP	1
7	2520-464	5/8 – 11 WHIZLOCK HEX NUT GR 2 ZP	2
8	2526-351	½ STANDARD FLAT WASHER ZP	2
9	2526-355	½ FLAT WASHER HARDENED ZP	3
10	2526-451	5/8 STANDARD FLAT WASHER ZP	2
11	2526-454	5/8 SAE FLAT WASHER HARDENED ZP	2
12	2565-179	YETTER DECAL	2
13	2967-567	PIVOT BUSHING ZP	2
14	2968-227	2968 MOUNT ASSEMBLY, CASE 2150	1
15	2968-472-LH	LH CNH 2000 TALL FERT WHEEL MOUNT	1
16	2968-473-RH	RH CNH 2000 SHORT FERT WHEEL MOUNT	1

2968-051-R PART IDENTIFICATION

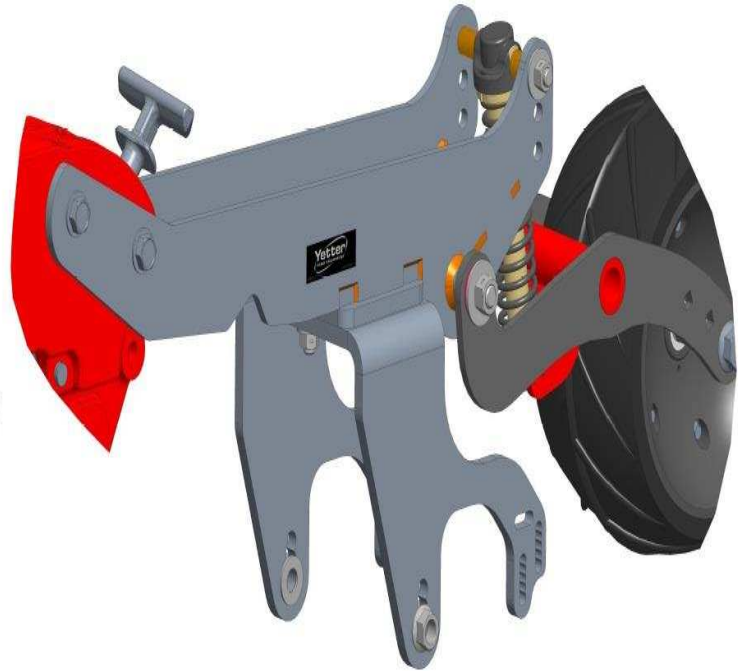
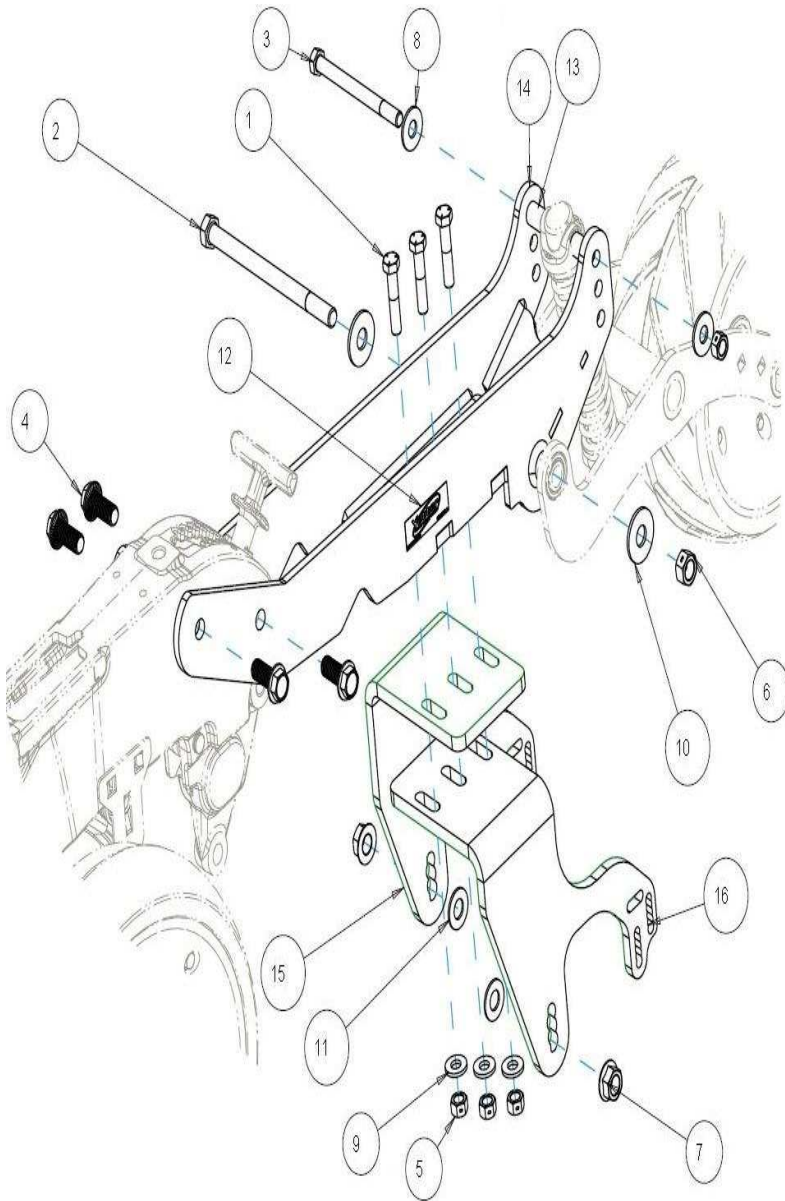

ITEM	PART #	DESCRIPTION	QTY
1	2502-314	½ - 13 X 2 ¼ HHCS GR 5 ZP	3
2	2502-333	5/8 – 11 X 9 HHCS GR 5 ZP	1
3	2502-373	½ - 13 X 6 HHCS GR 5 ZP	1
4	2502-808	M16 X 40 SERRATED HEX FLANGE BOLT ZP	4
5	2520-357	½ - 13 LOCK HEX NUT GR A ZP	4
6	2520-459	5/8 – 11 LOCK HEX NUT GR B ZP	1
7	2520-464	5/8 – 11 WHIZLOCK HEX NUT GR 2 ZP	2
8	2526-351	½ STANDARD FLAT WASHER ZP	2
9	2526-355	½ FLAT WASHER HARDENED ZP	3
10	2526-451	5/8 STANDARD FLAT WASHER ZP	2
11	2526-454	5/8 SAE FLAT WASHER HARDENED ZP	2
12	2565-179	YETTER DECAL	2
13	2967-567	PIVOT BUSHING ZP	2
14	2968-227	2968 MOUNT ASSEMBLY, CASE 2150	1
15	2968-472-RH	RH CNH 2000 TALL FERT WHEEL MOUNT	1
16	2968-473-LH	LH CNH 2000 SHORT FERT WHEEL MOUNT	1

2968-052-L PART IDENTIFICATION

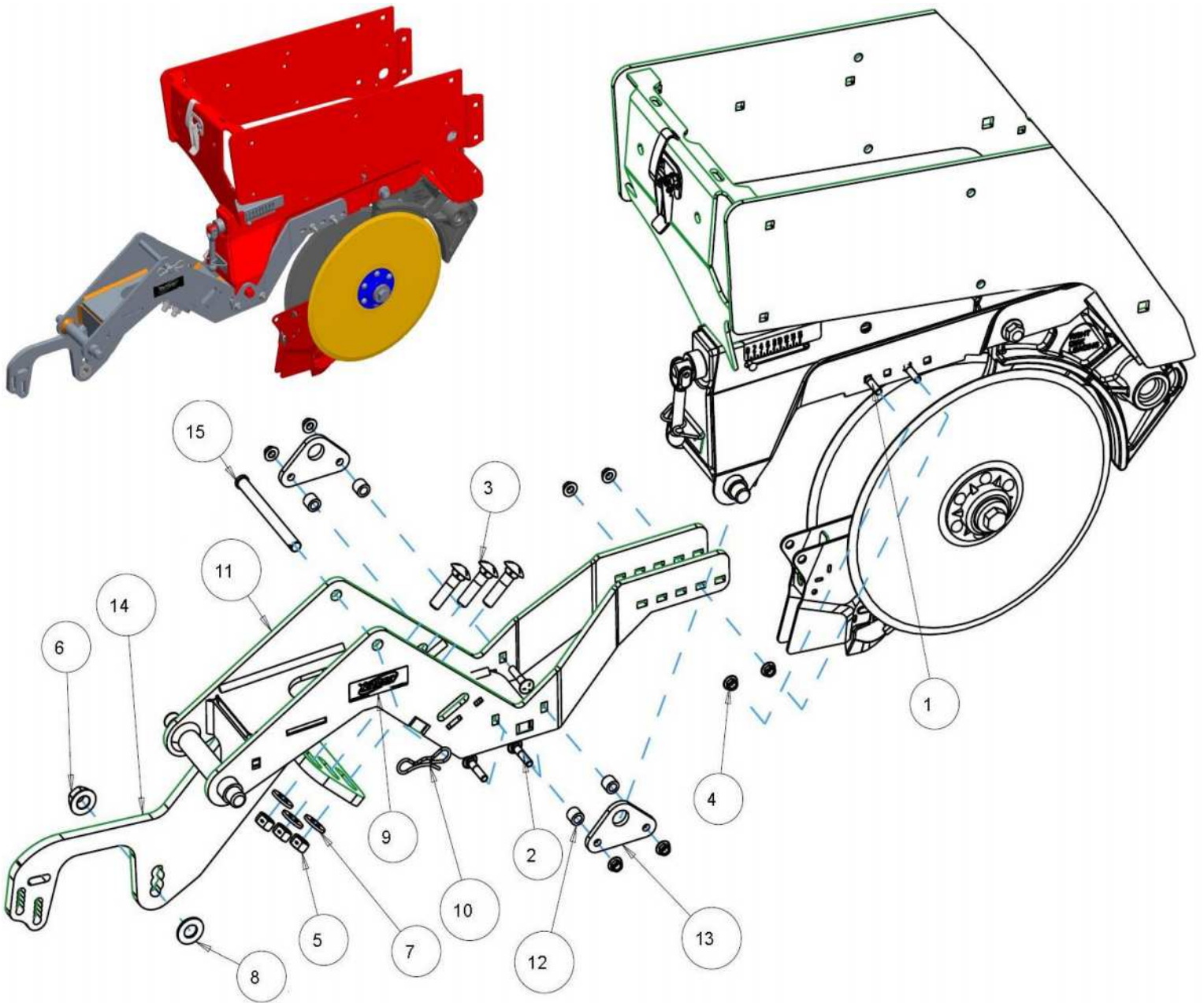

ITEM	PART #	DESCRIPTION	QTY
1	2505-207	5/16 – 18 X 1 ¼ CARRIAGE BOLT GR 5 ZP	4
2	2505-208	5/16 – 18 X 1 ½ CARRIAGE BOLT GR 5 ZP	4
3	2505-345	½ - 13 X 2 CARRIAGE BOLT GR 5 ZP	3
4	2520-206	5/16 – 18 FLANGE LOCK NUT	8
5	2520-357	½ - 13 LOCK HEX NUT GR A ZP	3
6	2520-464	5/8 – 11 WHIZLOCK HEX NUT GR 2 ZP	1
7	2526-355	½ FLAT WASHER HARDENED ZP	3
8	2526-454	5/8 SAE FLAT WASHER HARDENED ZP	1
9	2565-179	YETTER DECAL	2
10	2570-448	.120 BOWTIE LOCKING COTTER ZP	1
11	2968-230	MAIN MOUNT BRACKET W.A.	1
12	2968-383	TRIANGULAR MOUNT SPACER, ZP	4
13	2968-386	TRIANGULAR MOUNT	2
14	2968-403-LH	TALL CNH 1200 LHL ARM	1
15	2984-497	AIR CYLINDER ROD PIN	1

2968-052-R PART IDENTIFICATION

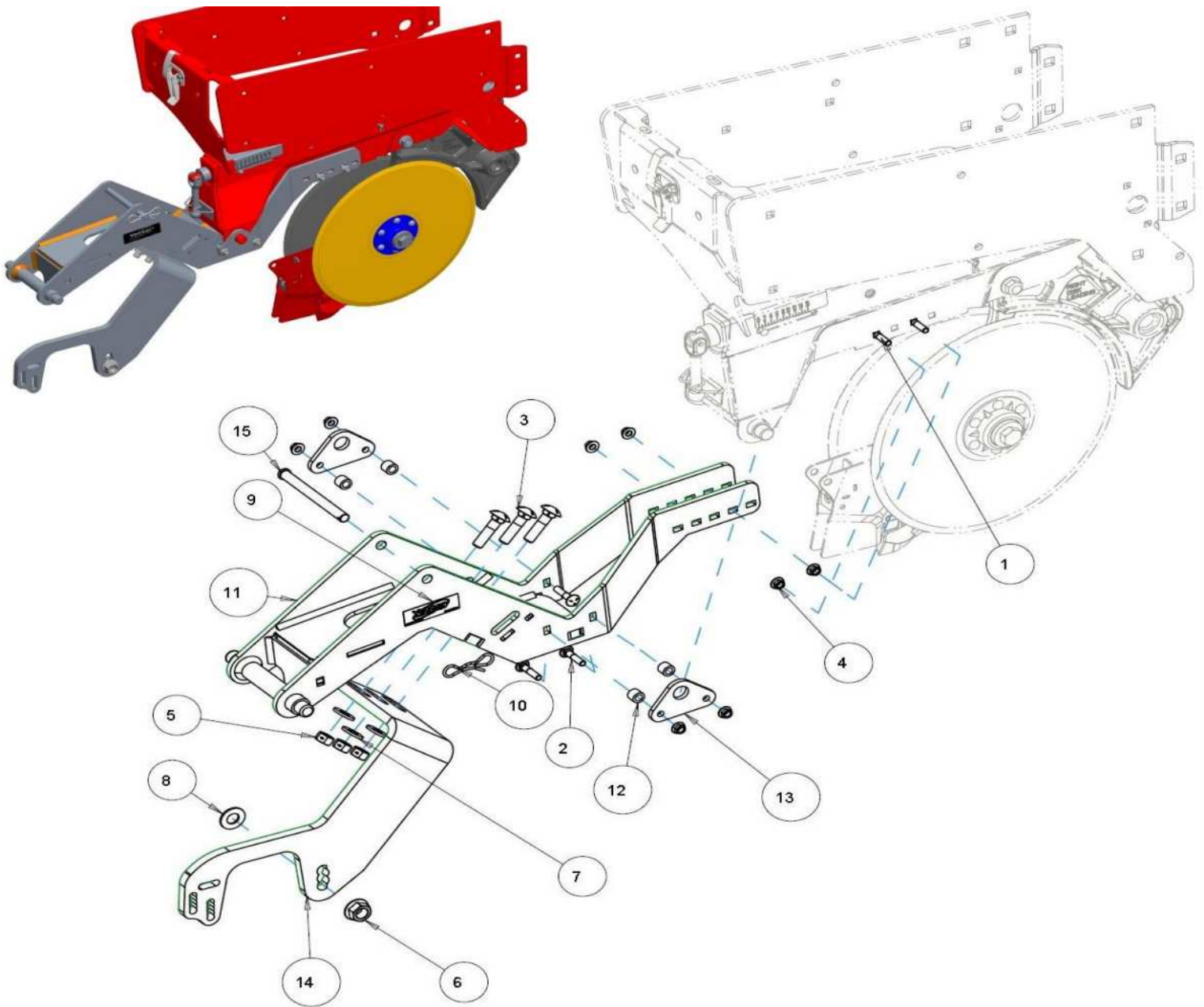

ITEM	PART #	DESCRIPTION	QTY
1	2505-207	5/16 – 18 X 1 ¼ CARRIAGE BOLT GR 5 ZP	4
2	2505-208	5/16 – 18 X 1 ½ CARRIAGE BOLT GR 5 ZP	4
3	2505-345	½ - 13 X 2 CARRIAGE BOLT GR 5 ZP	3
4	2520-206	5/16 – 18 FLANGE LOCK NUT	8
5	2520-357	½ - 13 LOCK HEX NUT GR A ZP	3
6	2520-464	5/8 – 11 WHIZLOCK HEX NUT GR 2 ZP	1
7	2526-355	½ FLAT WASHER HARDENED ZP	3
8	2526-454	5/8 SAE FLAT WASHER HARDENED ZP	1
9	2565-179	YETTER DECAL	2
10	2570-448	.120 BOWTIE LOCKING COTTER ZP	1
11	2968-230	MAIN MOUNT BRACKET W.A.	1
12	2968-383	TRIANGULAR MOUNT SPACER, ZP	4
13	2968-386	TRIANGULAR MOUNT	2
14	2968-403-RH	TALL CNH 1200 RHL ARM	1
15	2984-497	AIR CYLINDER ROD PIN	1

2968-053-L PART IDENTIFICATION

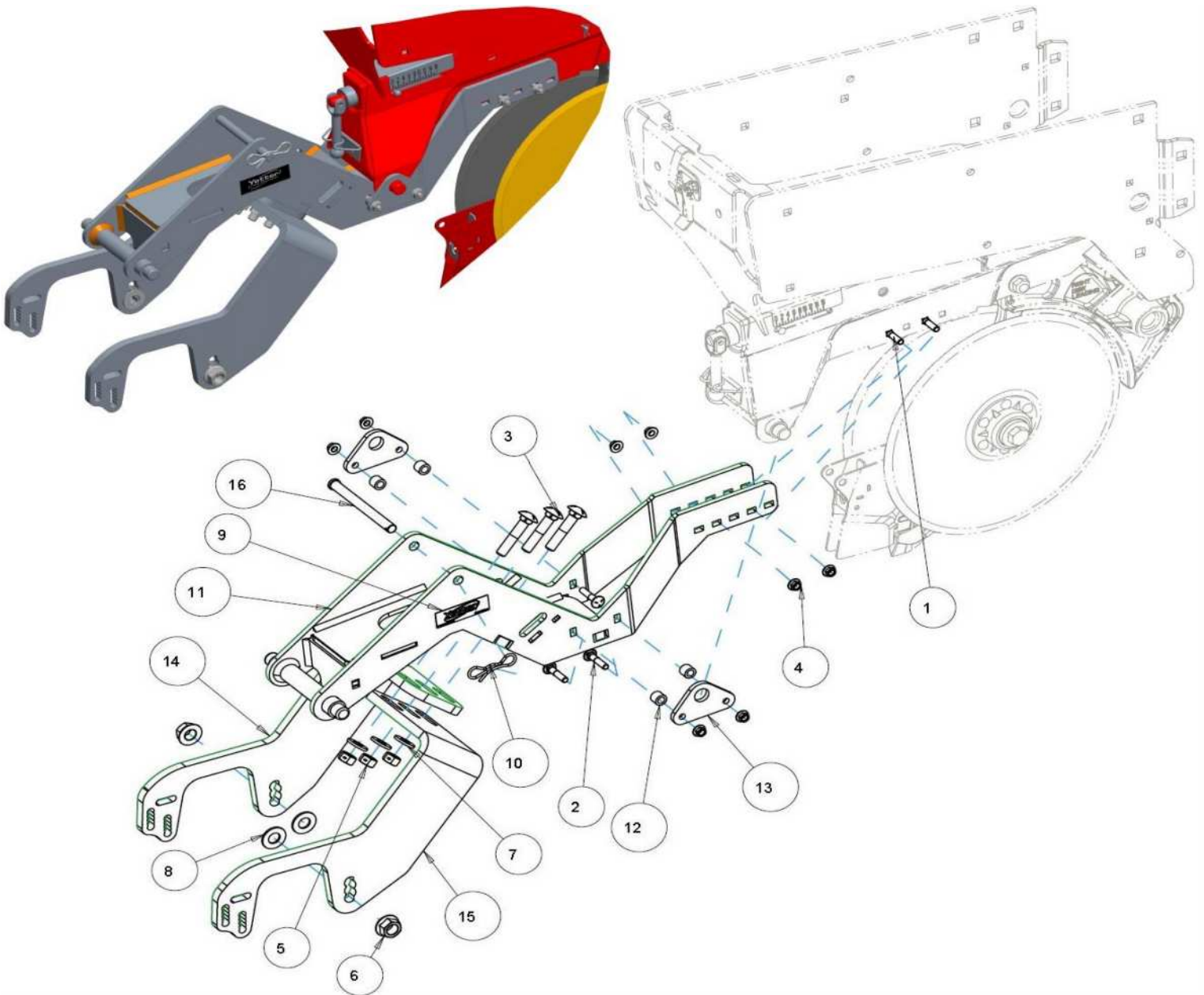

ITEM	PART #	DESCRIPTION	QTY
1	2505-207	5/16 – 18 X 1 ¼ CARRIAGE BOLT GR 5 ZP	4
2	2505-208	5/16 – 18 X 1 ½ CARRIAGE BOLT GR 5 ZP	4
3	2505-343	½ - 13 X 2 ½ CARRIAGE BOLT GR 5 ZP	3
4	2520-206	5/16 – 18 FLANGE LOCK NUT	8
5	2520-357	½ - 13 LOCK HEX NUT GR A ZP	3
6	2520-464	5/8 – 11 WHIZLOCK HEX NUT GR 2 ZP	2
7	2526-355	½ FLAT WASHER HARDENED ZP	3
8	2526-454	5/8 SAE FLAT WASHER HARDENED ZP	2
9	2565-179	YETTER DECAL	2
10	2570-448	.120 BOWTIE LOCKING COTTER ZP	1
11	2968-230	MAIN MOUNT BRACKET W.A.	1
12	2968-383	TRIANGULAR MOUNT SPACER, ZP	4
13	2968-386	TRIANGULAR MOUNT	2
14	2968-403-LH	TALL CNH LHL 1200 SHORT ARM	1
15	2968-404-RH	RH CNH 1200 SHORT ARM	1
16	2984-497	AIR CYLINDER ROD PIN	1

2968-053-R PART IDENTIFICATION

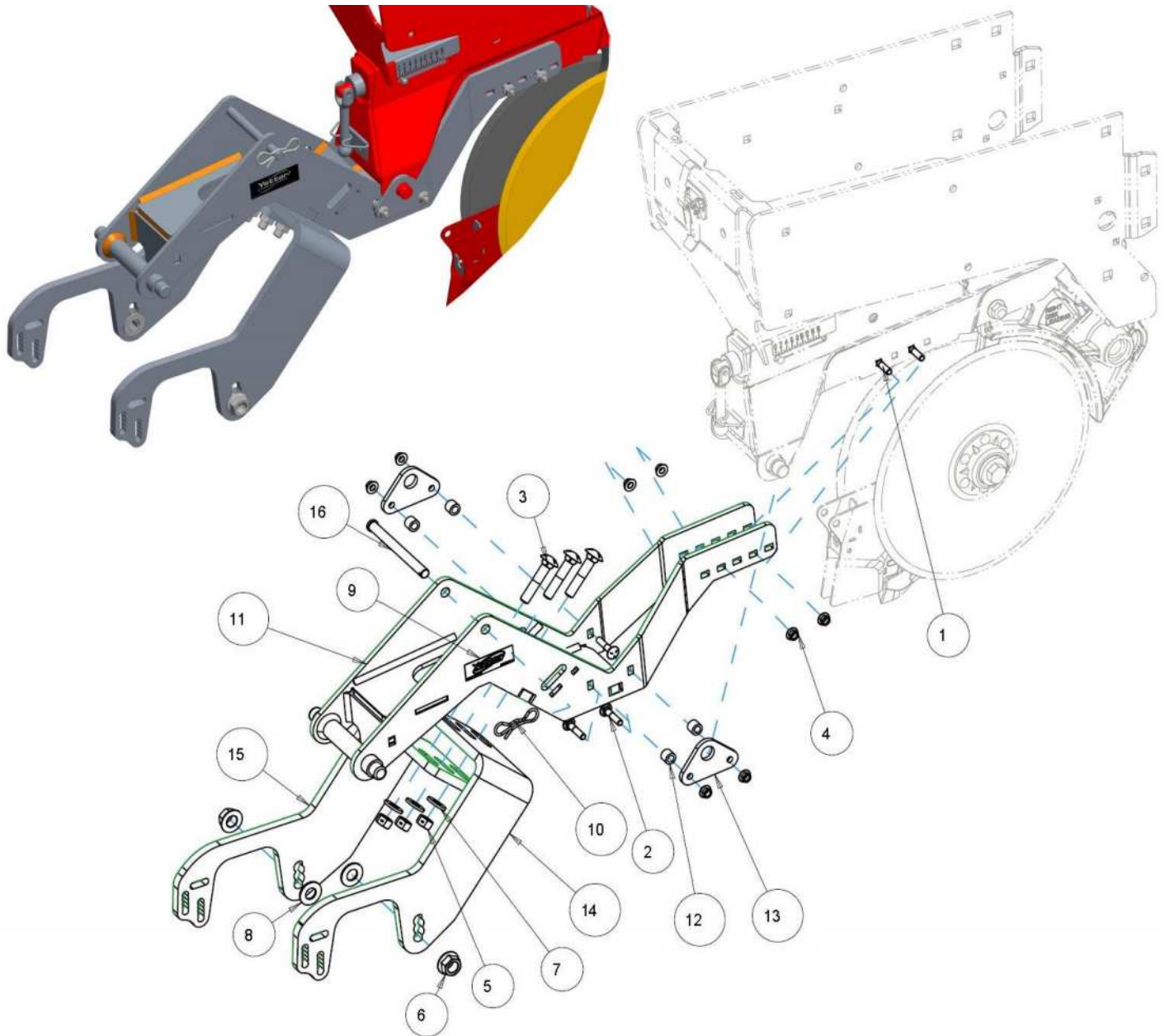

ITEM	PART #	DESCRIPTION	QTY
1	2505-207	5/16 – 18 X 1 ½ CARRIAGE BOLT GR 5 ZP	4
2	2505-208	5/16 – 18 X 1 ½ CARRIAGE BOLT GR 5 ZP	4
3	2505-343	½ - 13 X 2 ½ CARRIAGE BOLT GR 5 ZP	3
4	2520-206	5/16 – 18 FLANGE LOCK NUT	8
5	2520-357	½ - 13 LOCK HEX NUT GR A ZP	3
6	2520-464	5/8 – 11 WHIZLOCK HEX NUT GR 2 ZP	2
7	2526-355	½ FLAT WASHER HARDENED ZP	3
8	2526-454	5/8 SAE FLAT WASHER HARDENED ZP	2
9	2565-179	YETTER DECAL	2
10	2570-448	.120 BOWTIE LOCKING COTTER ZP	1
11	2968-230	MAIN MOUNT BRACKET W.A.	1
12	2968-383	TRIANGULAR MOUNT SPACER, ZP	4
13	2968-386	TRIANGULAR MOUNT	2
14	2968-404-RH	TALL CNH 1200 RHL ARM	1
15	2968-404-LH	LH CNH 1200 SHORT ARM	1
16	2984-497	AIR CYLINDER ROD PIN	1

2968-054 PART IDENTIFICATION

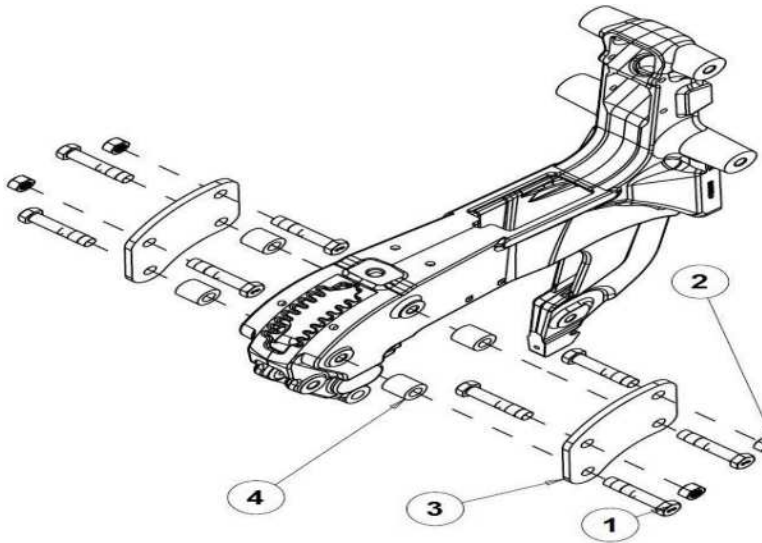

ITEM	PART #	DESCRIPTION	QTY
1	2505-807	M16 X 2 X 80 HEX SCREW, THREADLOCK, ZP	8
2	2520-477	M16 X 2 HEX NUT ZP	4
3	2968-374	BOX MOUNT BRACKET	2
4	2968-375	BOX MOUNT SPACER	4

2968-090A-L PARTS IDENTIFICATION

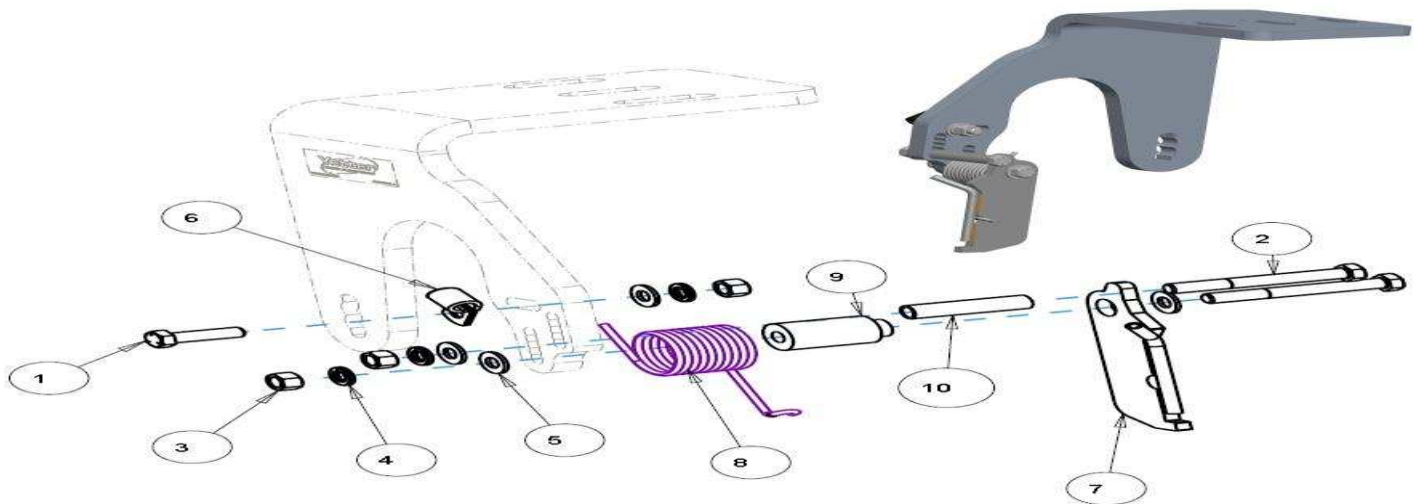

ITEM	PART #	DESCRIPTION	QTY
1	2502-244	3/8 - 16 X 1 1/4 HHCS GR 5 ZP	1
2	2502-251	3/8 - 16 X 3 HHCS GR 8 ZP	2
3	2520-251	3/8 - 16 HEX NUT ZP	3
4	2525-251	3/8 MEDIUM LOCK WASHER ZP	3
5	2526-253	3/8 SAE FLAT WASHER ZP	4
6	2570-727	3/8 HOSE P-CLIP W/ VINYL CUSHION	1
7	2968-229-L	LH KNIFE TUBE	1
8	2968-396-L	LH TORSION SPRING	1
9	2968-401	STEPPED BUSHING	1
10	2968-402	STOP BUSHING	1

2968-090A-R PARTS IDENTIFICATION

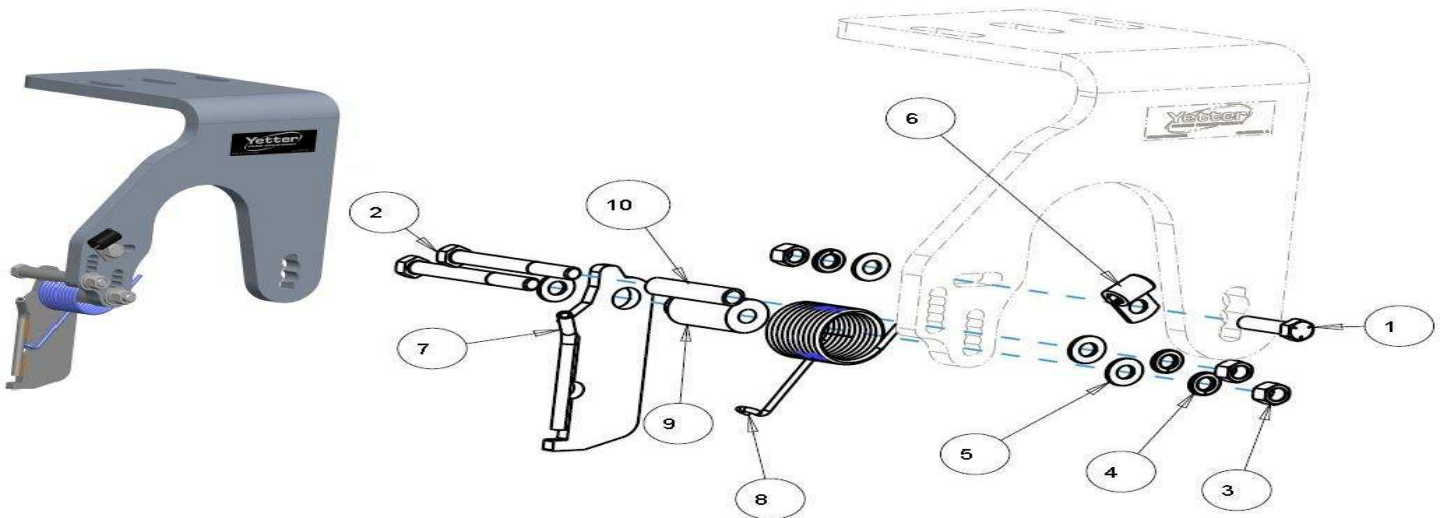

ITEM	PART #	DESCRIPTION	QTY
1	2502-244	3/8 – 16 X 1 ¼ HHCS GR 5 ZP	1
2	2502-251	3/8 – 16 X 3 HHCS GR 8 ZP	2
3	2520-251	3/8 – 16 HEX NUT ZP	3
4	2525-251	3/8 MEDIUM LOCK WASHER ZP	3
5	2526-253	3/8 SAE FLAT WASHER ZP	4
6	2570-727	3/8 HOSE P-CLIP W/ VINYL CUSHION	1
7	2968-229-R	RH KNIFE TUBE	1
8	2968-396-R	RH TORSION SPRING	1
9	2968-401	STEPPED BUSHING	1
10	2968-402	STOP BUSHING	1

2968-091 PART IDENTIFICATION

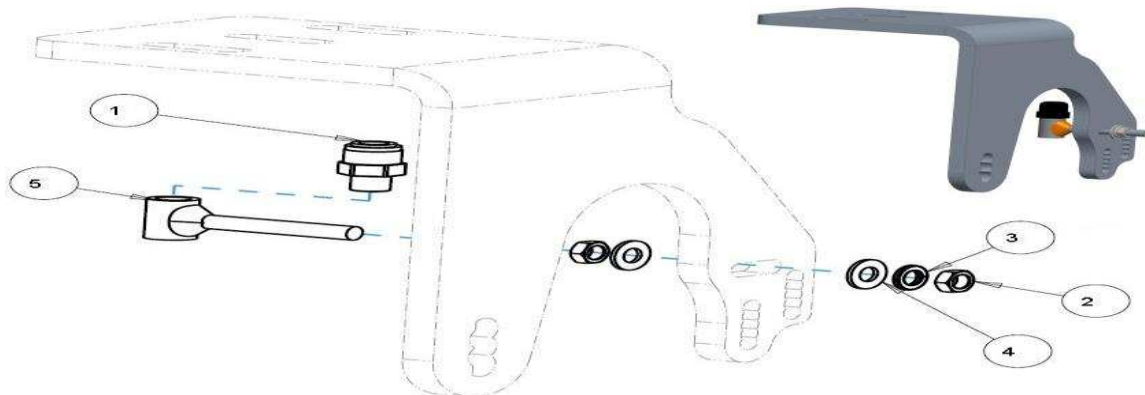

ITEM	PART #	DESCRIPTION	QTY
1	2515-846	MALE CONNECTOR – 3/8 X ¼ NPTF	1
2	2520-253	3/8 – 16 JAM HEX NUT ZP	2
3	2525-251	3/8 MEDIUM LOCK WASHER ZP	1
4	2526-253	3/8 SAE FLAT WASHER ZP	2
5	2968-218	INJECTOR HOLDER	1

2968-132 (SHOWN) 10" & 2968-133 11" WHEEL ASSEMBLY

MUST ALIGN GREASE ZERK WITH ALL GREASE GROOVES

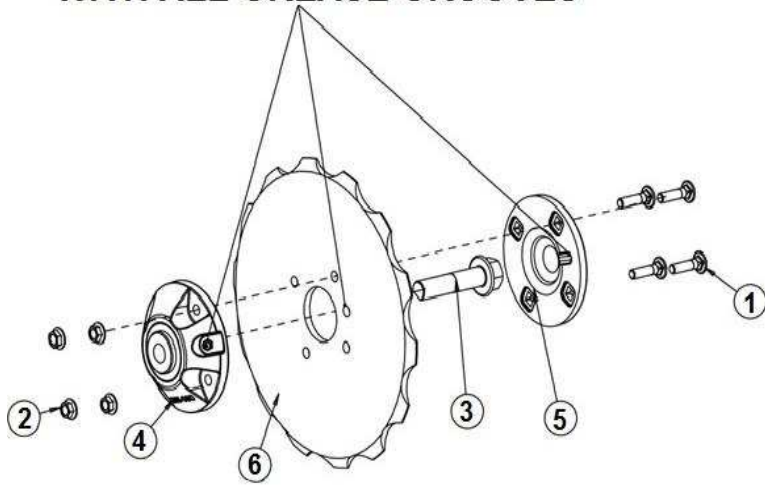

ITEM	PART #	DESCRIPTION	QTY
1	2505-207	5/16 – 18 X 1 ¼ CARRIAGE BOLT GR 5 ZP	4
2	2520-206	5/16 – 18 FLANGE LOCK NUT	4
3	2570-740	D-BOLT, FLANGED, 5/8 – 11 X 2.812 GR 8	1
4	2965-128	HUB & BEARING, 4 BOLT	1
5	2965-352	HUB CAP, 4 BOLT, BLACK	1
6	2968-320	10.05 X .256 FERTILIZER WHEEL (SHOWN)	1

2965-128 HUB & BEARING

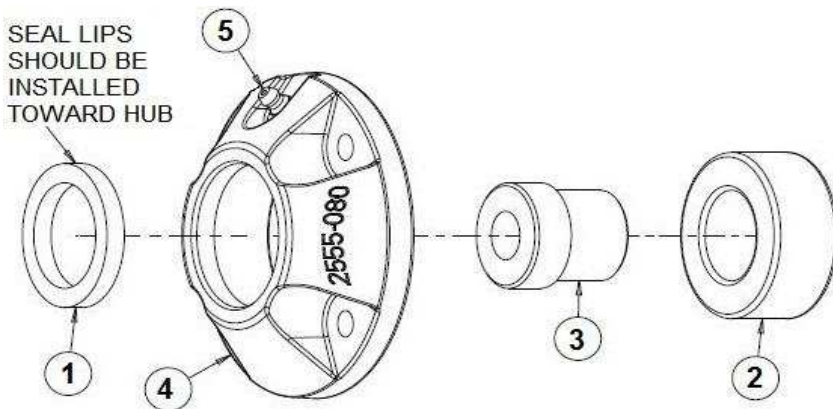

ITEM	PART #	DESCRIPTION	QTY
1	2550-069	TRIPLE LIP SEAL, NTI# 1812-5	1
2	2570-594	BEARING, 2 ROW	1
3	2570-715	BEARING INSERT	1
4	2965-351	HUB CASTING, MACHINED, 4 BOLT	1
5	2533-110	¼ - 28 SELF-TAP ZERK, STRAIGHT	1

TROUBLESHOOTING

<u>ISSUE</u>	<u>CAUSE</u>	<u>SOLUTION</u>
2968 UNITS PLUGGING WITH RESIDUE	<ul style="list-style-type: none"> - PLANTER UNITS AREN'T EQUIPPED WITH ROW CLEANERS - ROW CLEANERS AREN'T SET AGGRESSIVE ENOUGH - KNIFE (IF EQUIPPED) DRAGGING RESIDUE - TOO MUCH RESIDUE IN THE SOIL PROFILE - RESIDUE BEING THROWN INTO CLOSING WHEELS 	<ul style="list-style-type: none"> - ADD ROW CLEANERS TO PLANTER UNITS - ADJUST ROWS TO CLEAR MORE TRASH FROM THE ROW - ADJUST KNIFE POSITION HIGHER - REPLACE DULL BLADE TO HELP CUT RESIDUE BETTER - ADJUST FERTILIZER WHEELS WIDER
2968 BLADES NOT PENETRATING	<ul style="list-style-type: none"> - NOT ENOUGH ROW UNIT DOWN FORCE - DULL FERTILIZER BLADES - TOOLBAR NOT HEAVY ENOUGH - PLANTER TOOLBAR NOT LEVEL FRONT TO BACK 	<ul style="list-style-type: none"> - APPLY MORE ROW UNIT DOWN FORCE - REPLACE FERTILIZER BLADES - ADD WEIGHT TO TOOLBAR - LEVEL PLANTER TOOLBAR, SIDE TO SIDE & FORE & AFT
FERTILIZER SPLATTER	<ul style="list-style-type: none"> - TOO MUCH PRESSURE AT TIP - INJECTOR TIP ALIGNED WITH DISC SLOT 	<ul style="list-style-type: none"> - CHECK FERTILIZER PRESSURE, 20-30PSI AT TIP - ADJUST INJECTOR TO ALIGN STREAM OF FERTILIZER IN SLOT



NOTES:



A Tradition of Solutions since 1930

Yetter Farm Equipment Co

PO BOX 358 109 S. McDonough

Colchester, IL 62326-0358

Phone: 309-776-4111

Toll Free: 800-447-5777

Email: info@yetterco.com

For updated models and manuals visit the Yetter website:

www.yetterco.com

© Yetter Farm Equipment Co. All Rights Reserved

2565-960-REV_A – 01/2020